



鈕扣電池盒(扣)

詳細產品規格-請點擊[www.100y.com.tw](http://www.100y.com.tw)



Part No.	Product No.	說明	重量
52685	CH243-2032	CR2032 電池的電池盒	1.7g/pc

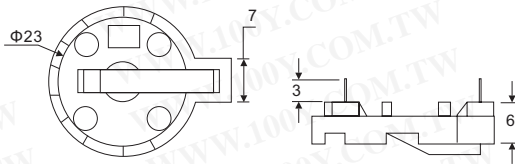

- MATERIAL: HOUSING-PBT+30% G.F. UL94V-0
- CONTACT PHOSPHOR BRONZE, C5191R-H T=0.6MM
- FLASH: 0.25mm MAX
- CAMBER: 0.13mm MAX DEFORMATION: NA
- WARP: 0.13mm MAX TWIST:NA
- PLATING: TIN 100u" MIN OVER Ni 50u" MIN Ni 80u" MIN
- COLOR: BLACK

Part No.	Product No.	說明	Max. Cell Dia.	重量
52680	CH25-2325	鈕扣電池盒 FOR:CR2325	23mm	2.25g/pc

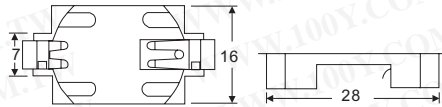

- MATERIAL: HOUSING-LCP 30%GF UL94V-0
- PLATING: Sn/Pb 120u" MIN OVER Ni 60u" MIN
- COLOR: WHITE

Part No.	Product No.	說明	重量
52684	CH29-2032	CR2032 電池的電池盒	1.45g/pc

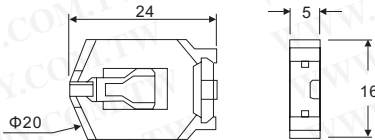

- MATERIAL: HOUSING-PPS+30% G/F UL94V-0
- CONTACT-COPPER ALLOY
- COLOR: BLACK

Part No.	Product No.	說明	重量
52683	CH7410-2032	CR2032 電池的電池盒	0.95g/pc



Part No.	Product No.	製造廠商	說明
49505	SMTU2032-LF	RENATA	RENATA_電池座

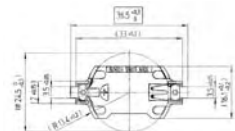

Part No.	Product No.	製造廠商	說明	Max. Cell Dia.
57347	SMTU2430-LF	RENATA	RENATA_電池座	24.5mm
57349	SMTU2430-LF.TR	RENATA	RENATA_電池座	24.5mm



Part No.	Product No.	製造廠商	說明
46143	SMTU2450N-LF	RENATA	RENATA_電池座

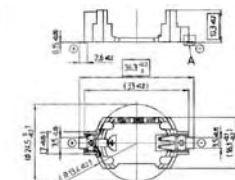

Part No.	Product No.	製造廠商	說明
59598	SMTU2477N-LF	RENATA	RENATA_電池座

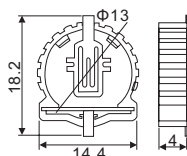

Part No.	Product No.	說明	重量
24680	ZH856	CR1220 電池的電池盒	0.7g

