

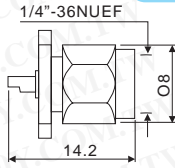

插板式SMA座

詳細產品規格-請點擊[www.100y.com.tw](http://www.100y.com.tw)



Part No.	Product No.	說明
3286	MCI-7808	SMA 公 Chassis Mount
43188	MCI-7808	SMA 公 Chassis Mount

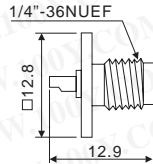

Part No.	Product No.	說明
62593	MCI-7814-鍍金	SMA 母 Chassis Mount
3285	MCI-7814-鍍鎳	SMA 母 Chassis Mount

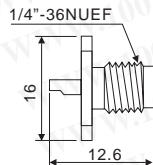

Part No.	Product No.	說明	重量
62436	MCI-7815-鍍金	SMA Female Chassis Mount	1.9g
2898	MCI-7815-鍍鎳	SMA Female Chassis Mount	1.9g

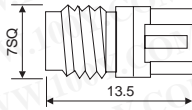

Part No.	Product No.	說明	重量
17500	MCI-7845	SMA FEMALE P.C BOARD MOUNT	3g

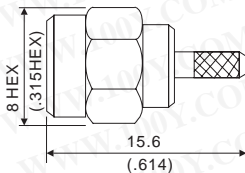

- Weight: 3.06g
- Suitable Cables: RG174, RG188, RG316, RG316-E, RG316-FEP

JYEBAO®

Part No.	Product No.	製造廠商	說明	Norm. Imp.(ohms)	重量
56987	SMA3100-0316	JYEBAO	JYEBAO_SMA CONN. FOR RG316	50	3.06g
59467	SMA3100S-0316	JYEBAO	JYEBAO_SMA CONN. FOR RG316	50	2.98g

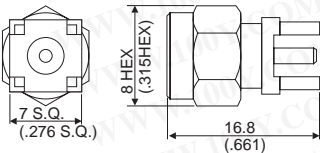

JYEBAO®

Part No.	Product No.	製造廠商	說明	Norm. Imp.(ohms)
57820	SMA3400-0000	JYEBAO	JYEBAO_SMA(M)LAUNCH CONN	50

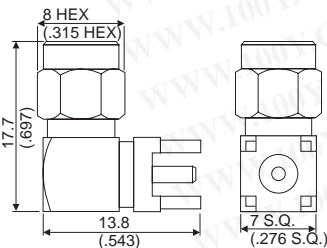

JYEBAO®

Part No.	Product No.	製造廠商	說明	重量
33549	SMA3400-9000	JYEBAO	JYEBAO_SMA (M)RA JACK PCB MOUNT	6.6g

● 假如您需要適合特殊用途的產品或更詳細的技術資料，我們的業務專員將會透過電話，傳真，E-mail,幫助您

