

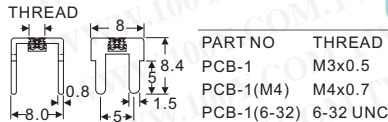

PC板其他配件

詳細產品規格請點擊www.100y.com.tw



用途：PC板上之焊接電線端子，美觀，牢固，耐電流大，配合螺絲固定端子
MATERIAL: TIN PLATED BRASS

Part No.	Product No.	說明	Tapped
59357	PCB-1-632	PC 板焊接端子	φ6mm
59355	PCB-1-M3	PC 板焊接端子	M3
59356	PCB-1-M4	PC 板焊接端子	M4

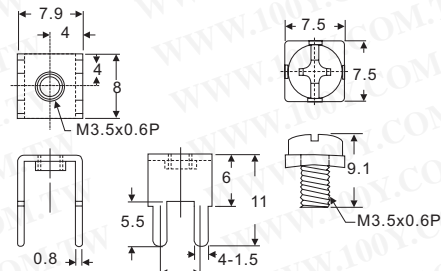

用途：PC板上之焊接電線端子，美觀，牢固，耐電流大，配合螺絲固定端子
MATERIAL: TIN PLATED BRASS
PACKAGE: 1000

Part No.	Product No.	說明	Tapped
59535	PCB-10-M3.5	PC 板焊接端子	M3.5

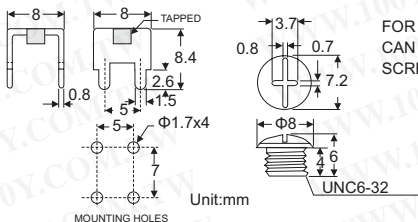

FOR PCB-11(STP)
CAN COOPERATE
SCREW USE)

PC板上之焊接電線端子，美觀，牢固，耐電流大，配合螺絲固定端子
MATERIAL: TIN PLATED BRASS
SCREW MATERIAL: NICKEL PLATED

Part No.	Product No.	說明	Tapped
59536	PCB-11-632	PC 板焊接端子	φ6mm
54293	PCB-11-M3	PC 板焊接端子	M3
54297	PCB-11-M4	PC 板焊接端子	M4

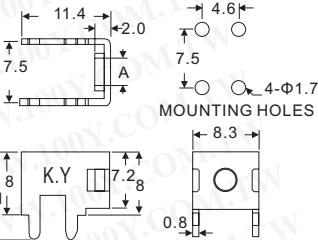

PART NO	TAPPED
PCB-12	M3x0.5
PCB-12(M4)	M4x0.7
PCB-12(632)	6-32UNC

用途：PC板上之焊接電線端子，美觀，牢固，耐電流大，配合螺絲固定端子
MATERIAL: TIN PLATED BRASS

Part No.	Product No.	說明	Tapped
59539	PCB-12-632	PC 板焊接端子	φ6mm
59537	PCB-12-M3	PC 板焊接端子	M3
59538	PCB-12-M4	PC 板焊接端子	M4

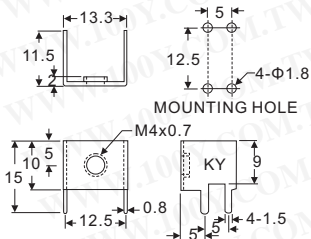

用途：PC板上之焊接電線端子，美觀，牢固，耐電流大，配合螺絲固定端子
MATERIAL: TIN PLATED BRASS

Part No.	Product No.	說明	Tapped
59540	PCB-15-M4	PC 板焊接端子	M4

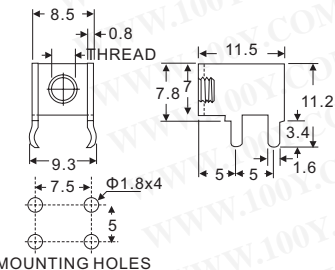

PART NO	THREAD
PCB-2	M3x0.5
PCB-2(M4)	M4x0.7
PCB-2(6-32)	6-32UNC

用途：PC板上之焊接電線端子，美觀，牢固，耐電流大，配合螺絲固定端子
MATERIAL: TIN PLATED BRASS

Part No.	Product No.	說明	Tapped
59458	PCB-2-632	PC 板焊接端子	φ6mm
59456	PCB-2-M3	PC 板焊接端子	M3
59457	PCB-2-M4	PC 板焊接端子	M4

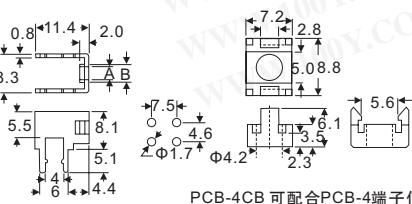
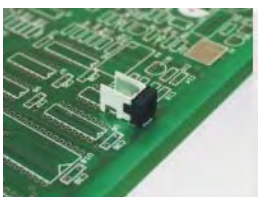

PART NO	A	B
PCB-4	M3x0.5	3.5
PCB-4(M4)	M4x0.7	4.4
PCB-4(632)	6-32UNC	4.4

用途：PC板上之焊接電線端子，美觀，牢固，耐電流大，配合螺絲固定端子
MATERIAL: TIN PLATED BRASS

Part No.	Product No.	說明	Tapped
59461	PCB-4-632	PC 板焊接端子	φ6mm
59459	PCB-4-M3	PC 板焊接端子	M3
59460	PCB-4-M4	PC 板焊接端子	M4

