

勝特力電材超市-龍山店 886-3-5773766  
 勝特力電材超市-光復店 886-3-5729570  
 勝特力电子(上海) 86-21-34970699  
 勝特力电子(深圳) 86-755-83298787  
<http://www.100y.com.tw>

AD-A3E3

SMA Plug To MMCX Plug  
6GHz VSWR 1.2

50Ω

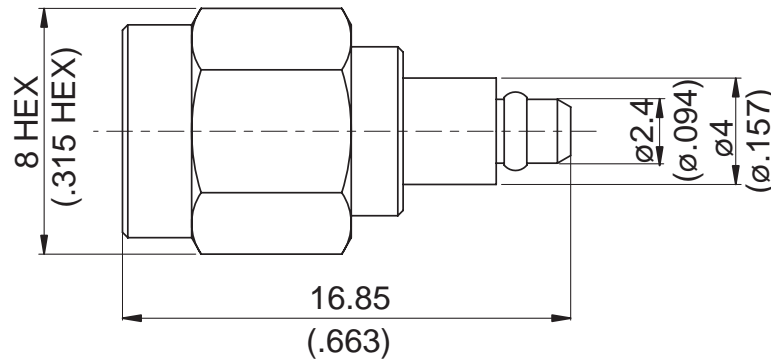

Parts	Material	Plating (Micro-inch)
Renber Ring	Beryllium Copper	Gold 4 Over Nickel-Phosphorus Alloy 80 Over Copper 20
Contact Pin	Brass	Gold 4 Over Nickel-Phosphorus Alloy 80 Over Copper 20
Retainer Ring	Beryllium Copper	Tin-Zinc-Copper-Alloy 100 Over Copper 50
Gasket	Silicon	
Insulator	Teflon	Gold 4 Over Nickel-Phosphorus Alloy 80 Over Copper 20
Body	Brass	Gold 4 Over Nickel-Phosphorus Alloy 80 Over Copper 20
Coupling Nut	Brass	Gold 4 Over Nickel-Phosphorus Alloy 80 Over Copper 20

Weight: 8.26 g

This part number complies with RoHS.

**Notice:** JYBAO reserves the right to make modifications deemed appropriate.

AD-A3E3	SMA Plug To MMCX Plug 6GHz VSWR 1.2	
<div style="border: 1px solid black; padding: 2px; margin-bottom: 5px;">Interface</div> Standard Mechanically Compatible With	<div style="border: 1px solid black; padding: 2px; margin-bottom: 5px; text-align: center;">SMA</div> MIL-STD-348B 2.92 & 3.5	<div style="border: 1px solid black; padding: 2px; margin-bottom: 5px; text-align: center;">MMCX</div> IEC 61169-52
<div style="border: 1px solid black; padding: 2px; margin-bottom: 5px;">Electrical Data</div> Impedance Frequency Range VSWR Insertion Loss Insulation Resistance Dielectric Withstanding Voltage (at sea level) Working Voltage (at sea level)	50Ω DC To 6GHz $\leq 1.2$ (DC To 6GHz) $\leq 0.03 \times \sqrt{f(\text{GHz})}$ dB $\geq 5000\text{M}\Omega$ 500 V rms 170 V rms	
<div style="border: 1px solid black; padding: 2px; margin-bottom: 5px;">Mechanical Data</div> Recommended Coupling Nut Torque Coupling Proof Torque Coupling Nut Retention Force Engagement Force Disengagement Force Contact Captivation-axial Durability (mating)	<div style="border: 1px solid black; padding: 2px; margin-bottom: 5px; text-align: center;">SMA</div> 4 in-lbs 5.3 in-lbs $\geq 60.7$ lbs NA NA $\geq 6.1$ lbs $\geq 100$	<div style="border: 1px solid black; padding: 2px; margin-bottom: 5px; text-align: center;">MMCX</div> NA NA NA $\leq 3.4$ lbs 1.4 to 3.4 lbs $\geq 2.3$ lbs $\geq 500$
<div style="border: 1px solid black; padding: 2px; margin-bottom: 5px;">Environmental Data</div> Temperature Range Thermal Shock Moisture Resistance Corrosion RoHS	-55°C to +155°C MIL-STD-202, Method 107, Condition B MIL-STD-202, Method 206 MIL-STD-202, Method 101, Condition B Compliant	

Notice: JYEBAO reserves the right to make modifications deemed appropriate.

# AD-A3E3 (+AD-A8E8)

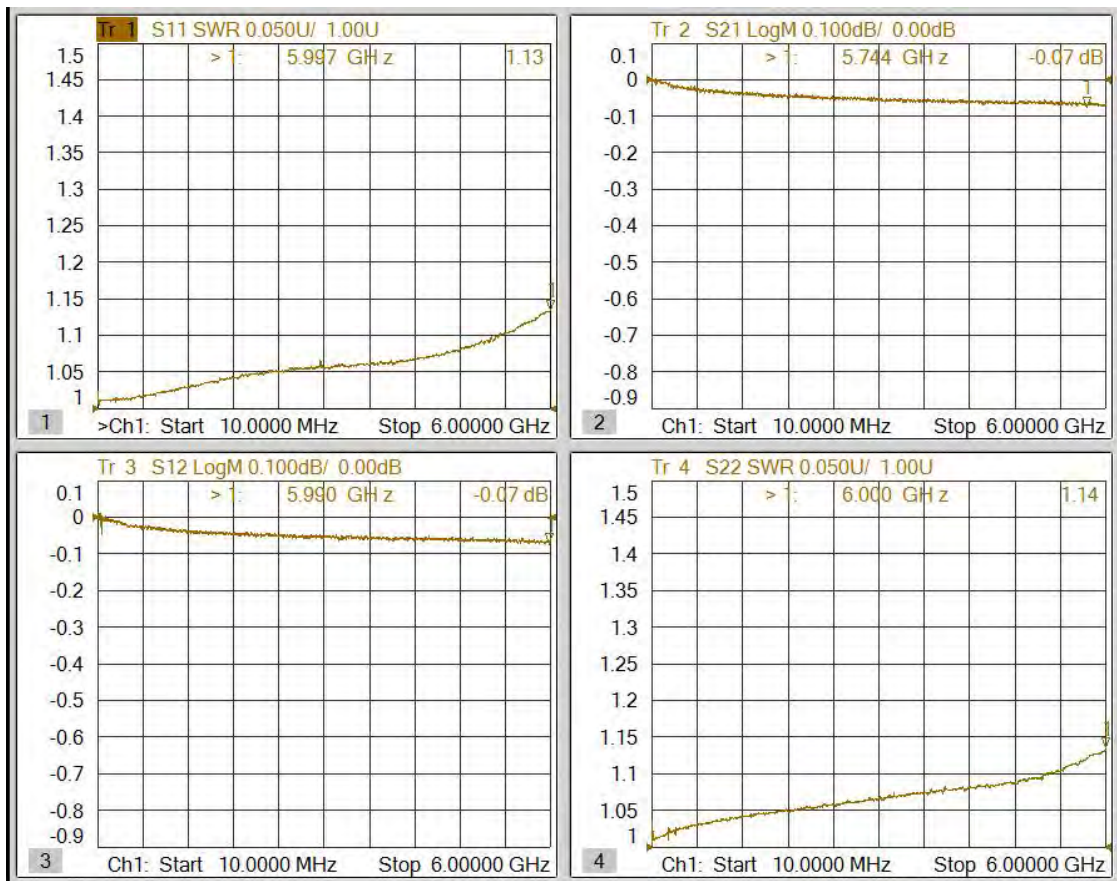

Notes:

1. IL of AD-A8E8+AD-A3E3 measured
2.  $IL/2 = IL$  of AD-A3E3

勝特力電材超市-龍山店 886-3-5773766  
勝特力電材超市-光復店 886-3-5729570  
勝特力電子(上海) 86-21-34970699  
勝特力電子(深圳) 86-755-83298787  
<http://www.100y.com.tw>