

SMA8300L-0085

SMA Jack Solder Bulkhead  
For RG405; 27GHz VSWR 1.2

50Ω

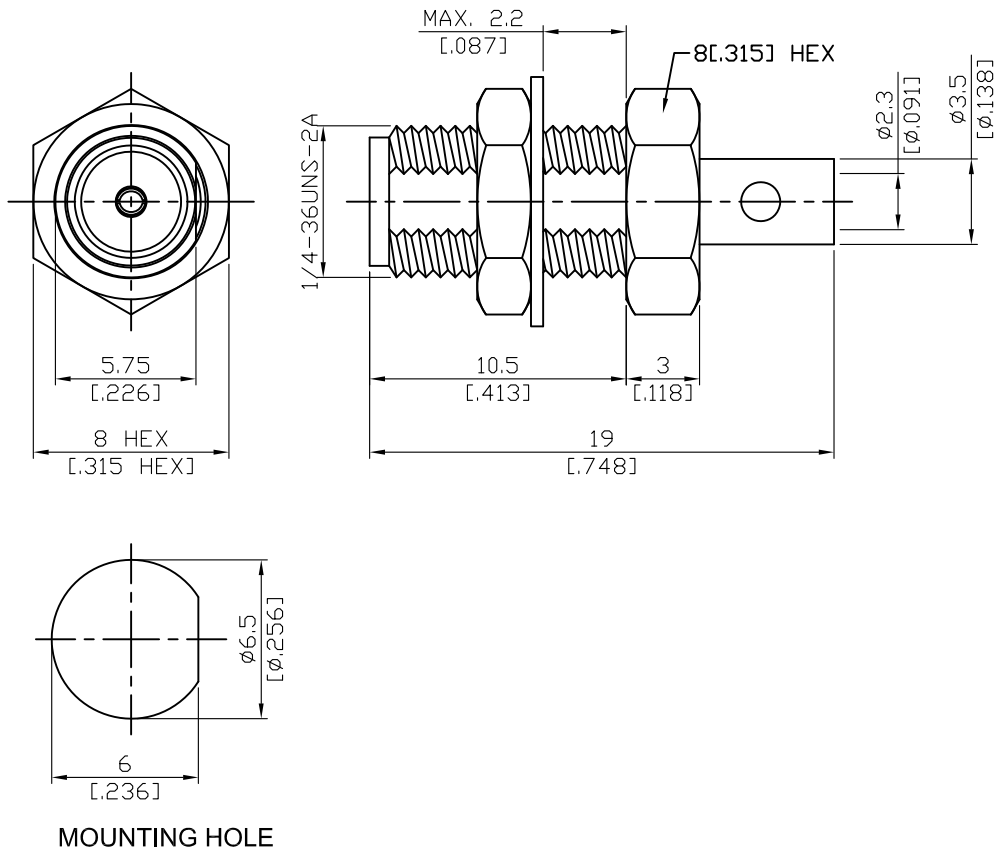

Parts	Material	Plating ( Micro-inch )
Body	Brass	Gold 4 Over Nickel-Phosphorus Alloy 80 Over Copper 20
Insulator	Teflon	
Contact Pin	Beryllium Copper	Gold 4 Over Nickel-Phosphorus Alloy 80 Over Copper 20
Lock Washer	Brass	Gold 4 Over Nickel-Phosphorus Alloy 80 Over Copper 20
Hex Nut	Brass	Gold 4 Over Nickel-Phosphorus Alloy 80 Over Copper 20

Weight: 3.54g  
Suitable Cables: Semi-rigid.085

## SMA

## SMA8300L-0085

## Interface

MIL-STD-348B

Mechanically compatible with

2.92 &amp; 3.5

## Electrical Data

Impedance

50 $\Omega$ 

Frequency range

DC to 27GHz

VSWR

 $\leq 1.2$  (DC to 27GHz)

Insertion loss

 $\leq 0.04 \times \sqrt{f(\text{GHz})}$  dB

Insulation resistance

 $\geq 5000\text{M}\Omega$ 

Contact resistance inner conductor

 $\leq 3\text{m}\Omega$ 

Contact resistance outer conductor

 $\leq 2\text{m}\Omega$ 

Dielectric withstanding voltage (at sea level)

1000 V rms

Working voltage (at sea level)

335 V rms

## Mechanical Data

Recommended coupling nut torque

4 inch lbs

Coupling proof torque

5.3 inch lbs

Contact Captivation-axial

 $\geq 6.1$  lbs

Durability (mating)

 $\geq 100$ 

## Environmental Data

Temperature range

-65°C to +165°C

Thermal shock

MIL-STD-202, Method 107, Condition B

Moisture resistance

MIL-STD-202, Method 106

Corrosion

MIL-STD-202, Method 101, Condition B

RoHS

Compliant

## Tooling

Soldering gauge

ST-0.4

Soldering fixture

ST-008

Locator tool

ST-011

Insert for .085 semi-rigid cable

ST-009

Dielectric insertion tool

ST-004

A

B

C

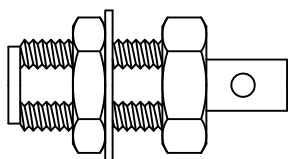

BODY + HEX NUT  
+ LOCK WASHER



CONTACT PIN

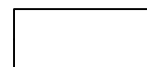

INSULATOR

DIAGRAM

ASSEMBLY INSTRUCTION

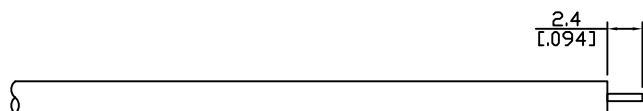

Step 1: STRIP AS SHOWN.

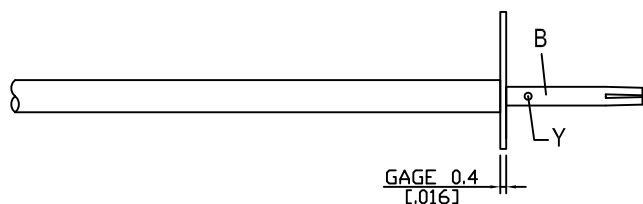

Step 2: PUT 0.4 MM GAGE ST-0.4 IN PLACE, INSERT CABLE'S CENTER CONDUCTOR INTO CENTER PIN " B " AND SOLDER IN " Y ".

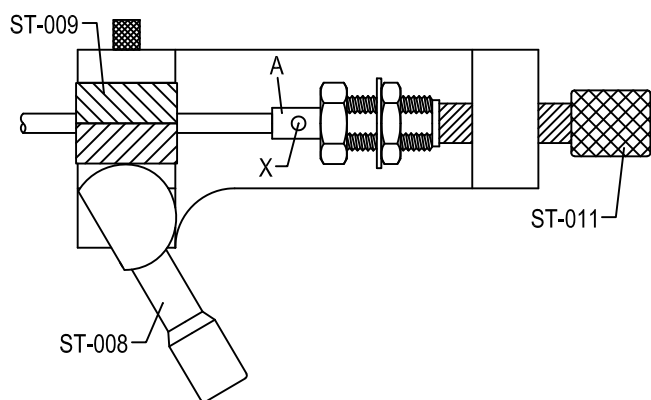

Step 3: USE SOLDERING FIXTURE " ST-008 ", INSERT TOOL " ST-009 " AND LOCATOR TOOL " ST-011 " TO FIX THE CONNECTOR. SOLDER IN " X ".

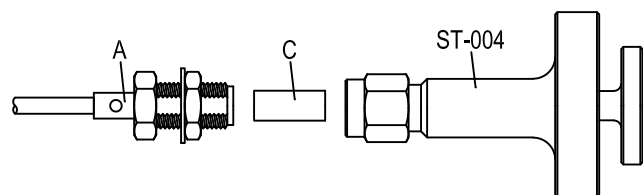

Step4: USE DIELECTRIC INSERTION TOOL " ST-004 " TO INSERT THE TEFLON " C ".

# SMA8300L-0085

S11

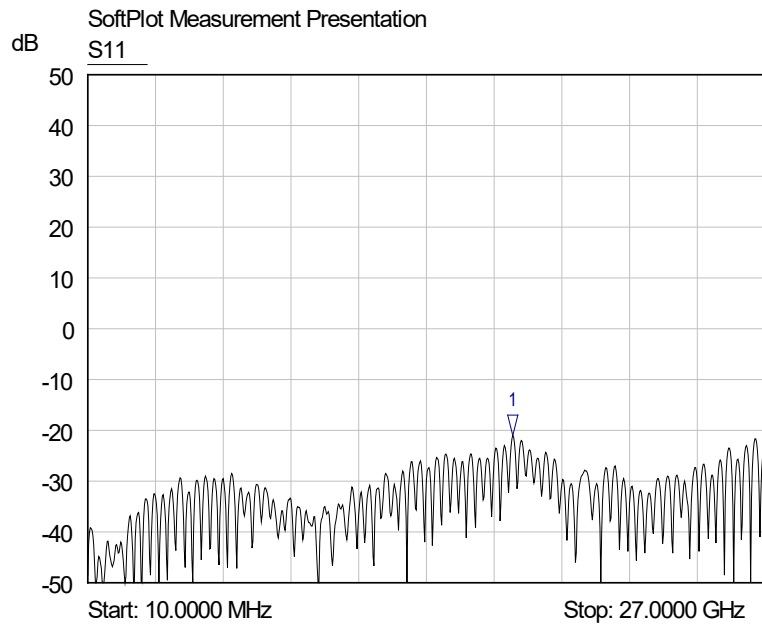

勝特力電材超市-龍山店 886-3-5773766  
勝特力電材超市-光復店 886-3-5729570  
勝特力電子(上海) 86-21-34970699  
勝特力電子(深圳) 86-755-83298787  
<http://www.100y.com.tw>