

3M™ WIREMOUNT PLUG, 4600 SERIES
.100 X .100, LATCH/EJECT CONNECTOR FOR .050" PITCH CABLE

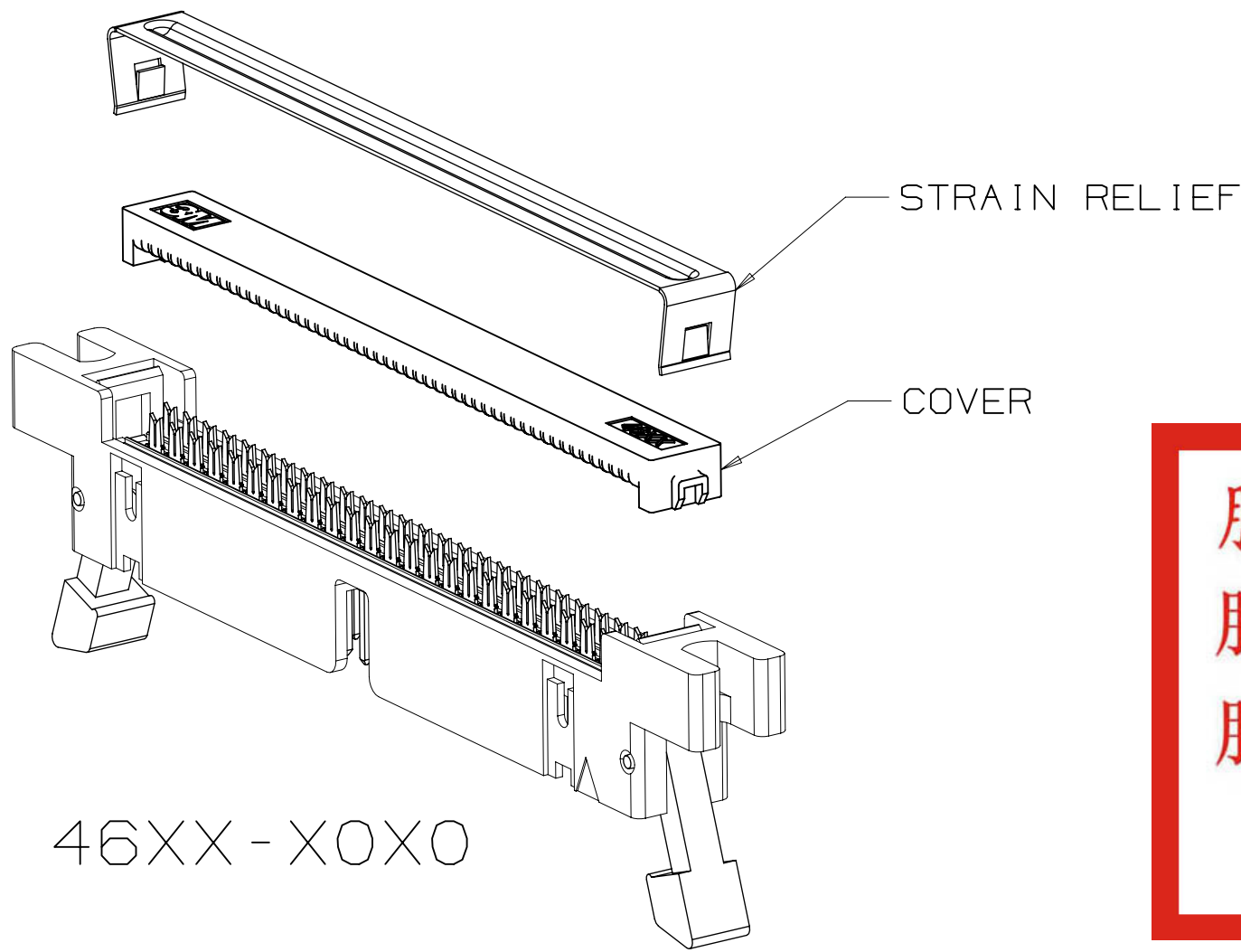

46XX-XOX0

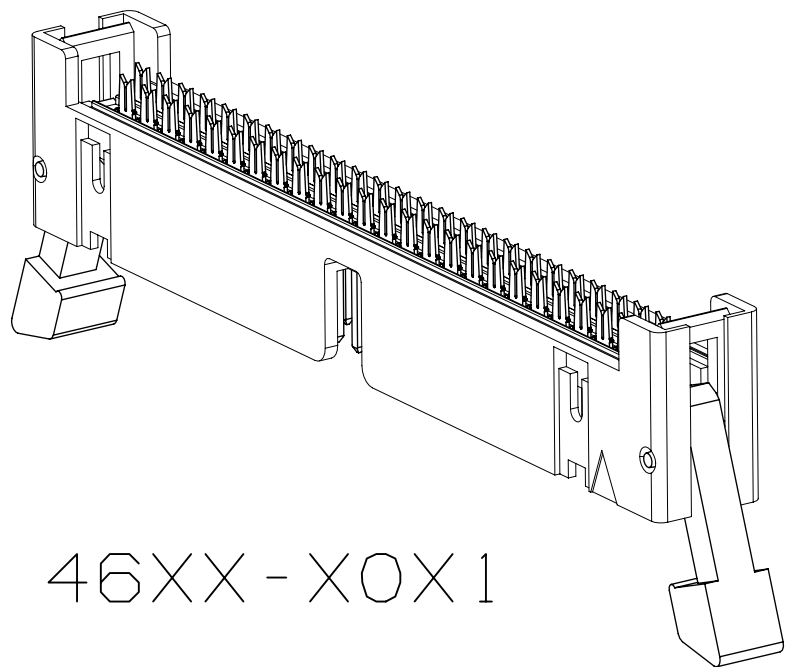

46XX-XOX1

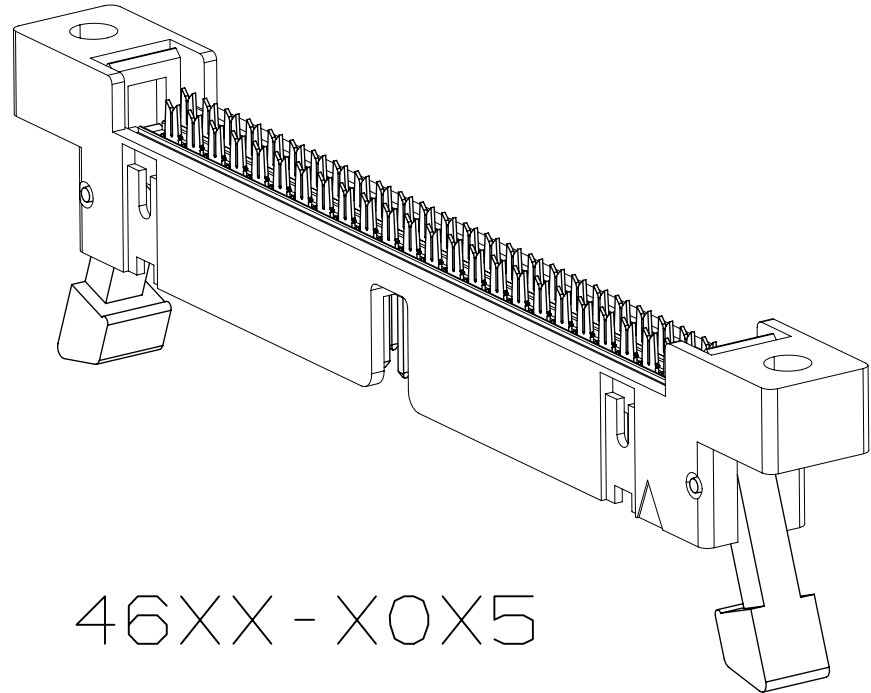

46XX-XOX5

勝特力材料 886-3-5753170
胜特力电子(上海) 86-21-34970699
胜特力电子(深圳) 86-755-83298787
[Http://www.100y.com.tw](http://www.100y.com.tw)

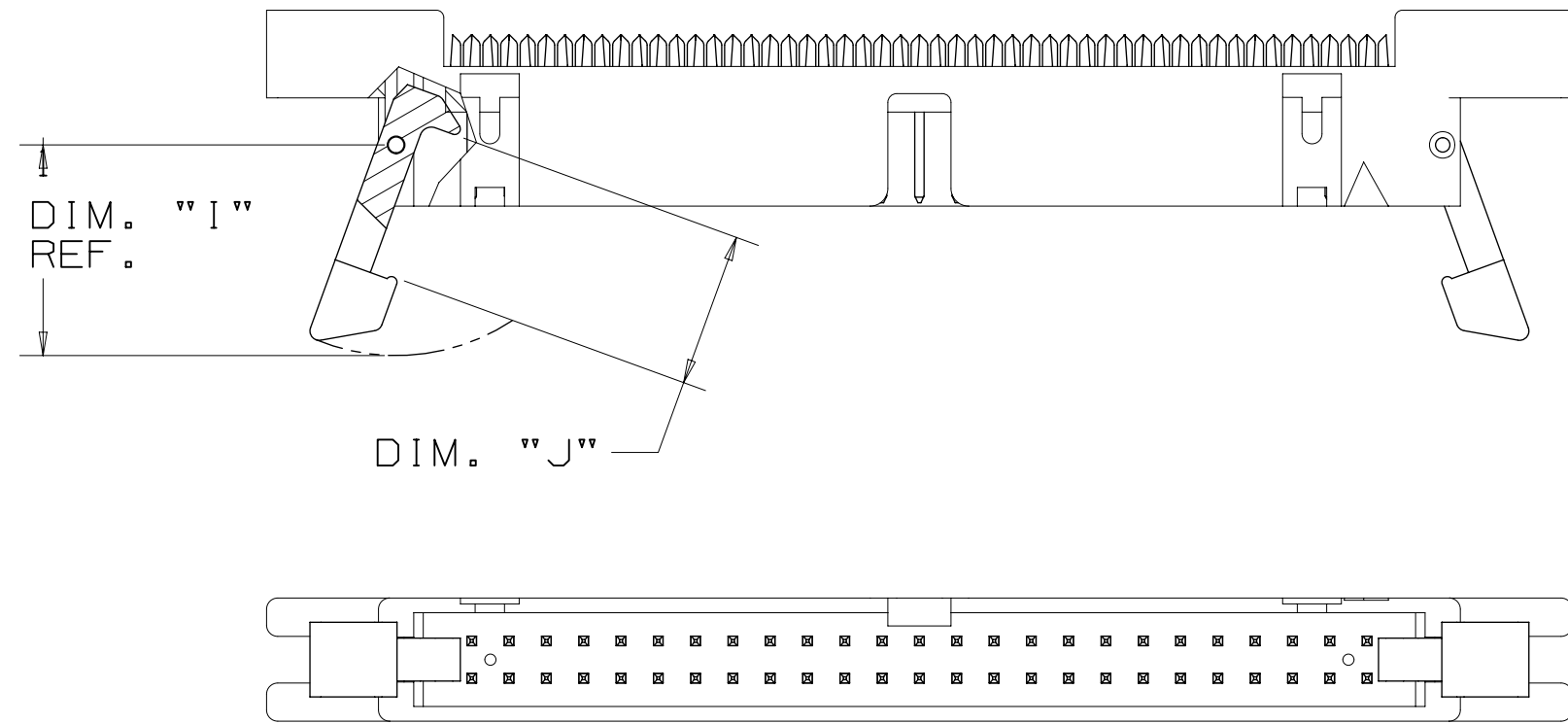

ORDERING INFORMATION

46XX-XXXX

CONTACT QTY: (SEE TABLE 1)

COVER STYLE: 0=OPEN END (DAISY CHAINING/BUSSING STANDARD)
6=OPEN END (DAISY CHAINING/BUSSING STANDARD)
7=CLOSED END (END CABLE TERMINATION)

EJECTOR/LATCH SYSTEM: 0=NONE (STANDARD)
2=SHORT EJECTOR LATCH (3505-16)
3=LONG EJECTOR LATCH (3505-17)

BODY STYLE: 0=W/MOUNTING FLANGE (STANDARD)
1=W/OUT MOUNTING FLANGE
5=MOUNTING FLANGE W/THREADED INSERT FROM SOCKET MATING SIDE

POLARIZATION: 0=FOR CONTACT QTY 14 TO 64
0=FOR NOTCH C ON 10 POSITION
5=FOR NOTCH B ON 10 POSITION

ASSEMBLY TOOLS:
3M™ PRESS 3640 (OR EQUIVALENT),
3M™ LOCATOR PLATE 3443-96,
3M™ PLATTEN 3442-9

STRAIN RELIEF
(ORDER SEPARATELY)
3448-46XX

CONTACT QTY:
(SEE TABLE 1)

3M ELECTRONICS MATERIALS SOLUTIONS DIVISION
INTERCONNECT SOLUTIONS
<http://www.3M.com/interconnect>

3M IS A TRADEMARK OF 3M COMPANY.
FOR TECHNICAL, SALES OR ORDERING
INFORMATION CALL 800-225-5373

UL
UL FILE NO: E68080

PERFORMANCE:	
CURRENT RATING:	1.50 A, ALL CONTACTS POWERED 2.25 A, 6 CONTACTS POWERED 5.50 A, 1 CONTACT POWERED (RATING CONDITIONS: EIA-364-070, METHOD 2, 30°C MAXIMUM TEMPERATURE RISE)
UL & CUL VOLTAGE RATING:	125V _{ac}
INSULATION RESISTANCE:	> 1 × 10 ⁹ Ohms AT 500 VDC
WITHSTANDING VOLTAGE:	1000 VACrms AT SEA LEVEL
OPERATING TEMPERATURE:	-55° C TO +105° C

AGENCY LISTINGS:
UNDERWIRTERS LABORATORIES (UL): FILE No. E68080
UL RATINGS TEMPERATURE: 130° C VOLTAGE: 125V CURRENT: 1.0A
CUL RATINGS TEMPERATURE: 130° C VOLTAGE: 125V CURRENT: 1.0A

PHYSICAL:

INSULATOR: MATERIAL: GLASS FILLED POLYESTER (PBT)
FLAMMABILITY: UL94V-0
COLOR: GRAY
CONTACT: MATERIAL: COPPER ALLOY
PLATING:
UNDER PLATING: 100μ" [2.54μm] NICKEL-OVERALL
"U" SLOT: GOLD FLASH
WIPING AREA: 30μ" [0.76μm] GOLD
WIRE ACCOMMODATION: 26 AND 28 AWG SOLID AND STRANDED
MARKINGS: 3M LOGO AND LOT NUMBER

- NOTES
- REGULATORY INFORMATION:
VISIT 3M.com/regs
 - IN THE EVENT OF CONFLICT
BETWEEN THIS DATA AND THAT
CONTAINED IN THE PRODUCT
SPECIFICATION, THE PRODUCT
SPECIFICATION TAKES PRECEDENT.

DIMENSIONS: INCH [MM]
[MM] FOR REF. ONLY

DESIGN REFERENCE		NEXT ASSEMBLY		REV	ECO	ISSUE DATE AND DESCRIPTION		DRFT	CHKD
XREF CODES		DIVISION CODE		CHKD	DATE	DATE	DATE	DATE	DATE
DO NOT SCALE DRAWING		SCALE		TOLERANCES EXCEPT AS NOTED		INCHES		MILLIMETERS	
THIRD ANGLE PROJECTION		INTERPRET PER ASME Y14.5 - 2018		MAX SURFACE ROUGHNESS		SURFACES		MARKED ONLY	
CAGE NUMBER		SIZE		DRAWING NO.		REV.		DET	
MODEL		4600		78-5100-0086-8		E		SHT 1 OF 4	

3M™ WIREMOUNT PLUG, 4600 SERIES
.100 X .100, LATCH/EJECT CONNECTOR FOR .050" PITCH CABLE

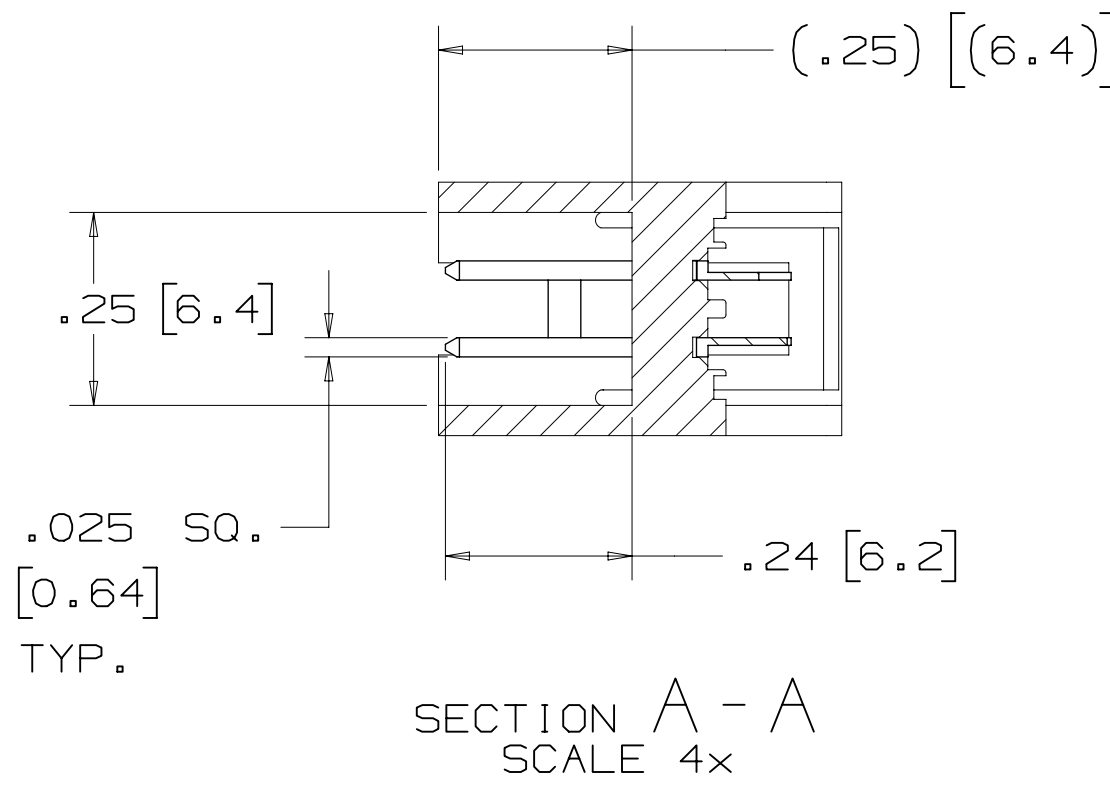
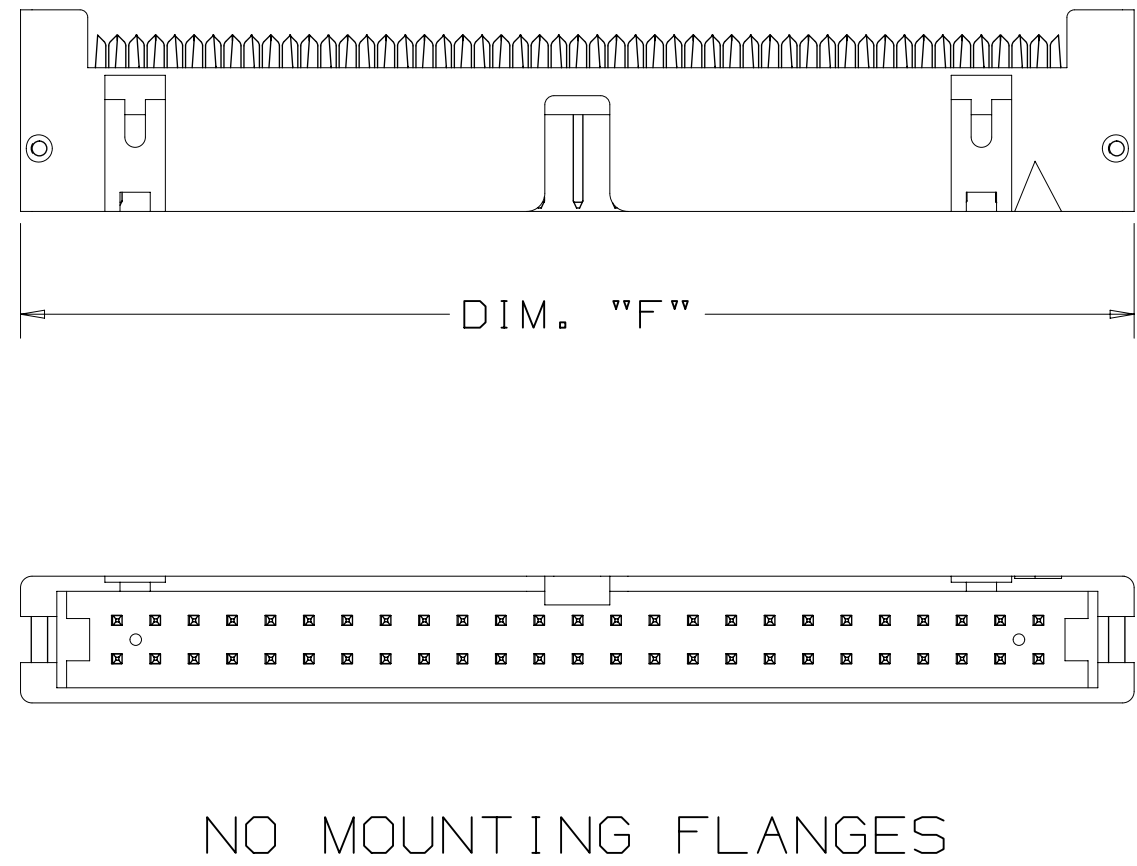
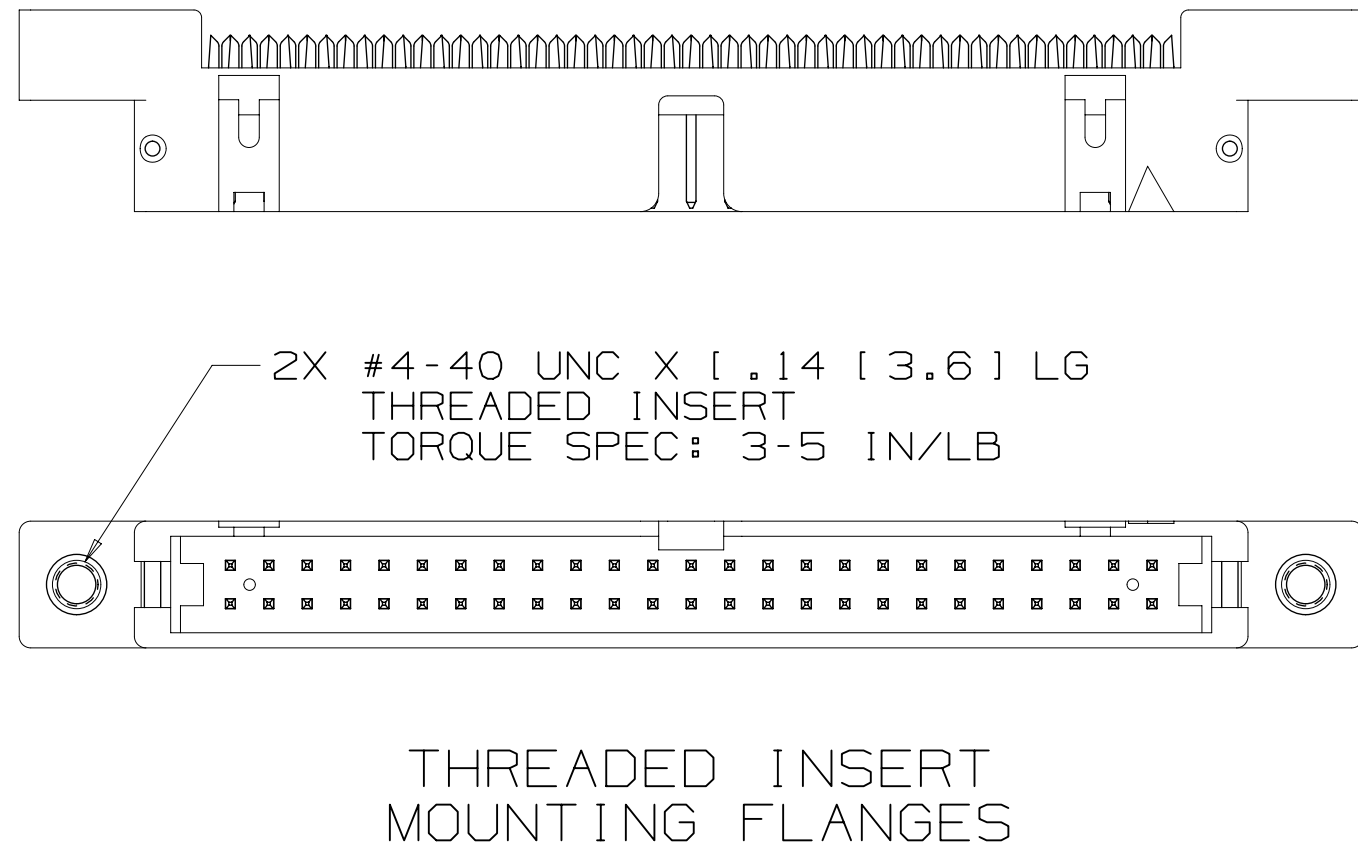
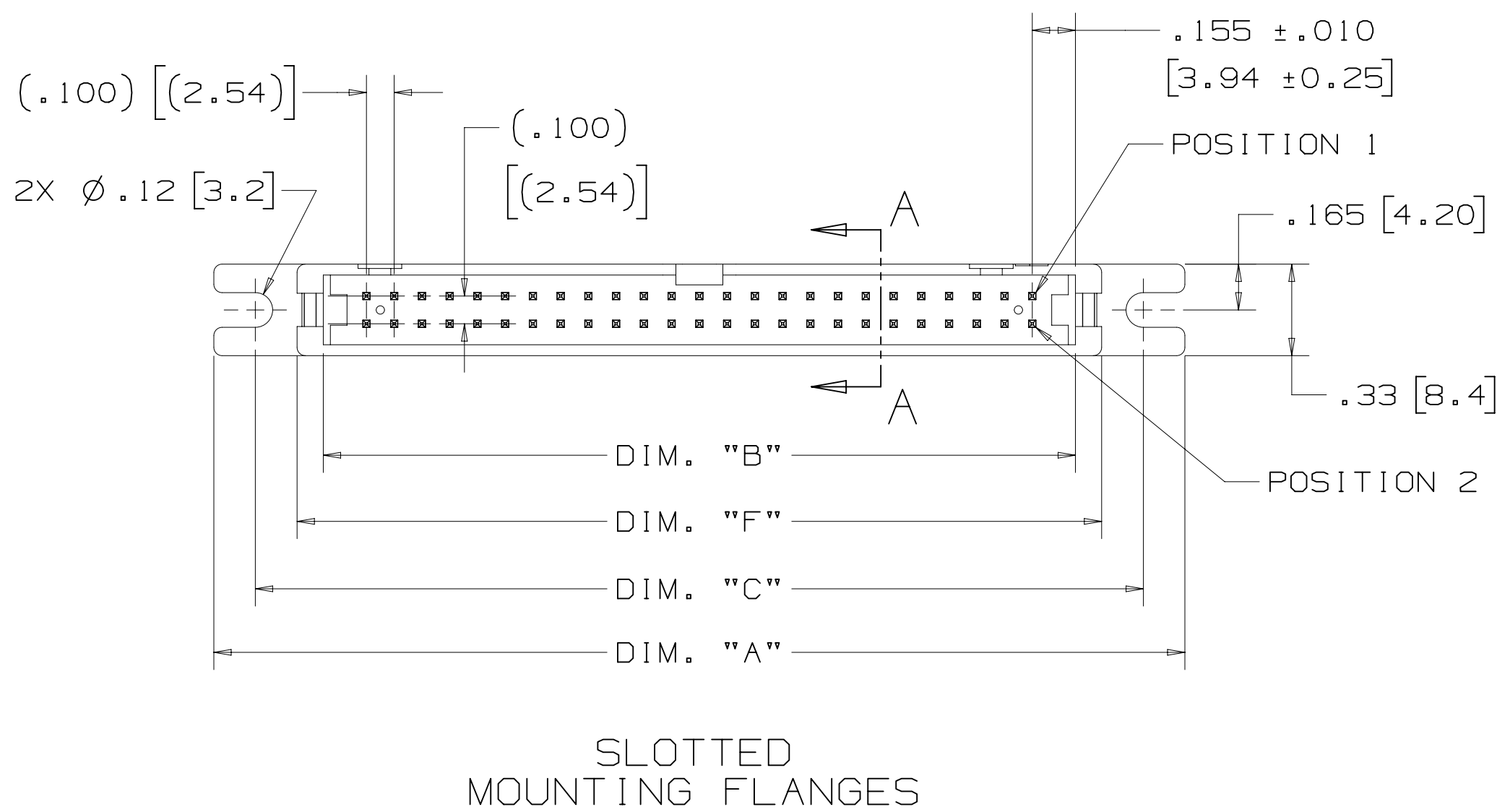
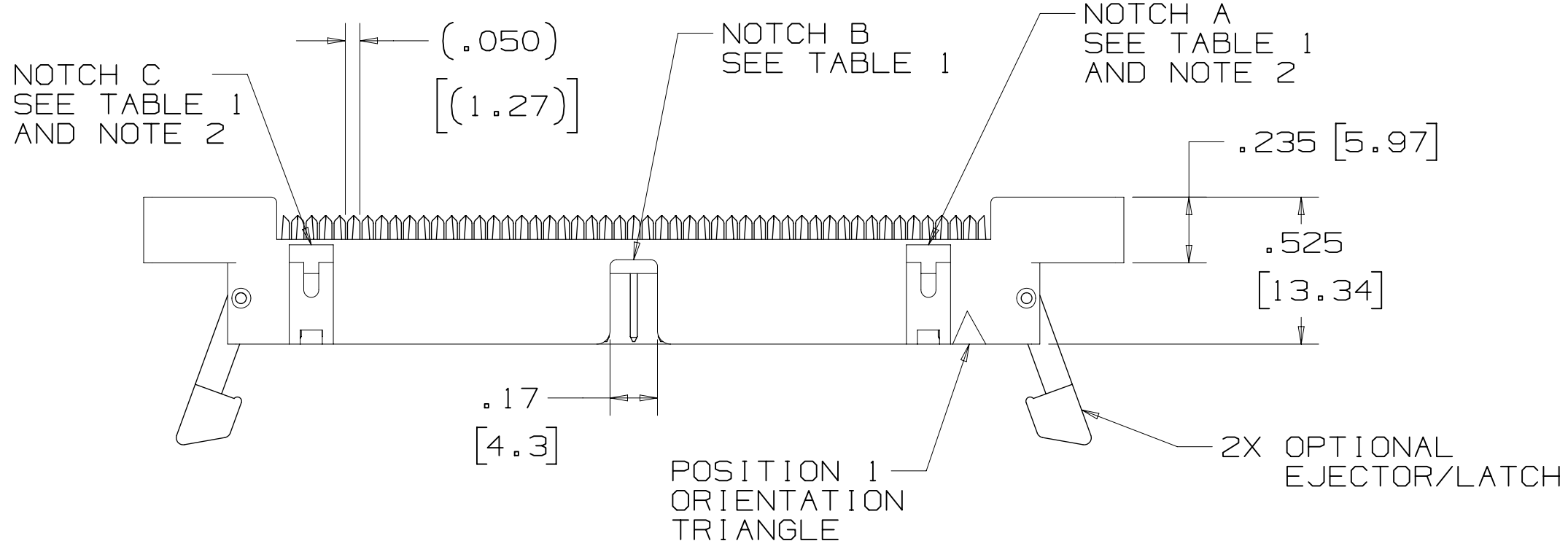
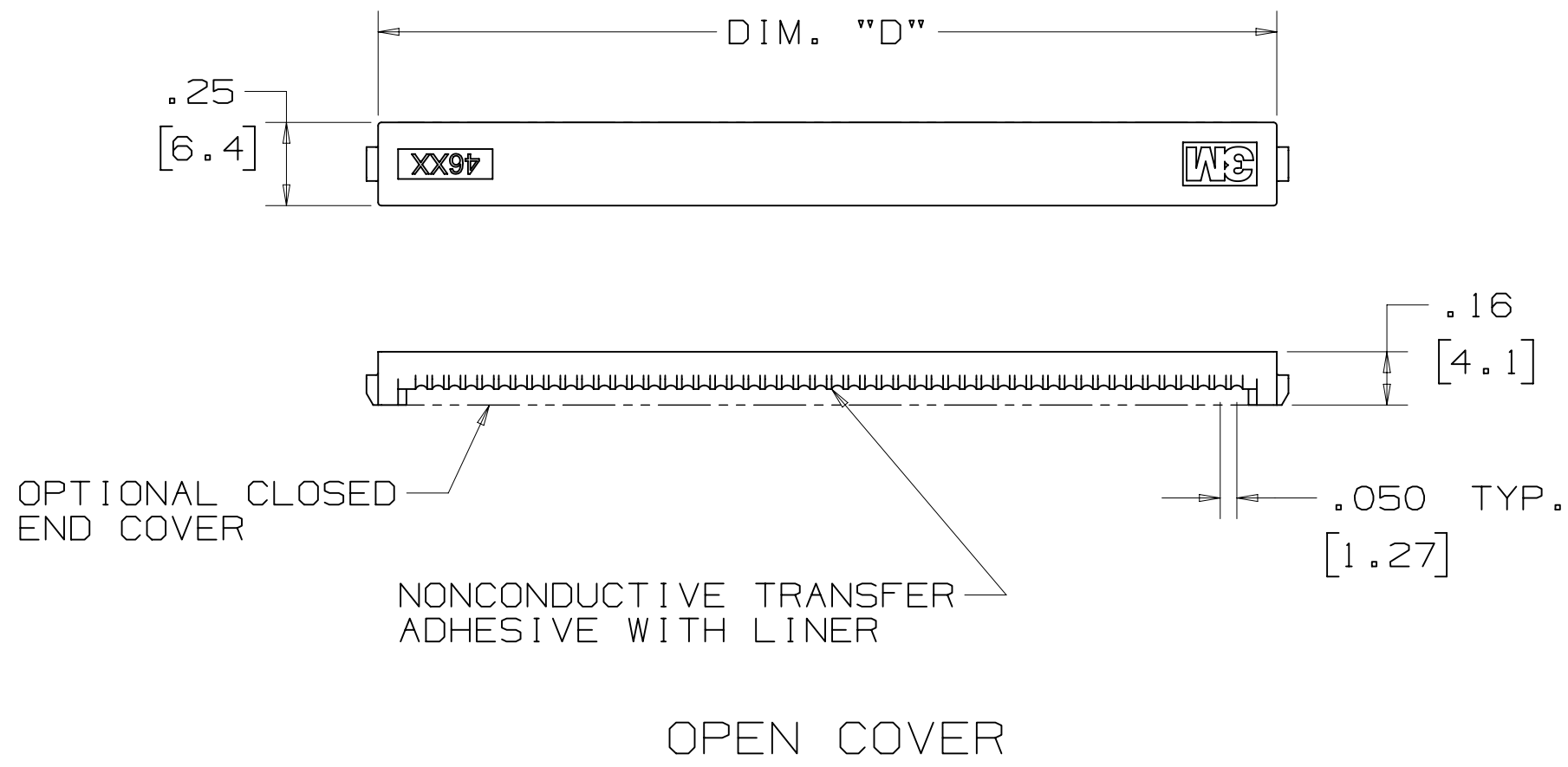

- NOTES
- 1 POLARIZATION OF 10 POSITION PRODUCT CAN BE EITHER:
- CENTER NOTCH B: 4610-XX5X
- NOTCH C: 4610-XX0X.
 - 2 NOTCHES A AND C WILL ACCOMMODATE 3M POLARIZATION KEY PART NO. 3518.

勝特力材料 886-3-5753170
胜特力电子(上海) 86-21-34970699
胜特力电子(深圳) 86-755-83298787
[Http://www.100y.com.tw](http://www.100y.com.tw)

3M ELECTRONICS MATERIALS SOLUTIONS DIVISION
INTERCONNECT SOLUTIONS
<http://www.3M.com/interconnect>

3M IS A TRADEMARK OF 3M COMPANY.
FOR TECHNICAL, SALES OR ORDERING
INFORMATION CALL 800-225-5373

DESIGN REFERENCE	NEXT ASSEMBLY	REV	ECO	ISSUE DATE AND DESCRIPTION	DRFT	CHKD
XXXXX	XXXXX	1	ECO	APR 08, 2021 ADD U-SLOT GOLD FLASH NOTE	JNC	SAN
DIVISION	DIVISION CODE	DRW	CHKD	DATE	DATE	DATE
DO NOT SCALE DRAWING	SCALE	EMSD	CASTIGLIONE	FEB 10, 2021	MFG	DATE
THIRD ANGLE PROJECTION	TOLERANCES EXCEPT AS NOTED	APPR	S. NEU	FEB 10, 2021	DATE	DATE
INTERPRET PER ASME Y14.5 - 2018	INCHES	0.0 ±.1	0.00 ±.01	0.000 ±.005	0.0000 ±.0002	0.0 ±.1
MAX SURFACE ROUGHNESS	MILLIMETERS	0.0 ±.1	0.00 ±.01	0.000 ±.005	0.0000 ±.0002	0.0 ±.1
MARKED ONLY	ANGLES	0.0 ±.1	0.00 ±.01	0.000 ±.005	0.0000 ±.0002	0.0 ±.1
CAGE NUMBER	SIZE	DRAWING NO.	REV.	DATE	DATE	DATE
D	78-5100-0086-8	E	DATE	DATE	DATE	DATE
MODEL	4600	LISTS	YES	NO	SHT	2 OF 4

3M™ WIREMOUNT PLUG, 4600 SERIES
.100 X .100, LATCH/EJECT CONNECTOR FOR .050" PITCH CABLE

TABLE 1							
DIMENSIONS							
PIN QTY.	DIM. "A"	DIM. "B"	DIM. "C"	DIM. "D"	DIM. "E"	DIM. "F"	POLARIZING NOTCHES PROVIDED
10	1.50 [38.1]	.71 [18.0]	1.20 [30.5]	.77 [19.6]	.85 [21.6]	.90 [22.9]	B OR C (SEE NOTE 3)
14	1.70 [43.2]	.91 [23.1]	1.40 [35.6]	.97 [24.6]	1.05 [26.7]	1.10 [27.9]	B, C
16	1.80 [45.7]	1.01 [25.7]	1.50 [38.1]	1.07 [27.2]	1.15 [29.2]	1.20 [30.5]	A, B, C
20	2.00 [50.8]	1.21 [30.7]	1.70 [43.2]	1.27 [32.3]	1.35 [34.3]	1.40 [35.6]	A, B, C
24	2.20 [55.9]	1.41 [35.8]	1.90 [48.3]	1.47 [37.3]	1.55 [41.9]	1.60 [40.6]	A, B, C
26	2.30 [58.4]	1.51 [38.4]	2.00 [50.8]	1.57 [39.9]	1.65 [46.9]	1.70 [43.2]	A, B, C
30	2.50 [63.5]	1.71 [43.4]	2.20 [55.9]	1.77 [45.0]	1.85 [47.1]	1.90 [48.3]	A, B, C
34	2.70 [68.6]	1.91 [48.5]	2.40 [61.0]	1.97 [50.0]	2.05 [52.1]	2.10 [53.3]	A, B, C
36	2.80 [71.1]	2.01 [51.1]	2.50 [63.5]	2.07 [52.6]	2.15 [54.6]	2.20 [55.9]	A, B, C
40	3.00 [76.2]	2.21 [56.1]	2.70 [68.6]	2.27 [57.7]	2.35 [59.7]	2.40 [61.0]	A, B, C
50	3.50 [88.9]	2.71 [68.8]	3.20 [81.3]	2.77 [70.4]	2.85 [72.4]	2.90 [73.7]	A, B, C
60	4.00 [101.6]	3.21 [81.5]	3.70 [94.0]	3.27 [83.1]	3.35 [85.1]	3.40 [86.4]	A, B, C
64	4.20 [106.7]	3.41 [86.6]	3.90 [99.1]	3.47 [88.1]	3.55 [90.2]	3.60 [91.4]	A, B, C

EJECTOR/LATCH

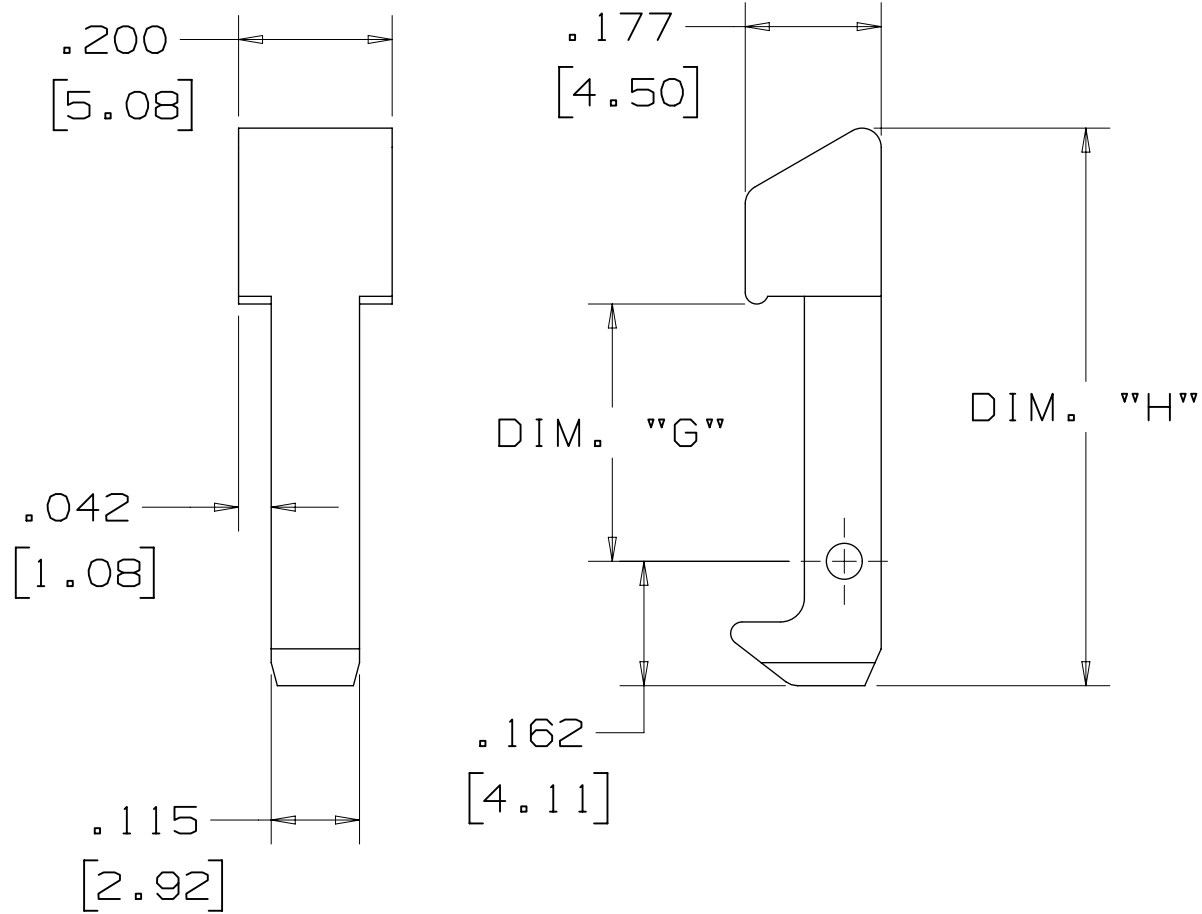

TABLE 2							
DIMENSIONS							
EJECTOR/LATCH OPTION	PART NUMBER	DIM. "G"	DIM. "H"	DIM. "I"	DIM. "J"	MATERIAL	COLOR
SHORT	3505-16	.335 [8.51]	.726 [18.44]	.92 [23.4]	.41 [10.4]	PBT	GRAY
LONG	3505-17	.484 [12.29]	.875 [22.23]	1.07 [27.2]	.56 [14.2]		

3M ELECTRONICS MATERIALS SOLUTIONS DIVISION
INTERCONNECT SOLUTIONS
<http://www.3M.com/interconnect>

3M IS A TRADEMARK OF 3M COMPANY.
FOR TECHNICAL, SALES OR ORDERING
INFORMATION CALL 800-225-5373



POLARIZING KEY
3M PART NO: 3518
(ORDER SEPARATELY)

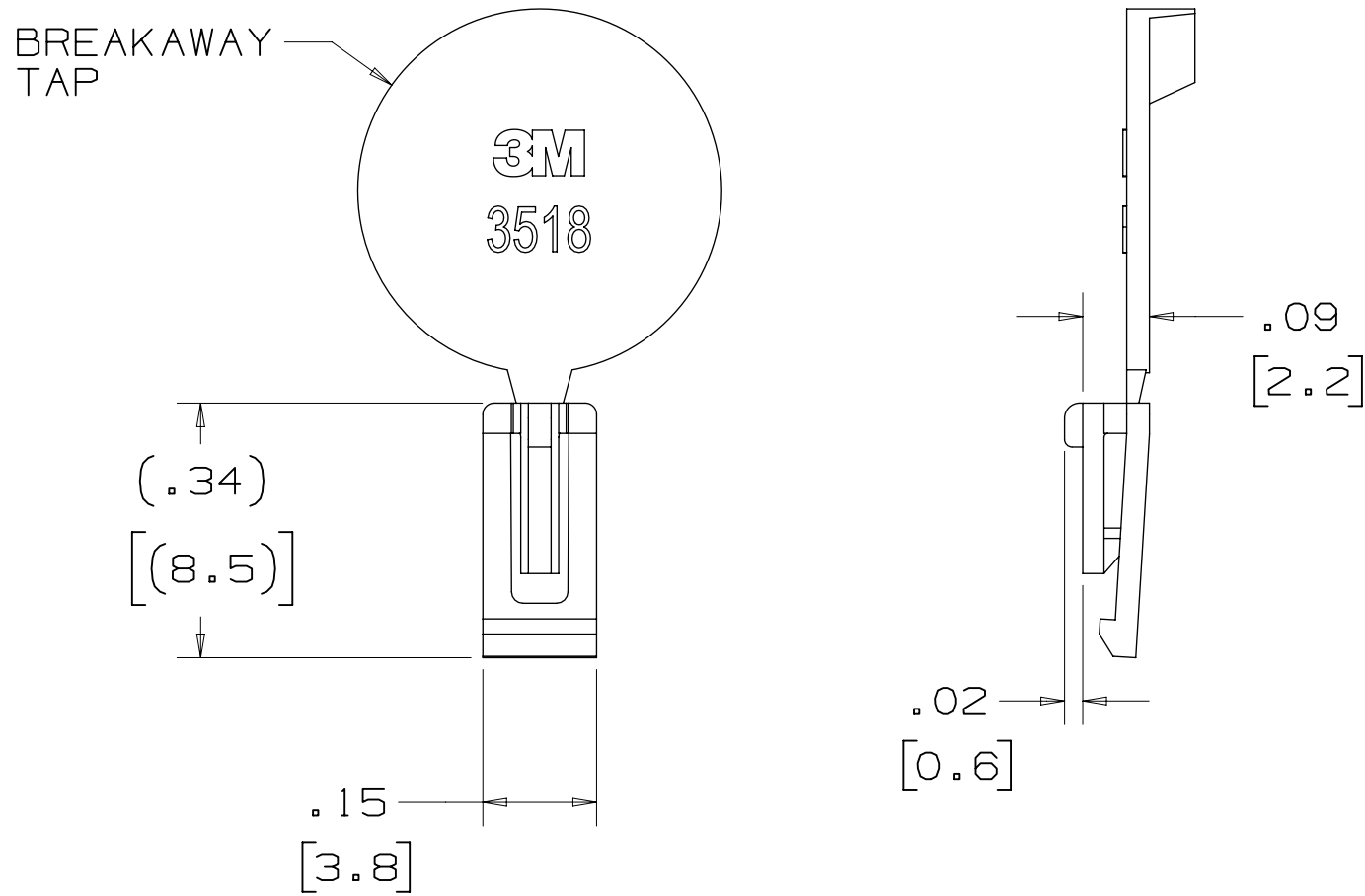

3M PART NO.	MATERIAL	COLOR
N3518	LCP	BLACK

- NOTES
- 1 MATERIAL: .012 [0.30] THK STAINLESS STEEL.
 - 2 THE DISTANCE FROM THE STRAIN RELIEF TO THE CONNECTOR IS EQUAL TO .04 [1.0] PLUS THE CABLE THICKNESS.
 - 3 POLARIZATION OF 10 POSITION PRODUCT CAN BE EITHER:
- CENTER NOTCH B: 4610-XX5X
- NOTCH C: 4610-XX0X.

勝特力材料 886-3-5753170
胜特力电子(上海) 86-21-34970699
胜特力电子(深圳) 86-755-83298787
[Http://www.100y.com.tw](http://www.100y.com.tw)

DESIGN REFERENCE		NEXT ASSEMBLY		REV	ECO	ISSUE DATE AND DESCRIPTION		DRFT	CHKD
XREF CODES		DIVISION CODE		CHKD	DATE	DATE	DATE	DATE	DATE
DIVISION		EMSD		CHKD	DATE	DATE	DATE	DATE	DATE
DO NOT SCALE DRAWING		SCALE 4/1		TOLERANCES EXCEPT AS NOTED		© 3M COPYRIGHT 2021			
THIRD ANGLE PROJECTION		INTERPRET PER ASME Y14.5 - 2018		INCHES .00 ± .01 .000 ± .0005 .0000 ± .0002		This document and the information it contains are 3M property and may not be reproduced or further distributed without 3M permission, or used or disclosed other than for 3M authorized purposes. All rights reserved.			
MAX SURFACE ROUGHNESS		MILLIMETERS 0 ± .00 .00 ± .000		TITILE		WIREMOUNT PLUG CONN., LATCH/EJECT, .100 X .100			
MARKED ONLY		ANGLES		CAGE NUMBER		DRAWING NO.		REV.	
				D		78-5100-0086-8		E	
				MODEL		4600		SHT 3 OF 4	

3M™ WIREMOUNT PLUG, 4600 SERIES
.100 X .100, LATCH/EJECT CONNECTOR FOR .050" PITCH CABLE

TABLE 3			
PIN QTY.	PART NUMBER	DIM. "A"	DIM. "B"
10	4610	1.200 [30.48]	.945 [24.00]
14	4614	1.400 [35.56]	1.145 [29.08]
16	4616	1.500 [38.10]	1.245 [31.62]
20	4620	1.700 [43.18]	1.445 [36.70]
24	4624	1.900 [48.26]	1.645 [41.78]
26	4626	2.00 [50.80]	1.745 [44.32]
30	4630	2.200 [55.88]	1.945 [49.40]
34	4634	2.400 [60.96]	2.145 [54.48]
36	4636	2.500 [63.50]	2.245 [57.02]
40	4640	2.700 [68.58]	2.445 [62.10]
50	4650	3.200 [81.28]	2.945 [74.80]
60	4660	3.700 [93.98]	3.445 [87.50]
64	4664	3.900 [99.06]	3.645 [92.58]

Regulatory: For regulatory information about this product, visit 3M.com/regs or contact your 3M representative.

Technical Information: The technical information, recommendations and other statements contained in this document are based upon tests or experience that 3M believes are reliable, but the accuracy or completeness of such information is not guaranteed.

Product Use: Many factors beyond 3M's control and uniquely within user's control can affect the use and performance of a 3M product in a particular application. Given the variety of factors that can affect the use and performance of a 3M product, user is solely responsible for evaluating the 3M product and determining whether it is fit for a particular purpose and suitable for user's method of application.

Warranty, Limited Remedy, and Disclaimer: Unless an additional warranty is specifically stated on the applicable 3M product packaging or product literature, 3M warrants that each 3M product meets the applicable 3M product specification at the time 3M ships the product. 3M MAKES NO OTHER WARRANTIES OR CONDITIONS, EXPRESS OR IMPLIED, INCLUDING, BUT NOT LIMITED TO, ANY IMPLIED WARRANTY OR CONDITION OF MERCHANTABILITY OR FITNESS FOR A PARTICULAR PURPOSE OR ANY IMPLIED WARRANTY OR CONDITION ARISING OUT OF A COURSE OF DEALING, CUSTOM OR USAGE OR TRADE. If the 3M product does not conform to this warranty, then the sole and exclusive remedy is, at 3M's option, replacement of the 3M product or refund of the purchase price.

Limitation of Liability: Except where prohibited by law, 3M will not be liable for any loss or damage arising from the 3M product, whether direct, indirect, special, incidental or consequential, regardless of the legal theory asserted, including warranty, contract, negligence or strict liability.

3M Company
Electronics Materials Solutions Division
13011 McCallen Pass, Bldg. C
Austin, TX 78753-5380
1-800-225-5373
www.3M.com/interconnect

- NOTES
- 1

ACCEPTS #4 PAN HEAD MACHINE SCREW.
- 2

FOR A REAR MOUNT PLUG CONNECTOR WITH EJECTOR/LATCHES, THE RECOMMENDED MAXIMUM PANEL THICKNESS IS .125 [3.18].
- 3

WITHOUT POLARIZING KEYS .340[8.64].

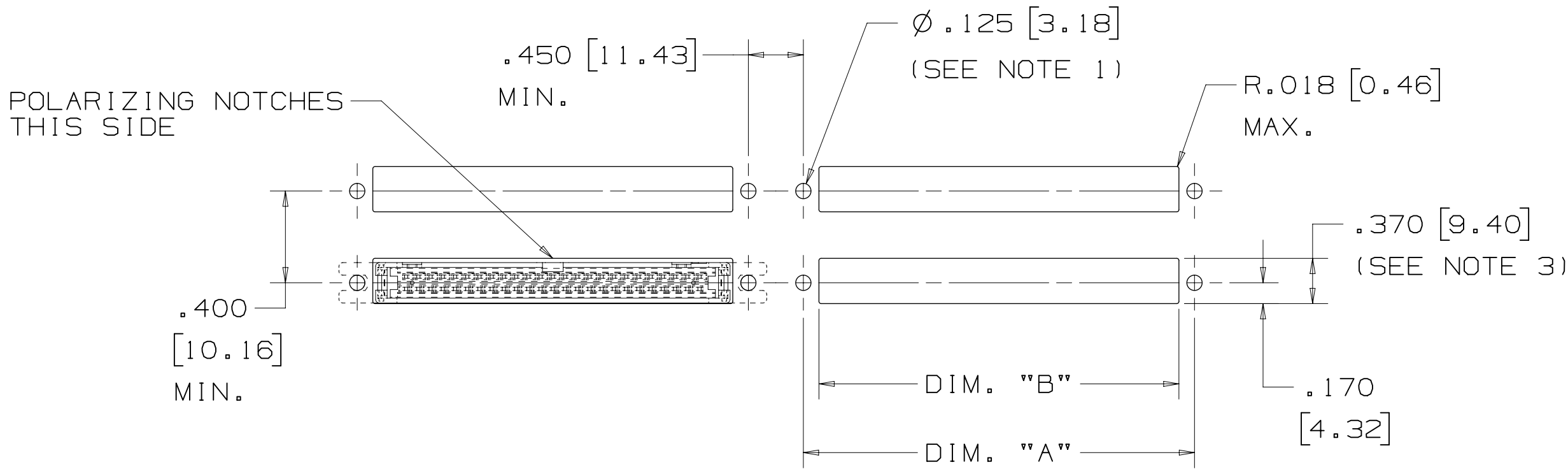

REAR MOUNT PANEL CUT-OUT

勝特力材料 886-3-5753170
胜特力电子(上海) 86-21-34970699
胜特力电子(深圳) 86-755-83298787
Http://www.100y.com.tw

3M ELECTRONICS MATERIALS SOLUTIONS DIVISION
INTERCONNECT SOLUTIONS
http://www.3M.com/interconnect

3M IS A TRADEMARK OF 3M COMPANY.
FOR TECHNICAL, SALES OR ORDERING
INFORMATION CALL 800-225-5373

DESIGN REFERENCE		NEXT ASSEMBLY		
REV	ECO	ISSUE DATE AND DESCRIPTION	DRFT	CHKD
1	0	FEB 10, 2021		
2	0	FEB 10, 2021		
3	0	FEB 10, 2021		
4	0	FEB 10, 2021		
5	0	FEB 10, 2021		
6	0	FEB 10, 2021		
7	0	FEB 10, 2021		
8	0	FEB 10, 2021		
9	0	FEB 10, 2021		
10	0	FEB 10, 2021		
11	0	FEB 10, 2021		
12	0	FEB 10, 2021		
13	0	FEB 10, 2021		
14	0	FEB 10, 2021		
15	0	FEB 10, 2021		
16	0	FEB 10, 2021		
17	0	FEB 10, 2021		
18	0	FEB 10, 2021		
19	0	FEB 10, 2021		
20	0	FEB 10, 2021		
21	0	FEB 10, 2021		
22	0	FEB 10, 2021		
23	0	FEB 10, 2021		
24	0	FEB 10, 2021		
25	0	FEB 10, 2021		
26	0	FEB 10, 2021		
27	0	FEB 10, 2021		
28	0	FEB 10, 2021		
29	0	FEB 10, 2021		
30	0	FEB 10, 2021		
31	0	FEB 10, 2021		
32	0	FEB 10, 2021		
33	0	FEB 10, 2021		
34	0	FEB 10, 2021		
35	0	FEB 10, 2021		
36	0	FEB 10, 2021		
37	0	FEB 10, 2021		
38	0	FEB 10, 2021		
39	0	FEB 10, 2021		
40	0	FEB 10, 2021		
41	0	FEB 10, 2021		
42	0	FEB 10, 2021		
43	0	FEB 10, 2021		
44	0	FEB 10, 2021		
45	0	FEB 10, 2021		
46	0	FEB 10, 2021		
47	0	FEB 10, 2021		
48	0	FEB 10, 2021		
49	0	FEB 10, 2021		
50	0	FEB 10, 2021		
51	0	FEB 10, 2021		
52	0	FEB 10, 2021		
53	0	FEB 10, 2021		
54	0	FEB 10, 2021		
55	0	FEB 10, 2021		
56	0	FEB 10, 2021		
57	0	FEB 10, 2021		
58	0	FEB 10, 2021		
59	0	FEB 10, 2021		
60	0	FEB 10, 2021		
61	0	FEB 10, 2021		
62	0	FEB 10, 2021		
63	0	FEB 10, 2021		
64	0	FEB 10, 2021		
65	0	FEB 10, 2021		
66	0	FEB 10, 2021		
67	0	FEB 10, 2021		
68	0	FEB 10, 2021		
69	0	FEB 10, 2021		
70	0	FEB 10, 2021		
71	0	FEB 10, 2021		
72	0	FEB 10, 2021		
73	0	FEB 10, 2021		
74	0	FEB 10, 2021		
75	0	FEB 10, 2021		
76	0	FEB 10, 2021		
77	0	FEB 10, 2021		
78	0	FEB 10, 2021		
79	0	FEB 10, 2021		
80	0	FEB 10, 2021		
81	0	FEB 10, 2021		
82	0	FEB 10, 2021		
83	0	FEB 10, 2021		
84	0	FEB 10, 2021		
85	0	FEB 10, 2021		
86	0	FEB 10, 2021		
87	0	FEB 10, 2021		
88	0	FEB 10, 2021		
89	0	FEB 10, 2021		
90	0	FEB 10, 2021		
91	0	FEB 10, 2021		
92	0	FEB 10, 2021		
93	0	FEB 10, 2021		
94	0	FEB 10, 2021		
95	0	FEB 10, 2021		
96	0	FEB 10, 2021		
97	0	FEB 10, 2021		
98	0	FEB 10, 2021		
99	0	FEB 10, 2021		
100	0	FEB 10, 2021		