

THIS DRAWING IS UNPUBLISHED. RELEASED FOR PUBLICATION
 © COPYRIGHT - By - ALL RIGHTS RESERVED.

LOC	DIST	REVISIONS			
P	LTR	DESCRIPTION	DATE	OWN	APVD
FT	0	J1	REVISED PER ECO-11-004587	11MAR11	RK HMR

勝特力材料 886-3-5753170
 勝特力电子(上海) 86-21-34970699
 勝特力电子(深圳) 86-755-83298787
 Http://www.100y.com.tw

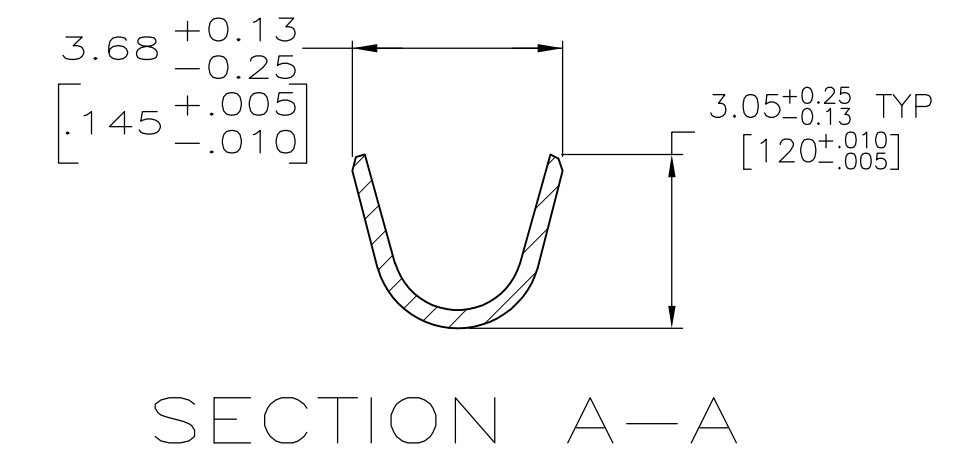
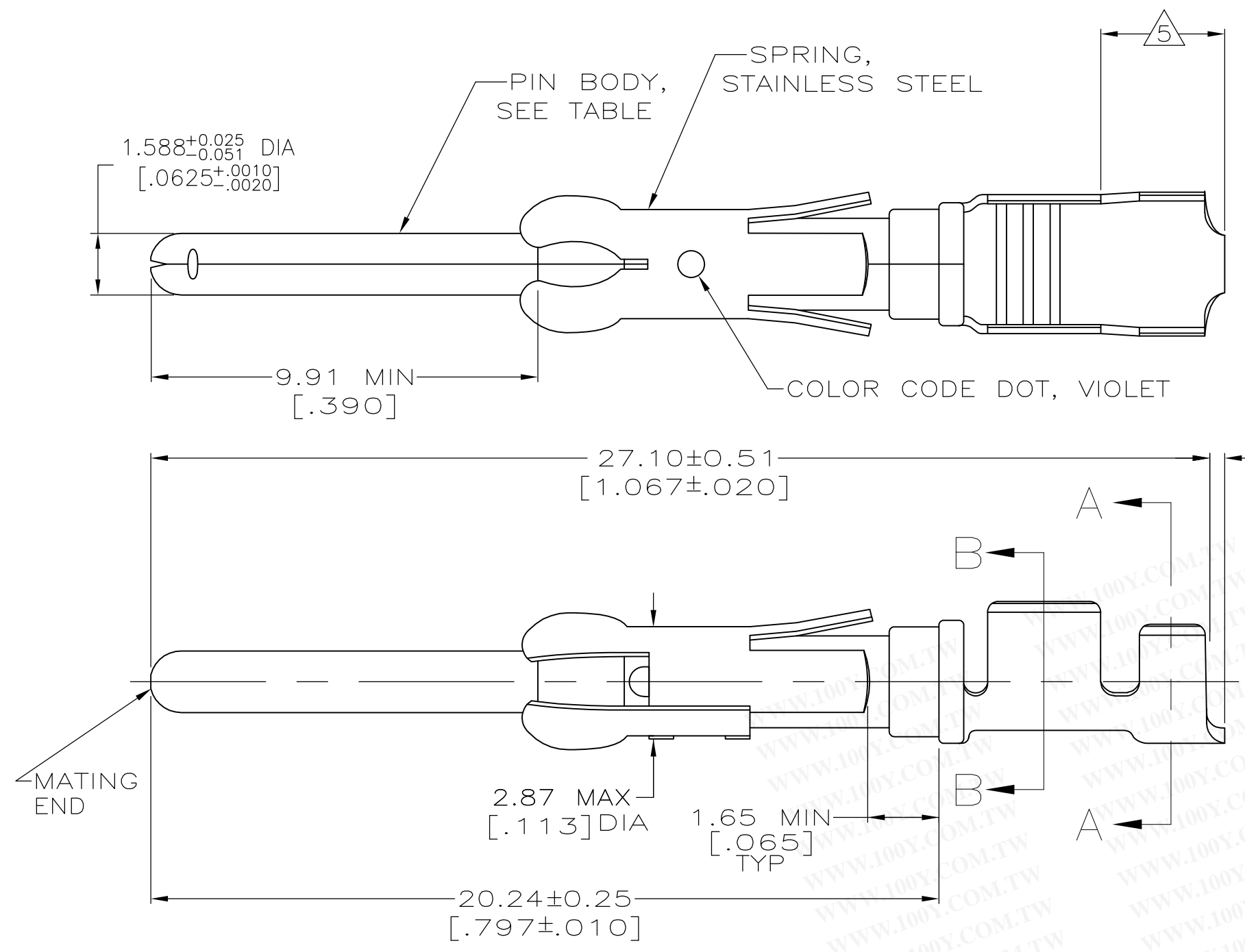

SECTION A-A

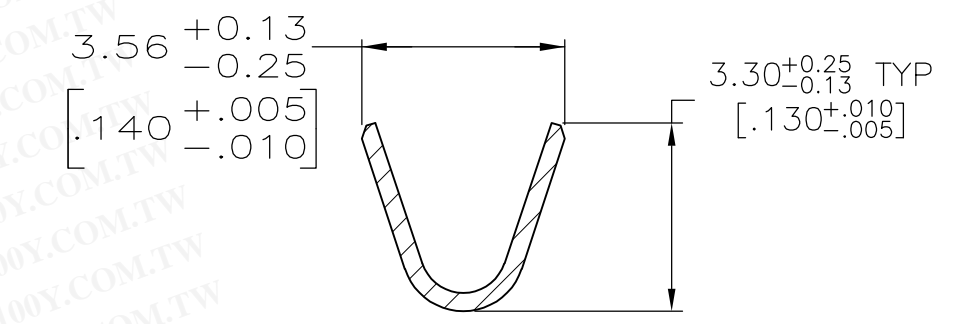

SECTION B-B

- ① 0.76µm [.000030] MIN PRECIOUS METAL PLATE ON MATING END FOR A LENGTH OF 5.08 [.200] MIN OVER 1.27µm [.000050] MIN NICKEL PLATE. GOLD FLASH ALL OVER. CONFORMS TO THE REQUIREMENTS OF TE CONNECTIVITY PRODUCT SPEC 108-10042, BASED ON EIA/ECA-364-1000.01A (CONTROLLED ENVIRONMENT APPLICATIONS).
- ② 0.76µm [.000030] MIN PRECIOUS METAL PLATE ON MATING END FOR A LENGTH OF 5.08 [.200] MIN WITH A UNIFORM GRADIENT TO 0.25µm [.000010] ON REMAINDER, OVER 1.27µm [.000050] MIN NICKEL PLATE. GOLD FLASH ALL OVER. CONFORMS TO THE REQUIREMENTS OF TE CONNECTIVITY PRODUCT SPEC 108-10042, BASED ON EIA/ECA-364-1000.01A (CONTROLLED ENVIRONMENT APPLICATIONS).
- ③ 0.38µm [.000015] MIN GOLD PER MIL-G-45204 ON MATING END FOR A LENGTH OF 5.08 [.200] MIN WITH GOLD FLASH ON THE REMAINDER OVER 1.27µm [.000050] MIN NICKEL PER QQ-N-290.
- ④ 1.27µm [.000050] MIN TIN-LEAD PER MIL-T-10727 OVER 1.27µm [.000050] MIN NICKEL PER QQ-N-290.
- ⑤ GOLD PLATING NOT REQUIRED IN THIS AREA.
- ⑥ WIRE RANGE 18-14 AWG.
- ⑦ INSULATION RANGE 2.03[.080]-2.54[.100] DIA.
- ⑧ 0.38µm [.000015] MIN GOLD PER MIL-G-45204 ON MATING END FOR A LENGTH OF 5.08 [.200] MIN, 1.27µm [.000050] MIN TIN-LEAD PER MIL-T-10727 FOR A LENGTH OF 5.69 [.224] MIN ON OPPOSITE END, BOTH OVER 1.27µm [.000050] MIN NICKEL PER QQ-N-290 ON ENTIRE CONTACT.
- ⑨ 1.27µm [.000050] MIN TIN PER MIL-T-10727 OVER 1.27µm [.000050] MIN NICKEL PER QQ-N-290.

STANDARD	⑨	CU-NI ALLOY	1-66359-9	1-66361-6	
STANDARD	④	CU-NI ALLOY	1-66359-7	1-66361-5	
STANDARD	①	CU-NI ALLOY	1-66359-6	1-66361-4	
SMALL PACK	⑨	BRASS	1-66359-4	1-66361-3	
STANDARD	⑨	BRASS	1-66359-4	1-66361-2	
SMALL PACK	①	BRASS	66359-4	1-66361-1	
SMALL PACK	④	BRASS	66359-2	1-66361-0	
OBSOLETE	STANDARD	⑧	BRASS	1-66359-3	66361-9
OBSOLETE	STANDARD	①	PHOSPHOR BRONZE	1-66359-2	66361-8
OBSOLETE	STANDARD	④	PHOSPHOR BRONZE	1-66359-1	66361-7
STANDARD	①	BRASS	66359-4	66361-4	
STANDARD	③	BRASS	66359-3	66361-3	
STANDARD	④	BRASS	66359-2	66361-2	
STANDARD	②	BRASS	66359-1	66361-1	
PACKAGING	BODY FINISH	BODY MATERIAL	STRIP P/N REF	PART NUMBER	

THIS DRAWING IS A CONTROLLED DOCUMENT.		DWN L.SIPE 06/03/92	STE TE Connectivity	
DIMENSIONS: mm [INCHES]		CHK W.LENKER 6-11-92		
TOLERANCES UNLESS OTHERWISE SPECIFIED:		APVD G.STEINHAUER 7-8-92	NAME	
0 PLC ± -	1 PLC ± -	PRODUCT SPEC	PIN ASSEMBLY, LOOSE PIECE, TYPE III+	
2 PLC ± 0.13 [.005]	3 PLC ± -	APPLICATION SPEC	SIZE	CAGE CODE
4 PLC ± -	ANGLES ± -	FINISH	A2	00779
MATERIAL SEE CALLOUTS	FINISH SEE TABLE	WEIGHT -	DRAWING NO	RESTRICTED TO
		CUSTOMER DRAWING	A2 00779 G-66361	
		SCALE 8:1	SHEET 1 OF 1	REV J1