

電源連接器 3W3 車針 d-sub DB 型 3V3 3 芯 混裝大電流 直針孔焊線式

图纸参数  
Drawing parameter

勝特力材料 886-3-5773766  
勝特力电子(上海) 86-21-34970699  
勝特力电子(深圳) 86-755-83298787  
[Http://www.100y.com.tw](http://www.100y.com.tw)

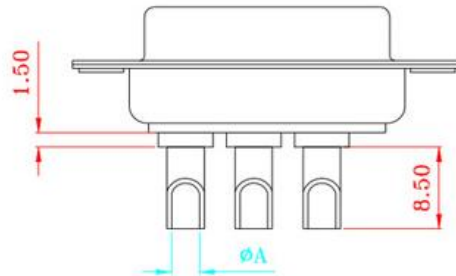
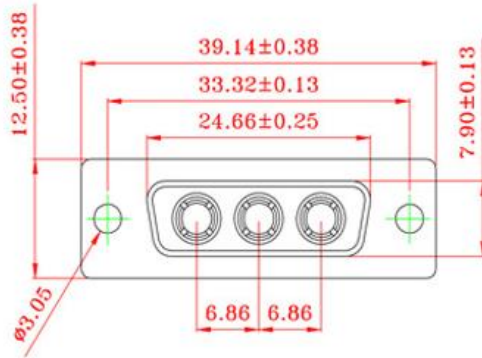

PART NO.	Current Rating	Dimension
		φ A
1198-033-815-000	40 AMPS	φ4.6
1198-033-615-000	30 AMPS	φ3.3
1198-033-415-000	20 AMPS	φ2.8
1198-033-215-000	10 AMPS	φ1.7

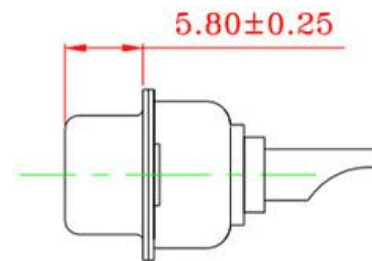

## MATERIALS AND FINISH

SHELL : STEEL MATERIAL, TIN FINISHED  
CONNECTOR INSULATOR : PBT THERMOPLASTIC,  
30% GLASS FILLED, UL 94V-0 RATED, BLACK COLOR  
HIGH POWER CONTACT MATERIAL: BRASS, 3u" GOLD PLATED

## ELECTRICAL CHARACTERISTICS

HIGH POWER CONTACT CURRENT RATING :10,20,OR 40 AMPS  
HIGH POWER CONTACT RESISTANCE : 2.7 MILLIOHMS MAX.  
DIELECTRIC WITHSTANDING VOLTAGE :  
1000 V AC FOR 1 MINUTE  
INSULATION RESISTANCE : 5000 MEGAOHMS MIN.  
TEMPERATURE RATING : -55°C ~ +125°C