

183211CS
(ON DRAWING)台架異図

REFERENCE ONLY

JAE

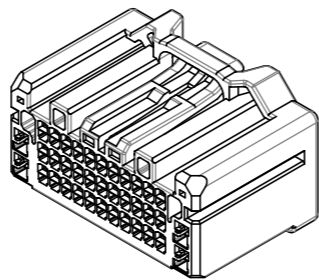
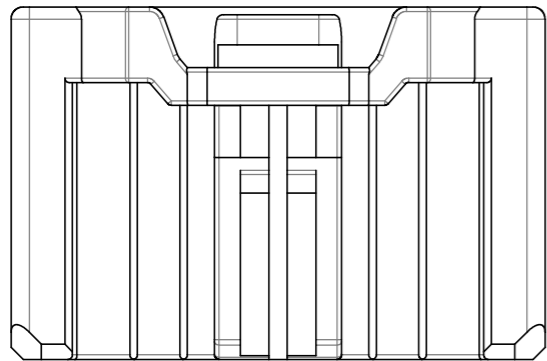

ISOMETRIC VIEW (1:1)
斜視図 (1:1)

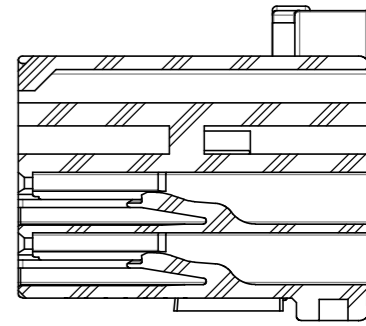
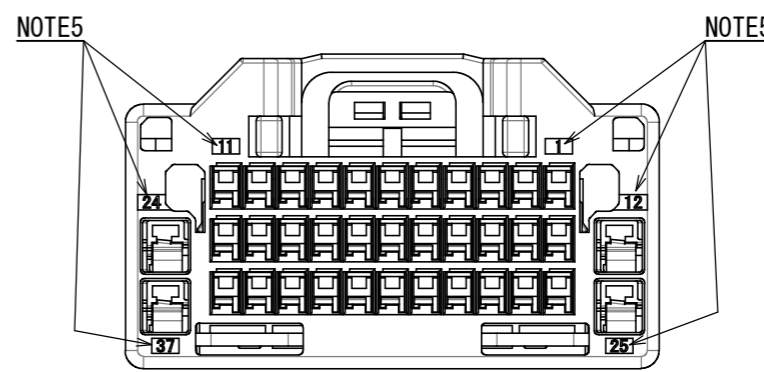
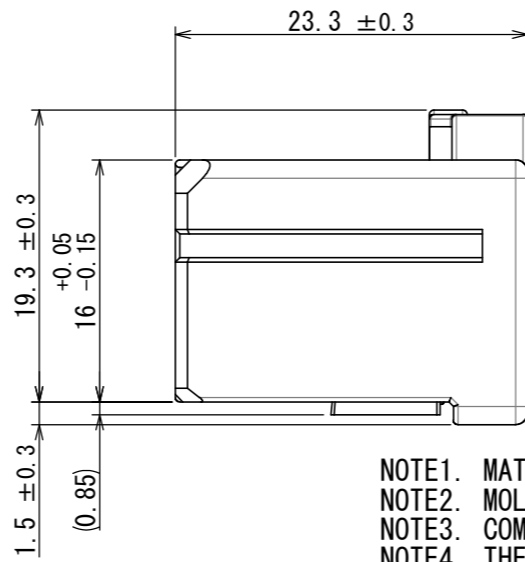
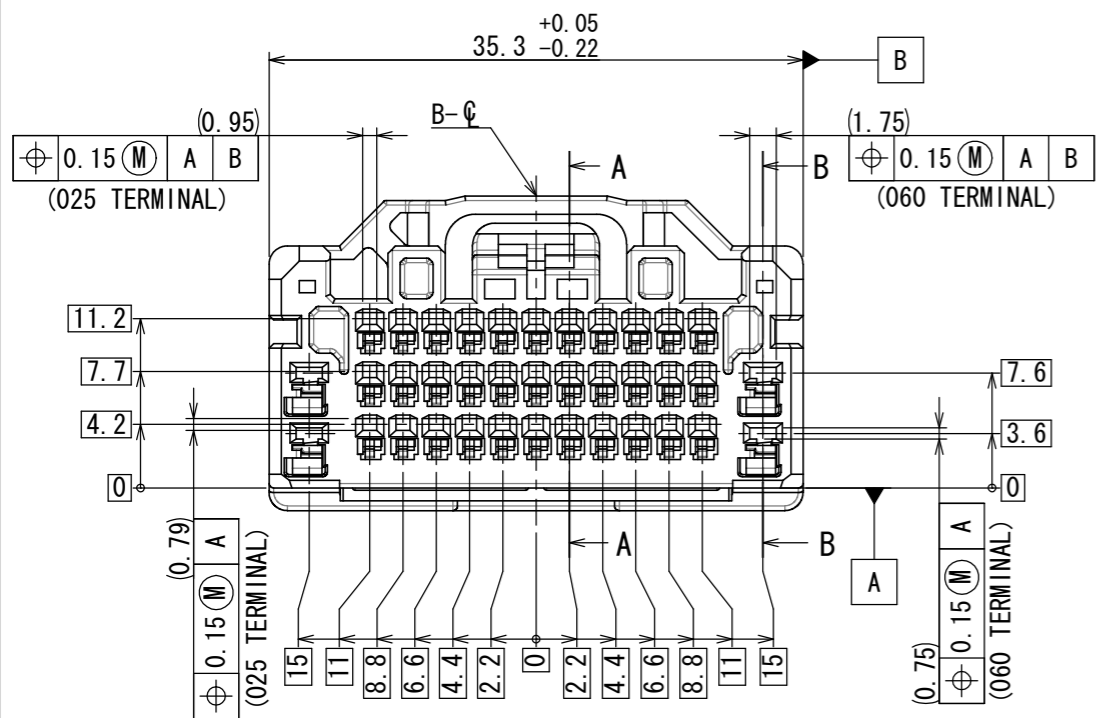

SECTION B-B
SCALE (2:1)

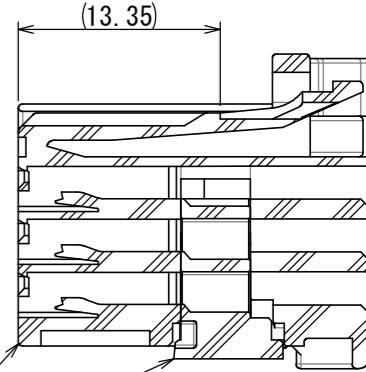

SECTION A-A
SCALE (2:1)

版数 VER.	年月日 DATE	CN NO.	変更内容 DESCRIPTION	製図 DR.	担当 CHK.	査閲 APPD.	承認 APPD.
------------	-------------	--------	---------------------	-----------	------------	-------------	-------------

TABLE1: TERMINAL MATERIALS AND PLATING LIST (端子材料・めっき仕様・適用電線)

TERMINAL SERIES	TERMINAL MARKING	PRODUCT NAME 品名	SJ DRAWING NO. SJ図番	MATERIAL 材料	PLATING めっき	APPLICABLE WIRE 適用電線
025 TERMINAL	S	M34S75C4F1	SJ038527	HIGH CONDUCTIVITY COPPER ALLOY 高導電性銅合金	TIN PLATING すずめっき	CHFUS0. 22sq AVSS0. 3sq CHFUS0. 35sq
	M	M34S75C4F2	SJ038528			CHFUS0. 5sq AVSS0. 5sq CAVS0. 5sq
	X	M34S75C4F5	SJ109336			CHFUS0. 75sq CHFUS0. 75sq
060 TERMINAL						CHFUS0. 13sq

TABLE2: APPLICABLE 025 TERMINAL LIST (025端子適用箇所)

PRODUCT NAME 品名	QTY 本数	025 TERMINAL POSITION 025端子適用箇所
M34S75C4F1 (S)	33	
M34S75C4F2 (M)		
M34S75C4F5 (X)		

- NOTE1. MATERIAL CODE APPEARS IN RAISED LETTERS.
 NOTE2. MOLDING LOT (YEAR AND MONTH) APPEARS IN RAISED LETTERS.
 NOTE3. COMPANY LOGO "JAE" & CAVITY NUMBER APPEARS IN RAISED LETTERS.
 NOTE4. THE ASSEMBLY LOT NO. IS INDICATED.
 NOTE5. TERMINAL NUMBER APPEARS IN RAISED LETTERS.

- 注1. 材料名を浮き出す。
 注2. ハウジングの成形ロット(年月)を浮き出す。
 注3. 社標、キャビティ番号を浮き出す。
 注4. 組立ロット番号を表記する。
 注5. 端子番号を浮き出す。

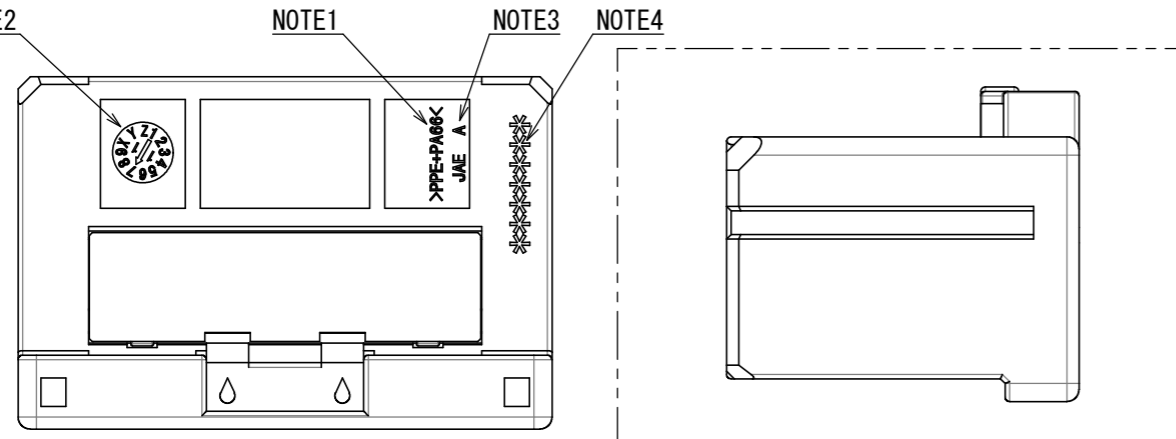

RETAINER SET CONDITION (REFERENCE)
リテーナセット状態図(参考)

2	RETAINER	1	PPE+PA66 (ALLOY)	—	COLOR: BLACK
1	HOUSING	1	PPE+PA66 (ALLOY)	—	COLOR: GRAY

仕様書 (SPECIFICATION)	第1版 (ORIGINAL DATE)	尺度 (SCALE)	シリーズ (SERIES)	日本航空電子工業株式会社
JACS-10940 JAHL-10940	25/JUN/2013	2:1	MX58	
一般公差 (GENERAL TOLERANCE)	製図 DR.	名称 (TITLE)	JAE JAPAN AVIATION ELECTRONICS INDUSTRY, LTD.	
寸法 (DIMENSION)	担当 CHK.	MX58037SFA (FEMALE CONNECTOR)		
× ±0.8	査閲 APPD.	質量 (MASS)	図面番号 (DRAWING NO.)	版数 (VER.)
×× ±0.4	承認 APPD.	7.1g	SJ112381	1
××× ±0.1				
×××× ±				

DCF-C-212H(12.08)

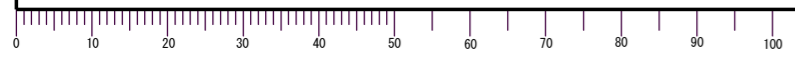

WISDOM承認 2013/06/25