



产品编号 : [50579305](#)

Product Description : SL Crimp Housing,  
Single Row, Version D, Back Ribs, 5  
Circuits, Black

系列号 : 70066

状态 : Active

Product Category : Connector Housings

工程编号 : 70066-0109



---

## 文件和资源

### 图纸

[图纸 050579305\\_sd.pdf](#)

[包装设计图 PK-70066-100-001.pdf](#)

### 3D 模型和设计文件

[3D模型 050579305\\_stp.zip](#)

### 规格

[产品规格 PS-70400-001.pdf](#)

[产品规格 PS-70058-001.pdf](#)

[产品规格 PS-71851-001.pdf](#)

[测试摘要 TS-70058-001-001.pdf](#)

---

## 产物环境合规

### 合规

|                    |  |
|--------------------|--|
| GADSL/IMDS         | Not Relevant                                   |
| China RoHS         |  |
| EU ELV             | Not Relevant                                   |
| Low-Halogen Status | Not Low-Halogen per IEC 61249-2-21             |
| REACH SVHC         | Not Contained per D(2023)3788-DC (14 Jun 2023) |
| EU RoHS            | Compliant per EU 2015/863                      |

### [多部分产品合规性声明](#)

- Eu RoHS

- REACH SVHC

- Low-Halogen

多部分行业合规性文件

- IPC 1752A Class C

- IPC 1752A Class D

- Molex Product Compliance Declaration

- IEC-62474

- chemSHERPA (xml)

欧盟 RoHS 合格证书

---

## 产品详情

### 常规

|      |   |
|------|---|
| 状态   | 活动  |
| 类别   | Connector Housings  |
| 系列   | 70066   |
| 说明   | SL Crimp Housing, Single Row, Version D, Back Ribs, 5 Circuits, Black |
| 应用   | Signal, Wire-to-Board   |
| 个评论  | Version D   |
| 产品系列 | SL Modular Connectors   |
| 产品名称 | SL  |
| UPC  | 800753578074  |

### 机构

|     |         |
|-----|---------|
| CSA | LR19980 |
| UL  | E29179  |

### 物理

|         |            |
|---------|------------|
| 电路数（最多） | 5          |
| 颜色-树脂   | 黑色         |
| 阻燃性     | 94V-0      |
| 性别      | Receptacle |
| 符合灼热丝规范 | 否          |
| 插接极性    | 是          |
| 锁定插接部位  | 否          |

|           |                 |
|-----------|-----------------|
| 材料 - 树脂   | Polyester Alloy |
| 净重        | 0.037/g         |
| 行数        | 1               |
| 包装形式      | Bag             |
| 面板安装式     | 否               |
| 间距 - 插配接口 | 2.54mm          |
| 可堆叠的      | 是               |
| 运行温度范围    | -40° to +105° C |

## 进程

|    |     |
|----|-----|
| 无铅 | 不适用 |
|----|-----|

---

## 可配插/可连接使用的产品

### 可配插部件

| 描述  | 产品编号         |
|---|--------------|
| 2.54mm SL Interim Clips   | <u>70013</u> |
| SL Dual Row Housing Panel Mounts                                | <u>70022</u> |
| SL Single Row, Version D, Male FFC/FPC Connectors               | <u>70431</u> |
| SL Single Row Male Insulation Displacement Connector Assemblies | <u>70475</u> |
| SL Vertical Single Row Headers                                  | <u>70543</u> |
| SL Right-Angle, Single Row, Low Profile Headers                 | <u>70553</u> |

### 可连接使用部件

| 描述                  | 产品编号         |
|---------------------|--------------|
| SL Male Terminals   | <u>70021</u> |
| SL Female Terminals | <u>70058</u> |
| SL Female Terminals | <u>71851</u> |

**NOTES:**

- 1) MATERIAL: GLASS FILLED POLYESTER, UL94V-0, COLOR: BLACK.
- 2) HOUSING TO BE USED WITH TERMINAL PT. NO. 70058-\*\*\*\*
- 3) SEE CHART FOR CIRCUIT SIZES.
- 4) TO BE USED WITH (0.64)/.025 SQ. OR RD. PINS.
- 5) PARTS STACKABLE END TO END ON (2.54)/.100 CENTERS.
- 6) REFER TO PRODUCT SPECIFICATION NO. : P.S.-70058
- 7) PARTS MAY OR MAY NOT BE SUPPLIED WITH EXTERIOR CORE-OUT CONFIGURATION, SEE DWG. SD-70066-\*\*\*\* FOR OPTIONAL HOUSING DETAILS.
- 8) PACKAGE PER PK-70066-100.

**OPTION "D"**

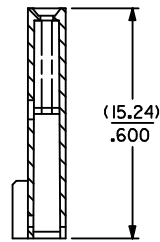
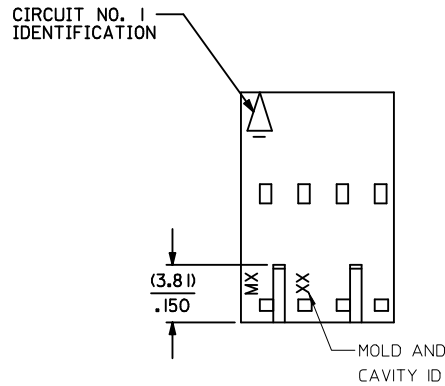
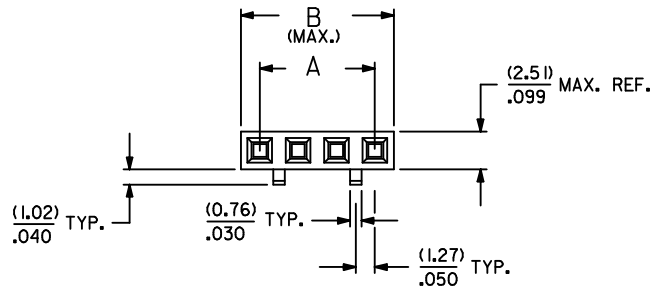

**SECTION C-C**

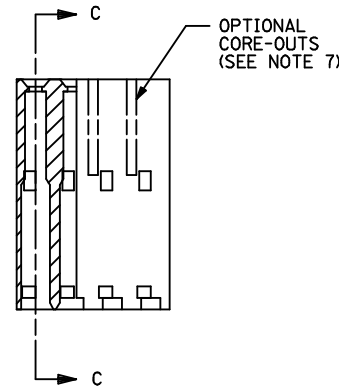

| CKT. SIZE | EDP. NO.   | ENG. NO.   | A                | B                |
|-----------|------------|------------|------------------|------------------|
| 2         | 50-57-9302 | 70066-0106 | (2.54)<br>.100   | (5.05)<br>.199   |
| 3         | 50-57-9303 | 70066-0107 | (5.08)<br>.200   | (7.59)<br>.299   |
| 4         | 50-57-9304 | 70066-0108 | (7.62)<br>.300   | (10.13)<br>.399  |
| 5         | 50-57-9305 | 70066-0109 | (10.16)<br>.400  | (12.67)<br>.499  |
| 6         | 50-57-9306 | 70066-0110 | (12.70)<br>.500  | (15.21)<br>.599  |
| 7         | 50-57-9307 | 70066-0111 | (15.24)<br>.600  | (17.75)<br>.699  |
| 8         | 50-57-9308 | 70066-0112 | (17.78)<br>.700  | (20.29)<br>.799  |
| 9         | 50-57-9309 | 70066-0113 | (20.32)<br>.800  | (22.83)<br>.899  |
| 10        | 50-57-9310 | 70066-0114 | (22.86)<br>.900  | (25.37)<br>.999  |
| 11        | 50-57-9311 | 70066-0115 | (25.40)<br>1.000 | (27.91)<br>1.099 |
| 12        | 50-57-9312 | 70066-0116 | (27.94)<br>1.100 | (30.45)<br>1.199 |
| 13        | 50-57-9313 | 70066-0117 | (30.48)<br>1.200 | (32.99)<br>1.299 |
| 14        | 50-57-9314 | 70066-0118 | (33.02)<br>1.300 | (35.53)<br>1.399 |
| 15        | 50-57-9315 | 70066-0119 | (35.56)<br>1.400 | (38.07)<br>1.499 |
| 16        | 50-57-9316 | 70066-0120 | (38.10)<br>1.500 | (40.61)<br>1.599 |
| 17        | 50-57-9317 | 70066-0121 | (40.64)<br>1.600 | (43.15)<br>1.699 |
| 18        | 50-57-9318 | 70066-0122 | (43.18)<br>1.700 | (45.69)<br>1.799 |
| 19        | 50-57-9319 | 70066-0123 | (45.72)<br>1.800 | (48.23)<br>1.899 |
| 20        | 50-57-9320 | 70066-0124 | (48.26)<br>1.900 | (50.77)<br>1.999 |
| 21        | 50-57-9321 | 70066-0125 | (50.80)<br>2.000 | (53.31)<br>2.099 |
| 22        | 50-57-9322 | 70066-0126 | (53.34)<br>2.100 | (55.85)<br>2.199 |
| 23        | 50-57-9323 | 70066-0127 | (55.88)<br>2.200 | (58.39)<br>2.299 |
| 24        | 50-57-9324 | 70066-0128 | (58.42)<br>2.300 | (60.93)<br>2.399 |
| 25        | 50-57-9325 | 70066-0129 | (60.96)<br>2.400 | (63.47)<br>2.499 |

|   |                                      |                                       |            |  |            |  |                      |                        |                     |   |
|---|--------------------------------------|---------------------------------------|------------|--|------------|--|----------------------|------------------------|---------------------|---|
| <b>LOCATE MOLD &amp; CAVITY ID</b><br>EC NO: UCP2014-4216<br>DRWR:RWHIPPLE 2014/04/11<br>CHKD:DMORGAN 2014/04/11<br>APPR:SMILLER 2014/04/28 | QUALITY SYMBOLS<br>▽=0<br>▽=0<br>▽=0 | GENERAL TOLERANCES (UNLESS SPECIFIED) |            | DIMENSION STYLE<br>IN/MM                             |            | SCALE                                  | DESIGN UNITS<br>INCH | THIRD ANGLE PROJECTION |                     |   |
|   |                                      | 4 PLACES ± ---                        | ± ---      | DRAWN BY   | DATE       | TITLE                                  |                      |                        |                     |   |
|   |                                      | 3 PLACES ± ---                        | ± ---      | CHECKED BY   | DATE       | SALES, 70066-OPT.D<br><br><b>molex</b> |                      |                        |                     |   |
|   |                                      | 2 PLACES ± ---                        | ± ---      | DMORGAN  | 2014/04/11 |  |                      |                        |                     |   |
| 1 PLACE ± ---   | ± ---                                | APPROVED BY                           | DATE       | MATERIAL NO.<br>SEE CHART                            |            | DOCUMENT NO.<br>SD-70066-0106-0129     |                      |                        | SHEET NO.<br>1 OF 1 |   |
| 0 PLACE ± ---   | ± ---                                | SMILLER                               | 2014/04/28 | DRAFT WHERE APPLICABLE MUST REMAIN WITHIN DIMENSIONS |            |  |                      |                        |                     | THIS DRAWING CONTAINS INFORMATION THAT IS PROPRIETARY TO MOLEX INCORPORATED AND SHOULD NOT BE USED WITHOUT WRITTEN PERMISSION |