

### Specification

**MATERIAL:**

Insulator: High Temperature Thermoplastic, UL 94V-0  
 Contact: Copper Alloy  
 SHELL: SUS

**PLATING:**

Contact: ALL AN GOLD IU  
 Shell: Plated 50u" HI Overall, PAD As IU

**Electrical:**

Current Rating : 0.5A AC/DC max.  
 Voltage Rating : 120V AC/DC  
 Ambient Temperature Range : -20° C +80° C  
 Storage Temperature Range : -40° C +100° C  
 Ambient Humidity Range : 95% R.H. Max.  
 Contact Resistance: 100m $\Omega$  max.  $\Omega$   
 Insulation Resistance: 1000M $\Omega$  min./200VDC  
 Rating Cycle: 1000-1000 Insertions  
 产品环境温度: 200度

0.58

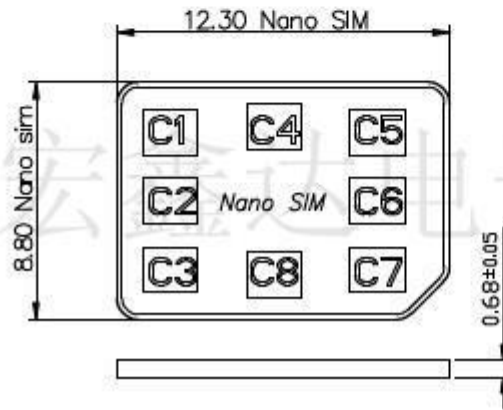
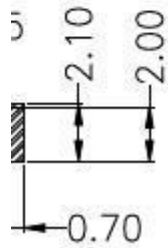

0