



OUTPUT TYPE

PLS Series - Output Type



SINCE 1978
APEX CONNECTOR

勝特力材料 886-3-5753170
勝特力电子(上海) 86-21-34970699
勝特力电子(深圳) 86-755-83298787
Http://www.100y.com.tw

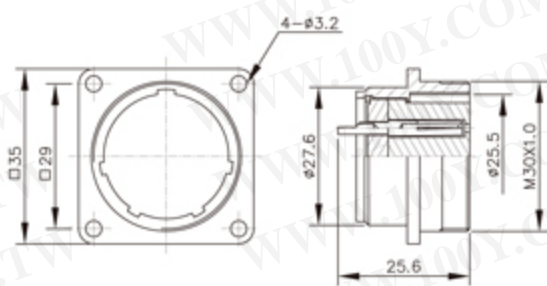

PLS-28-RF

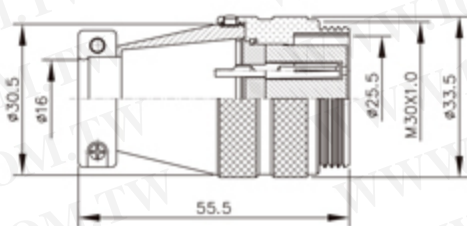

PLS-28-ADF

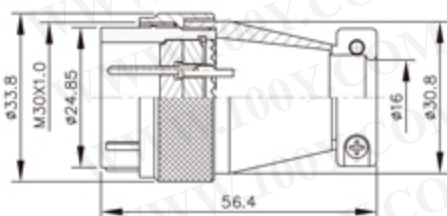

PLS-28-PM

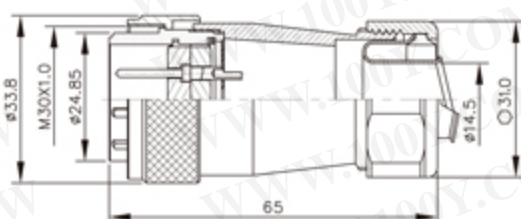

PLS-28-GPM1/2"

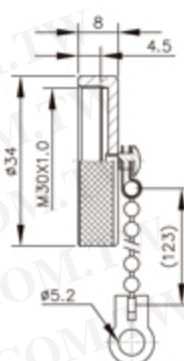

PLS-28-RCa

ACCESSORY:

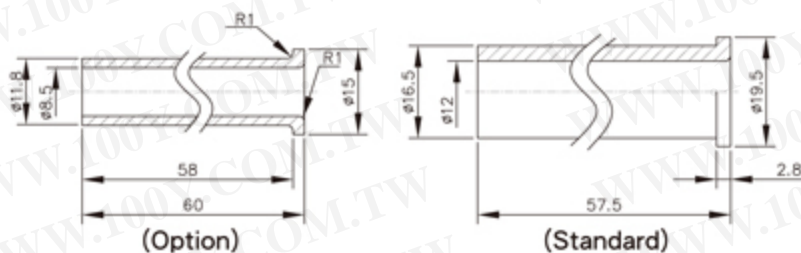

(Option)

(Standard)

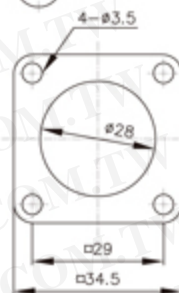

RUBBER TUBE FOR PLS-28-PM

RUBBER PLATE FOR PLS-28-RF

◆ No. of contacts	12	16	17	20	26
Contacts Configuration					
Rated current / voltage	10A 250V	10A 250V	10A 250V	5A 250V	5A 250V
Operation limit voltage (AC.V.rms)	250	250	250	250	250
Withstanding voltage (AC.V.rms) 1 minute	1000	1000	1000	1000	1000
Insulation resistance (MΩ MIN.) at DC 500V	1000	1000	1000	1000	1000
Contact resistance (MΩ MAX.) at DC 1A	5	5	5	3	3
Solder inter diameter	1.6	1.6	1.6	1.2	1.2