

REVISIONS					
P	LTR	DESCRIPTION	DATE	DWN	APVD
	A	REVISED PER PCN E-18-001206	24JAN2018	JA	DM

勝特力電材超市-龍山店 886-3-5773766
 勝特力電材超市-光復店 886-3-5729570
 勝特力电子(上海) 86-21-34970699
 勝特力电子(深圳) 86-755-83298787
<http://www.100y.com.tw>

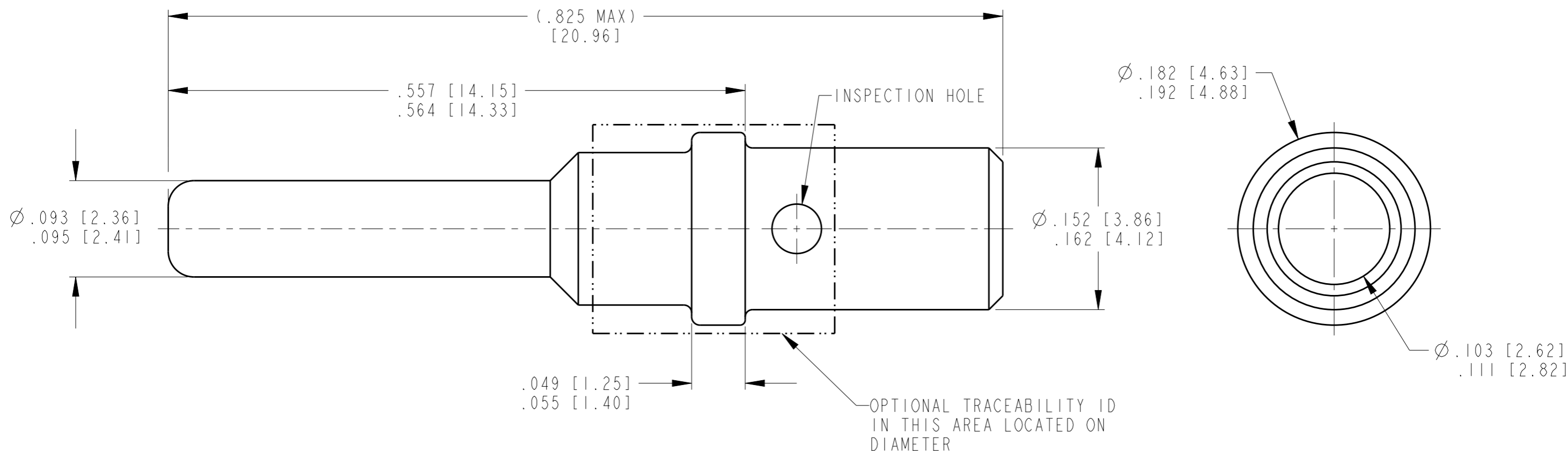

TE INTERNAL PN	DEUTSCH PN	PLATING
0460-204-12141	0460-204-12141	NICKEL

THIS DRAWING IS A CONTROLLED DOCUMENT.		DWN	J. APOSTOL	08MAR2005		
DIMENSIONS: INCHES [mm]		CHK	B. BYFORD	14MAR2005		
TOLERANCES UNLESS OTHERWISE SPECIFIED:		APVD	R. REED	14MAR2005		
0 PLC ± 1 PLC ± 2 PLC ± 3 PLC ± 4 PLC ± ANGLES ±		PRODUCT SPEC	0425-015-0000			
MATERIAL		APPLICATION SPEC	0425-205-0000		NAME	CONTACT PIN SIZE 12
FINISH		WEIGHT	1.27g		SIZE	A3
		CUSTOMER DRAWING	SCALE 10:1		CAGE CODE	4AFU8
			SHEET 1 OF 1		DRAWING NO	0460-204-12XX
			REV A		RESTRICTED TO	

1. WIRE RANGE : 14 AWG TO 12 AWG [2.0 - 3.0 mm²]

NOTES:

0460-204-12141 ✓ ACTIVE

DEUTSCH | DEUTSCH Common Contact

TE Internal #: 0460-204-12141

Automotive Terminals, Pin, Pin Diameter 2.4 mm [.094 in], 14 – 12 AWG Wire Size, 2.08 – 3.31 mm² Wire Size, DEUTSCH Common Contact

[View on TE.com >](#)



Terminals & Splices > Automotive Terminals > DEUTSCH Solid Contacts



Terminal Type: **Pin**

Mating Pin Diameter: **2.4 mm [.094 in]**

Terminal Transmits: **25 – 40 A (Power)**

Wire Size: **2.08 – 3.31 mm²**

[All DEUTSCH Solid Contacts \(46\)](#)

Features

Product Type Features

Receptacle Style	180°
Sealable	No

Contact Features

Contact Size	Size 12
Contact Fabrication	Solid
Wire Contact Termination Area Plating Material	Nickel
Typical Current Rating	25 A
Crimp Type	O-Crimp
Terminal Type	Pin
Mating Pin Diameter	2.4 mm [.094 in]
Interface Plating	Nickel (Ni)

Termination Features

Termination Method to Wire & Cable	Crimp
Product Terminates To	Wire

Dimensions

Wire Size	2.08 – 3.31 mm ²
-----------	-----------------------------

Usage Conditions



Insulation Option	Uninsulated
Operating Temperature (Max)	125 °C[257 °F]
Operating Temperature Range	-55 – 125 °C[-67 – 257 °F]

Operation/Application

Compatible With Wire Base Material	Copper
------------------------------------	--------

Packaging Features

Packaging Quantity	1250
Packaging Method	Carrier

Other

Customer Preferred Contact	No
Terminal Transmits	25 – 40 A (Power)

Product Compliance

[For compliance documentation, visit the product page on TE.com>](#)

EU RoHS Directive 2011/65/EU	Compliant with Exemptions
EU ELV Directive 2000/53/EC	Compliant
China RoHS 2 Directive MIIT Order No 32, 2016	Restricted Materials Above Threshold
EU REACH Regulation (EC) No. 1907/2006	Current ECHA Candidate List: JAN 2024 (240) Candidate List Declared Against: JAN 2024 (240) SVHC > Threshold: Pb (1% in Component Part) Article Safe Usage Statements: Do not eat, drink or smoke when using this product. Wash thoroughly after handling. Recycle if possible and dispose of the article by following all applicable governmental regulations relevant to your geographic location.
Halogen Content	Low Halogen - Br, Cl, F, I < 900 ppm per homogenous material. Also BFR/CFR/PVC Free
Solder Process Capability	Not reviewed for solder process capability

Product Compliance Disclaimer

This information is provided based on reasonable inquiry of our suppliers and represents our current actual knowledge based on the information they provided. This information is subject to change. The part numbers that TE has identified as EU RoHS compliant have a maximum concentration of 0.1% by weight in homogenous materials for lead, hexavalent chromium, mercury, PBB, PBDE, DBP, BBP, DEHP, DIBP, and 0.01% for cadmium, or qualify for an exemption to these limits as defined in the Annexes of Directive 2011/65/EU (RoHS2). Finished electrical and electronic equipment products will be CE marked as required by Directive 2011/65/EU. Components may not be CE marked. Additionally, the part numbers that TE has identified as EU ELV compliant have a maximum concentration of 0.1% by weight in homogenous materials for lead, hexavalent chromium, and mercury, and 0.01% for cadmium, or qualify for an exemption to these limits as defined in the Annexes of Directive 2000/53/EC (ELV). Regarding the REACH Regulation, the information TE provides

on SVHC in articles for this part number is based on the latest European Chemicals Agency (ECHA) 'Guidance on requirements for substances in articles' posted at this URL: <https://echa.europa.eu/guidance-documents/guidance-on-reach>

Compatible Parts



TE Part # CAT-H396-CH8172
DEUTSCH HDP20 Housings



TE Part # CAT-H3930-CH8172
DEUTSCH HD30 Housings



TE Part # CAT-D486-CH8172
DEUTSCH DTP Housings



TE Part # CAT-D781-CH8172
DEUTSCH DRB Housings



TE Part # CAT-H3910-CH8172
DEUTSCH HD10 Housings



TE Part # CAT-D48-PCH8172
DEUTSCH DTHD Housings



TE Part # HDT-48-00
CRIMP TOOL, HAND



TE Part # HDT-50-00
CRIMP TOOL



TE Part # HDP-400
POWER CRIMPER



TE Part # CAT-D799-CH8172
DEUTSCH DRC Housings



TE Part # JS-12-00
JIFFY SPLICE, size 12



TE Part # 0462-203-12141
SOC, SOLID, SIZE 12, 12-14AWG, NI



TE Part # 1062-12-0222
SOC, SF, SIZE 12, 10, NI/NI



TE Part # 1062-12-0166
SOC, SF, SIZE 12, 12-14, NI/SN



TE Part # 1062-12-0222-PS
SOC, SF, SIZE 12, 10, NI/NI, 100 PC



TE Part # DRCP24-86PA
REC, 86P, BLK, 12/20, A

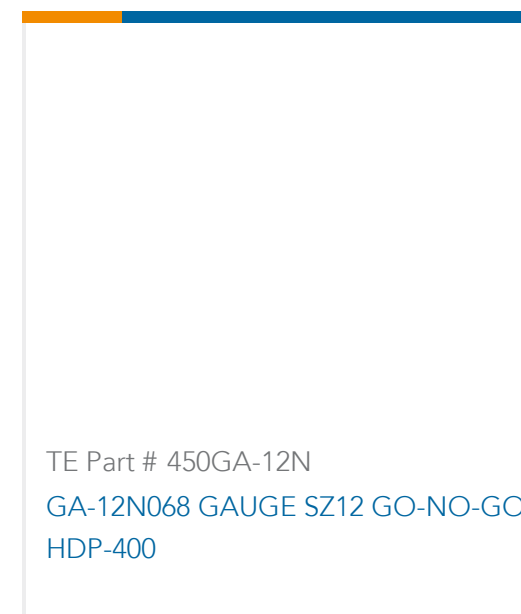
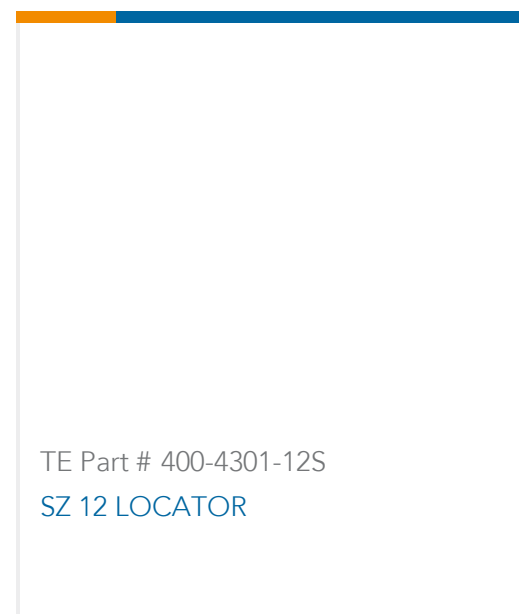
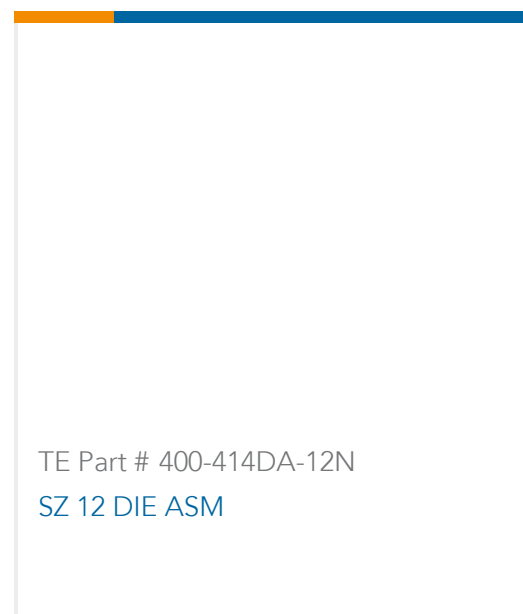

Also in the Series | DEUTSCH Common Contact

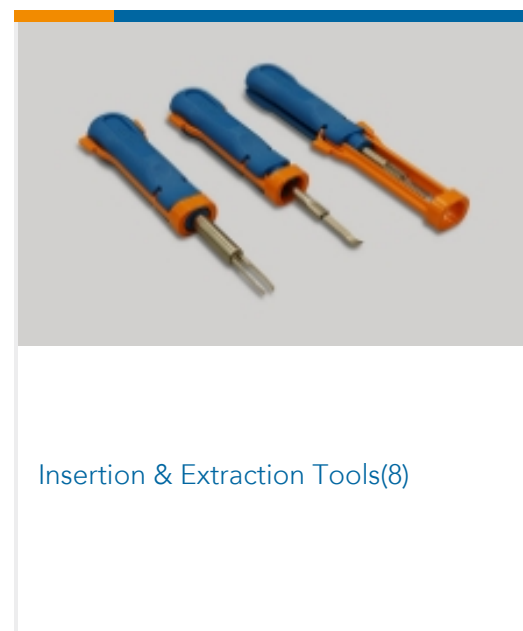
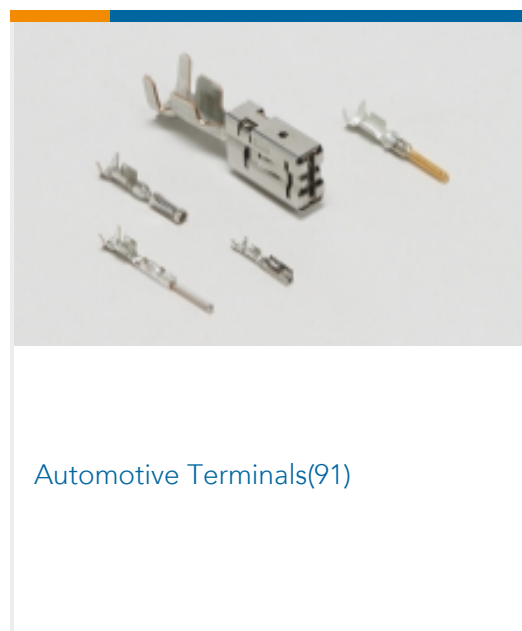

Customers Also Bought



Documents

Product Drawings

PIN, SOLID, SIZE 12, 12-14AWG, NI

English

CAD Files

3D PDF

3D

Customer View Model

[ENG_CVM_CVM_0460-204-12141_K.2d_dxf.zip](#)

English

Customer View Model

[ENG_CVM_CVM_0460-204-12141_K.3d_igs.zip](#)

English

Customer View Model

[ENG_CVM_CVM_0460-204-12141_K.3d_stp.zip](#)



English

By downloading the CAD file I accept and agree to the [Terms and Conditions](#) of use.

Datasheets & Catalog Pages

[CONNECTOR SELECTOR](#)

English

Product Specifications

[Engineering Report](#)

English