

REVISIONS				
P	LTN	DESCRIPTION	DATE	OWN APVD
AP3		REVISED PER ECR-17-008392	28JUN2017	BW KR
AP4		REVISED PER ECR-21-120286	1NOV2021	SS VS
AP5		REVISED PER ECR-22-148473	08AUG2022	AVN VS

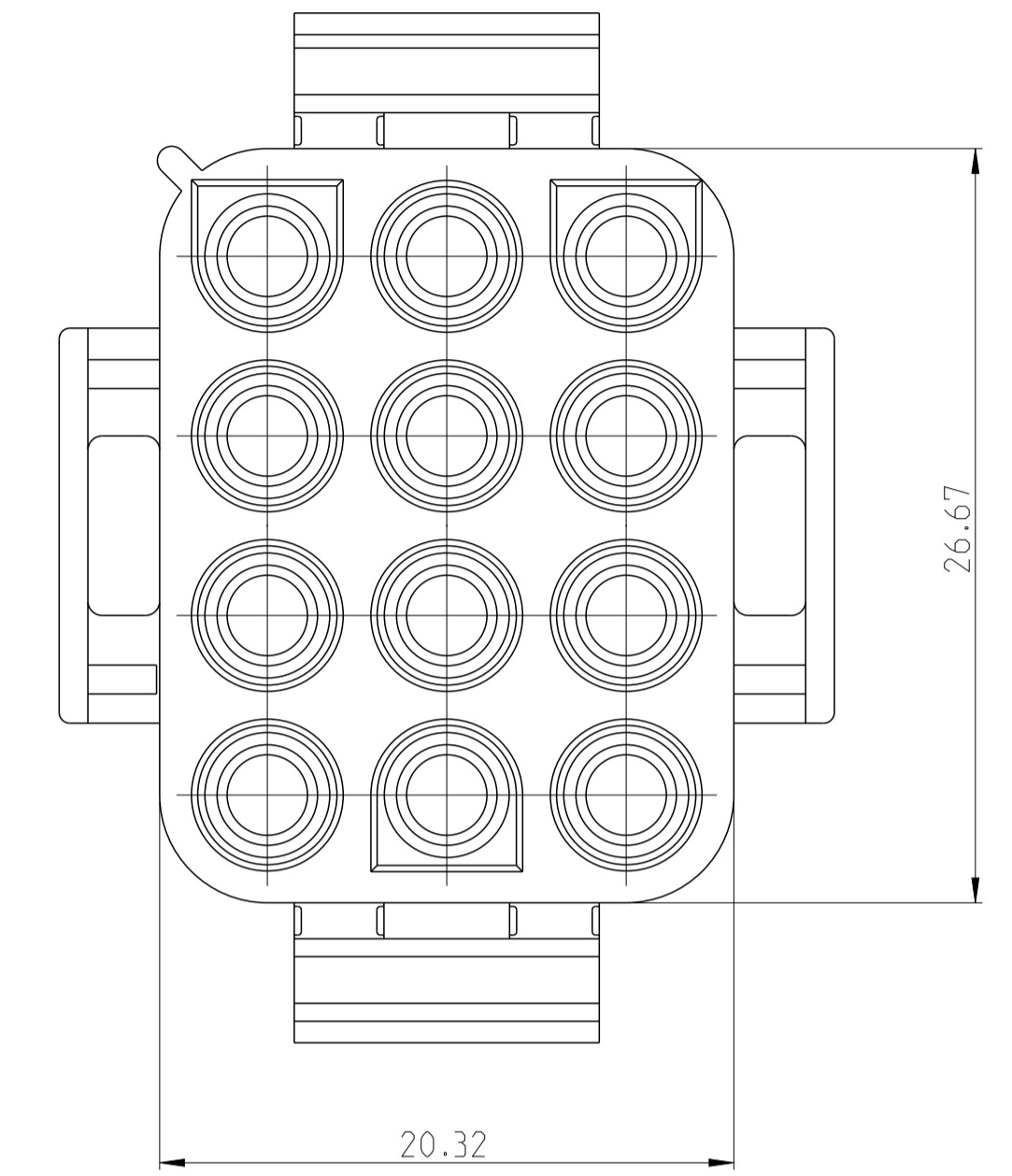

- 1 MATES WITH APPROPRIATE UNIVERSAL MATE-N-LOK™ CAP OR HEADER.
- 2 SMALL NICKS ARE PERMITTED ON THE CIRCUIT TOWERS WHICH COULD INCREASE THE INITIAL HOUSING MATING FORCE BY UP TO 4.4 NEWTONS (1.0 LBS). NO INDIVIDUAL NICKED TOWER SHALL INCREASE THIS FORCE BY OVER 2.2 NEWTONS (1.5 LBS).
- 3 DIMENSIONS SHOWN REPRESENT PRODUCT IN DRY, AS MOLDED, CONDITION. ADDITIONAL 2% GROWTH DUE TO SUBSEQUENT MOISTURE ABSORPTION MAY OCCUR AND SHOULD BE ACCOUNTED FOR.
- 4 FOUR RIBS EQUALLY SPACED, NO SPECIFIC ORIENTATION. NO RIBS OR SIX RIBS EQUALLY SPACED, NO SPECIFIC ORIENTATION, OPTIONAL.
- 5 UNDERWRITERS RECOGNIZED COMPONENT LOGO AND CSA CERTIFICATION LOGO TO BE LOCATED ONCE EACH ON SIDE OF HOUSING.
- 6 OBSOLETE PARTS: OBSOLETE CIS STREAMLINING PER D.RENAUD/D.SINISI

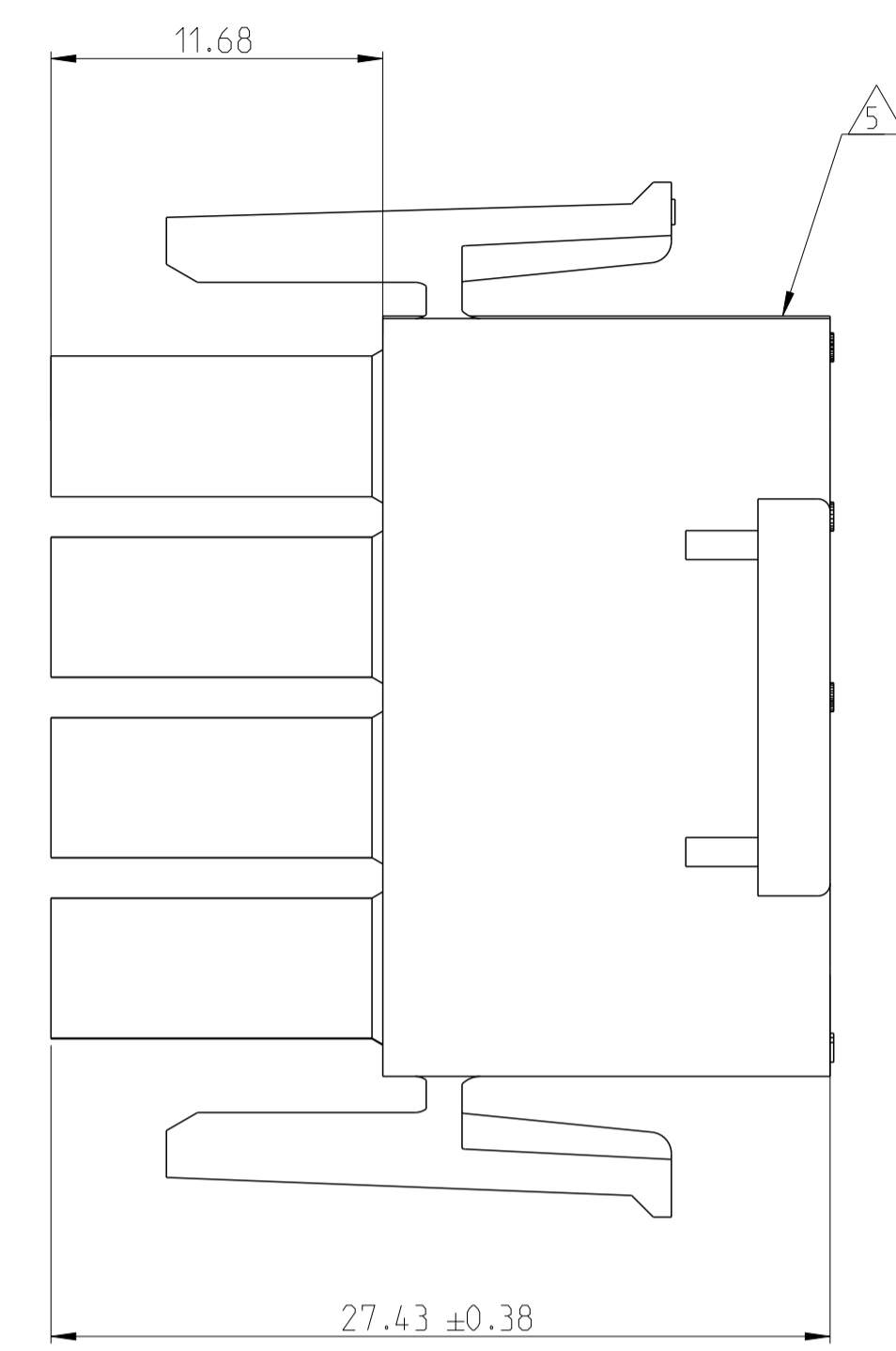
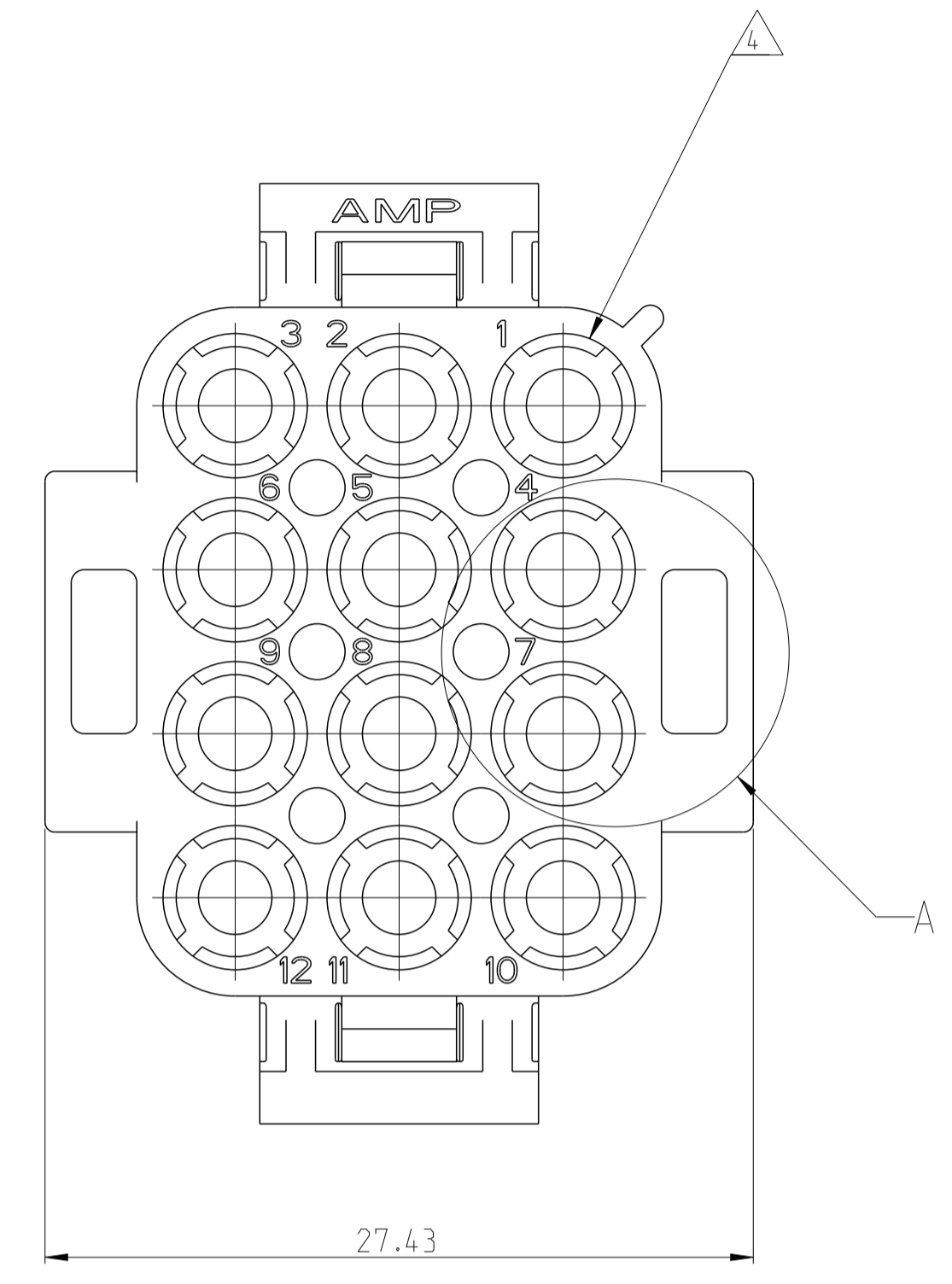
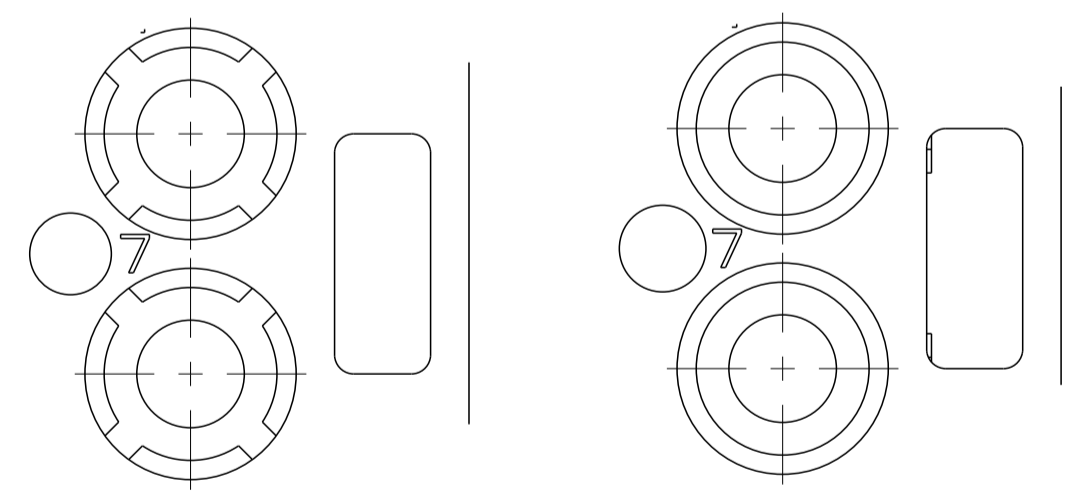

DETAIL A
OPTIONAL CONSTRUCTION

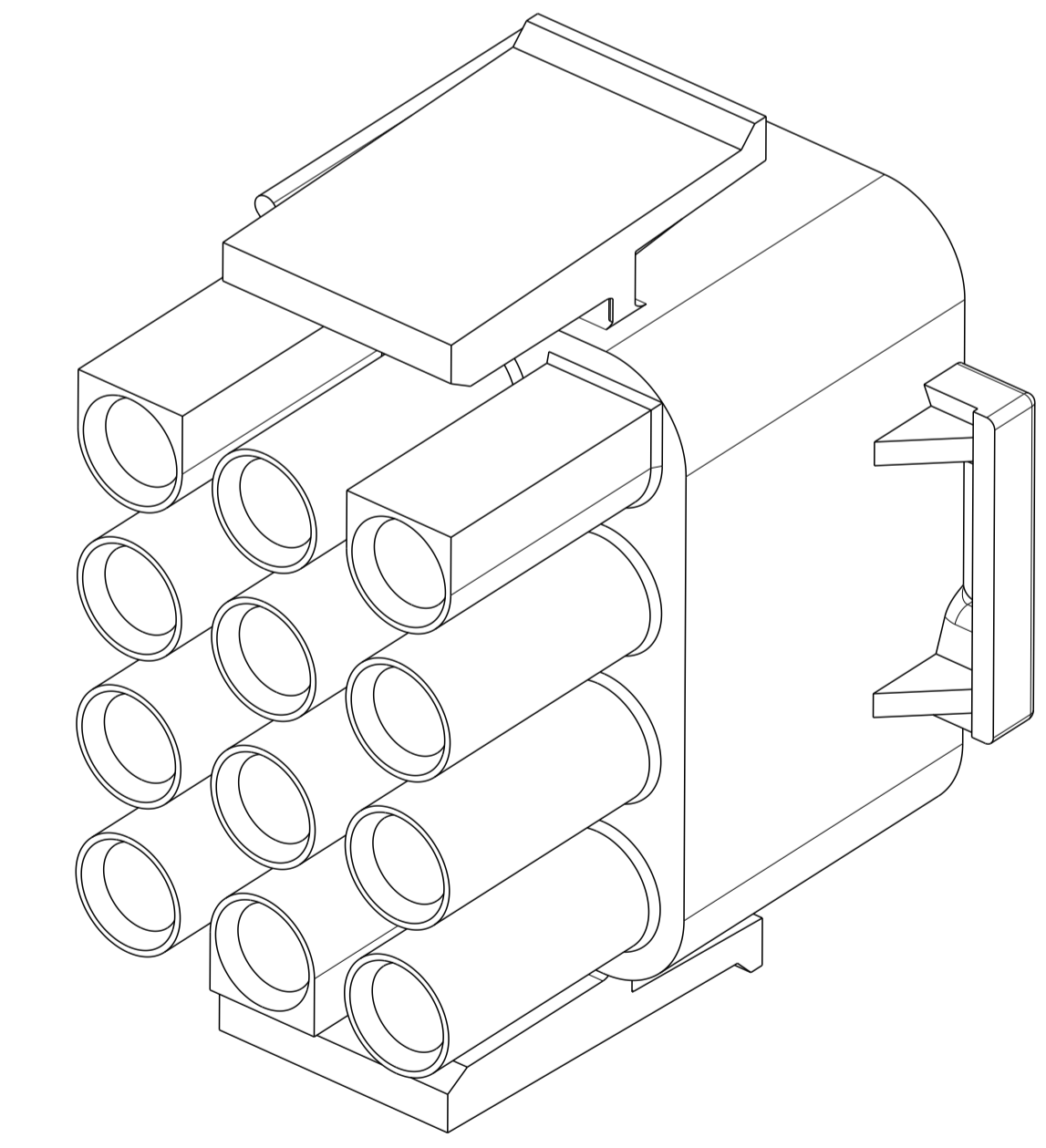
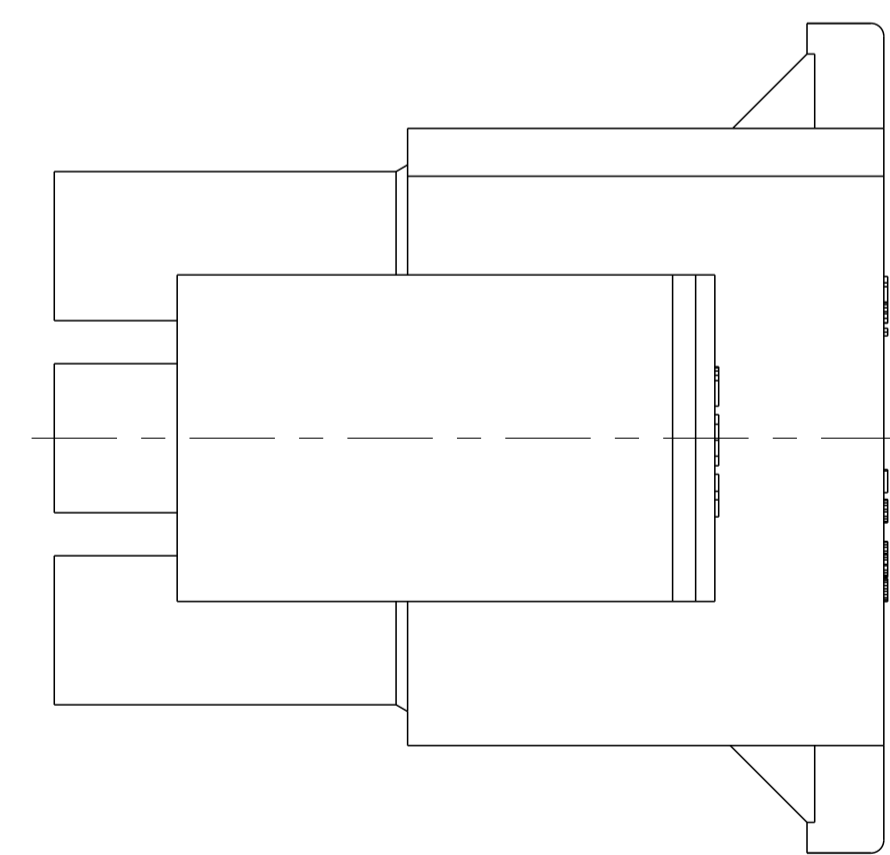

3-DIMENSIONAL MODEL
NTS

勝特力電材超市-龍山店 886-3-5773766
 勝特力電材超市-光復店 886-3-5729570
 勝特力電子(上海) 86-21-34970699
 勝特力電子(深圳) 86-755-83298787
<http://www.100y.com.tw>

	BLACK	1-480708-9
6	OBSOLETE - GRAY	1-480708-8
	OBSOLETE - VIOLET	1-480708-7
6	OBSOLETE - BLUE	1-480708-6
	OBSOLETE - GREEN	1-480708-5
	YELLOW	1-480708-4
6	OBSOLETE - ORANGE	1-480708-3
	RED	1-480708-2
6	SUPERSEDED BY 1-480708-0 - BROWN	1-480708-1
	NATURAL	1-480708-0
	COLOR	PART NUMBER

THIS DRAWING IS A CONTROLLED DOCUMENT.		OWN K. WHITAKER 01SEP2004	TE Connectivity	
DIMENSIONS: mm		CHK S. RIDGILL 01SEP2004	NAME PLUG, 12 CIRCUIT, UNIVERSAL MATE-N-LOK	
TOLERANCES UNLESS OTHERWISE SPECIFIED:		APVD S. RIDGILL 01SEP2004	PRODUCT SPEC	
0 PLC ±		APPLICATION SPEC		
1 PLC ±		SIZE CAGE CODE DRAWING NO		
2 PLC ±0.13		RESTRICTED TO		
3 PLC ±		A 00779 C=480708		
4 PLC ±		WEIGHT		
ANGLES ±		CUSTOMER DRAWING		
FINISH ±		SCALE 4:1 SHEET 1 OF 2 REV AP5		
MATERIAL NYLON, UL 94V-2				

REVISIONS				
P	LTN	DESCRIPTION	DATE	APVD
-		SEE SHEET 1	-	-

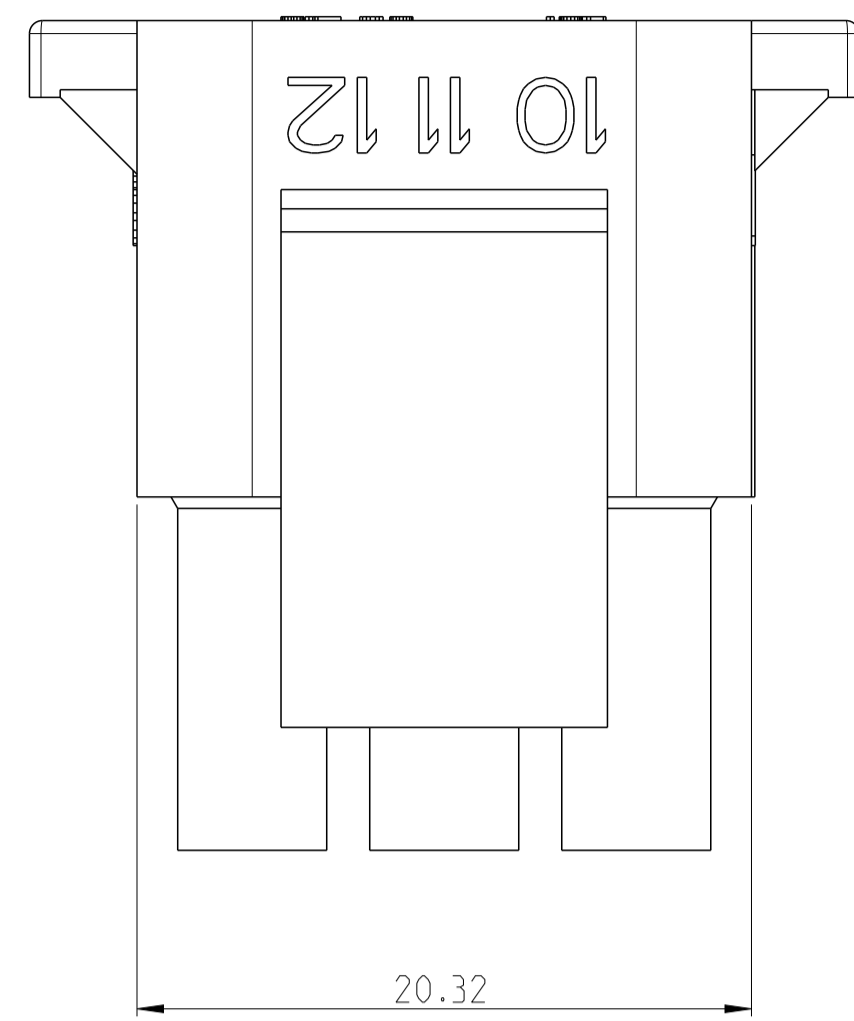

- 1 STAMP NUMBERS 3.18 HIGH AT WIRE END OF HOUSING (12 POINT DAVID TYPE).
- 2 CHARACTERS TO BE POSITIONED ON HOUSING TO BE READ FROM WIRE END ONLY.
- 3 VIOLET, BLACK, BROWN, AND BLUE COLORED BLOCKS TO BE STAMPED WITH WHITE CHARACTERS. ALL OTHER COLORED BLOCKS TO BE STAMPED WITH BLACK CHARACTERS.

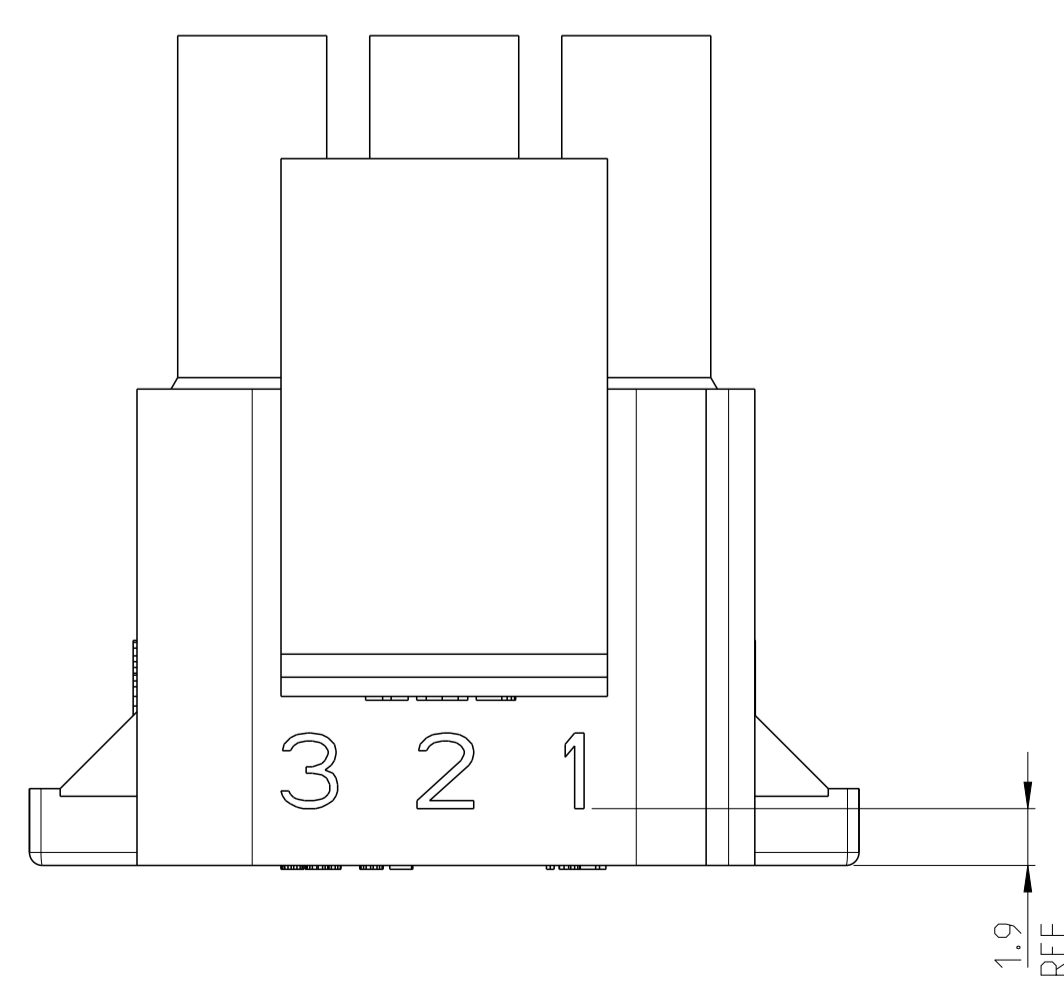
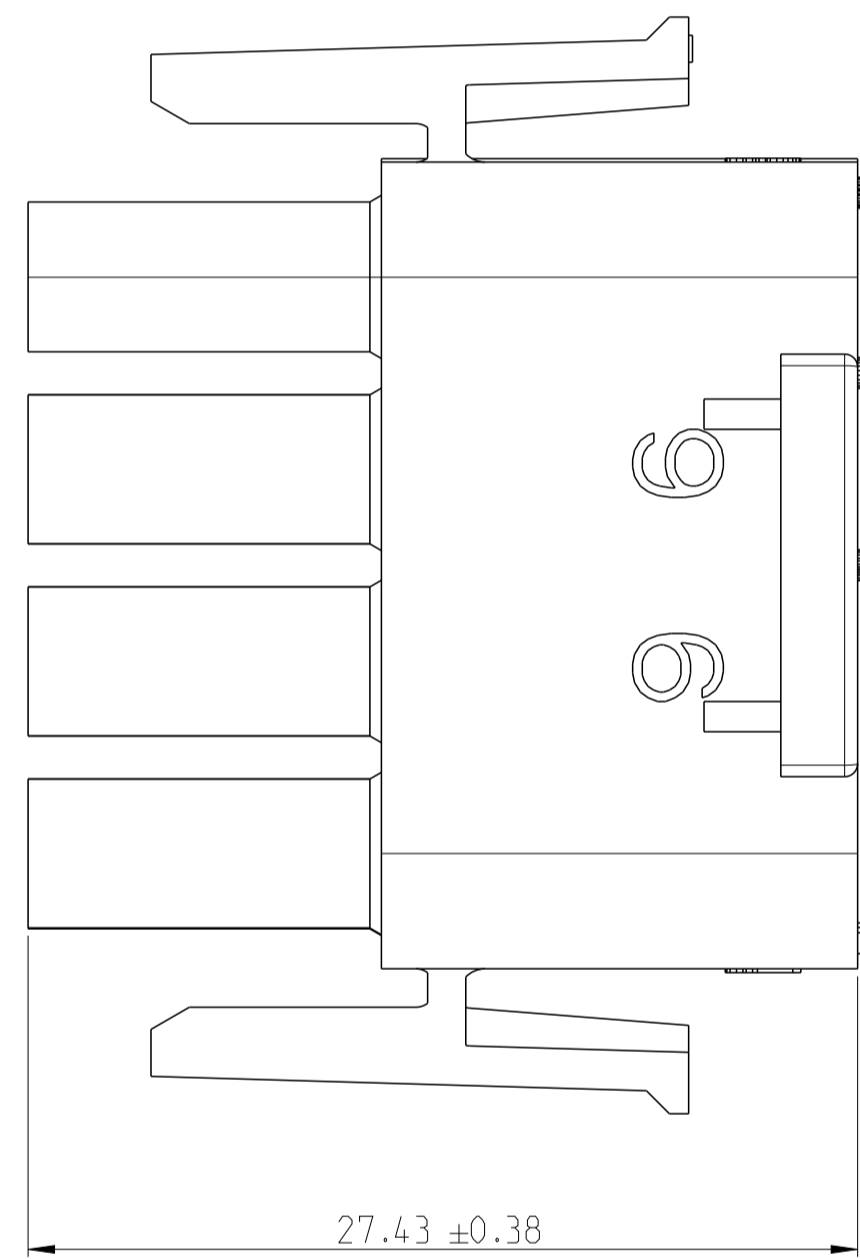
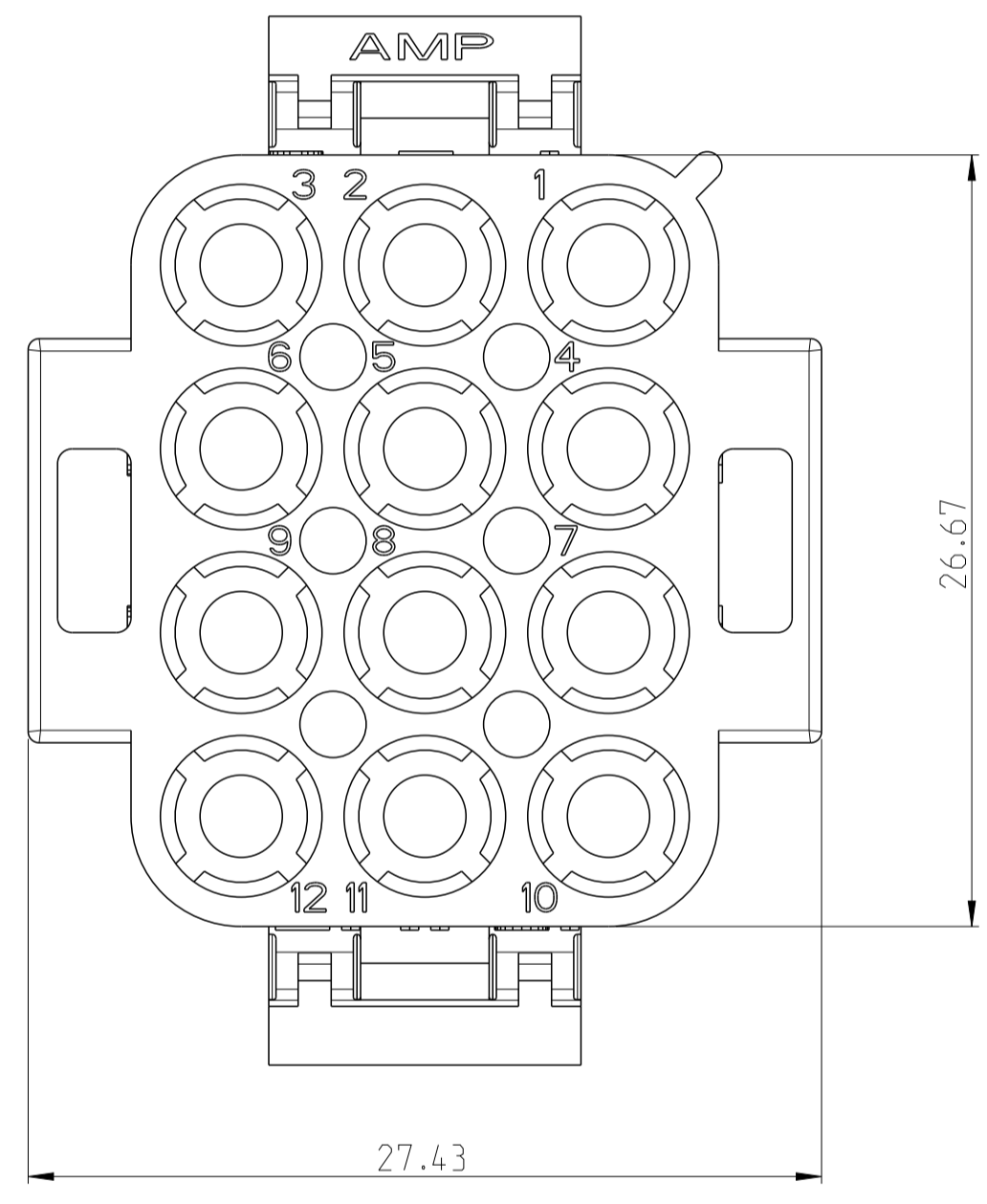
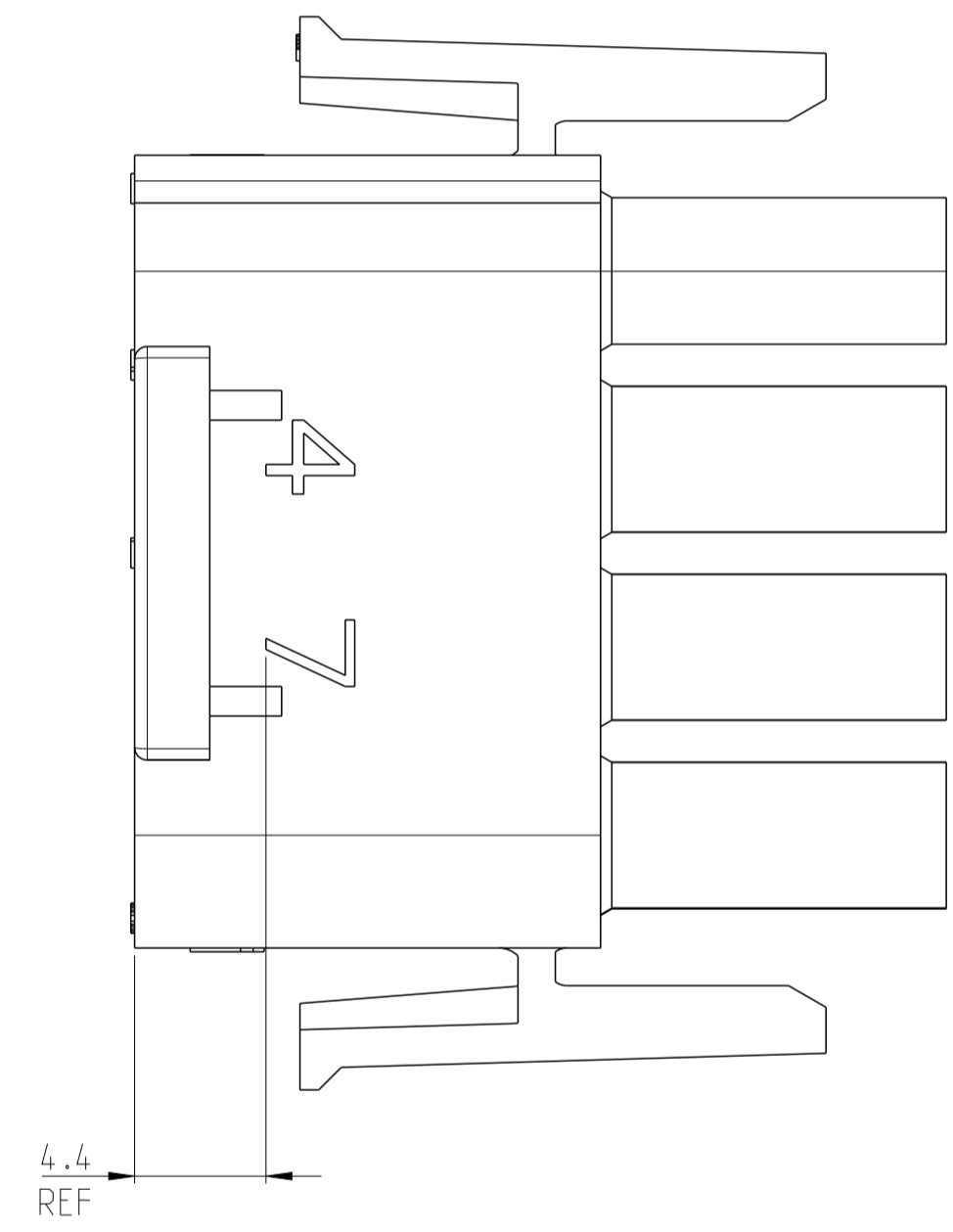

NATURAL	2-480708-0
COLOR	PART NUMBER

THIS DRAWING IS A CONTROLLED DOCUMENT.		DWN: R. WHITAKER 01SEP2004 CHK: S. RIDGILL 01SEP2004 APVD: S. RIDGILL 01SEP2004	TE TE Connectivity
DIMENSIONS: mm	TOLERANCES UNLESS OTHERWISE SPECIFIED: 0 PLC # 1 PLC # 2 PLC #0.13 3 PLC # 4 PLC # ANGLES #0°30' FINISH -	NAME: PLUG, 12 CIRCUIT, UNIVERSAL MATE-N-LOK PRODUCT SPEC - APPLICATION SPEC - WEIGHT -	RESTRICTED TO: -
MATERIAL: NYLON, UL 94V-2		SIZE: A 00779 C=480708 CUSTOMER DRAWING	SCALE: 4:1 SHEET 2 OF 2 REV AP5

Universal MATE-N-LOK* Connector

1. INTRODUCTION

1.1. Purpose

Testing was performed on Universal MATE-N-LOK* connectors to determine their conformance to the requirements of Product Specification 108-1031 Revision J.

1.2. Scope

This report covers the electrical, mechanical, and environmental performance of Universal MATE-N-LOK* connectors. Testing was performed at the Environmental Testing Department of the Automatic Machine Group between 15Sep76 and 12Jan77. The test file number for this testing is ELR 472-1. Additional testing was performed at the Engineering Assurance Product Testing Laboratory between 29May 07 and 04Jun07. The test file number for this testing is CTLB084620-003. This documentation is on file at and available from the Engineering Assurance Product Testing Laboratory.

1.3. Conclusion

The Universal MATE-N-LOK connectors listed in paragraph 1.5, conformed to the electrical, mechanical, and environmental performance requirements of Product Specification 108-1031 Revision J.

1.4. Product Description

This connector system is available in 1, 2, 3, 4, 5, 6, 9, 12 and 15 circuit configurations. Both plug and cap have positive locking housings to prevent accidental disengagement when used in panel mounted applications or as free-hanging connectors. They are molder from 6/6 Nylon 94V2. Contacts are furnished in continuous strip for automatic machine termination and in loose-piece for hand tool crimping. They are made from pre-tin brass and include sockets, solid pins and split pins.

1.5. Test Specimens

Test specimens were representative of normal production lots. Specimens identified with the following part numbers were used for test:

Part Number	Description	Part Number	Description
350867	1circuit plug housing	1-480709-0	12 circuit cap housing
350868	1 circuit cap housing	1-480710-0	15 circuit plug housing
1-480698-0	2 circuit plug housing	1-480711-0	15 circuit cap housing
1-480699-0	2 circuit cap housing	350218-1	Solid pin
1-480700-0	3 circuit plug housing	350536-1	Socket
1-480701-0	3 circuit cap housing	350537-1	Socket
1-480702-0	4 circuit plug housing	350538-1	Solid pin
1-480703-0	4 circuit cap housing	350561-1	Solid pin
1-480704-0	6 circuit plug housing	350570-1	Socket
1-480705-0	6 circuit cap housing	350687-1	Split pin
1-480706-0	9 circuit plug housing	350699-1	Split pin
1-480707-0	9 circuit cap housing	195444-3	Switched probe yoke subassembly
1-480708-0	12 circuit plug housing		

Figure 1

1.6. Environmental Conditions

Unless otherwise stated, the following environmental conditions prevailed during testing:

Temperature: 15 to 35°C

Relative Humidity: 25 to 75%

1.7. Qualification Test Sequence

Test or Examination	Test Group (a)						
	1	2	3	4	5	6	7
	Test Sequence (b)						
Examination of product	1						
Termination resistance, specified current			2				
Termination resistance, dry circuit		4,6,10,12		1,3,5,7			
Dielectric withstanding voltage		2,9,14					
Insulation resistance		3,13					
Temperature rise vs current			1				
Vibration				2			
Physical shock				4			
Mating force		1					
Unmating force		7					
Contact insertion force						1	
Contact retention force						2	
Crimp tensile					1		
Durability		5					
Housing panel retention							1
Housing lock strength		15					
Thermal shock		8					
Humidity/temperature cycling		11					
Salt spray corrosion				6			



NOTE

(a) Each test group shall consist of a minimum of 5 specimens.

(b) Numbers indicate sequence in which tests are performed.

Figure 2

2. SUMMARY OF TESTING

2.1. Examination of Product - All Test Groups

2.2. Specimens were visually examined and no evidence of physical damage detrimental to product performance was observed.

2.3. Termination Resistance, Specified Current - Test Group 3

All termination resistance measurements taken at a specified current of 4.5 amperes for 20 AWG wire and 10 amperes for 14 AWG wire were less than 3 milliohms initially.

2.4. Termination Resistance, Dry Circuit - Test Groups 2 and 4

All termination resistance measurements taken at 100 milliamperes maximum and 50 millivolts maximum open circuit voltage were less than 3.5 milliohms initially.

2.5. Dielectric Withstanding Voltage - Test Group 2 No dielectric breakdown or flashover occurred.

2.6. Insulation Resistance - Test Group 2

All insulation resistance measurements were greater than 1000 megohms initially and 100 megohms after testing.

2.7. Temperature Rise Vs Current - Test Group 3

All specimens had a temperature rise of less than 30°C above ambient when tested using a baseline rated current of 6 amperes for 20 AWG wire in a 12 position housing, 11 amperes for 14 AWG wire in a 12 position housing, 7 amperes for 20 AWG wire in a 4 position housing and 15 amperes for 14 AWG wire in a 4 position housing.

2.8. Vibration - Test Group 4

No discontinuities were detected during vibration testing. Following vibration testing, no cracks, breaks, or loose parts on the specimens were visible.

2.9. Physical Shock - Test Group 4

No discontinuities were detected during physical shock testing. Following physical shock testing, no cracks, breaks, or loose parts on the specimens were visible.

2.10. Mating Force - Test Group 2

All mating force measurements were less than 22.2 N [5 lbf] average per contact for solid pins when fully mated (based on a sample size of 30 mated, loaded housings) and 6.67 N [1.5 lbf] maximum per contact for split pins.

2.11. Unmating Force - Test Group 2

All unmating force measurements were greater than 3.11 N [0.7 lbf] per contact for solid pins and 2.22 N [0.5 lbf] per contact for split pins.