

THIS DRAWING IS UNPUBLISHED. RELEASED FOR PUBLICATION 20
 © COPYRIGHT 20 ALL RIGHTS RESERVED.

LOC	DIST	REVISIONS					
CM	00	P	LTR	DESCRIPTION	DATE	DWN	APVD
		P2		REVISED PER ECR-17-004864	21APR2017	N.L	D.Z

勝特力電材超市-龍山店 886-3-5773766
 勝特力電材超市-光復店 886-3-5729570
 勝特力電子(上海) 86-21-34970699
 勝特力電子(深圳) 86-755-83298787
<http://www.100y.com.tw>

1. ACCEPTS CONTACT P/N 1375819.
2. ACCEPTS MTA-100 KEYING PLUG P/N 641994-1.
3. DIMENSIONS IN BRACKETS ARE IN INCHES.
4. NOT FOR USE WITH CONTACT PART NUMBER 770601 OR 770666.

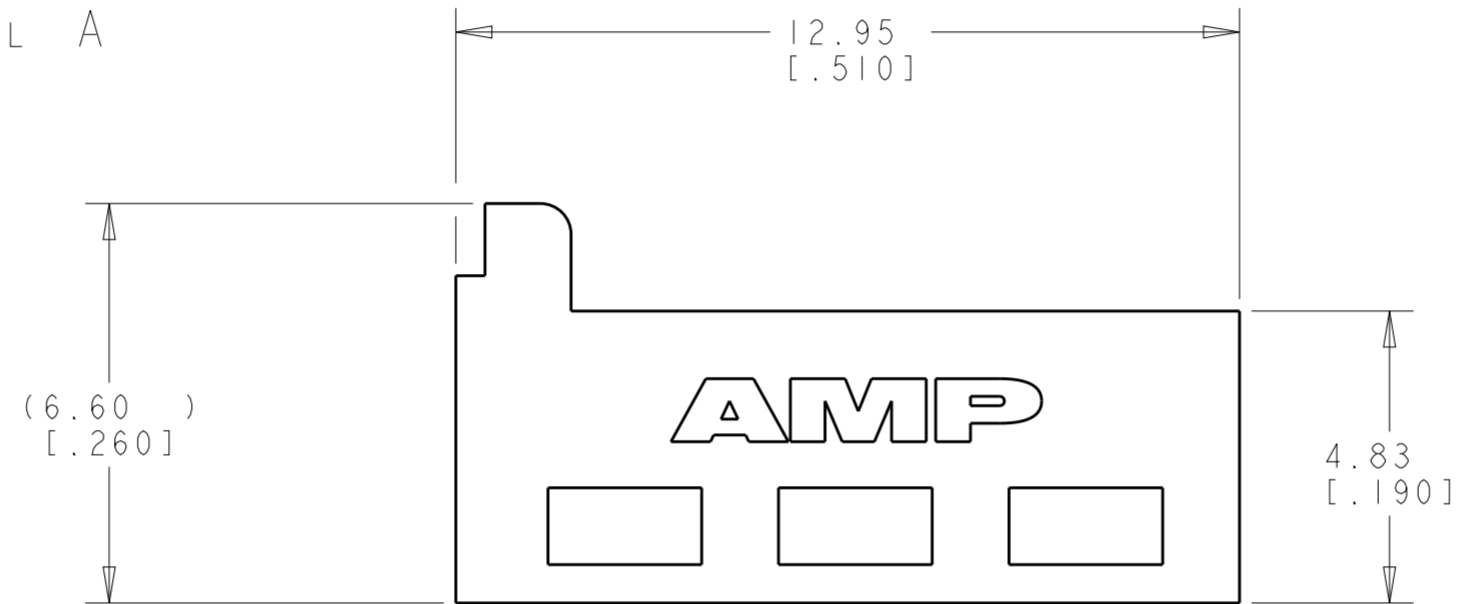
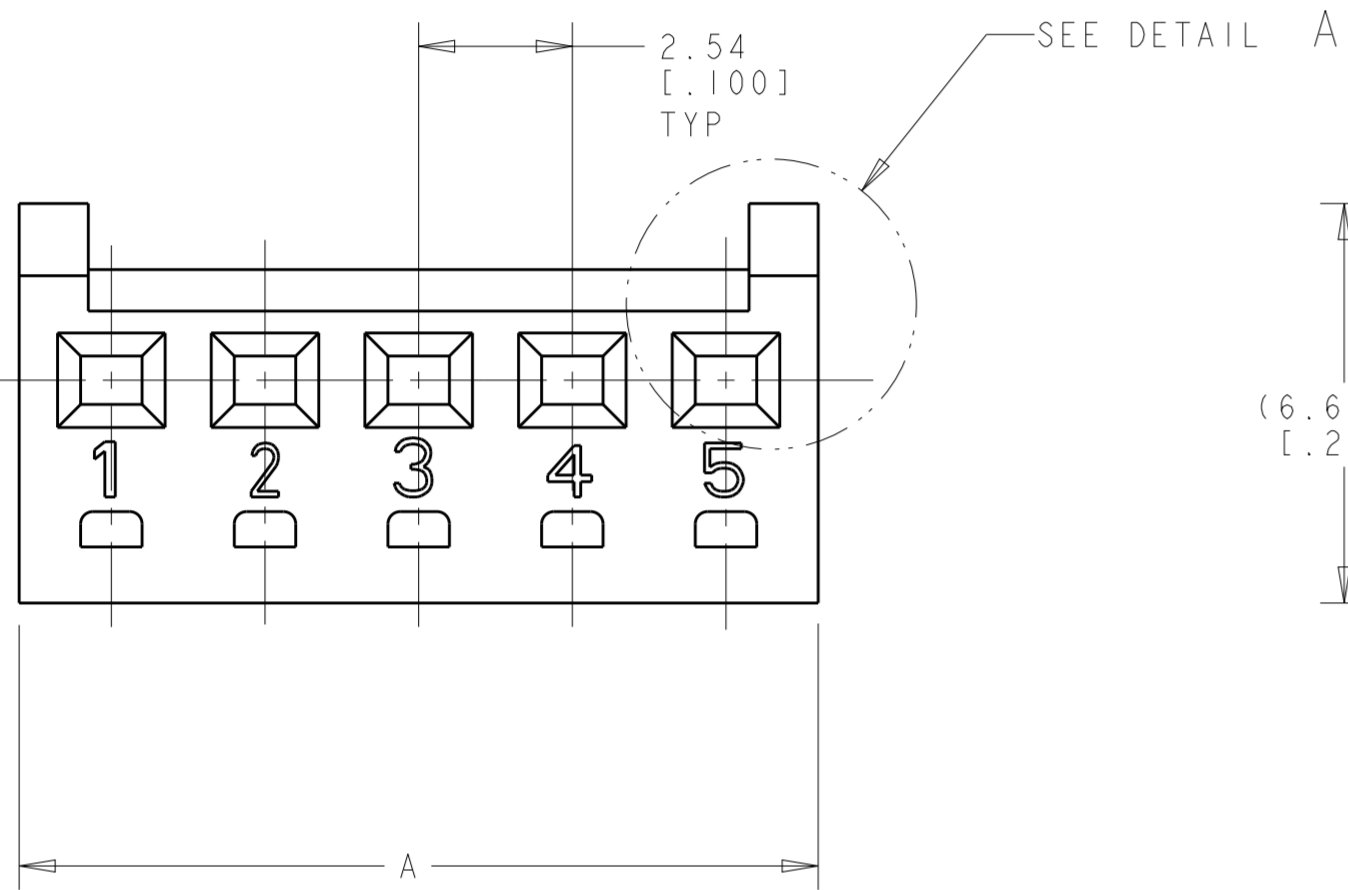

71.63	2.820	28	2-1375820-8
69.09	2.720	27	2-1375820-7
66.55	2.620	26	2-1375820-6
64.01	2.520	25	2-1375820-5
61.47	2.420	24	2-1375820-4
58.93	2.320	23	2-1375820-3
56.39	2.220	22	2-1375820-2
53.85	2.120	21	2-1375820-1
51.31	2.020	20	2-1375820-0
48.77	1.920	19	1-1375820-9
46.23	1.820	18	1-1375820-8
43.69	1.720	17	1-1375820-7
41.15	1.620	16	1-1375820-6
38.61	1.520	15	1-1375820-5
36.07	1.420	14	1-1375820-4
33.53	1.320	13	1-1375820-3
30.99	1.220	12	1-1375820-2
28.45	1.120	11	1-1375820-1
25.91	1.020	10	1-1375820-0
23.37	.920	9	1375820-9
20.83	.820	8	1375820-8
18.29	.720	7	1375820-7
15.75	.620	6	1375820-6
13.21	.520	5	1375820-5
10.67	.420	4	1375820-4
8.13	.320	3	1375820-3
5.59	.220	2	1375820-2
mm	INCH	NO OF CKTS	PART NO
DIM A +0.25/-0.13 [+ .010/- .005]			

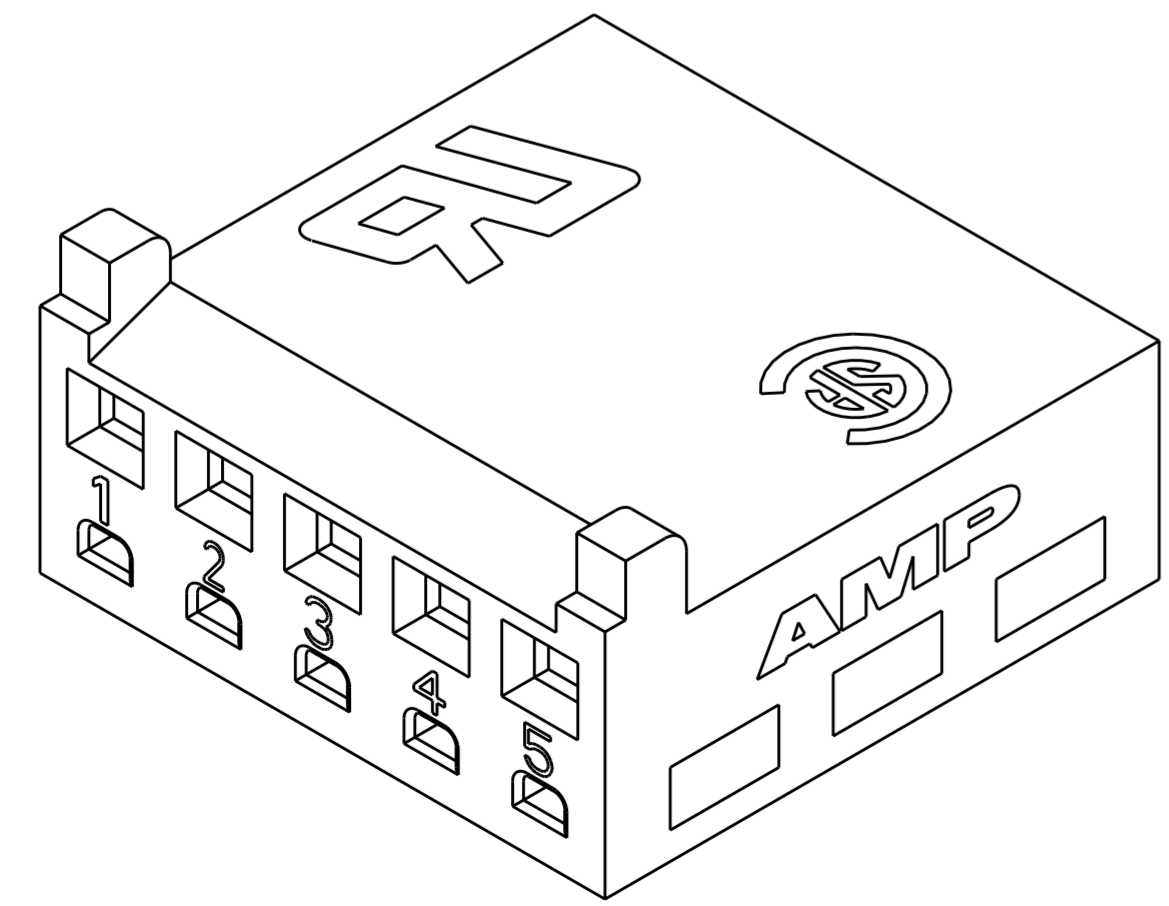
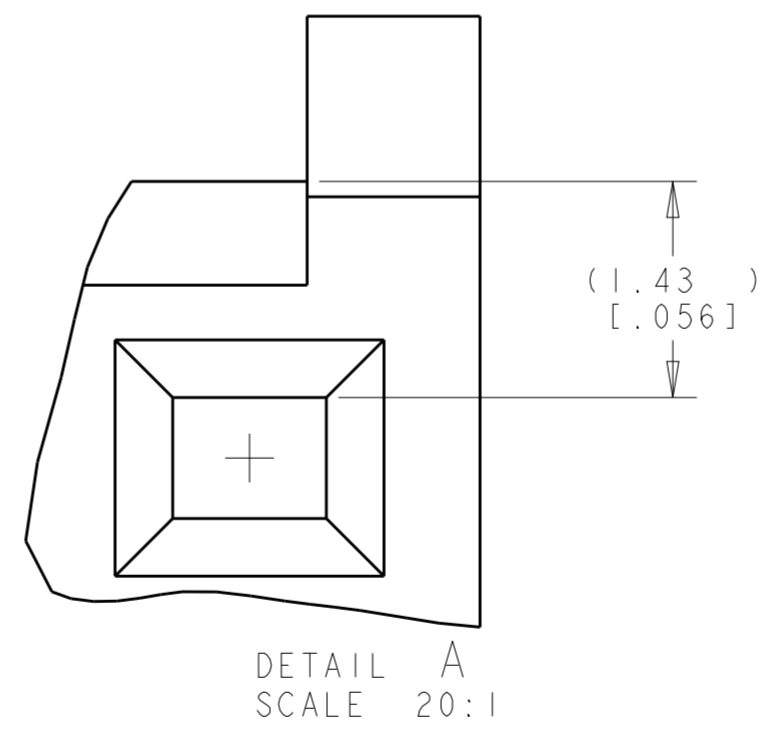

METRIC

THIS DRAWING IS A CONTROLLED DOCUMENT.

DIMENSIONS: mm [INCHES]	TOLERANCES UNLESS OTHERWISE SPECIFIED: 0 PLC ± 1 PLC ± 2 PLC ±0.13 [.005] 3 PLC ± 4 PLC ± ANGLES ± FINISH	MATERIAL NYLON	DWN 21-JUNE-2001 K. WHITAKER CHK 21-JUNE-2001 J. ELLIS APVD 21-JUNE-2001 J. ELLIS	PRODUCT SPEC 108-1948 APPLICATION SPEC 114-13036	WEIGHT -	NAME HOUSING, CST-100 II	SIZE A2	CAGE CODE 00779	DRAWING NO C-1375820	RESTRICTED TO -
CUSTOMER DRAWING						SCALE 8:1	SHEET 1	OF 1	REV P2	

STE TE Connectivity

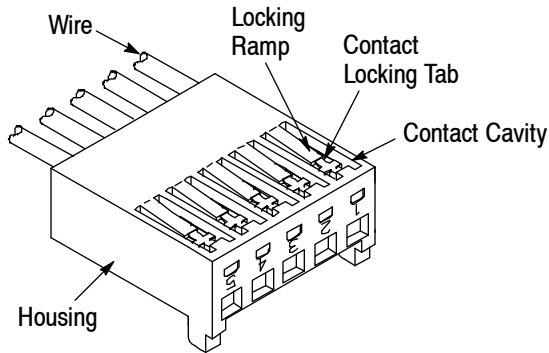

Figure 1

1. INTRODUCTION

CST-100 II Contact 1375819-[] can be extracted from Housing 1375820-[] using a commercially-available precision tweezer with a tip width of 0.38 mm [.015 in.] and tip thickness of 0.25 mm [.010 in.] (approximately). Common listings of this type of tweezer are Pattern 6, Type 6, or 6-SA; or MM, Pattern MM, MM SA, or MM Boley Style.

NOTE



Dimensions in this instruction sheet are in metric units [with U.S. customary units in brackets]. Figures are not drawn to scale.

Read these instructions thoroughly before removing any contacts from the housing.

Reasons for reissue of this instruction sheet are provided in Section 4, REVISION SUMMARY.

2. DESCRIPTION

When properly inserted into the housing contact cavity, the tweezer is used to raise the locking ramp to release the contact locking tab, allowing the contact to be removed from the back (wire end) of the housing. Refer to Figure 1.

3. EXTRACTION PROCEDURE

DANGER



The tips of the tweezer are sharp. To avoid personal injury or damage to the housing, be careful when using the tweezer.

1. Place the housing on a flat surface with the locking ramps facing up.
2. Grasp the wire, and push the contact toward the front (mating end) of the housing so that the locking tab is away from the locking ramp. See Figure 2, Detail A.

3. While keeping the contact in place, position the tweezer over the contact so that the tips straddle the locking tab. See Figure 2, Detail B.

IMPORTANT — To avoid damage to the contact, make sure that the tweezer tips straddle the contact locking tab. Be careful NOT to depress the locking tab.

4. Slightly squeeze the tweezer, and slide the tweezer tips along the locking ramp. *Slowly* pivot the tweezer downward so that the end of the locking ramp raises slightly, only enough to clear the contact locking tab. See Figure 2, Detail C.

IMPORTANT — Be careful not to over-extend the locking ramp. If the end of the locking ramp is raised too much, it will NOT return to its original position.

Detail A

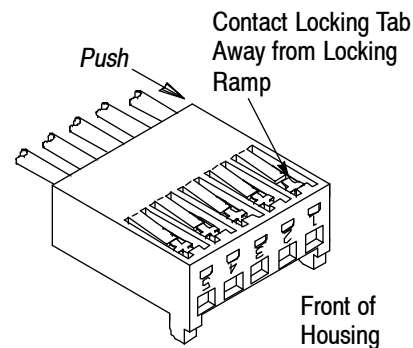

Detail B

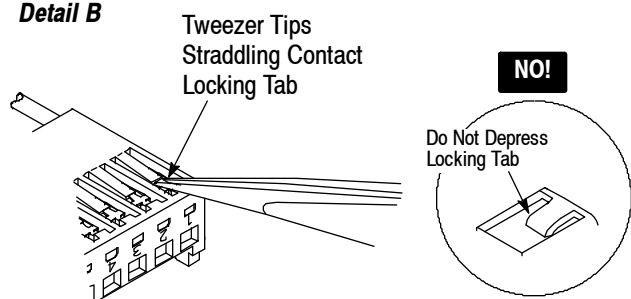

Detail C

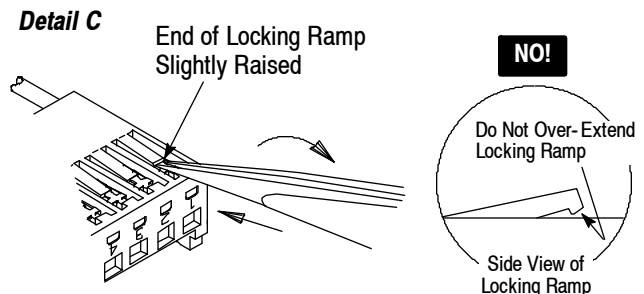

Figure 2

5. While holding the locking ramp in position, *gently* pull back on the wire until the contact is free. See Figure 3. If the contact does not pull out freely, push it back into the housing, and repeat the extraction procedure.

IMPORTANT — DO NOT pull the wire in a harsh manner. If the locking ramp is *not* raised enough to clear the contact locking tab, the locking ramp will be cut or sheared. If the locking ramp is cut or sheared, discard the housing.



DO NOT raise the locking ramp to check for damage; instead, after inserting a contact into that contact cavity, pull back on the wire to ensure that the contact locking tab has engaged the locking ramp. If not, and the contact pulls out, the locking ramp has been damaged.

4. REVISION SUMMARY

Revisions to this instruction sheet include:

- Replaced company logo

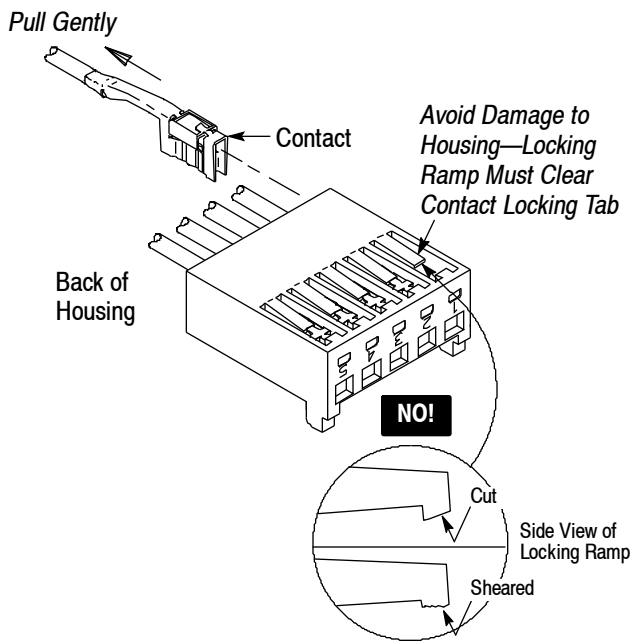

Figure 3