

勝特力材料 886-3-5753170
 勝特力电子(上海) 86-21-34970699
 勝特力电子(深圳) 86-755-83298787
[Http://www.100y.com.tw](http://www.100y.com.tw)

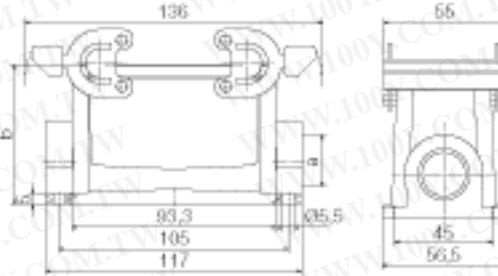

General ordering data

| | |
|------------------|---|
| Order No. | 1656830000 |
| Part designation | HDC 40D SBU 1PG29G |
| Version | HDC enclosures, Size: 6, IP 65 / IP 66, Base, transversal locking, high |
| EAN | 4008190409845 |
| Qty. | 1 pc(s). |

Dimensions

| | |
|----------------------------------|--------|
| Total length | 93 mm |
| Width housing C | 43 mm |
| Width base C1 | 58 mm |
| Height of housing B | 84 mm |
| Height of base B1 | 5 mm |
| Mounting hole distance, width C2 | 45 mm |
| Hole pitch length A2 | 105 mm |
| Cable entry | PG 29 |

General data

| | |
|-----------------------|-------------------|
| Protection class | IP 65 / IP 66 |
| Housing main material | diecast aluminium |
| Colour | grey |
| Temperature, min. | -40 °C |
| Temperature, max. | 125 °C |

Version

| | |
|--------------------------------|---------------|
| Type of housing | Base housing |
| Cable entry | w. threading |
| Number of cable entry on top | 0 |
| Number of cable entry sideways | 1 |
| Cover | without cover |
| Cover | without cover |
| Size | 6 |
| Design | high |
| Upper part/Lower part/Cover | Lower part |

勝特力材料 886-3-5753170
 勝特力电子(上海) 86-21-34970699
 勝特力电子(深圳) 86-755-83298787
[Http://www.100y.com.tw](http://www.100y.com.tw)

Version

locking system Side-locking clamp on lower side
 Cable entry PG 29

Approvals

Approvals institutes



Downloads

| | |
|-------|--|
| EPLAN | 1656830000.MZF |
| PDF | 1656830000_HDC_40D_SBU_1PG29G_STP_Blatt__1.pdf |
| DXF | 1656830000_HDC_40D_SBU_1PG29G_STP.dxf |
| IGES | 1656830000_HDC_40D_SBU_1PG29G_STP.igs |
| STEP | 1656830000_HDC_40D_SBU_1PG29G_STP.stp |
| VRML | 1656830000_HDC_40D_SBU_1PG29G_STP.wrl |

Classifications

| | |
|------------|-------------|
| ETIM 2.0 | EC000437 |
| ETIM 3.0 | EC000437 |
| eClass 4.1 | 40-02-06-14 |
| eClass 5.0 | 27-14-34-19 |
| eClass 5.1 | 27-14-34-19 |

Similar products

| Order No. | Part designation | Version |
|------------|--------------------|---|
| 1899980000 | HDC 16B SBU 1M25G | HDC enclosures, Size: 6, IP 65 / IP 66, Base, transversal locking, standard |
| 1656720000 | HDC 16B SBU 1PG21G | HDC enclosures, Size: 6, IP 65 / IP 66, Base, transversal locking, standard |
| 1788240000 | HDC 16B SBU 2M25G | HDC enclosures, Size: 6, IP 65 / IP 66, Base, transversal locking, standard |
| 1656730000 | HDC 16B SBU 2PG21G | HDC enclosures, Size: 6, IP 65 / IP 66, Base, transversal locking, standard |
| 1902970000 | HDC 40D SBU 1M25G | HDC enclosures, Size: 6, IP 65 / IP 66, Base, transversal locking, high |
| 1902990000 | HDC 40D SBU 1M32G | HDC enclosures, Size: 6, IP 65 / IP 66, Base, transversal locking, high |
| 1787120000 | HDC 40D SBU 2M25G | HDC enclosures, Size: 6, IP 65 / IP 66, Base, transversal locking, high |
| 1787110000 | HDC 40D SBU 2M32G | HDC enclosures, Size: 6, IP 65 / IP 66, Base, transversal locking, high |
| 1656810000 | HDC 40D SBU 2PG21G | HDC enclosures, Size: 6, IP 65 / IP 66, Base, transversal locking, high |
| 1656840000 | HDC 40D SBU 2PG29G | HDC enclosures, Size: 6, IP 65 / IP 66, Base, transversal locking, high |