



产品编号 : 194290016

**Product Description** : MX150L 16 Circuit Panel Mount Plug for 14-22 AWG Wire, Rear Mount Flange Assembly, without Gasket, Black

系列号 : 19429

**状态** : Active

**Product Category** : Connector Housings

---

## 文件和资源

### 图纸

图纸 194290016\_sd.pdf

包装设计图 PK-19429-001-001.pdf

### 3D 模型和设计文件

3D模型 194290016\_stp.zip

### 规格

应用规格 AS-19417-001-001.pdf

产品规格 PS-19417-001-001.pdf

---

## 产物环境合规

### 合规

GADSL/IMDS	Not Relevant
China RoHS	
EU ELV	Not Relevant
Low-Halogen Status	Not Low-Halogen per IEC 61249-2-21
REACH SVHC	Not Contained per D(2023)8585-DC (23 Jan 2024)
EU RoHS	Compliant per EU 2015/863

### 多部分产品合规性声明

- Eu RoHS
- REACH SVHC
- Low-Halogen
  
- IPC 1752A Class C
- IPC 1752A Class D
- Molex Product Compliance Declaration

- IEC-62474

- chemSHERPA (xml)

欧盟 RoHS 合格证书

## 产品详情

### 常规

状态	活动
类别	Connector Housings
系列	19429
说明	MX150L 16 Circuit Panel Mount Plug for 14-22 AWG Wire, Rear Mount Flange Assembly, without Gasket, Black
应用	Power, Wire-to-Wire
评论	For Inside Panel Mount Application; IP67 rated; Conforms to UL 1977; NOT suitable for automotive applications with requirements such as USCAR-2, USCAR-25, GMW3191, AK Testing, J2030, Volvo Technology Requirements, and Toyota Connector Spec (TCS)
产品系列	MX150L Industrial Sealed Connector System
产品名称	MX150L
UPC	822348543496

### 物理

电路数 (最多)	16
颜色-树脂	黑色
性别	Plug
符合灼热丝规范	否
锁定插接部位	是
净重	24.763/g
行数	2
包装形式	Bag
面板安装式	是
间距 - 插配接口	5.84mm
有极性的插配件	是

可堆叠的	否
运行温度范围	-40° to +125° C

---

## 可配插/可连接使用的产品

### 可配插部件

描述	产品编号
MX150L Receptacle Housings	<u>19418</u>

### 可连接使用部件

描述	产品编号
MX150L Gasket for 16 Circuit Plug Housing with Flange	<u><a href="/content/molex/molex-dot-com/cn/zh/products/product-page.html/194270023.html">/content/molex/molex-dot-com/cn/zh/products/product-page.html/194270023.html</a></u>
MX150L Male Terminals and Circuit Voiding Keys	<u>19417</u>

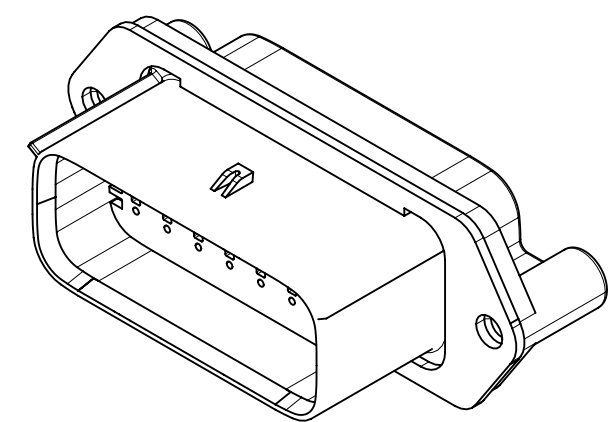
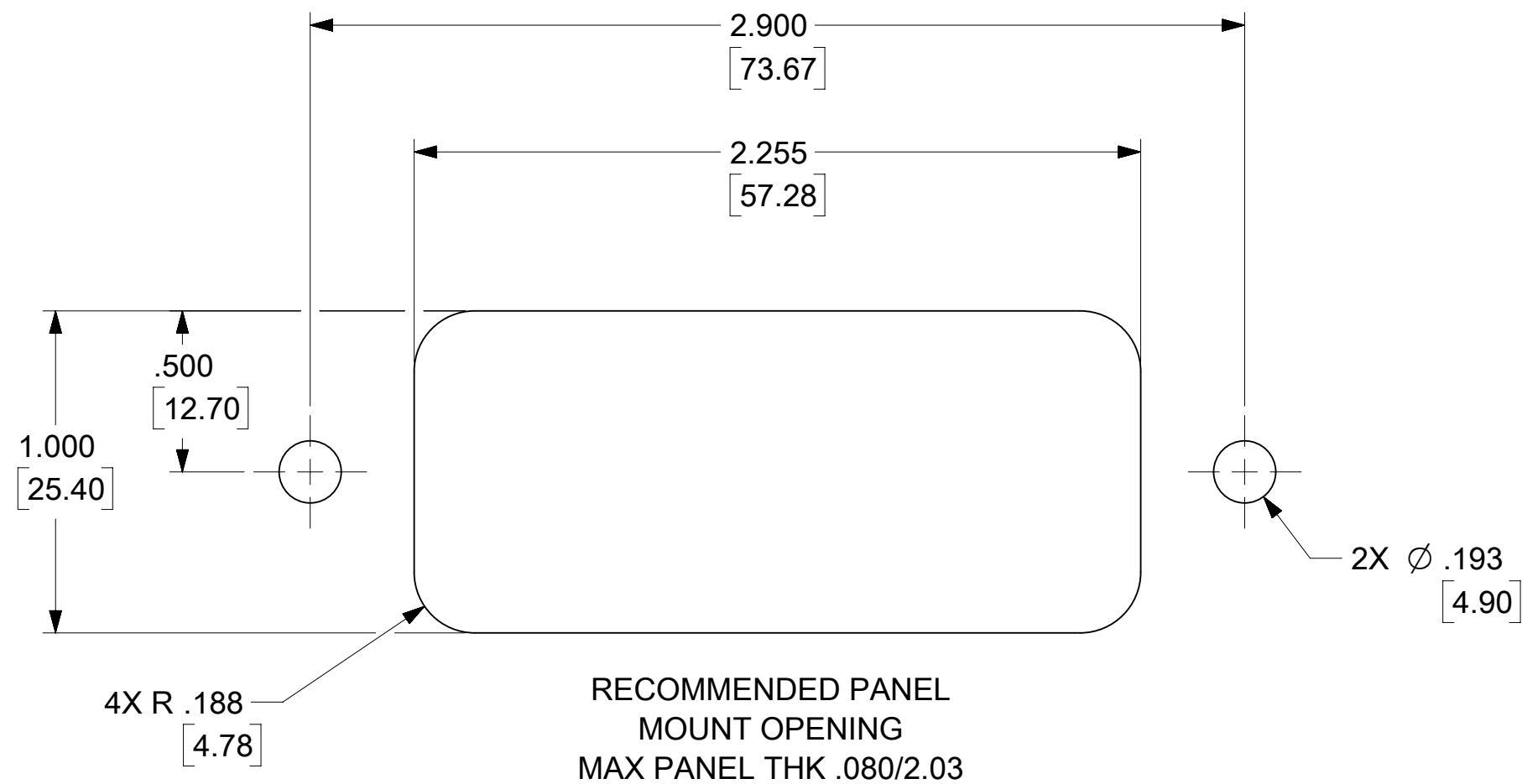
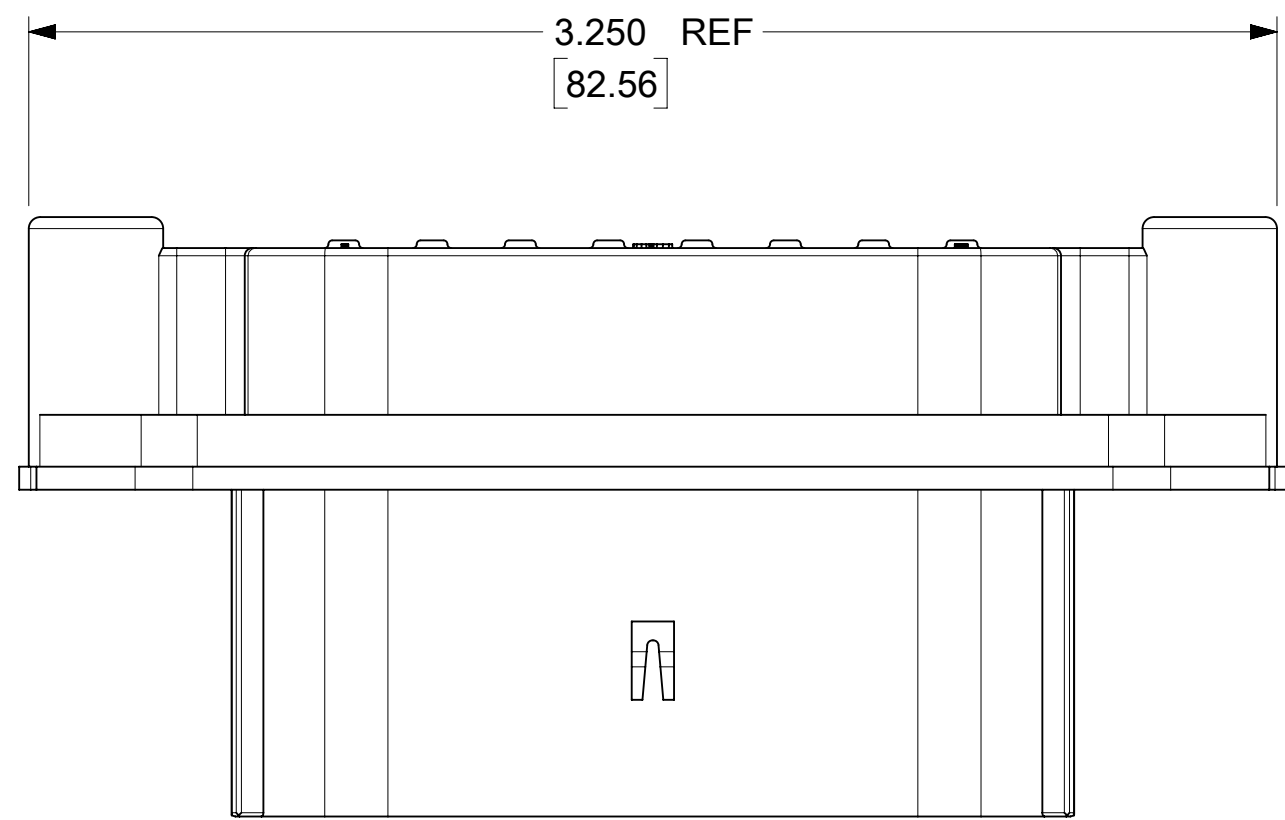

SCALE 1:1

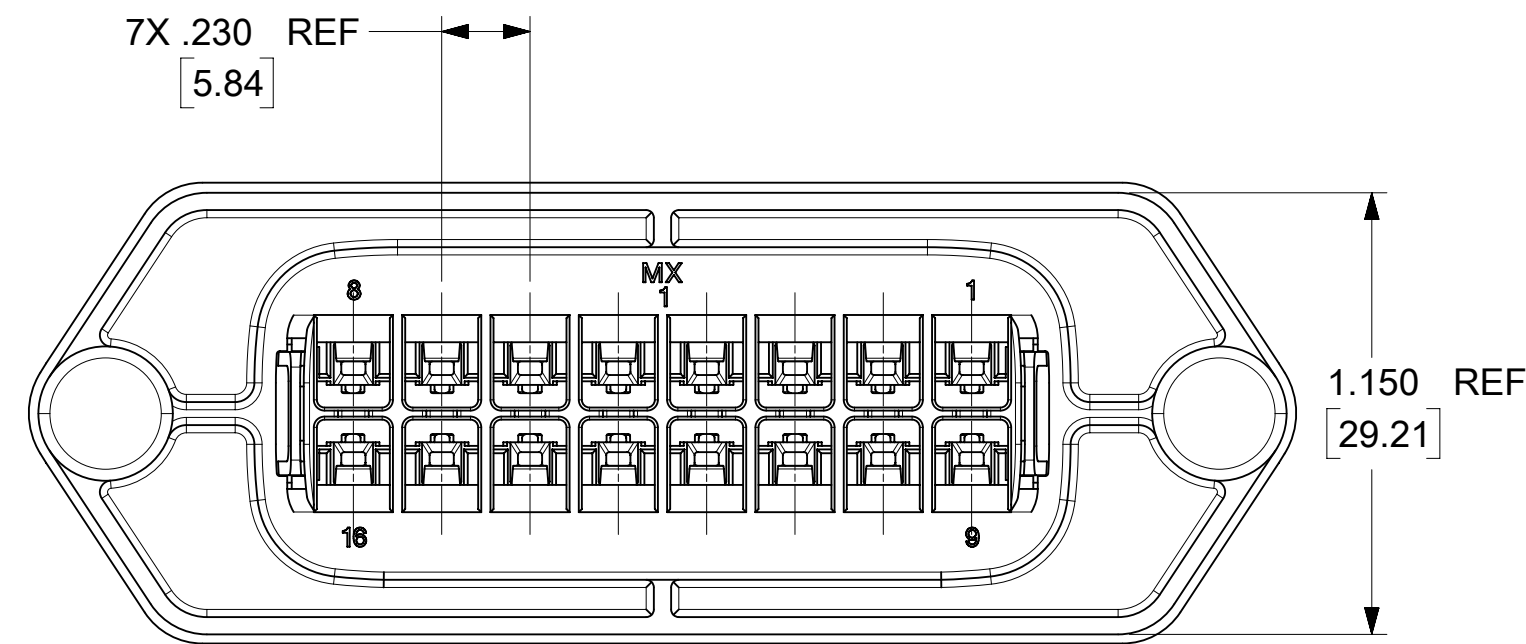
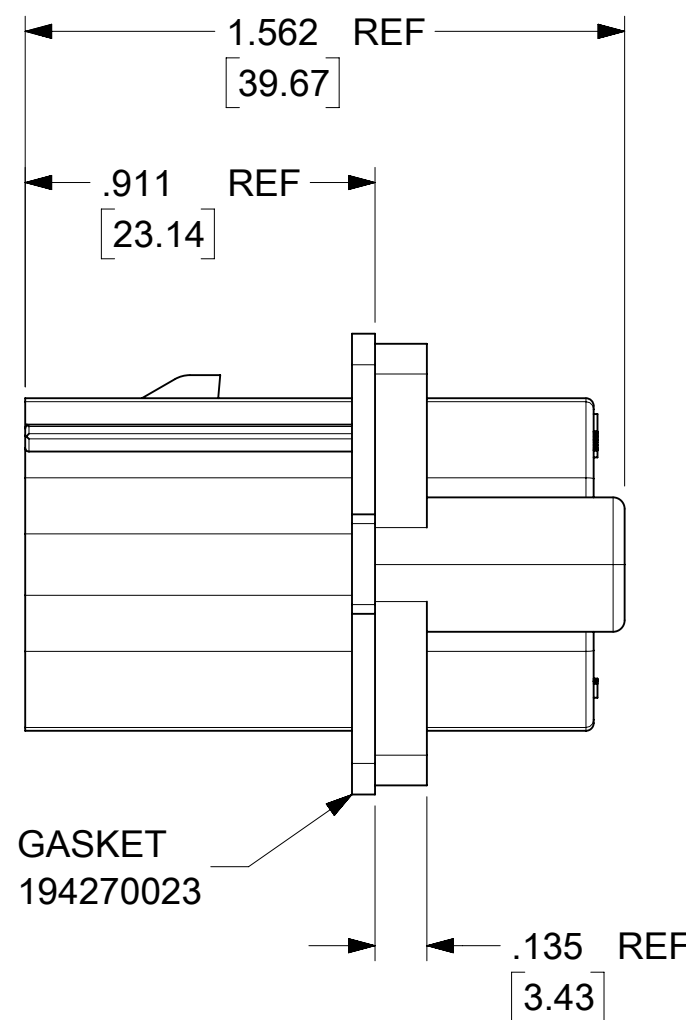
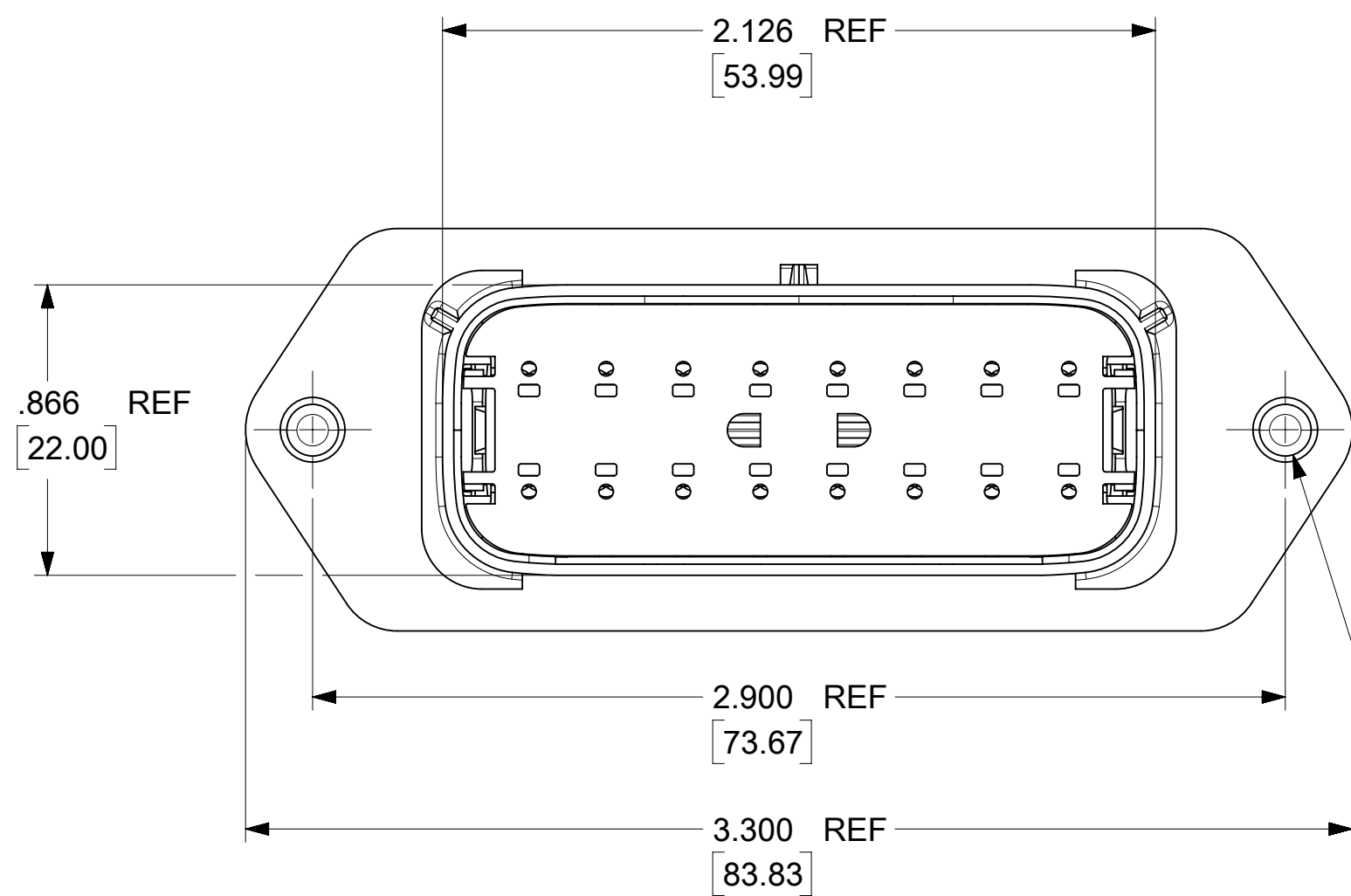

2X Ø .154 X .030 X 45° CHAM [3.91] REF

194290040	YES
194290016	NO
MATERIAL NUMBER	GASKET

- NOTES:
- MATERIALS:  $\text{E}$   
HOUSING: SYNDIOTACTIC POLYSTYRENE (SPS), GLASS FILLED, UL94 V-0, COLOR: BLACK  
GASKET: EPDM RUBBER
  - PRODUCT SPECIFICATION: PS-19417-001.
  - PACKAGING SPECIFICATION: PK-19429-001.  
GASKETS, IF REQUIRED FOR THE ASSEMBLIES, ARE BULK PACKAGED IN A SEPARATE BAG.
  - MATES WITH: 19418 SERIES RECEPTACLE ASSEMBLIES.
  - USE CONNECTOR WITH MALE CRIMP TERMINAL: SERIES 19417.
  - RECOMMENDED MOUNTING HARDWARE: (2)#10 X .62/15.8 LONG PLASTIC THREAD CUTTING SCREWS. RECOMMENDED TORQUE 15-17 IN-LBS. SUGGESTED SOURCE: ITW SHAKEPROOF INDUSTRIAL BOSSCREW OR EQUIVALENT.
  - ASSEMBLY IS ROHS COMPLIANT.

FUNCTIONAL SYMBOLS FA = 0 FC = 0 FP = 0	THIS DRAWING CONTAINS INFORMATION THAT IS PROPRIETARY TO MOLEX ELECTRONIC TECHNOLOGIES, LLC AND SHOULD NOT BE USED WITHOUT WRITTEN PERMISSION		CURRENT REV DESC: REDRAWN IN NX & HSG MATERIAL UPDATED					
	DIMENSION UNITS	SCALE	EC NO: 690910					
	in[mm]	2:1	DRWN: RMV02	2021/12/21				
	GENERAL TOLERANCES (UNLESS SPECIFIED)		CHK'D: DMYRICK	2022/01/05				
	MM	INCH	APPR: JMACNEIL	2022/01/06				
4 PLACES	±	±	INITIAL REVISION:					
3 PLACES	±	± 0.015	DRWN: DMYRICK	03/12/10	DOCUMENT NUMBER	DOC TYPE	DOC PART	REVISION
2 PLACES	±	0.38	APPR: DTITUS	2010/10/18	SD-19429-008	PSD	001	E
1 PLACE	±	±	DRAFT WHERE APPLICABLE MUST REMAIN WITHIN DIMENSIONS		MATERIAL NUMBER	CUSTOMER	SHEET NUMBER	
0 PLACES	±	±	THIRD ANGLE PROJECTION	DRAWING	SEE CHART	GENERAL MARKET	1 OF 1	
				C-SIZE	SERIES	19429		

DOCUMENT STATUS	P1	RELEASE DATE	2022/01/06	14:54:33
-----------------	----	--------------	------------	----------