



产品编号 : 438600006

**Product Description** : Modular Jack, Right-Angle, Low Profile, Inverted, Shielded, All Panel Grounding Tabs, 6/4

系列号 : 43860

**状态** : Active

**Product Category** : Modular Jacks and Plugs

---

## 文件和资源

### 图纸

图纸 438600006\_sd.pdf

包装设计图 PK-43860-005-001.pdf

### 3D 模型和设计文件

3D模型 438600006\_stp.zip

### 规格

应用规格 AS-43860-001-001.pdf

产品规格 PS-43860-003-001.pdf

测试摘要 TS-43860-001-001.pdf

---

## 产物环境合规

### 合规

|                    |   |
|--------------------|---|
| GADSL/IMDS         | Not Relevant  |
| China RoHS         |  |
| EU ELV             | Not Relevant  |
| Low-Halogen Status | Not Low-Halogen per IEC 61249-2-21  |
| REACH SVHC         | Not Contained per D(2023)8585-DC (23 Jan 2024)  |
| EU RoHS            | Compliant per EU 2015/863   |

### 多部分产品合规性声明

- Eu RoHS
- REACH SVHC
- Low-Halogen
  
- IPC 1752A Class C
- IPC 1752A Class D
- Molex Product Compliance Declaration

- IEC-62474

- chemSHERPA (xml)

欧盟 RoHS 合格证书

---

## 产品详情

### 常规

|             |   |
|-------------|---|
| 状态          | 活动  |
| 类别          | Modular Jacks and Plugs   |
| 系列          | 43860   |
| 说明          | Modular Jack, Right-Angle, Low Profile, Inverted, Shielded, All Panel Grounding Tabs, 6/4 |
| 元件类型        | PCB Jack  |
| 磁性的         | 否   |
| 性能分类        | 3   |
| 以太网电源 (PoE) | 不适用   |
| 产品系列        | Magnetic and Modular Jacks/Plugs  |
| 产品名称        | Modular Jack 6/4  |
| UPC         | 800753919969  |

### 机构

|     |         |
|-----|---------|
| CSA | LR19980 |
| UL  | E107635 |

### 电气

|         |               |
|---------|---------------|
| 每触点最大电流 | 1.5A          |
| 面板接地    | 是             |
| PCB接地   | 是             |
| 屏蔽      | 是             |
| 电压 - 最大 | 150V AC (RMS) |

### 物理

|                  |     |
|------------------|-----|
| 衬套颜色             | 不适用 |
| 颜色-树脂            | 黑色  |
| 耐用性(插拔次数) - 最多次数 | 500 |

|             |                                |
|-------------|--------------------------------|
| 阻燃性         | 94V-0                          |
| 向下 / 向上锁门   | 是                              |
| 插孔高度        | 13.53mm                        |
| 光管/发光二极管    | 无                              |
| 材料 - 金属     | Brass, Phosphor Bronze         |
| 材料 - 接合部位电镀 | 金牌                             |
| 材料 - 终端电镀   | Tin                            |
| 材料 - 树脂     | High Temperature Thermoplastic |
| 净重          | 3.672/g                        |
| 方向          | Right Angle (Side Entry)       |
| 包装形式        | Tray                           |
| 面板安装式       | With Flange                    |
| PCB 定位器     | 是                              |
| PCB 保持力     | 是                              |
| 推荐的 PCB 厚度  | 1.60mm                         |
| 间距 - 插配接口   | 1.02mm                         |
| 间距 - 终端界面   | 1.02mm                         |
| 最薄镀层 - 接合部位 | 1.270µm                        |
| 最薄镀层 - 端接   | 2.540µm                        |
| 端口配置        | 1x1                            |
| 位置/插入的接头    | 6/4                            |
| 运行温度范围      | -40° to +85° C                 |
| 终端界面类型      | Through Hole                   |
| 防水/防尘       | 否                              |
| 导线/电缆型号     | 不适用                            |

## 进程

|    |      |
|----|------|
| 无铅 | WAVE |
|----|------|

---

## 可配插/可连接使用的产品

### 可配插部件

| 描述   | 产品编号         |
|------|--------------|
| 配插使用 | FCC 68 Plugs |

---

---

This document was generated on Jun 03, 2024

NOTES:

- 1) MATERIAL:  
HOUSING: NYLON(PA), GLASS FILLED, UL94V-0, COLOR: SEE CHART  
TERMINALS: PHOSPHOR BRONZE
- 2) FINISH:  
TERMINALS:  
SELECT GOLD IN CONTACT AREA: 50 MICROINCHES (1.27 MICROMETERS) MIN.,  
SELECT TIN IN PC TAIL AREA: 100 MICROINCHES (2.54 MICROMETERS) MIN.,  
WITH OVERALL NICKEL UNDERPLATE: 50 MICROINCHES (1.27 MICROMETERS) MIN.
- 3) PRODUCT SPECIFICATION: PS-43860-003.
- 4) PACKAGING SPECIFICATION:  
CONNECTOR ASSEMBLIES PACKAGED IN EXTRUDED TUBES PER MOLEX  
PACKAGING SPECIFICATION PK-43860-004.
- 5) ALL UNTOLERANCED DIMENSIONS ARE SHOWN FOR REFERENCE ONLY.
- 6) CONFORMS TO FCC REGULATION PART 68.5 FOR MODULAR JACKS.
- 7) THIS PART CONFORMS TO CLASS B REQUIREMENTS OF COSMETIC  
SPECIFICATION PS-45499-002.

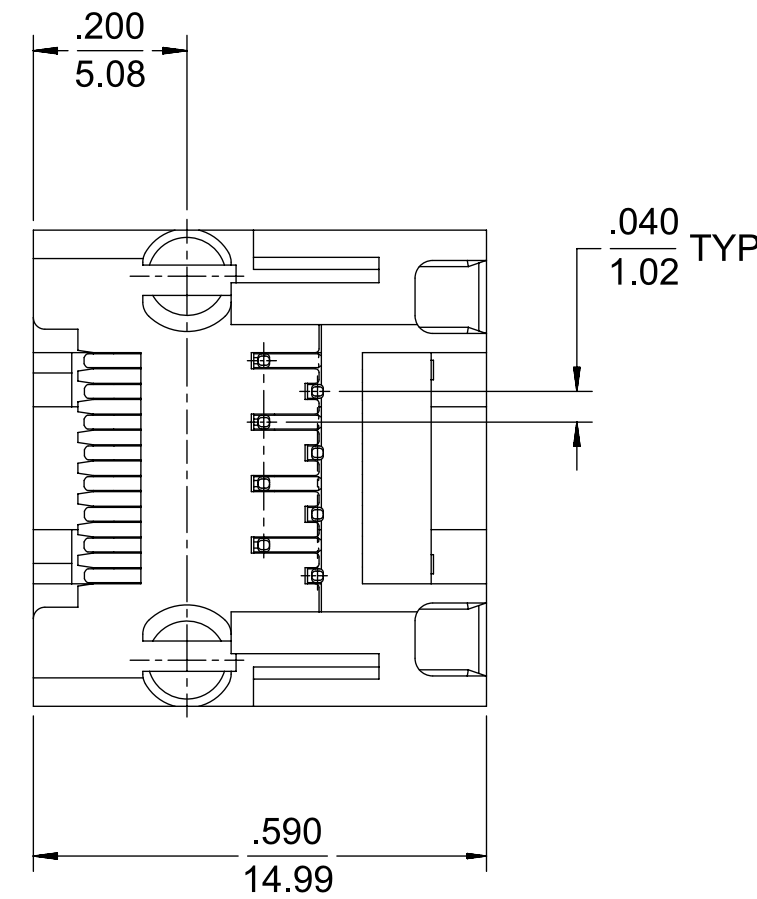
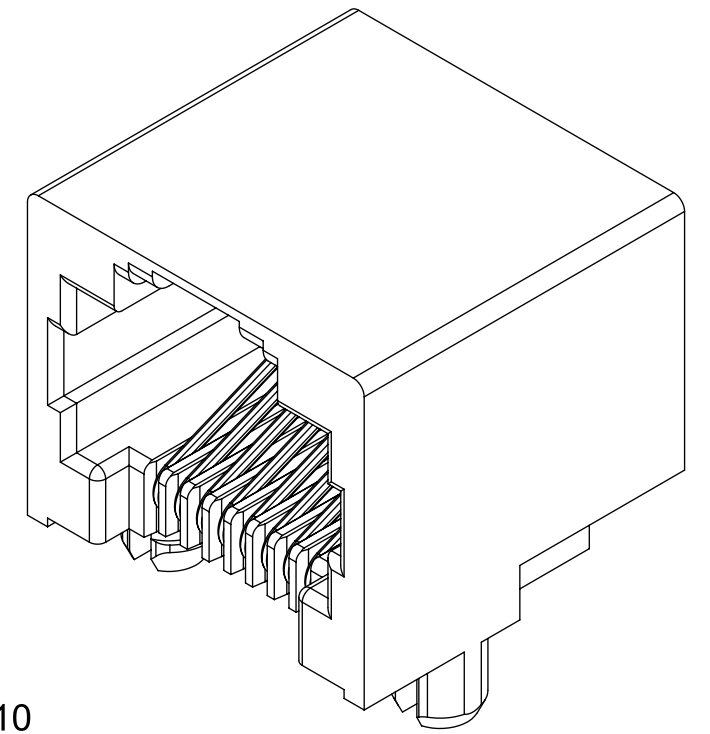
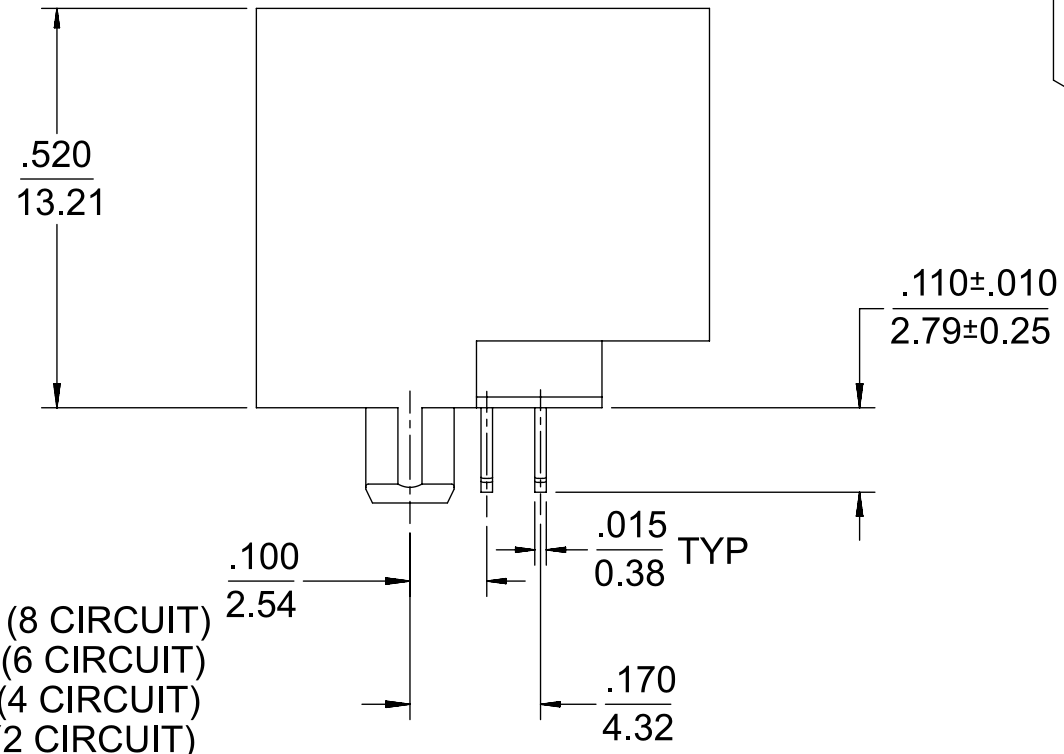
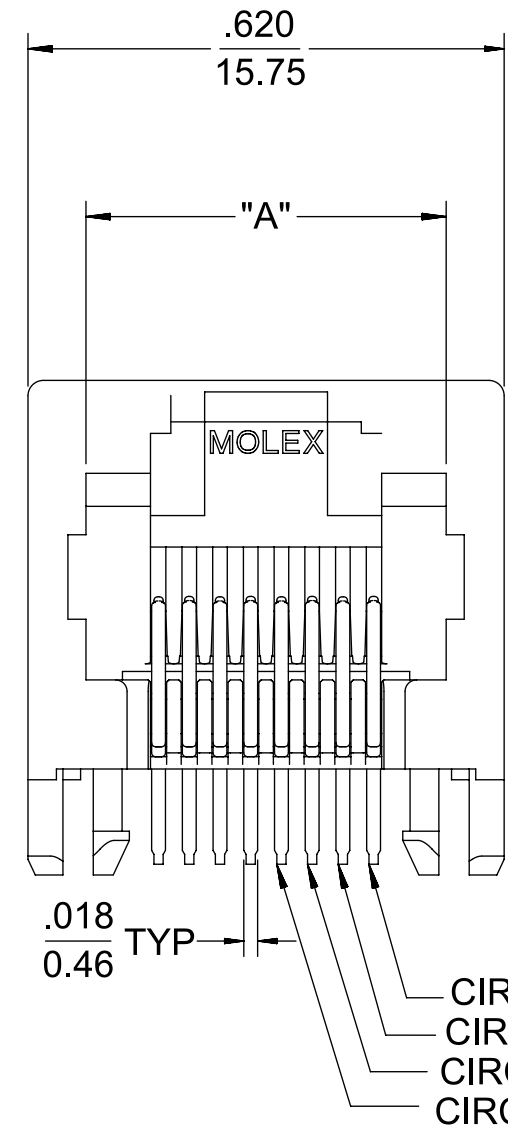
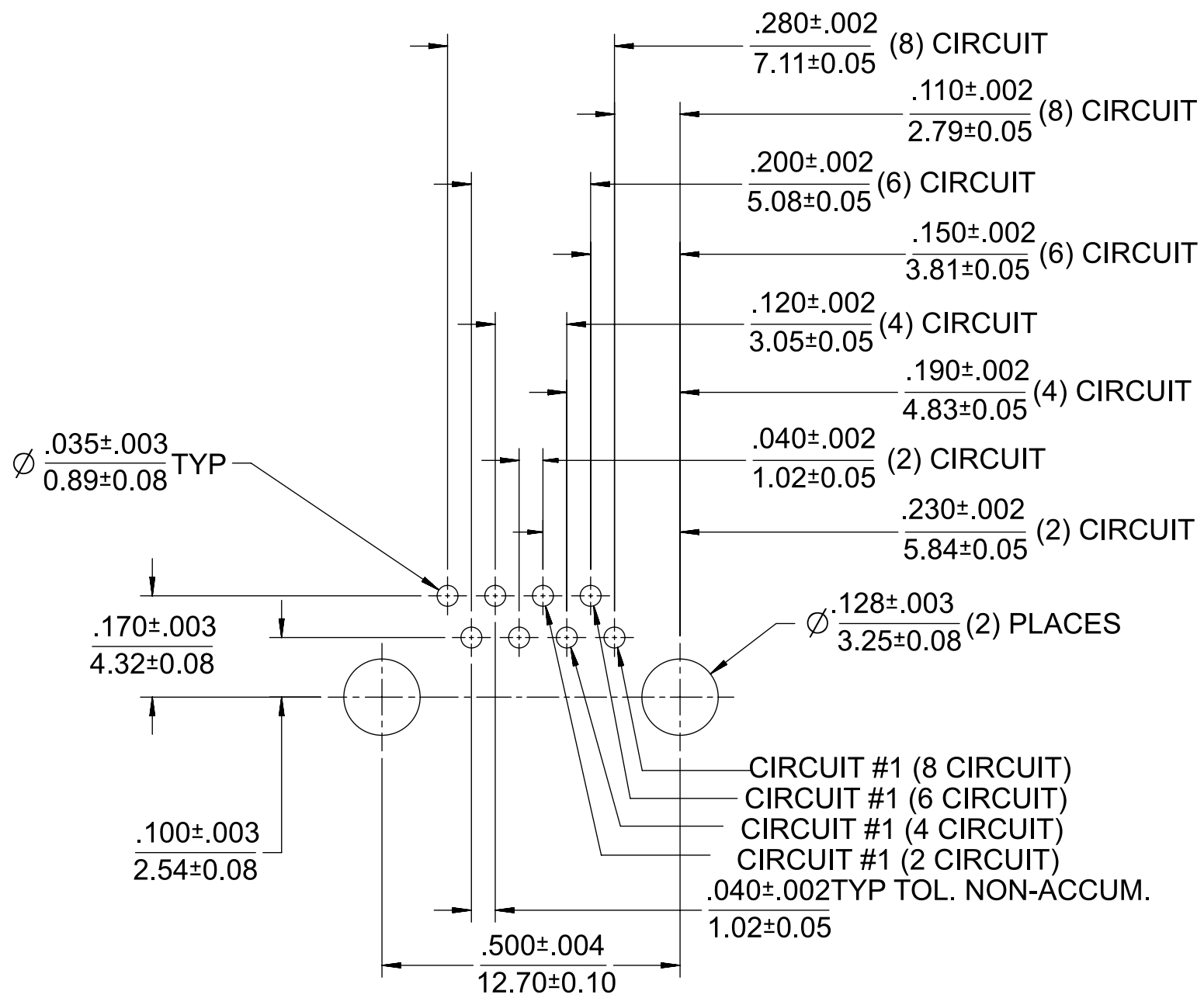

| ASSEMBLY MAT. NUM. | CONNECTOR SIZE | DIM "A"    | CIRCUITS | HOUSING COLOR |
|--------------------|----------------|------------|----------|---------------|
| 43860-0001         | 8              | .469/11.91 | 8        | BLACK         |
| 43860-0002         | 6              | .389/9.88  | 6        | BLACK         |
| 43860-0003         | 6              | .389/9.88  | 4        | BLACK         |
| 43860-0020         | 6              | .389/9.88  | 2        | BLACK         |

|  |   |                        |   |              |
|--|---|------------------------|---|--------------|
| FUNCTIONAL SYMBOLS                                   | THIS DRAWING CONTAINS INFORMATION THAT IS PROPRIETARY TO MOLEX ELECTRONIC TECHNOLOGIES, LLC AND SHOULD NOT BE USED WITHOUT WRITTEN PERMISSION |                        |   |              |
|  | DIMENSION UNITS   | SCALE                  | CURRENT REV DESC: REMOVED OBSOLETE PART NUMBERS AS PER PCN#512600       |              |
| $\frac{F}{A} = 0$                                    | IN/mm   | 4:1                    | <b>molex</b><br>INVERTED MODULAR JACK ASSEMBLY<br>PRODUCT SALES DRAWING |              |
| $\frac{F}{C} = 0$                                    | GENERAL TOLERANCES (UNLESS SPECIFIED)   |                        |   |              |
| $\frac{F}{P} = 0$                                    | MM  | INCH                   |   |              |
| DIVISIONAL SYMBOLS                                   | 4 PLACES  | ±                      |   |              |
|  | 3 PLACES  | ±                      | ± 0.0100  |              |
|  | 2 PLACES  | ± 0.250                | ±   |              |
|  | 1 PLACE   | ±                      | ±   |              |
|  | 0 PLACES  | ±                      | ±   |              |
|  | ANGULAR TOL   | ± 0.5°                 |   |              |
| DRAFT WHERE APPLICABLE MUST REMAIN WITHIN DIMENSIONS |   | THIRD ANGLE PROJECTION | DRAWING   | SERIES       |
|  |   |                        | C-SIZE  | 43860        |
|  |   | DRWN: Madhava M        | 2023-10-26  |              |
|  |   | CHK'D: Ganesh Rao B    | 2023-12-20  |              |
|  |   | APPR: Gurunandan GA    | 2023-12-20  |              |
|  |   | INITIAL REVISION:      |   |              |
|  |   | DRWN: TALEND           | 1997/02/13  |              |
|  |   | APPR: FRY              | 1997/03/04  |              |
|  |   | PHASE:                 |   |              |
|  |   | CO NO:                 |   |              |
|  |   | DOCUMENT NUMBER        | DOC TYPE  | DOC PART     |
|  |   | SD-43860-001           | PSD   | 001          |
|  |   | MATERIAL NUMBER        | CUSTOMER  | SHEET NUMBER |
|  |   | SEE TABLE              | GENERAL MARKET  | 1 OF 5       |

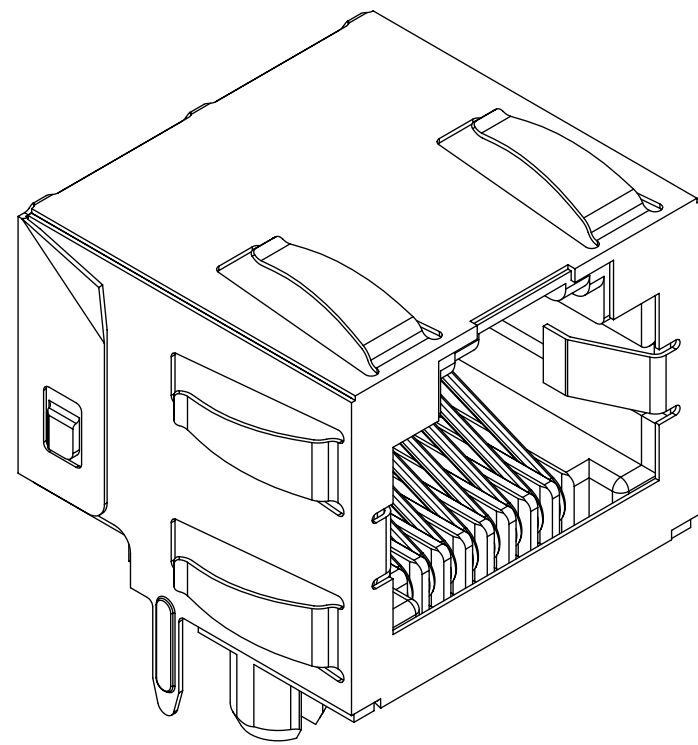

**NOTES:**

- 1) MATERIAL:  
HOUSING: NYLON(PA), GLASS FILLED, UL94V-0,  
COLOR: BLACK  
TERMINALS: PHOSPHOR BRONZE  
SHIELD: BRASS
- 2) FINISH:  
TERMINALS:  
SELECT GOLD IN CONTACT AREA: 50 MICROINCHES/  
1.27 MICROMETERS MIN.,  
SELECT TIN IN PC TAIL AREA: 100 MICROINCHES/  
2.54 MICROMETERS MIN.,  
WITH OVERALL NICKEL UNDERPLATE: 50 MICROINCHES/  
1.27 MICROMETERS MIN.  
SHIELD:  
100 MICROINCHES/2.54 MICROMETERS NICKEL OVER  
50 MICROINCHES/1.27 MICROMETERS COPPER  
UNDERPLATE; PCB GROUND TABS DIPPED IN TIN
- 3) PRODUCT SPECIFICATION: PS-43860-003.
- 4) PACKAGING SPECIFICATION:  
CONNECTOR ASSEMBLIES PACKAGED IN THERMOFORMED TRAYS  
PER MOLEX PACKAGING SPECIFICATION PK-43860-005.  
43860-5025 CONNECTOR ASSEMBLIES PACKAGED IN TAPE AND  
REEL PER MOLEX PACKAGING SPECIFICATION PK-70873-700\*
- 5) ALL UNTOLERANCED DIMENSIONS ARE SHOWN FOR REFERENCE ONLY.
- 6) CONFORMS TO FCC REGULATION PART 68.5 FOR MODULAR JACKS.
- 7) AVAILABLE WITH THE (2) SPECIFIED PANEL GROUND TABS  
OMITTED FOR SIDE TO SIDE STACKABILITY, PER THE ASSEMBLY  
MATERIAL NUMBER TABLE.
- 8) AVAILABLE WITH TOP PANEL GROUND TABS ONLY, PER THE  
ASSEMBLY MATERIAL NUMBER TABLE.
- 9) THIS PART CONFORMS TO CLASS B REQUIREMENTS OF COSMETIC  
SPECIFICATION PS-45499-002.

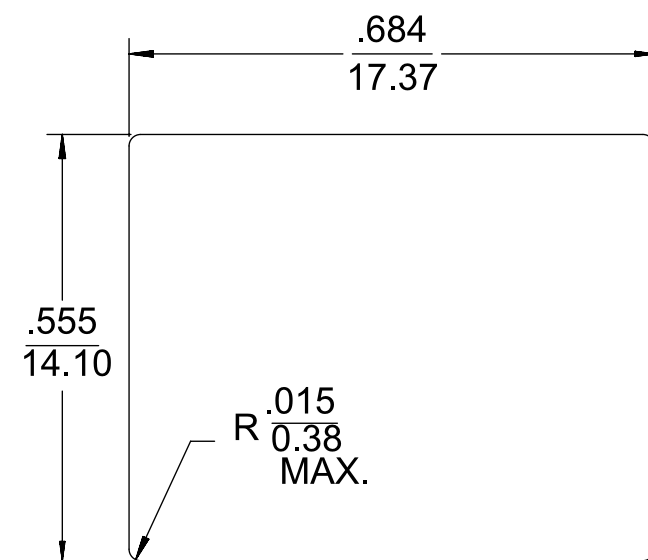
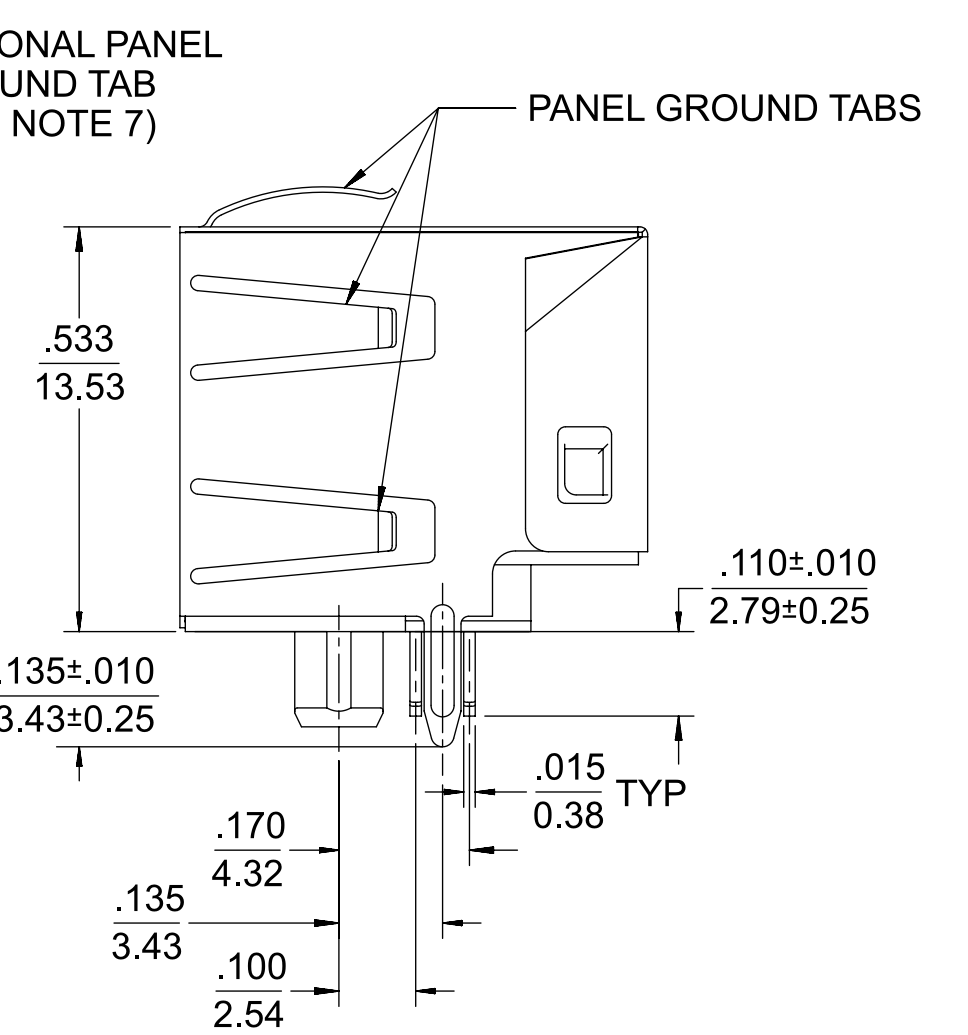
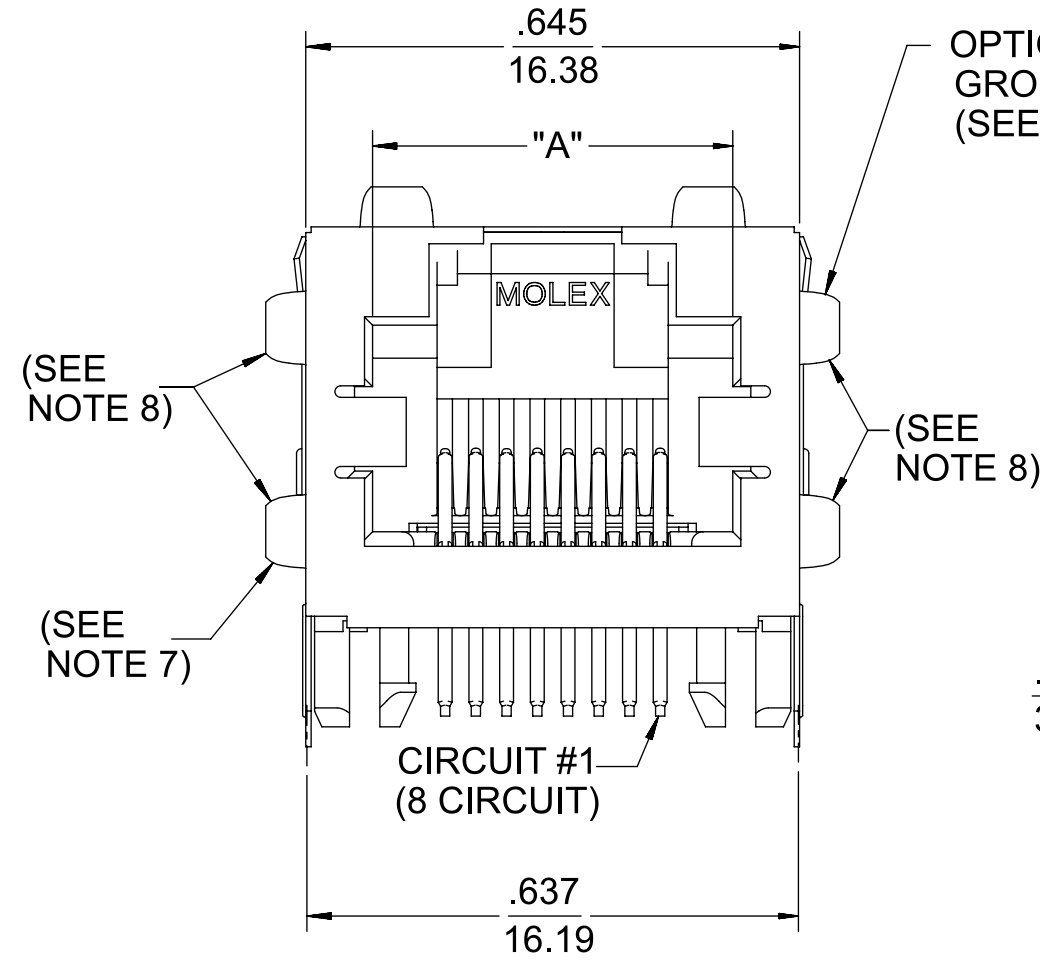
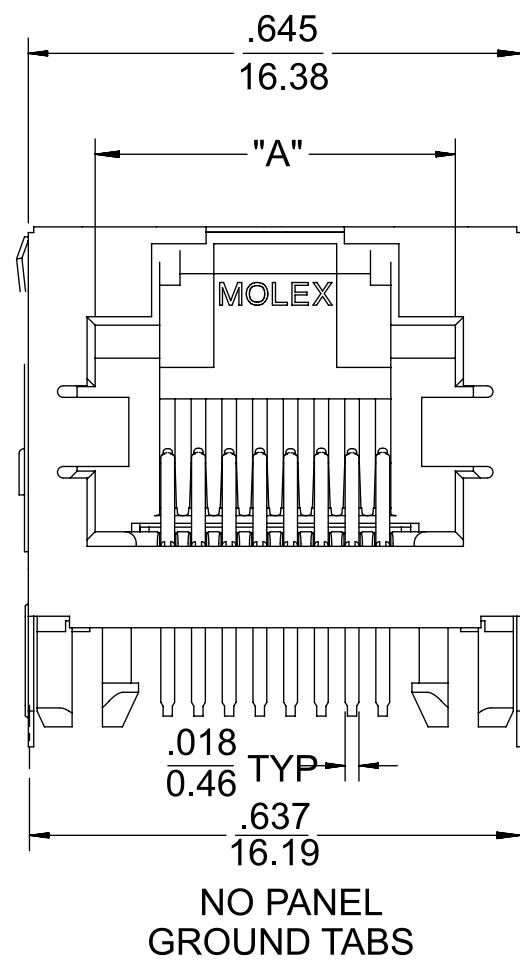

RECOMMENDED  
PANEL  
OPENING

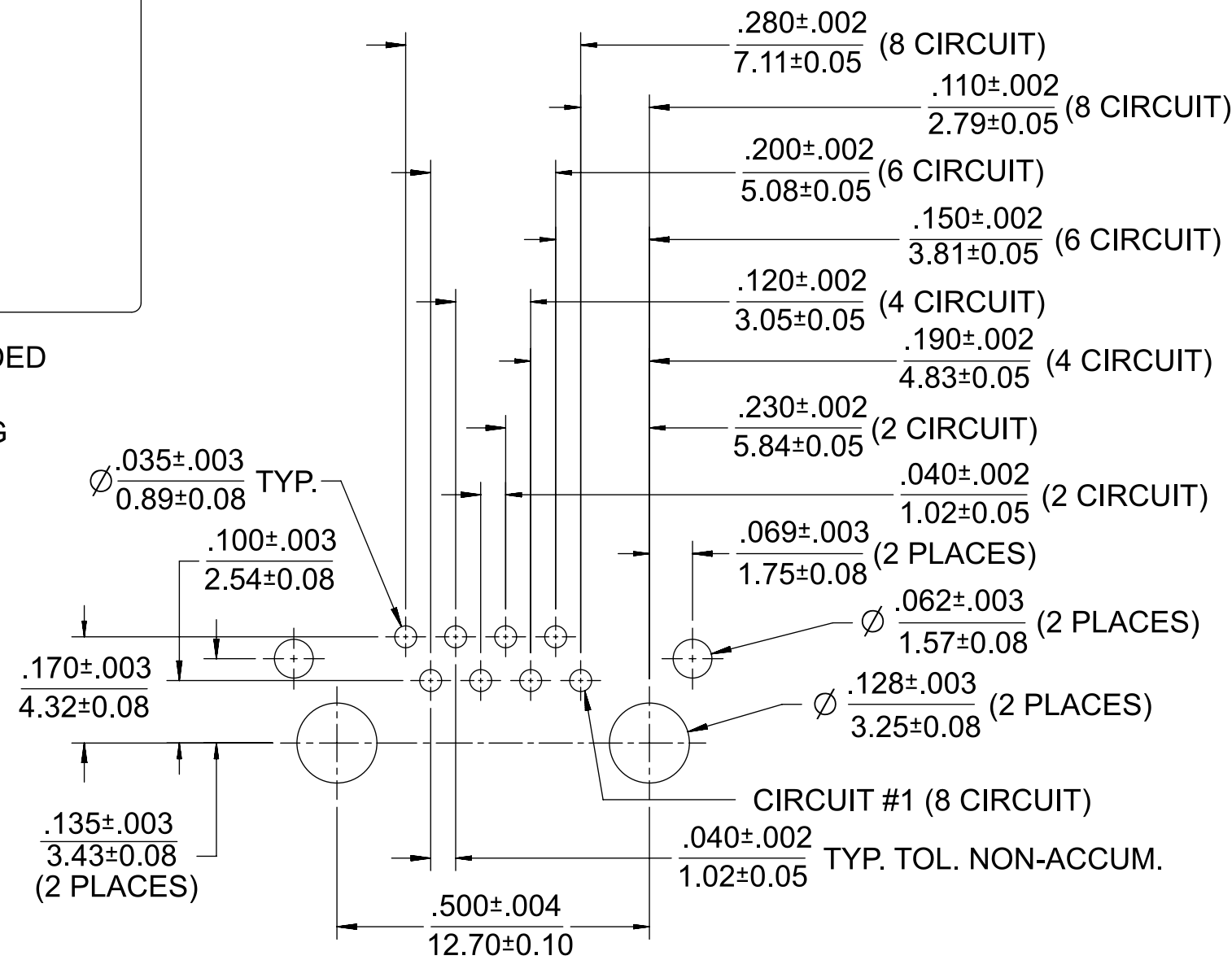

PC BOARD LAYOUT  
COMPONENT SIDE OF BOARD  
RECOMMENDED PCB THICKNESS .062±.005/1.57±0.13

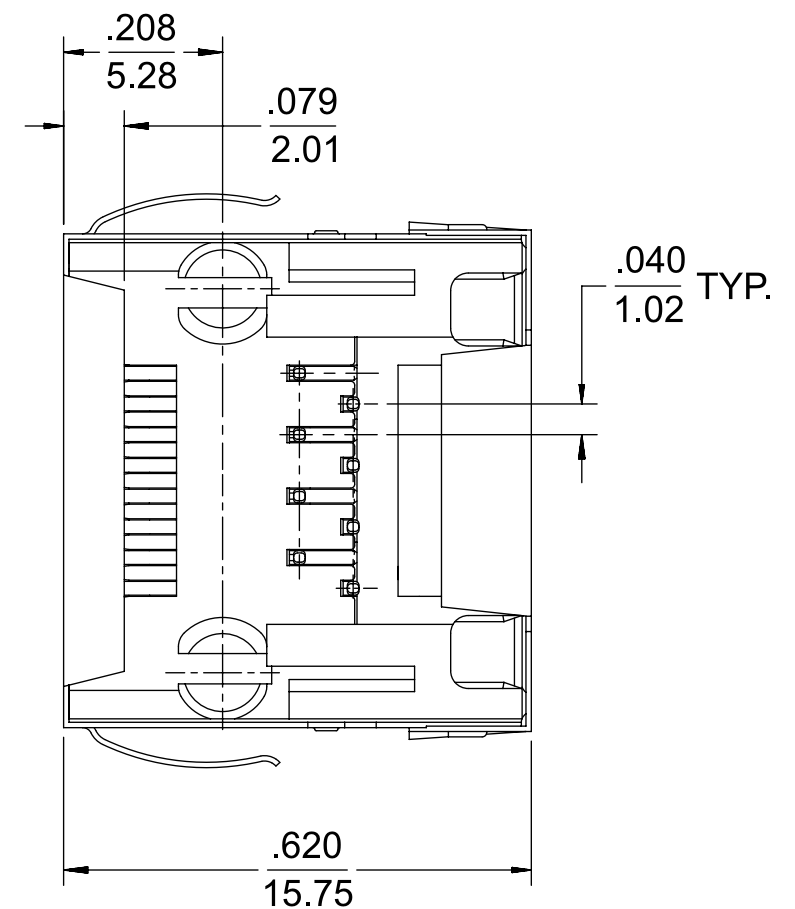

| ASSEMBLY MAT. NUM. | CONNECTOR SIZE | DIM "A"    | CIRCUITS | PANEL GROUND TABS | PACKAGING OPTION |
|--------------------|----------------|------------|----------|-------------------|------------------|
| 43860-0004         | 8              | .469/11.91 | 8        | ALL               | TRAY             |
| 43860-0005         | 6              | .389/9.88  | 6        | ALL               | TRAY             |
| 43860-0006         | 6              | .389/9.88  | 4        | ALL               | TRAY             |
| 43860-0013         | 8              | .469/11.91 | 8        | SEE NOTE #7       | TRAY             |
| 43860-0014         | 6              | .389/9.88  | 6        | SEE NOTE #7       | TRAY             |
| 43860-0025         | 8              | .469/11.91 | 8        | NONE              | TRAY             |
| 43860-0026         | 6              | .389/9.88  | 6        | NONE              | TRAY             |
| 43860-0031         | 8              | .469/11.91 | 8        | SEE NOTE #8       | TRAY             |
| 43860-5025         | 8              | .469/11.91 | 8        | NONE              | TAPE             |

|  |   |                              |  |                            |
|--|---|------------------------------|--|----------------------------|
| FUNCTIONAL SYMBOLS<br>FA = 0<br>FC = 0<br>FP = 0     | THIS DRAWING CONTAINS INFORMATION THAT IS PROPRIETARY TO MOLEX ELECTRONIC TECHNOLOGIES, LLC AND SHOULD NOT BE USED WITHOUT WRITTEN PERMISSION |                              | CURRENT REV DESC: REMOVED OBSOLETE PART NUMBERS AS PER PCN#512600  |                            |
|  | DIMENSION UNITS<br><b>IN/mm</b>   | SCALE<br><b>4:1</b>          | PHASE:<br>CO NO:<br>DRWN: Madhava M 2023-10-26<br>CHK'D: Ganesh Rao B 2023-12-20<br>APPR: Gurunandan GA 2023-12-20 |                            |
| DIVISIONAL SYMBOLS                                   | GENERAL TOLERANCES (UNLESS SPECIFIED)   |                              | INITIAL REVISION:<br>DRWN: TALEND 1997/02/13<br>APPR: FRY 1997/03/04   |                            |
|  | 4 PLACES ±  | MM INCH ±                    | DOCUMENT NUMBER<br><b>SD-43860-001</b>   |                            |
| DRAFT WHERE APPLICABLE MUST REMAIN WITHIN DIMENSIONS |   | THIRD ANGLE PROJECTION       | DRAWING<br><b>C-SIZE</b>   | SERIES<br><b>43860</b>     |
|  |   | MATERIAL NUMBER<br>SEE TABLE |  | CUSTOMER<br>GENERAL MARKET |
|  |   | DOC TYPE<br>PSD              |  | DOC PART<br>001            |
|  |   | SHEET NUMBER<br>2 OF 5       |  |                            |

**molex**

INVERTED MODULAR JACK  
ASSEMBLY

PRODUCT SALES DRAWING

|  |                            |                        |                      |
|--|----------------------------|------------------------|----------------------|
| DOCUMENT NUMBER<br><b>SD-43860-001</b> | DOC TYPE<br>PSD            | DOC PART<br>001        | REVISION<br><b>J</b> |
| MATERIAL NUMBER<br>SEE TABLE           | CUSTOMER<br>GENERAL MARKET | SHEET NUMBER<br>2 OF 5 |                      |

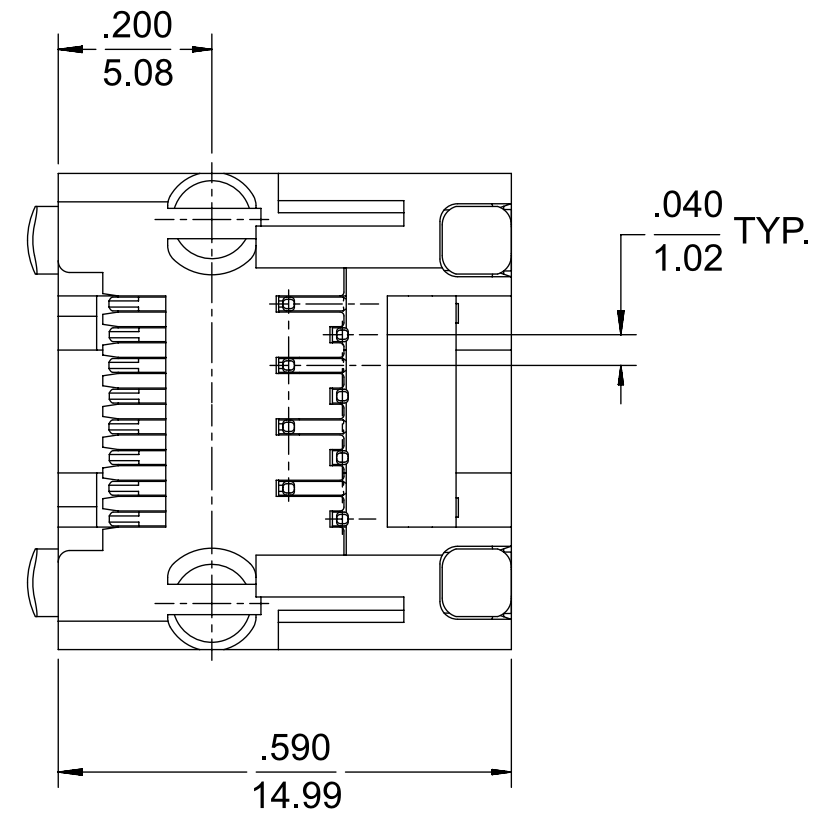
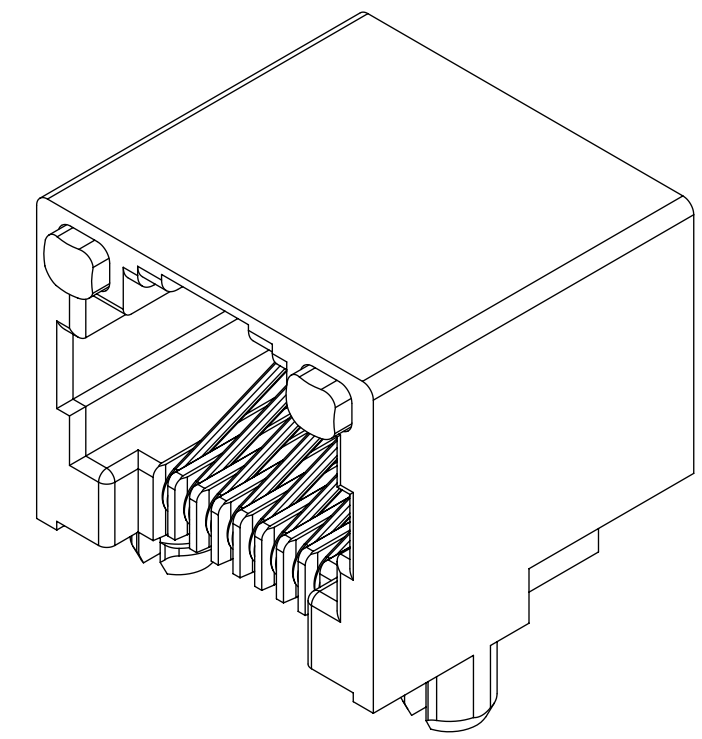
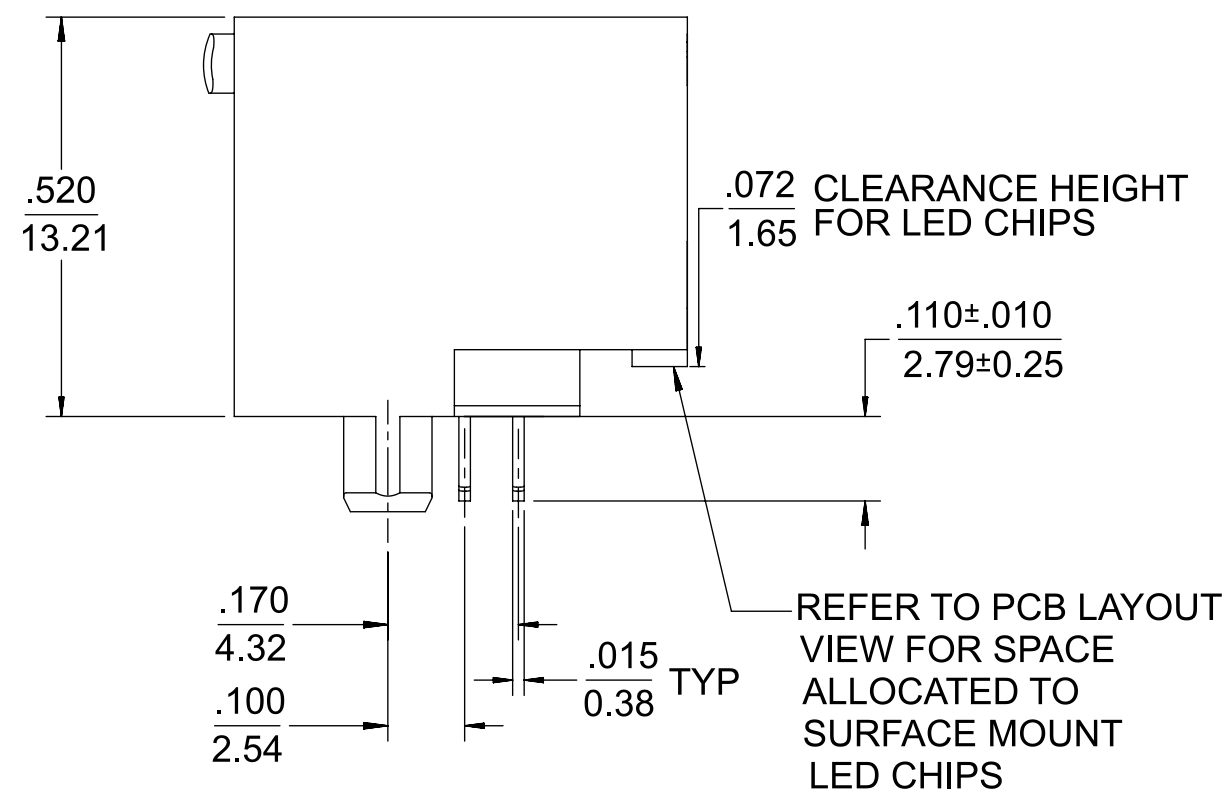
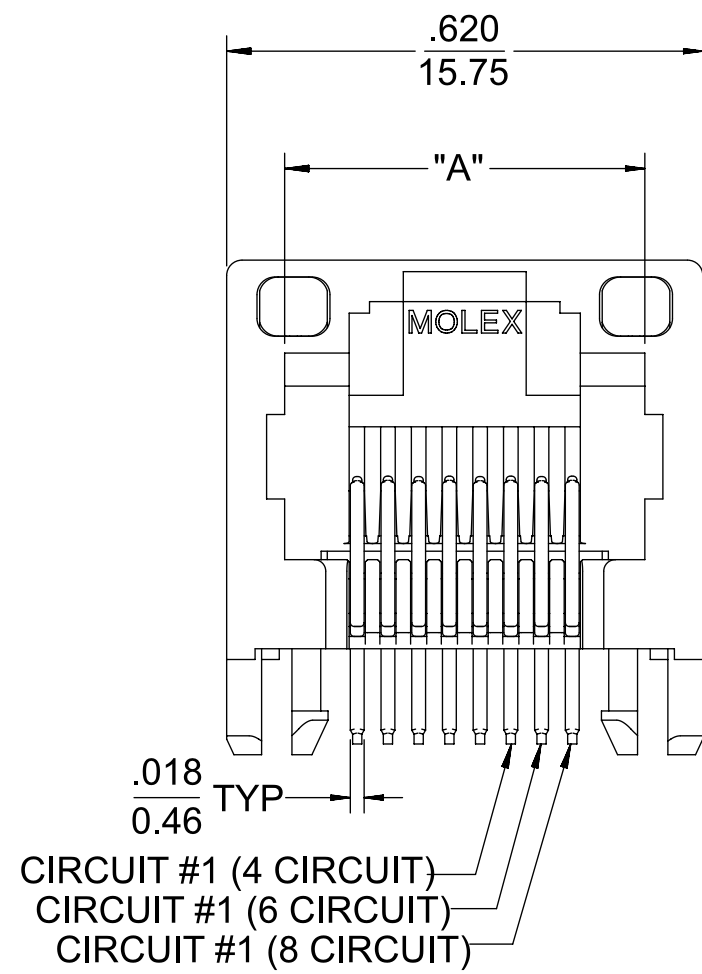

**NOTES:**

- MATERIAL:**  
 HOUSING: NYLON(PA), GLASS FILLED, UL94V-0, COLOR: BLACK  
 TERMINALS: PHOSPHOR BRONZE  
 LIGHT PIPES:  
 POLYCARBONATE - WAVE OR HAND SOLDER ONLY  
 (NOT DESIGNED FOR I/R REFLOW OR CONVECTION REFLOW SOLDER PROCESSES)  
 POLYSULFONE - MAXIMUM REFLOW TEMPERATURE 400°F (205°C)
- FINISH:**  
 TERMINALS:  
 SELECT GOLD IN CONTACT AREA: 50 MICROINCHES (1.27 MICROMETERS) MIN.,  
 SELECT TIN IN PC TAIL AREA: 100 MICROINCHES (2.54 MICROMETERS) MIN.,  
 WITH OVERALL NICKEL UNDERPLATE: 50 MICROINCHES (1.27 MICROMETERS) MIN.
- PRODUCT SPECIFICATION AND PROCESSING PARAMETERS:** PS-43860-003.
- PACKAGING SPECIFICATION:**  
 CONNECTOR ASSEMBLIES PACKAGED IN EXTRUDED TUBES PER MOLEX  
 PACKAGING SPECIFICATION PK-43860-004.
- APPLICATION SPECIFICATION:** AS-43860-001
- ALL UNTOLERANCED DIMENSIONS ARE SHOWN FOR REFERENCE ONLY.
- CONFORMS TO FCC REGULATION PART 68.5 FOR MODULAR JACKS.
- REFER TO SHEET (5) OF (5) FOR RECOMMENDED PCB LAYOUT.
- THIS PART CONFORMS TO CLASS B REQUIREMENTS OF COSMETIC SPECIFICATION PS-45499-002.

| ASSEMBLY MAT. NUM. | LIGHT PIPE MATERIAL | CONNECTOR SIZE | DIM "A"    | CIRCUITS |
|--------------------|---------------------|----------------|------------|----------|
| 43860-0007         | POLYCARBONATE       | 8              | .469/11.91 | 8        |
| 43860-0008         | POLYCARBONATE       | 6              | .389/9.88  | 6        |

|  |   |                        |  |  |  |
|--|---|------------------------|--|--|--|
| FUNCTIONAL SYMBOLS<br>FA = 0<br>FC = 0<br>FP = 0 | THIS DRAWING CONTAINS INFORMATION THAT IS PROPRIETARY TO MOLEX ELECTRONIC TECHNOLOGIES, LLC AND SHOULD NOT BE USED WITHOUT WRITTEN PERMISSION |                        | CURRENT REV DESC: REMOVED OBSOLETE PART NUMBERS AS PER PCN#512600  |  | <b>molex</b>                           |
|  | DIMENSION UNITS<br><b>IN/mm</b>   | SCALE<br><b>4:1</b>    | PHASE:<br>CO NO:<br>DRWN: Madhava M 2023-10-26<br>CHK'D: Ganesh Rao B 2023-12-20<br>APPR: Gurunandan GA 2023-12-20 |  |  |
| DIVISIONAL SYMBOLS                               | GENERAL TOLERANCES (UNLESS SPECIFIED)   |                        | INITIAL REVISION:<br>DRWN: TALEND 1997/02/13<br>APPR: FRY 1997/03/04   |  | PRODUCT SALES DRAWING                  |
|  | 4 PLACES ±  | MM                     | INCH   | 0 PLACES ±   | DOCUMENT NUMBER<br><b>SD-43860-001</b> |
|  | 3 PLACES ±  | ± 0.0100               |  | ANGULAR TOL ± 0.5°                                   | DOC TYPE<br>PSD                        |
|  | 2 PLACES ±  | ± 0.250                |  | DRAFT WHERE APPLICABLE MUST REMAIN WITHIN DIMENSIONS | DOC PART<br>001                        |
|  | 1 PLACE ±   | ±                      |  | THIRD ANGLE PROJECTION                               | REVISION<br><b>J</b>                   |
|  | 0 PLACES ±  | ±                      |  | DRAWING<br><b>C-SIZE</b>                             | SHEET NUMBER<br>3 OF 5                 |
|  |   | SERIES<br><b>43860</b> | MATERIAL NUMBER<br>SEE TABLE   | CUSTOMER<br>GENERAL MARKET                           |  |

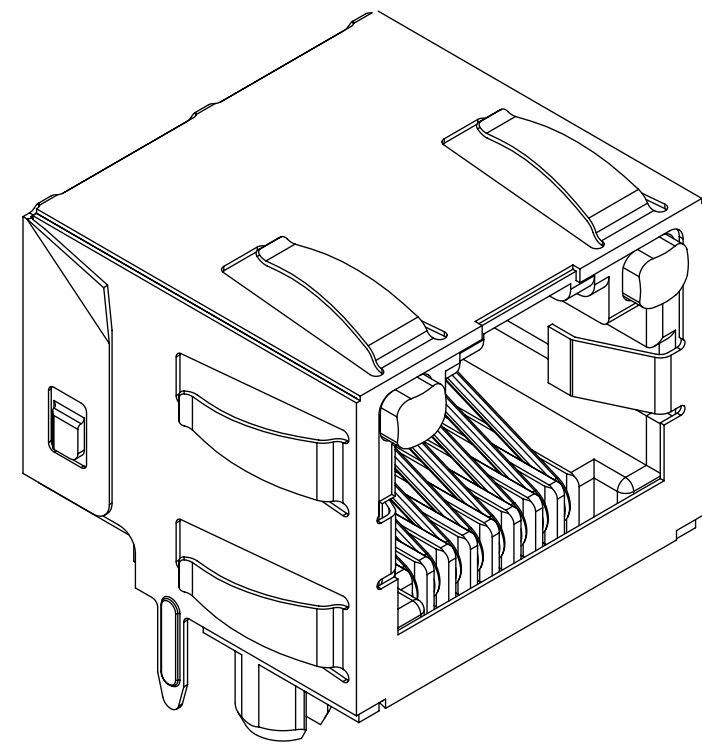

OPTIONAL PANEL GROUND TAB (SEE NOTE 8)

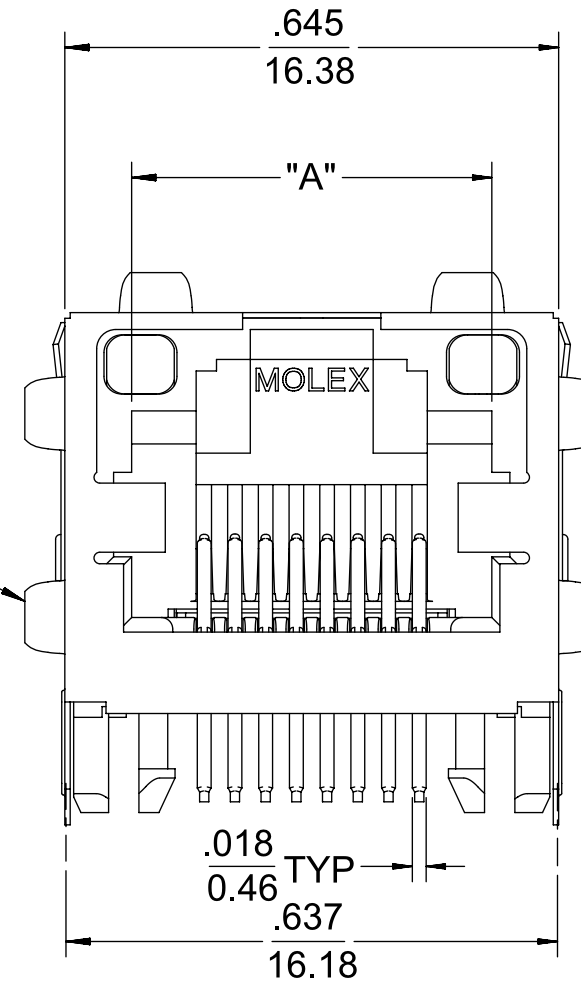

OPTIONAL PANEL GROUND TAB (SEE NOTE 8)

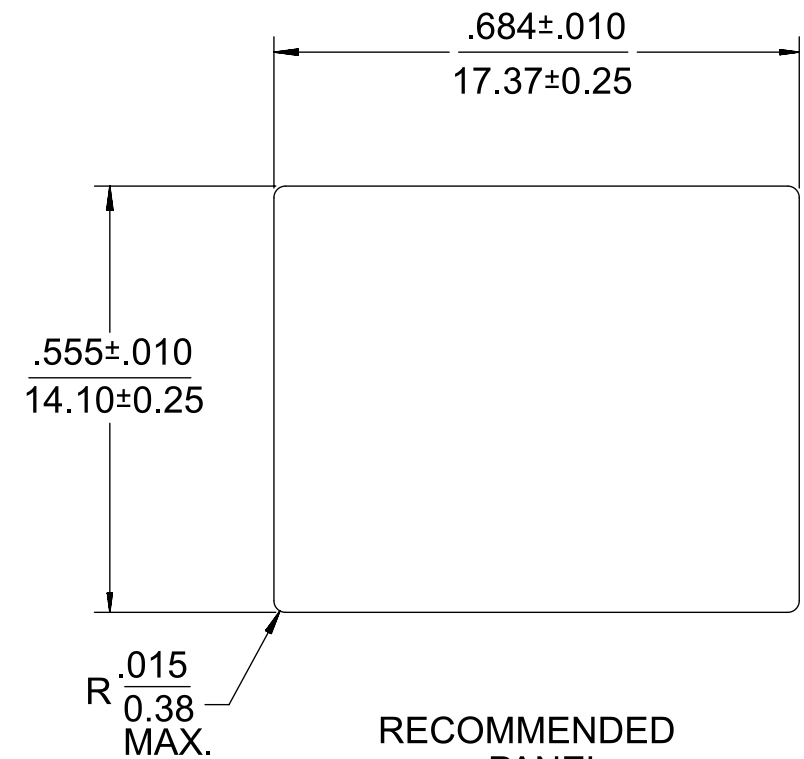
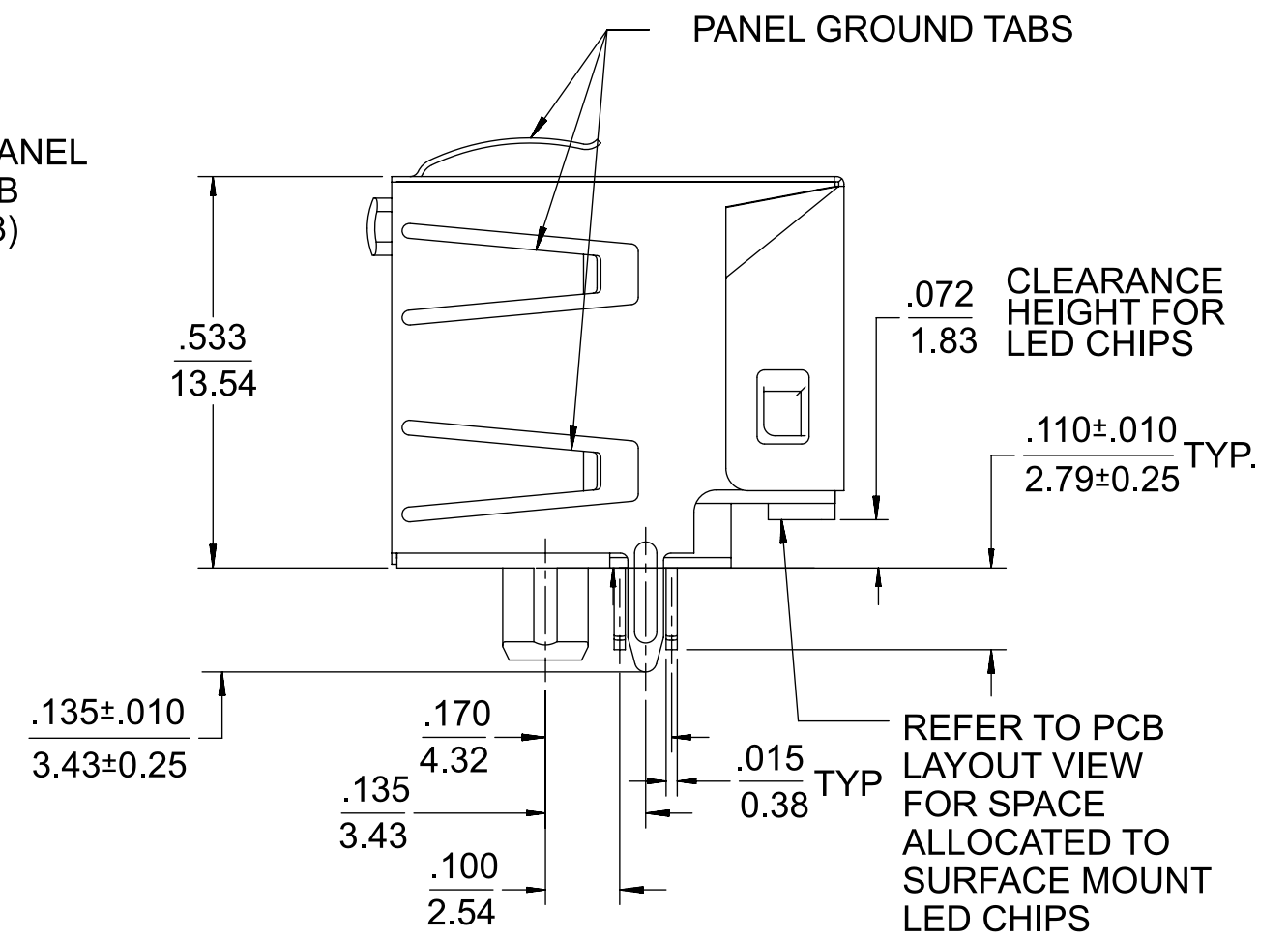

RECOMMENDED PANEL OPENING

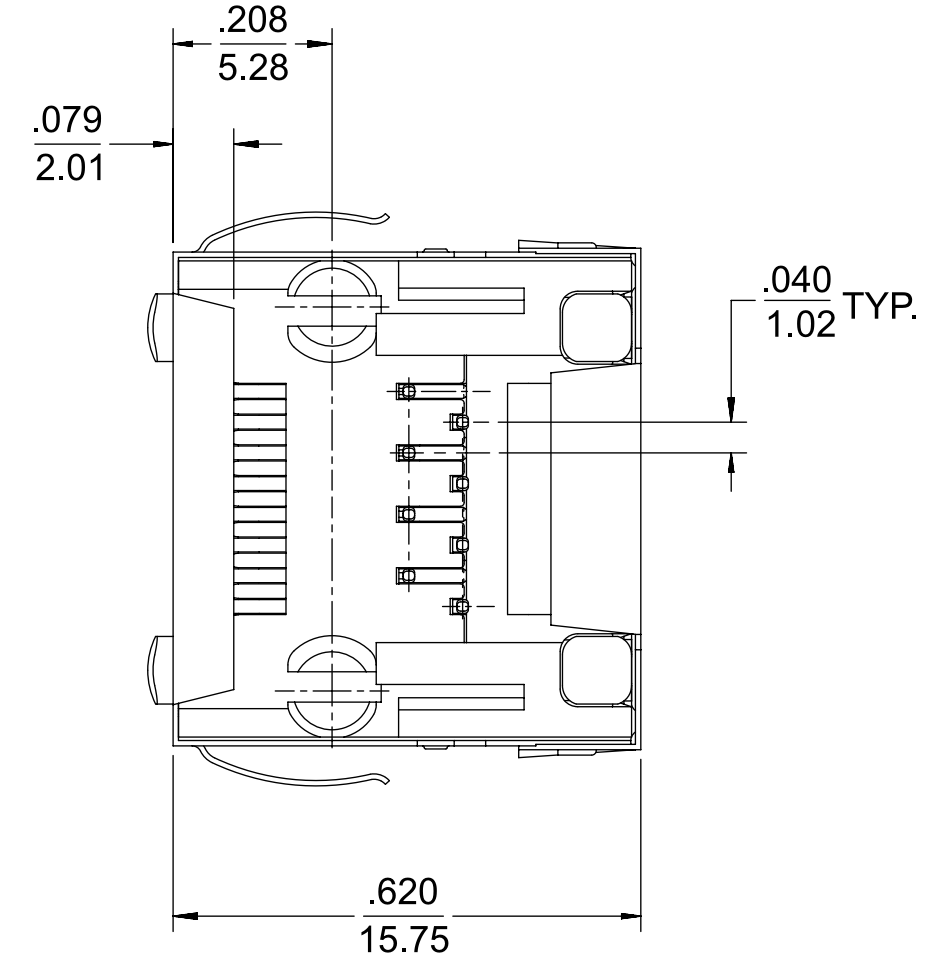

- NOTES:
- MATERIAL:  
HOUSING: NYLON(PA), GLASS FILLED, UL94V-0, COLOR: BLACK  
TERMINALS: PHOSPHOR BRONZE  
SHIELD: BRASS  
LIGHT PIPES:  
POLYCARBONATE - WAVE OR HAND SOLDER ONLY  
(NOT DESIGNED FOR I/R REFLOW OR CONVECTION REFLOW SOLDER PROCESSES)  
POLYSULFONE - MAXIMUM REFLOW TEMPERATURE 400°F (205°C)
  - FINISH:  
TERMINALS:  
SELECT GOLD IN CONTACT AREA: 50 MICROINCHES/1.27 MICROMETERS MIN.,  
SELECT TIN IN PC TAIL AREA: 100 MICROINCHES/2.54 MICROMETERS MIN.,  
WITH OVERALL NICKEL UNDERPLATE: 50 MICROINCHES/1.27 MICROMETERS MIN.  
SHIELD:  
100 MICROINCHES/2.54 MICROMETERS OVER 50 MICROINCHES/1.27 MICROMETERS COPPER UNDERPLATE; PCB GROUND TABS DIPPED IN TIN
  - PRODUCT SPECIFICATION AND PROCESSING PARAMETERS: PS-43860-003.
  - PACKAGING SPECIFICATION:  
CONNECTOR ASSEMBLIES PACKAGED IN THERMOFORMED TRAYS PER MOLEX PACKAGING SPECIFICATION PK-43860-005.
  - APPLICATION SPECIFICATION: AS-43860-001
  - ALL UNTOLERANCED DIMENSIONS ARE SHOWN FOR REFERENCE ONLY.
  - CONFORMS TO FCC REGULATION PART 68.5 FOR MODULAR JACKS.
  - AVAILABLE WITH THE (2) SPECIFIED PANEL GROUND TABS OMITTED FOR SIDE TO SIDE STACKABILITY, PER THE ASSEMBLY MATERIAL NUMBER TABLE.
  - REFER TO SHEET (5) OF (5) FOR RECOMMENDED PCB LAYOUT.
  - THIS PART CONFORMS TO CLASS B REQUIREMENTS OF COSMETIC SPECIFICATION PS-45499-002.

| ASSEMBLY MAT. NUM. | LIGHT PIPE MATERIAL | CONNECTOR SIZE | DIM "A"    | CIRCUITS | PANEL GROUND TABS |
|--------------------|---------------------|----------------|------------|----------|-------------------|
| 43860-0010         | POLYCARBONATE       | 8              | .469/11.91 | 8        | ALL               |
| 43860-0011         | POLYCARBONATE       | 6              | .389/9.88  | 6        | ALL               |
| 43860-0012         | POLYCARBONATE       | 6              | .389/9.88  | 4        | ALL               |
| 43860-0016         | POLYCARBONATE       | 8              | .469/11.91 | 8        | SEE NOTE #8       |
| 43860-0017         | POLYCARBONATE       | 6              | .389/9.88  | 6        | SEE NOTE #8       |

|                    |   |       |   |                 |
|--------------------|---|-------|---|-----------------|
| FUNCTIONAL SYMBOLS | THIS DRAWING CONTAINS INFORMATION THAT IS PROPRIETARY TO MOLEX ELECTRONIC TECHNOLOGIES, LLC AND SHOULD NOT BE USED WITHOUT WRITTEN PERMISSION |       | CURRENT REV DESC: REMOVED OBSOLETE PART NUMBERS AS PER PCN#512600 |                 |
|                    | DIMENSION UNITS   | SCALE | PHASE:  |                 |
| $\frac{F}{A} = 0$  | IN/mm   | 4:1   | CO NO:  |                 |
| $\frac{F}{C} = 0$  | GENERAL TOLERANCES (UNLESS SPECIFIED)   |       | DRWN: Madhava M 2023-10-26  |                 |
| $\frac{F}{P} = 0$  |   |       | CHK'D: Ganesh Rao B 2023-12-20                                    |                 |
|                    |   |       | APPR: Gurunandan GA 2023-12-20                                    |                 |
| DIVISIONAL SYMBOLS |   |       | INITIAL REVISION:   |                 |
| 4 PLACES ±         | MM  | INCH  | DRWN: TALEND 1997/02/13   |                 |
| 3 PLACES ±         | ± 0.0100  |       | APPR: FRY 1997/03/04  |                 |
| 2 PLACES ±         | ± 0.250   |       | DRAFT WHERE APPLICABLE MUST REMAIN WITHIN DIMENSIONS              |                 |
| 1 PLACE ±          | ±   |       | THIRD ANGLE PROJECTION  |                 |
| 0 PLACES ±         | ±   |       | DRAWING SERIES  |                 |
| ANGULAR TOL ± 0.5° | ± 0.5°  |       | C-SIZE 43860  |                 |
|                    |   |       |   | DOCUMENT NUMBER |
|                    |   |       |   | SD-43860-001    |
|                    |   |       |   | DOC TYPE        |
|                    |   |       |   | PSD             |
|                    |   |       |   | DOC PART        |
|                    |   |       |   | 001             |
|                    |   |       |   | J               |
|                    |   |       |   | SHEET NUMBER    |
|                    |   |       |   | 4 OF 5          |

**molex**

INVERTED MODULAR JACK ASSEMBLY

PRODUCT SALES DRAWING

|                 |                |              |          |
|-----------------|----------------|--------------|----------|
| DOCUMENT NUMBER | DOC TYPE       | DOC PART     | REVISION |
| SD-43860-001    | PSD            | 001          | J        |
| MATERIAL NUMBER | CUSTOMER       | SHEET NUMBER |          |
| SEE TABLE       | GENERAL MARKET | 4 OF 5       |          |



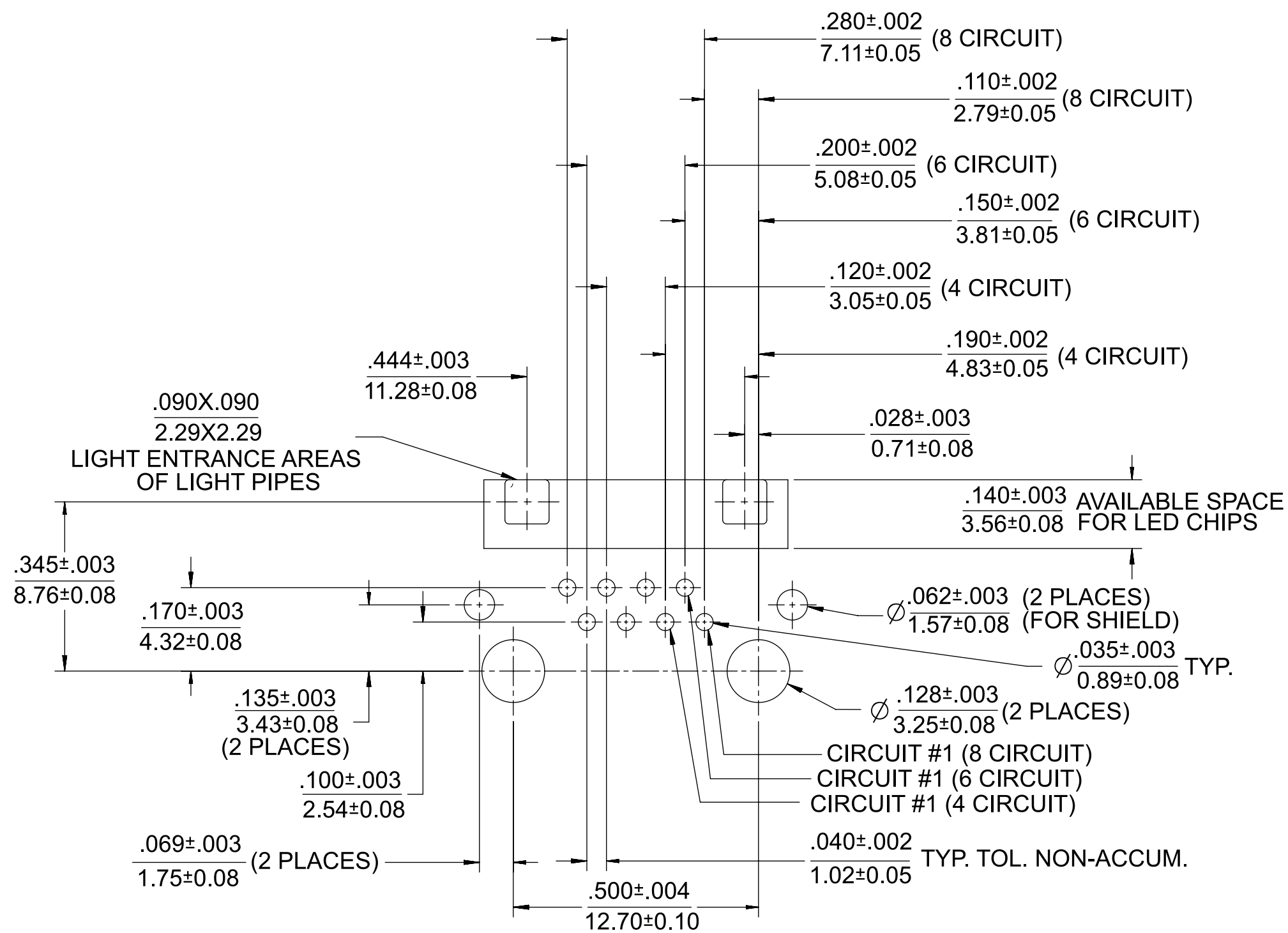

MOLEX RECOMMENDED  
PC BOARD LAYOUT  
COMPONENT SIDE OF BOARD  
RECOMMENDED PCB THICKNESS .062±.005/1.57±0.13

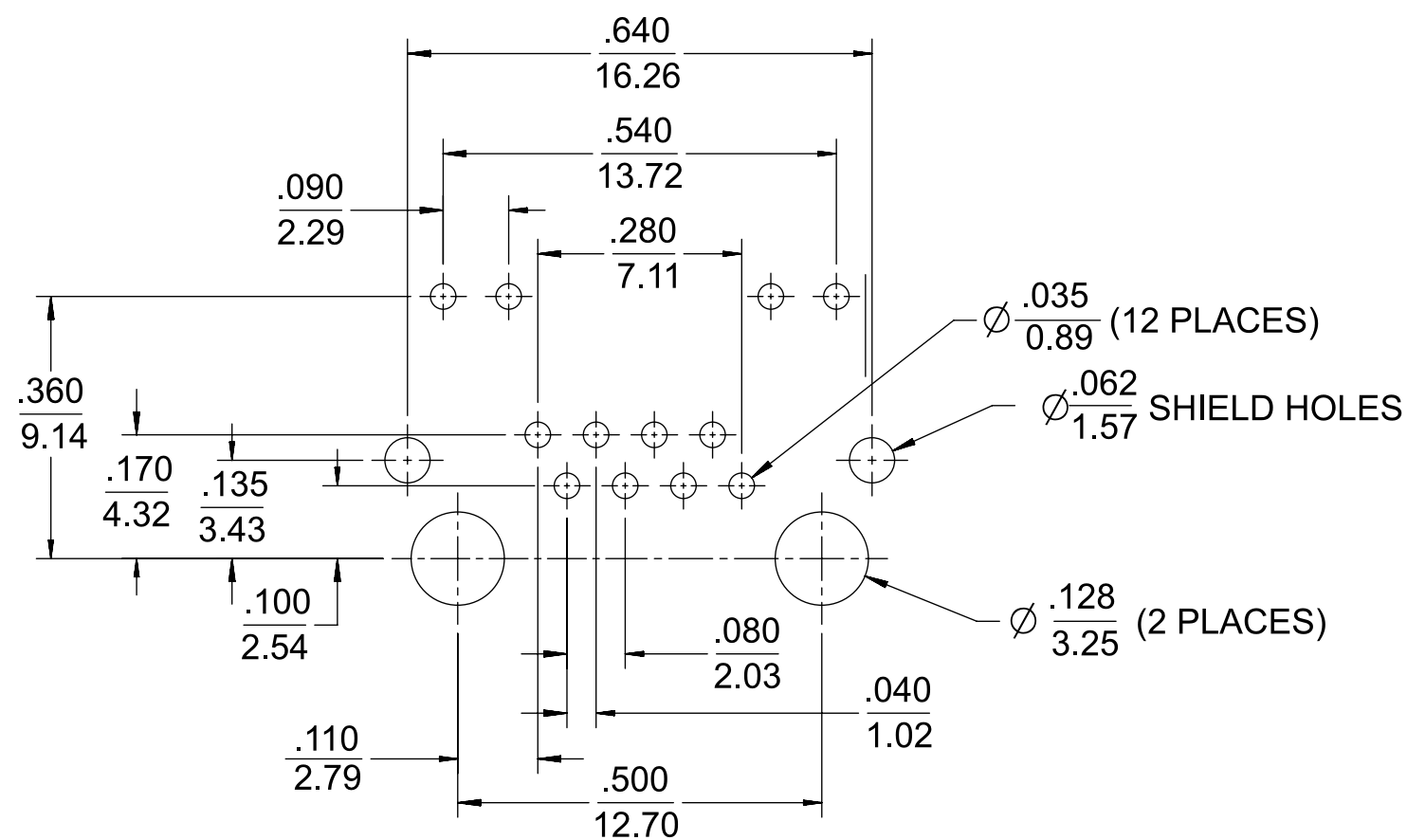

TYPICAL COMPETITION  
PCB LAYOUT WITH  
INTEGRAL LED'S  
(SHOWN FOR REFERENCE ONLY)

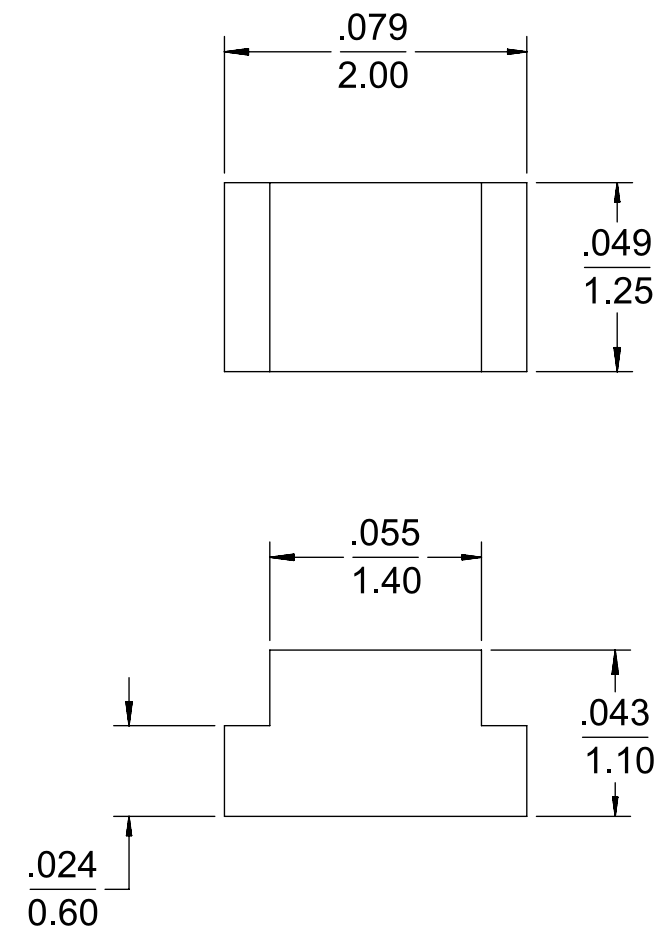

RECOMMENDED SMT  
0805 LED DIMENSIONS  
SCALE 20:1  
(SEE NOTE 1)

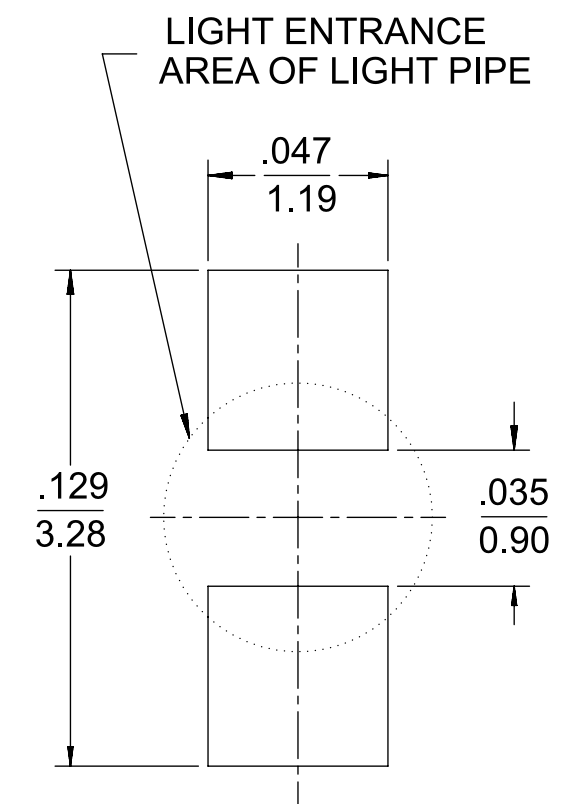

RECOMMENDED SMT  
0805 LED SOLDER PATTERN  
SCALE 20:1  
(SEE NOTE 1)

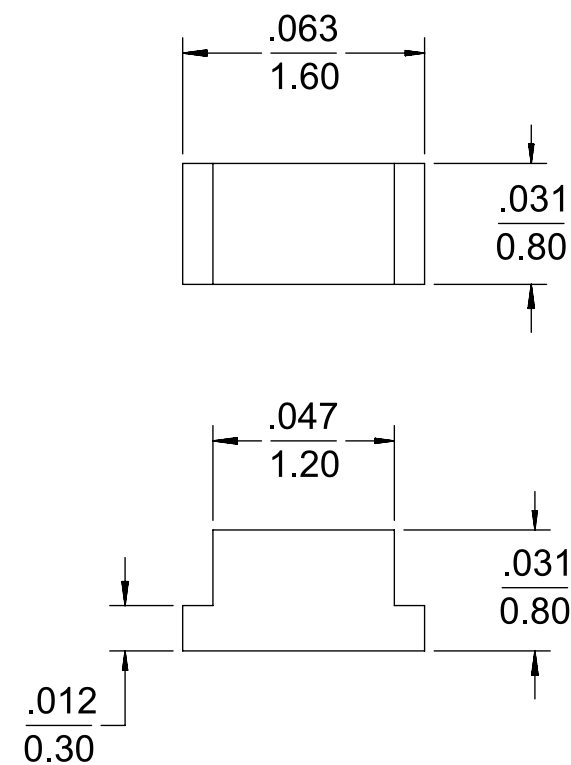

RECOMMENDED SMT  
0603 LED DIMENSIONS  
SCALE 20:1  
(SEE NOTE 1)

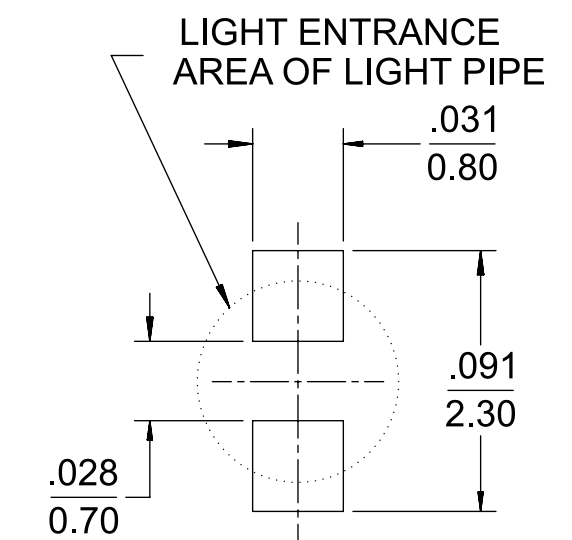

RECOMMENDED SMT  
0603 LED SOLDER PATTERN  
SCALE 20:1  
(SEE NOTE 1)

NOTES:  
1. FOR CROSS REFERENCE OF RECOMMENDED LED'S SEE MOLEX WEB SITE

|                     |   |         |          |  |  |  |                                |  |  |
|---------------------|---|---------|----------|--|--|--|--------------------------------|--|--|
| FUNCTIONAL SYMBOLS  | THIS DRAWING CONTAINS INFORMATION THAT IS PROPRIETARY TO MOLEX ELECTRONIC TECHNOLOGIES, LLC AND SHOULD NOT BE USED WITHOUT WRITTEN PERMISSION |         |          | CURRENT REV DESC: REMOVED OBSOLETE PART NUMBERS AS PER PCN#512600  |  |  |                                |  |  |
|                     | DIMENSION UNITS   | SCALE   |          |  |  |  |                                |  |  |
| $\frac{F_A}{A} = 0$ | IN/mm   | 4:1     |          | PHASE:<br>CO NO:<br>DRWN: Madhava M 2023-10-26<br>CHK'D: Ganesh Rao B 2023-12-20<br>APPR: Gurunandan GA 2023-12-20 |  |  | INVERTED MODULAR JACK ASSEMBLY |  |  |
| $\frac{F_C}{C} = 0$ | GENERAL TOLERANCES (UNLESS SPECIFIED)   |         |          |  |  |  |                                |  |  |
| $\frac{F_P}{P} = 0$ |   | MM      | INCH     | INITIAL REVISION:<br>DRWN: TALEND 1997/02/13<br>APPR: FRY 1997/03/04   |  |  | PRODUCT SALES DRAWING          |  |  |
| DIVISIONAL SYMBOLS  |   |         |          |  |  |  |                                |  |  |
|                     | 4 PLACES  | ±       | ±        | DOCUMENT NUMBER  |  |  | DOC TYPE   DOC PART   REVISION |  |  |
|                     | 3 PLACES  | ±       | ± 0.0100 |  |  |  |                                |  |  |
|                     | 2 PLACES  | ± 0.250 | ±        | SD-43860-001   |  |  | PSD 001 J                      |  |  |
|                     | 1 PLACE   | ±       | ±        |  |  |  |                                |  |  |
|                     | 0 PLACES  | ±       | ±        | MATERIAL NUMBER  |  |  | CUSTOMER                       |  |  |
|                     | ANGULAR TOL   | ± 0.5°  |          |  |  |  |                                |  |  |
|                     | DRAFT WHERE APPLICABLE MUST REMAIN WITHIN DIMENSIONS  |         |          | THIRD ANGLE PROJECTION   |  |  | DRAWING                        |  |  |
|                     |   |         |          | C-SIZE   |  |  | SERIES                         |  |  |
|                     |   |         |          | 43860  |  |  | SEE TABLE                      |  |  |
|                     |   |         |          | GENERAL MARKET   |  |  | SHEET NUMBER                   |  |  |
|                     |   |         |          | 5 OF 5   |  |  |                                |  |  |