



产品编号 : 447690601

Product Description : Micro-Fit BMI Receptacle Header, Dual Row, Vertical, with Press-fit Plastic Pegs, 2.54µm Tin (Sn), 6 Circuits

系列号 : 44769

状态 : Active

Product Category : PCB Headers and Receptacles

文件和资源

图纸

图纸 447690601_sd.pdf

包装设计图 PK-44769-001-001.pdf

3D 模型和设计文件

3D模型 447690601_stp.zip

符号足迹数据 SYM-44769-0601-001.zip

规格

产品规格 PS-44300-001-001.pdf

测试摘要 443000002-TS-000.pdf

产物环境合规

合规

GADSL/IMDS	Not Relevant
China RoHS	
EU ELV	Not Relevant
Low-Halogen Status	Low-Halogen per IEC 61249-2-21
REACH SVHC	Not Contained per D(2023)8585-DC (23 Jan 2024)
EU RoHS	Compliant per EU 2015/863

多部分产品合规性声明

- Eu RoHS
- REACH SVHC
- Low-Halogen

- IPC 1752A Class C
- IPC 1752A Class D

- Molex Product Compliance Declaration

- IEC-62474

- chemSHERPA (xml)

欧盟 RoHS 合格证书

产品详情

常规

状态	活动
类别	PCB Headers and Receptacles
系列	44769
说明	Micro-Fit BMI Receptacle Header, Dual Row, Vertical, with Press-fit Plastic Pegs, 2.54µm Tin (Sn), 6 Circuits
应用	Board-to-Board, Power, Wire-to-Board
元件类型	PCB Receptacle
产品系列	Micro-Fit Connector System
产品名称	Micro-Fit BMI
UPC	800756566702

机构

CSA	LR19980
UL	E29179

电气

每触点最大电流	8.5A
电压 - 最大	250V

物理

回路数 (已载入)	6
电路数 (最多)	6
颜色-树脂	黑色
耐用性(插拔次数) - 最多次数	30
阻燃性	94V-0
符合灼热丝规范	否

材料 - 金属	Phosphor Bronze
材料 - 接合部位电镀	Tin
材料 - 终端电镀	Tin
材料 - 树脂	Liquid Crystal Polymer
净重	1.283/g
行数	2
方向	垂直
包装形式	Tray
PC 焊脚长度	3.40mm
PCB 定位器	是
PCB 保持力	是
推荐的 PCB 厚度	1.57mm
间距 - 插配接口	3.00mm
最薄镀层 - 接合部位	2.540µm
最薄镀层 - 端接	2.540µm
有极性的插配件	是
PCB 极性	是
运行温度范围	-40° to +105° C
终端界面类型	Through Hole

进程

最长持续时间	5
无铅	WAVE
最大周期	1
最高温度	260

可配插/可连接使用的产品

可配插部件

描述	产品编号
Micro-Fit BMI Dual Row Plug Housings	<u>44300</u>
Micro-Fit BMI Right-Angle Dual Row Headers	<u>44428</u>
Micro-Fit BMI Vertical Dual Row Headers	<u>44432</u>

This document was generated on Jul 01, 2024

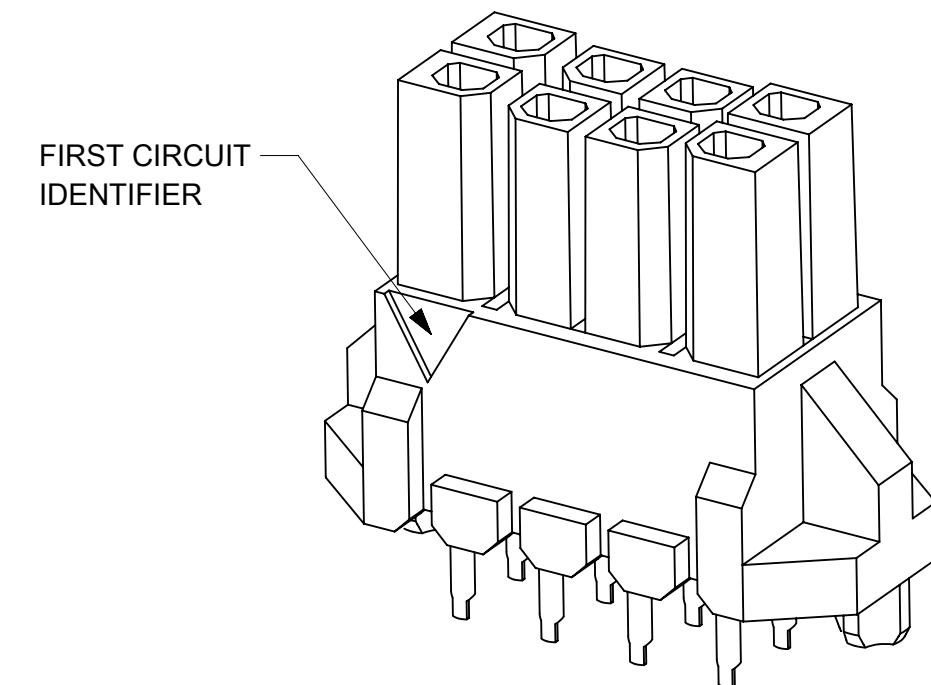
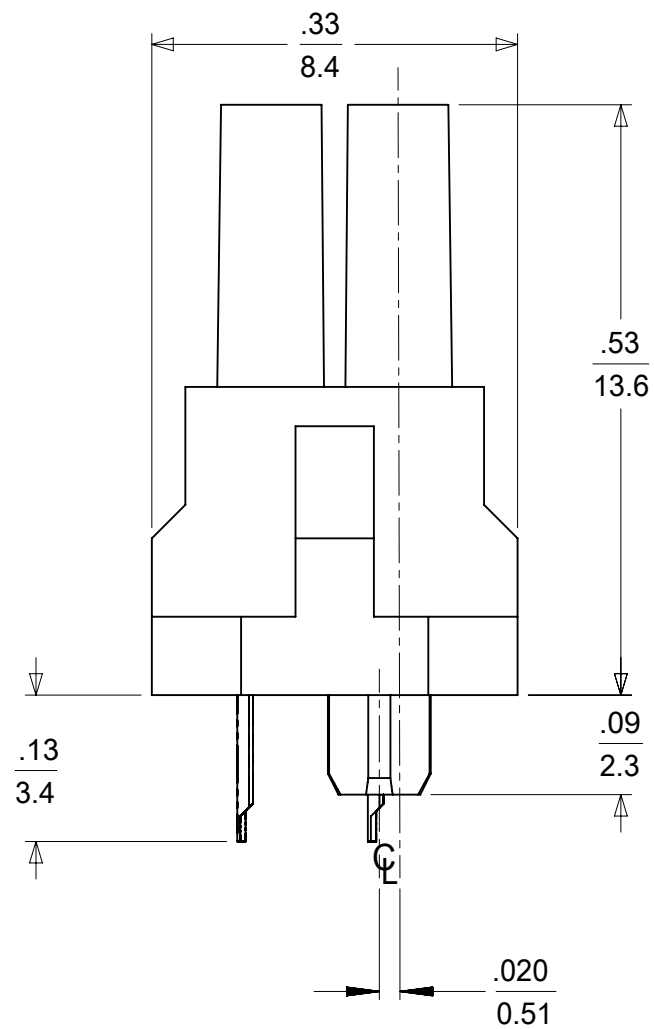
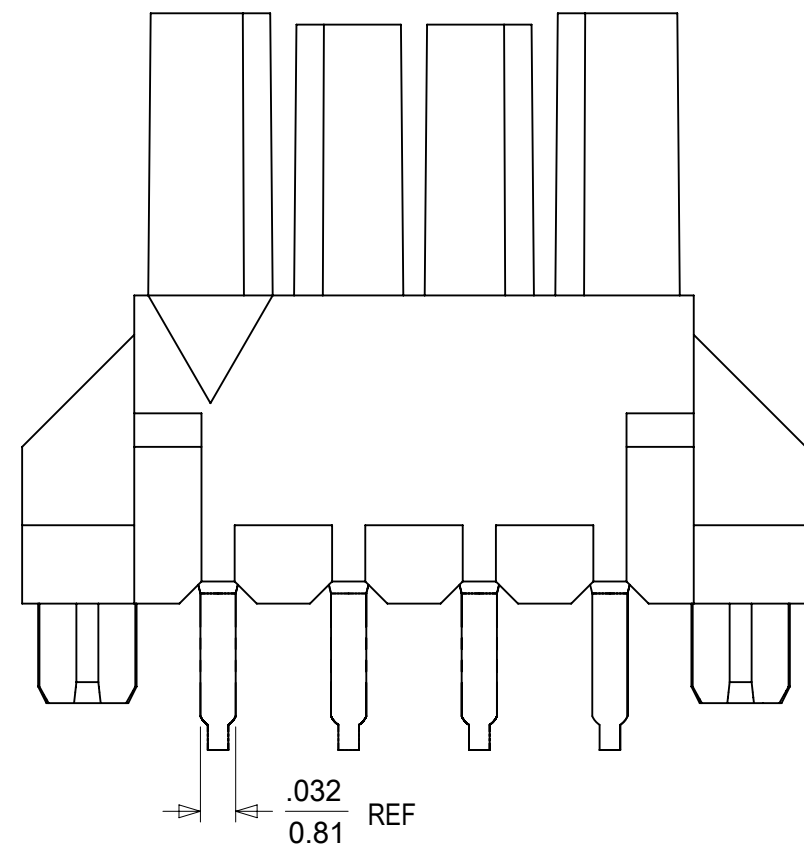
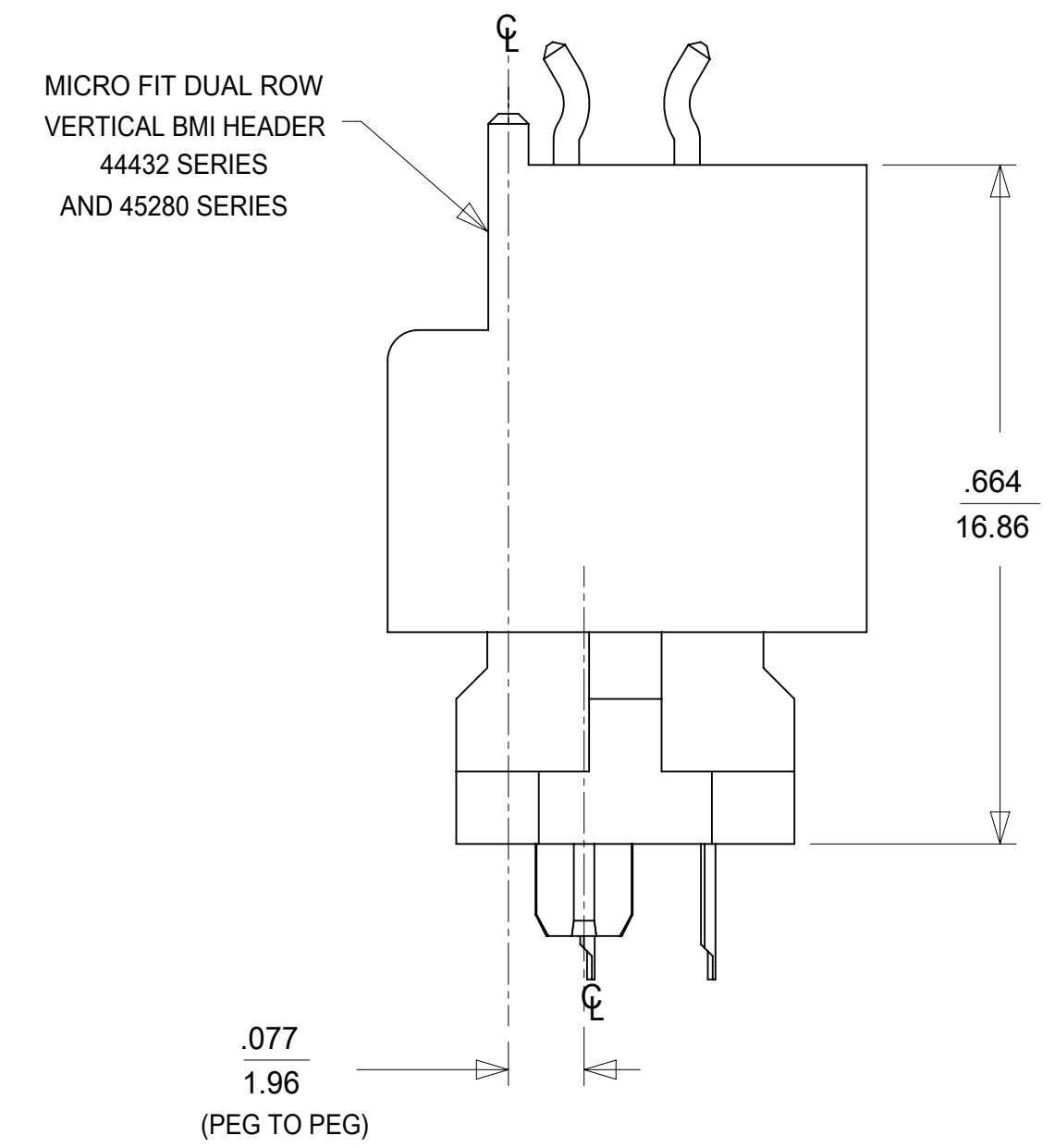
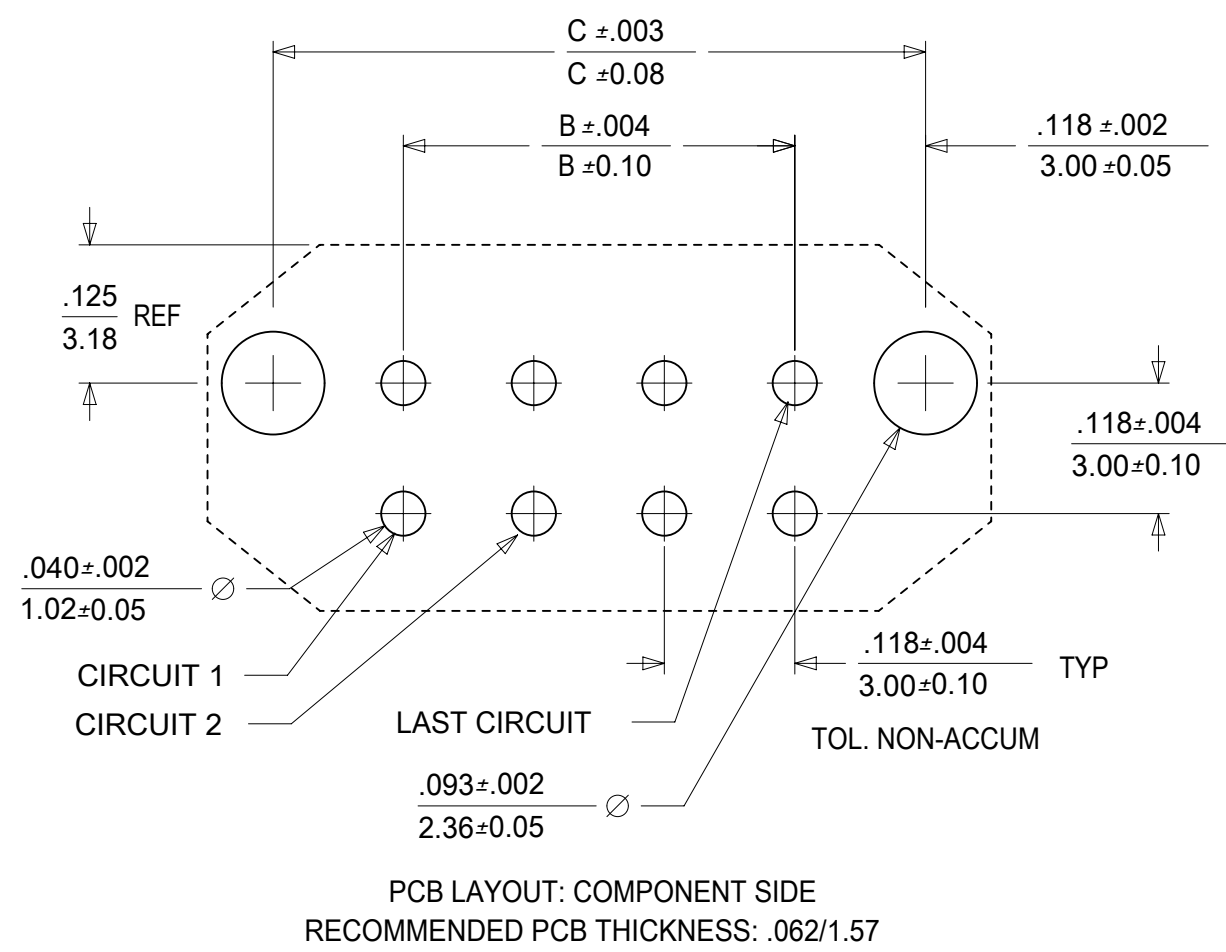
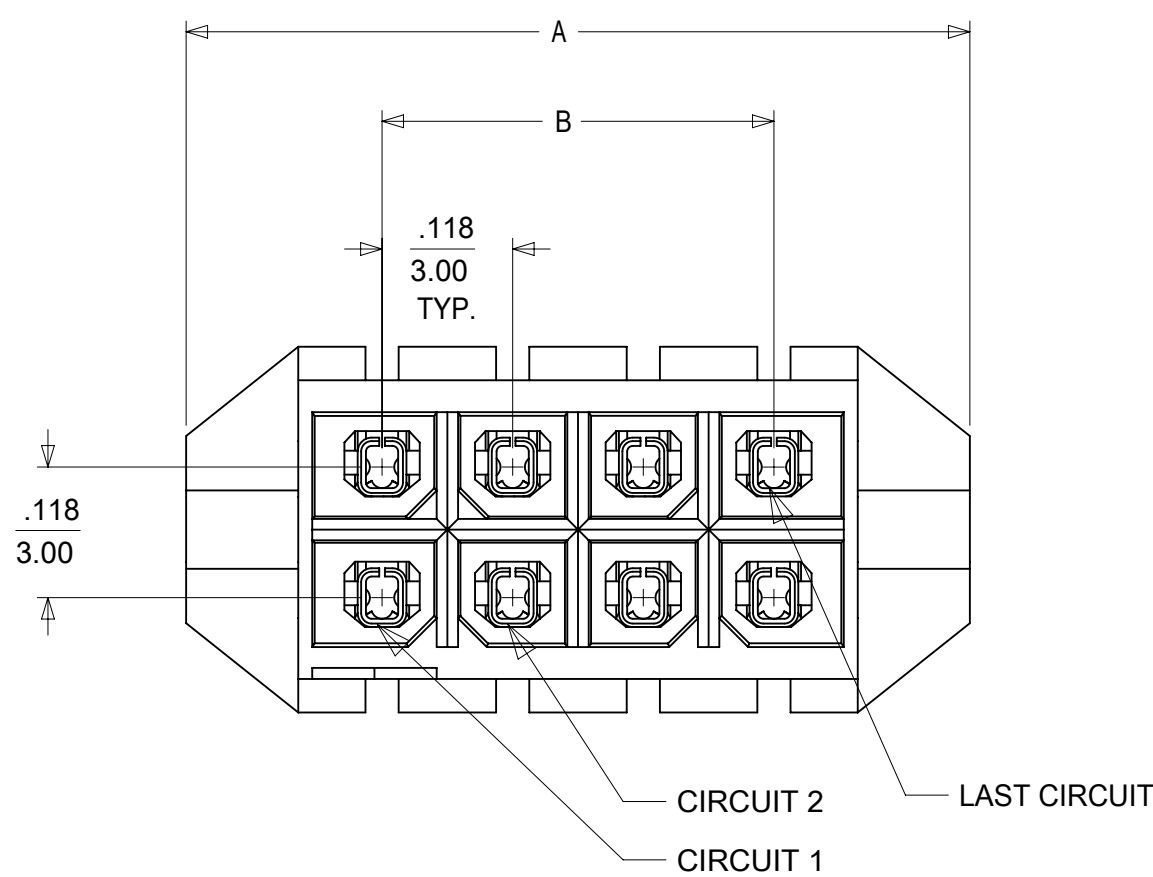

MATED DIMENSIONS
(FOR ALIGNMENT OF PCB'S IN X & Y DIRECTIONS)

CIRCUIT SIZE	DIM. "A"	DIM. "B"	DIM. "C"
4	.472/(12.00)	.118/(3.00)	.354/(9.00)
6	.591/(15.00)	.236/(6.00)	.472/(12.00)
8	.709/(18.00)	.354/(9.00)	.591/(15.00)
10	.827/(21.00)	.472/(12.00)	.709/(18.00)
12	.945/(24.00)	.591/(15.00)	.827/(21.00)
14	1.063/(27.00)	.709/(18.00)	.945/(24.00)
16	1.181/(30.00)	.827/(21.00)	1.063/(27.00)
18	1.299/(33.00)	.945/(24.00)	1.181/(30.00)
20	1.417/(36.00)	1.063/(27.00)	1.299/(33.00)
22	1.535/(39.00)	1.181/(30.00)	1.417/(36.00)
24	1.654/(42.00)	1.299/(33.00)	1.535/(39.00)

- NOTES:
- MATERIAL:
HOUSING: LIQUID CRYSTAL POLYMER, GLASS FILLED, UL 94V-0, COLOR - BLACK
TERMINALS: PHOSPHOR BRONZE ALLOY
 - FINISH:
(A) = .000100/0.00254 MIN. TIN OVER
.000050/0.00127 MIN. NICKEL
(B) = .000015/0.00038 MIN. SELECTIVE GOLD IN CONTACT AREA,
.000100/0.00254 MIN. SELECTIVE TIN IN PC TAIL AREA,
BOTH OVER .000050/0.00127 MIN. NICKEL
(C) = .000030/0.00076 MIN. SELECTIVE GOLD IN CONTACT AREA,
.000100/0.00254 MIN. SELECTIVE TIN IN PC TAIL AREA,
BOTH OVER .000050/0.00127 MIN. NICKEL
 - PRODUCT SPECIFICATIONS: PS-44300-001
 - PACKAGING SPECIFICATION: PK-44769-001.
 - THIS HEADER MATES WITH MOLEX MICRO-FIT BMI HEADER SERIES 45280, 44432, AND 44428, AND MOLEX MICRO-FIT BMI PLUG SERIES 44300.
 - MOLEX RECOMMENDS THE USE OF MICRO-FIT TEST PLUG (SERIES 44242) WHENEVER CONTINUITY TESTING IS PERFORMED. TEST PLUGS MUST NOT BE USED TO MAKE OR BREAK UNDER LOAD. MOLEX DOES NOT RECOMMEND USING STANDARD MATING COMPONENTS (SERIES 45280, 44432, 44428, OR 44300) FOR TESTING PURPOSES.
 - THIS PART CONFORMS TO CLASS 'B' REQUIREMENTS OF COSMETIC SPECIFICATION PS-45499-002.

SYMBOLS		THIS DRAWING CONTAINS INFORMATION THAT IS PROPRIETARY TO MOLEX ELECTRONIC TECHNOLOGIES, LLC AND SHOULD NOT BE USED WITHOUT WRITTEN PERMISSION	
▽ = 0	IN/MM	SCALE	CURRENT REV DESC: ADD POLARIZATION
▽ = 0	NTS		
▽ = 0	GENERAL TOLERANCES (UNLESS SPECIFIED)		
▽ = 0		MM	INCH
▽ = 0	4 PLACES	±	±
▽ = 0	3 PLACES	±	± 0.01
▽ = 0	2 PLACES	± 0.25	± 0.014
▽ = 0	1 PLACE	± 0.35	±
▽ = 0	0 PLACES	±	±
▽ = 0	ANGULAR TOL	± 0.5°	
▽ = 0	DRAFT WHERE APPLICABLE MUST REMAIN WITHIN DIMENSIONS		THIRD ANGLE PROJECTION
		DRAWING	SERIES
		C-SIZE	44769
		EC NO: 611105	DRWN: JBAUMERT 2019/01/25
		CHK'D: SSOUSEK	2019/02/05
		APPR: FSMITH	2019/02/07
		INITIAL REVISION:	
		DRWN: BURLESON	2000/07/13
		APPR: EDGLE Y	2000/07/13
		MATERIAL NUMBER	CUSTOMER
		SEE CHART	GENERAL MARKET
		DOCUMENT NUMBER	DOC TYPE DOC PART REVISION
		SD-44769-001	PSD 001 F1
		SHEET NUMBER	1 OF 2

POLARIZATION LAYOUT

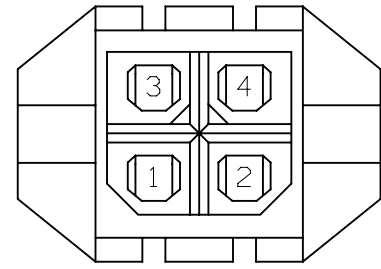

4 CIRCUIT

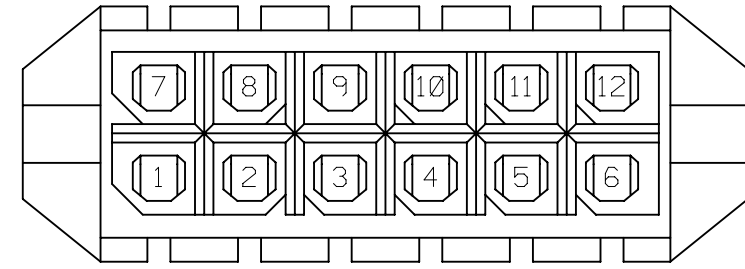

12 CIRCUIT

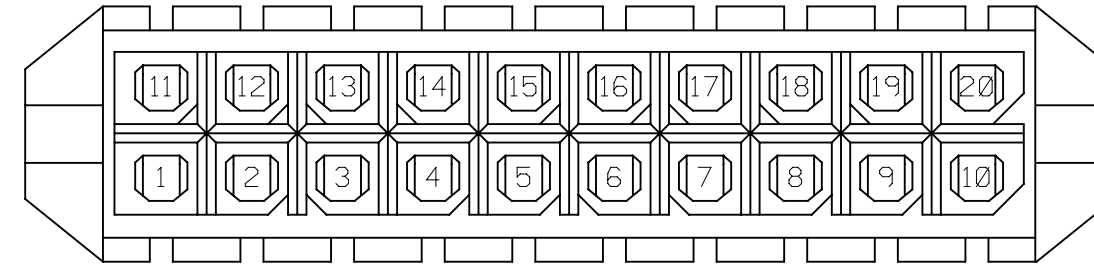

20 CIRCUIT

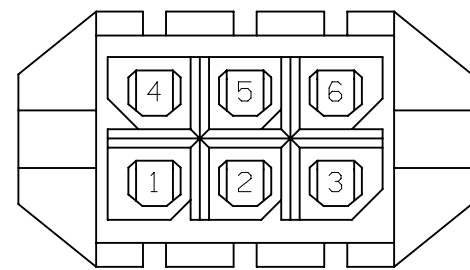

6 CIRCUIT

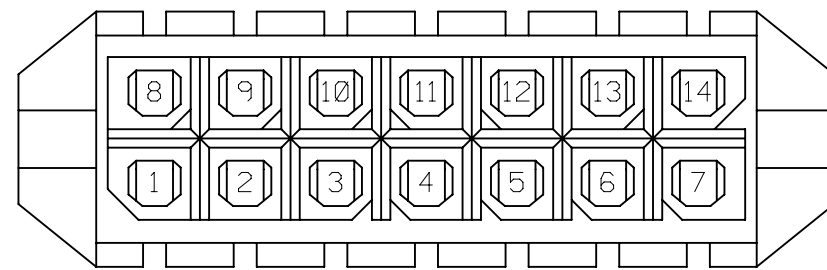

14 CIRCUIT

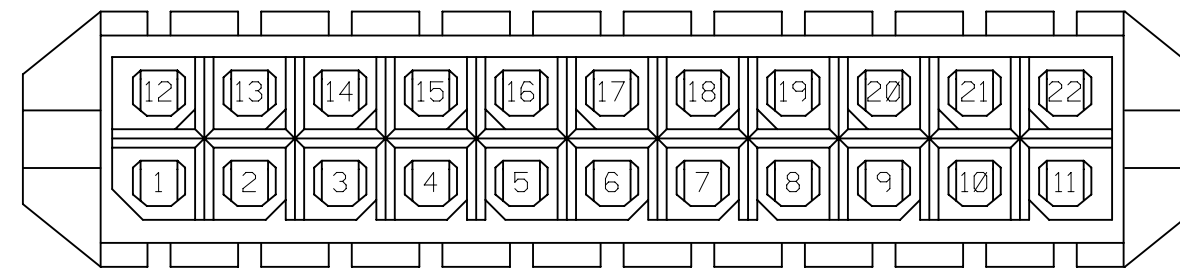

22 CIRCUIT

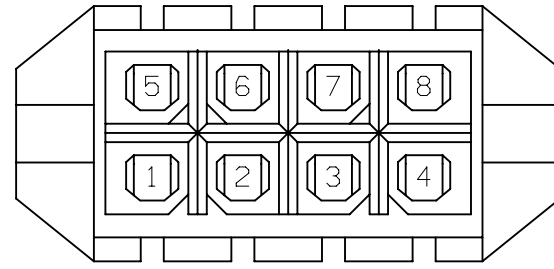

8 CIRCUIT

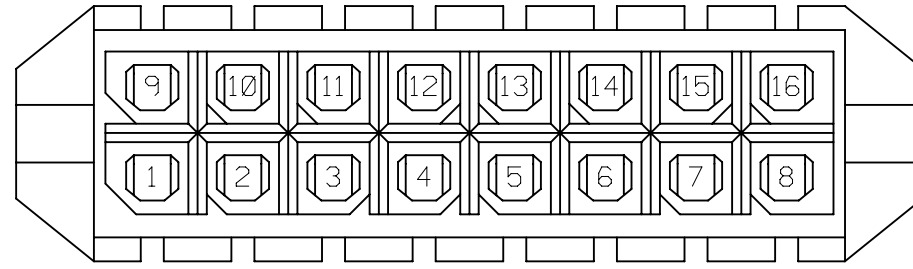

16 CIRCUIT

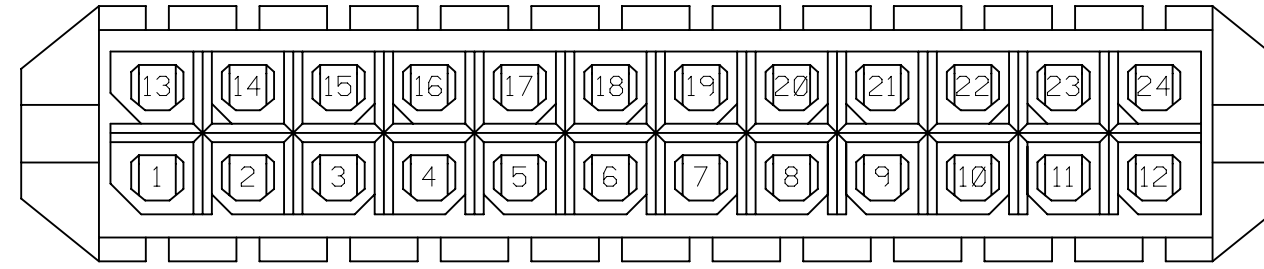

24 CIRCUIT

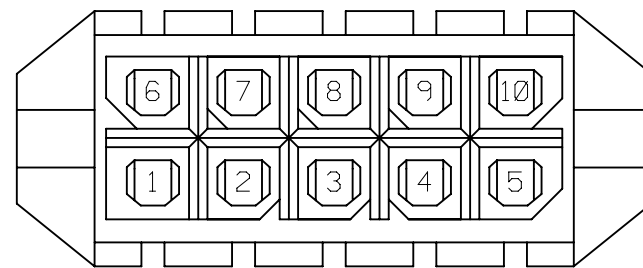

10 CIRCUIT

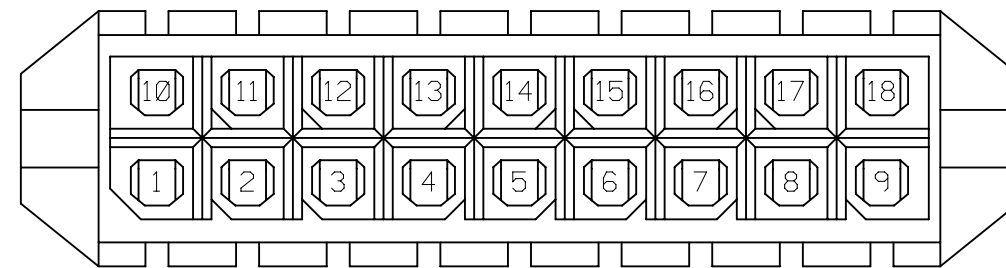

18 CIRCUIT

MATERIAL NUMBER	NUMBER OF POSITIONS	PLATING OPTION
44769-0401	04	A
44769-0402	04	B
44769-0403	04	C
44769-0601	06	A
44769-0602	06	B
44769-0603	06	C
44769-0801	08	A
44769-0802	08	B
44769-0803	08	C
44769-1001	10	A
44769-1002	10	B
44769-1003	10	C
44769-1201	12	A
44769-1202	12	B
44769-1203	12	C
44769-1401	14	A
44769-1402	14	B
44769-1403	14	C
44769-1601	16	A
44769-1602	16	B
44769-1603	16	C
44769-1801	18	A
44769-1802	18	B
44769-1803	18	C
44769-2001	20	A
44769-2002	20	B
44769-2003	20	C
44769-2201	22	A
44769-2202	22	B
44769-2203	22	C
44769-2401	24	A
44769-2402	24	B
44769-2403	24	C

SYMBOLS DIMENSION UNITS: IN/MM SCALE: NTS GENERAL TOLERANCES (UNLESS SPECIFIED): 4 PLACES: ± 0.25 ± 0.014 3 PLACES: ± 0.35 ± 0.014 2 PLACES: ± 0.35 ± 0.014 1 PLACE: ± 0.35 ± 0.014 0 PLACES: ± 0.35 ± 0.014 ANGULAR TOL: ± 0.5° DRAFT WHERE APPLICABLE MUST REMAIN WITHIN DIMENSIONS THIRD ANGLE PROJECTION DRAWING SERIES: C-SIZE 44769	THIS DRAWING CONTAINS INFORMATION THAT IS PROPRIETARY TO MOLEX ELECTRONIC TECHNOLOGIES, LLC AND SHOULD NOT BE USED WITHOUT WRITTEN PERMISSION CURRENT REV DESC: ADD POLARIZATION EC NO: 611105 DRWN: JBAUMERT 2019/01/25 CHK'D: SSOUSEK 2019/02/05 APPR: FSMITH 2019/02/07 INITIAL REVISION: DRWN: BURLESON 2000/07/13 APPR: EDGLEY 2000/07/13		<p>MICRO-FIT (3.0) BMI VERTICAL RECEPTACLE HEADER ASSEMBLY, 4 - 24 CIRCUIT</p> <p>PRODUCT CUSTOMER DRAWING</p> <p>DOCUMENT NUMBER: SD-44769-001 DOC TYPE: PSD DOC PART: 001 REVISION: F1</p> <p>MATERIAL NUMBER: SEE CHART CUSTOMER: GENERAL MARKET SHEET NUMBER: 2 OF 2</p>
	DOCUMENT STATUS: P1 RELEASE DATE: 2019/02/07 14:35:12		