

勝特力電材超市-龍山店 886-3-5773766
 勝特力電材超市-光復店 886-3-5729570
 勝特力電子(上海) 86-21-34970699
 勝特力電子(深圳) 86-755-83298787
<http://www.100y.com.tw>

注記 NOTES

- 1. 適合ターミナル : 50752-8*00
 APPLICABLE TERMINAL : 50752-8*00
- 適合ハウジング : 51163-**00
 APPLICABLE HOUSING : 51163-**00
- 2. 偶数極の製品に適用。
 APPLY EVEN CIRCUIT PRODUCTS.
- 3. 8~15極品に適用。
 APPLY 8~15 CKT PRODUCTS.

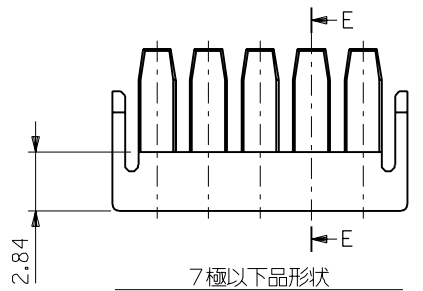

| | | | | | |
|------|------|------|------|------------|----------------------|
| 12.5 | 38.1 | 35 | 39.3 | 51164-1505 | 15 |
| ↑ | 35.6 | 32.5 | 36.8 | ↑ | -1405 |
| | 33.1 | 30 | 34.3 | | -1305 |
| | 30.6 | 27.5 | 31.8 | | -1205 |
| | 28.1 | 25 | 29.3 | | -1105 |
| | 25.6 | 22.5 | 26.8 | | -1005 |
| ↓ | 23.1 | 20 | 24.3 | | -0905 |
| 12.5 | 20.6 | 17.5 | 21.8 | | -0805 |
| X | 18.1 | 15 | 19.3 | | -0705 |
| | 15.6 | 12.5 | 16.8 | | -0605 |
| | 13.1 | 10 | 14.3 | | -0505 |
| | 10.6 | 7.5 | 11.8 | | -0405 |
| | 8.1 | 5 | 9.3 | | -0305 |
| | 5.6 | 2.5 | 6.8 | 51164-0205 | 2 |
| D | C | (B) | (A) | ENG. NO. | 極数 NO. OF CKT. |

トレードマーク
TRADE MARK

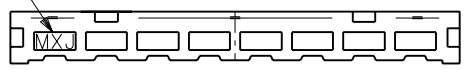

断面 E-E
SECT.E-E
(8極以上)
(OVER 8CKT.)

断面 E-E
SECT.E-E
(7極以下)
(UNDER 7CKT.)

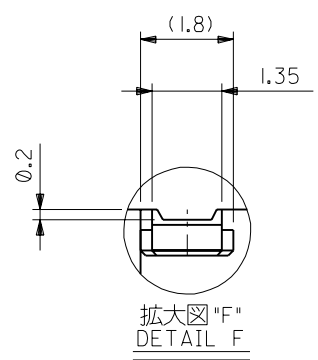
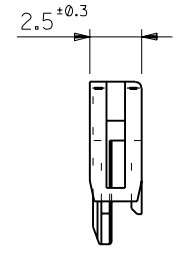

拡大図 "F"
DETAIL F

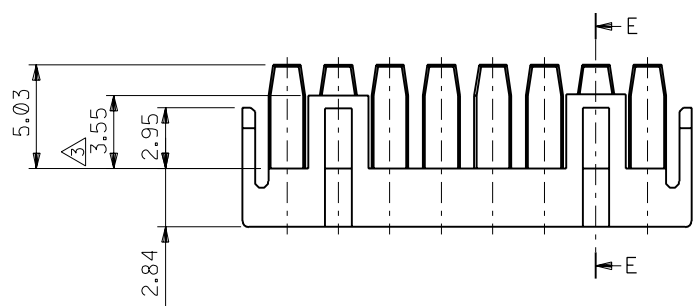
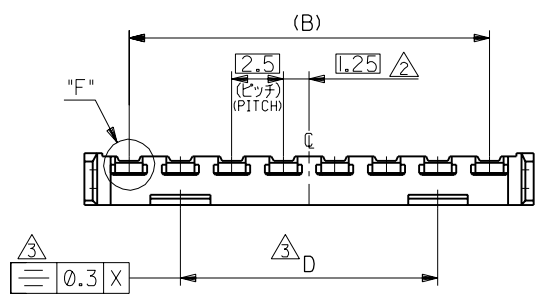
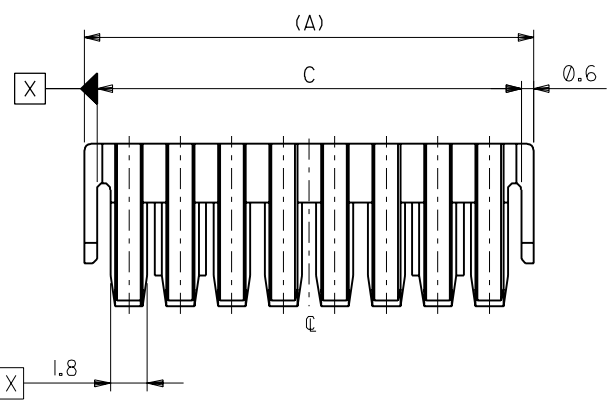

| | | | | | |
|-------------------------|-------|----------------------|----------|-----------|----------|
| 角度 ANGLE | ±3° | | | | |
| 30以上 OVER | +0.3 | | | | |
| 10以上 OVER 30 未満 UNDER | +0.25 | | | | |
| 10 未満 UNDER | +0.2 | | | | |
| 一般公差 GENERAL TOLERANCES | LTR | 変更内容 REVISION RECORD | DR. CHK. | 日付 DATE | 尺度 SCALE |
| | 0 | 新規作成 (JC80469) | S.A.T. | '97/11/27 | 4 : 1 |

材料 MATERIAL PBTP, UL94V-0 (灰色 GRAY)
 仕上げ FINISH — — —
 適用電線範囲 WIRE RANGE — — —
 被覆外径 INS. RANGE — — —
 DRAWN BY '97/11/26 S.AIHARA
 APP'D BY '97/11/27 M.FUKUSHIMA
 CHK'D BY '97/11/27 T.ITO
 尺度 SCALE 4 : 1

MOLEX-JAPAN CO.,LTD.
 日本モレックス株式会社
 REVISE ONLY ON CAD SYSTEM
 TITLE 名称 2.5 WIRE TO BOARD CONN. RETAINER
 DWG. NO. SD-51164-**05
 REV 0