



产品编号 : 643211018

系列号 : 64321

Product Category : Connector Housings

Product Description : .635mm, 1.50mm, 2.80mm, CMC Receptacle, 53 Circuits, Left Wire Output, Gray Coding, Mat Sealed

状态 : Active

---

## 文件和资源

### 图纸

图纸 643211018\_sd.pdf

### 3D 模型和设计文件

3D模型 643211018\_stp.zip

### 规格

应用规格 AS-64318-002-001.pdf

应用规格 AS-64318-002-CH-001.pdf

应用规格 AS-64318-002-SP-001.pdf

应用规格 AS-98420-001-001.pdf

应用规格 AS-98420-001-CH-001.pdf

应用规格 AS-98420-001-SP-001.pdf

应用规格 AS-64318-002-FR-001.pdf

应用规格 AS-98420-001-FR-001.pdf

包装规格 PK-98995-001-001.pdf

产品规格 PS-64321-001-001.pdf

---

## 产物环境合规

### 合规

GADSL/IMDS	Compliant
China RoHS	
EU ELV	Compliant per 2000/53/EC
Low-Halogen Status	Low-Halogen per IEC 61249-2-21
REACH SVHC	Not Contained per D(2023)8585-DC (23 Jan 2024)
EU RoHS	Compliant per EU 2015/863

### 多部分产品合规性声明

- Eu RoHS

- REACH SVHC

- Low-Halogen
- IPC 1752A Class C
- IPC 1752A Class D
- Molex Product Compliance Declaration
- IEC-62474
- chemSHERPA (xml)

欧盟 RoHS 合格证书

## 产品详情

### 常规

状态	活动
类别	Connector Housings
系列	64321
说明	. 635mm, 1. 50mm, 2. 80mm, CMC Receptacle, 53 Circuits, Left Wire Output, Gray Coding, Mat Sealed
应用	Automotive, Power, Wire-to-Board
个评论	Current tested on a fully loaded connector, current for temperature increase of 40° C; Current max = 21.0A for 2.80mm Terminal (5.00mm <sup>2</sup> wire), 12.0A for 1.50mm Terminal (2.00mm <sup>2</sup> wire), 2.5A for 0.635mm Terminal (0.75mm <sup>2</sup> wire)
更详细的技术信息	Sealed, high-density, power, modular connecting system for Power Train and Body Electronics applications in cars, trucks, busses
产品系列	CMC and CMX Sealed, Hybrid, Modular Connectors
产品名称	CMC
UPC	883906135171

### 物理

电路详图	5x 2.8mm, 8 x 1.5mm, 40 x 0.635mm terminals
电路数 (最多)	53
颜色-树脂	灰色
性别	Receptacle

符合灼热丝规范	否
插接极性	是
锁定插接部位	是
材料 - 树脂	Polyester
净重	50.888/g
行数	5
包装形式	Carton
面板安装式	否
间距 - 插配接口	2.54mm, 3.50mm, 7.00mm
有极性的插配件	是
可堆叠的	否
运行温度范围	-40° to +125° C

## 进程

无铅	不适用
----	-----

---

## 可配插/可连接使用的产品

### 可配插部件

描述	产品编号
配插使用	Please contact Molex for details

### 可连接使用部件

描述	产品编号
Wire Cap for CMC Mat Sealed Receptacle, 53 Circuits	<a href="/content/molex/molex-dot-com/cn/zh/products/product-page.html/643211101.html">/content/molex/molex-dot-com/cn/zh/products/product-page.html/643211101.html</a>
CMC 0.635mm Blind Cavity Plug	<a href="/content/molex/molex-dot-com/cn/zh/products/product-page.html/643251010.html">/content/molex/molex-dot-com/cn/zh/products/product-page.html/643251010.html</a>
CMC 1.50mm Blind Cavity Plug	<a href="/content/molex/molex-dot-com/cn/zh/products/product-page.html/643251023.html">/content/molex/molex-dot-com/cn/zh/products/product-page.html/643251023.html</a>
CMC 2.80mm Blind Cavity Plug	<a href="/content/molex/molex-dot-com/cn/zh/products/product-page.html/643251091.html">/content/molex/molex-dot-com/cn/zh/products/product-page.html/643251091.html</a>
0.635mm CMC CP Female Terminals	<u>64322</u>

---

1.50mm CMC CP Female Terminals	<u>64323</u>
--------------------------------	--------------

---

施工工具

全局

描述	产品编号
Continuity Test Pen Assembly	<u>638121100</u>
Unlocking Tool for CMC and CMX Receptacle Connector	<u>638241200</u>

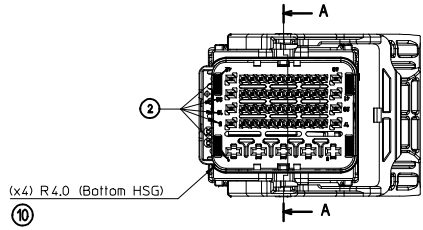
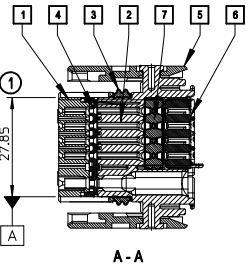

CMC 53W LEFT WIRE OUTPUT

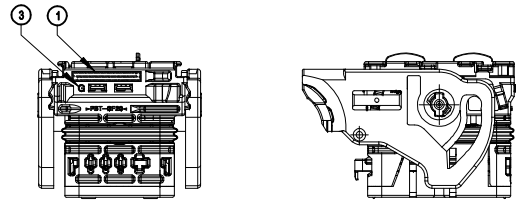

LEFT WIRE OUTPUT (Position shown below)	
MOLEX P/N	COLOR
0643211011	BLACK
0643211018	GREY
0643211019	BROWN
0643211015	GREEN

RIGHT WIRE OUTPUT (Position shown below)	
MOLEX P/N	COLOR
0643212011	BLACK
0643212018	GREY
0643212019	BROWN
0643212015	GREEN

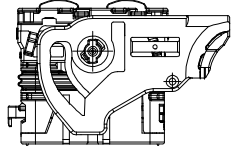
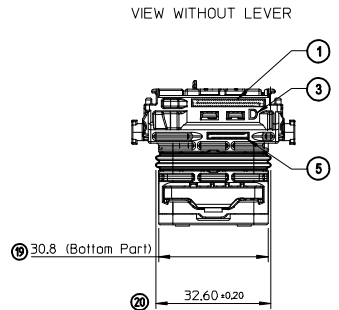
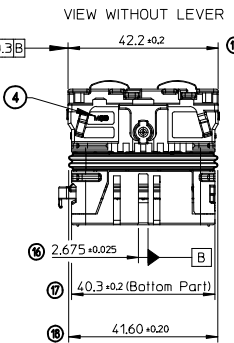
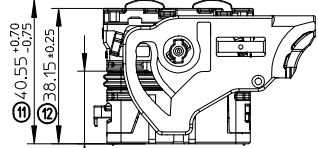
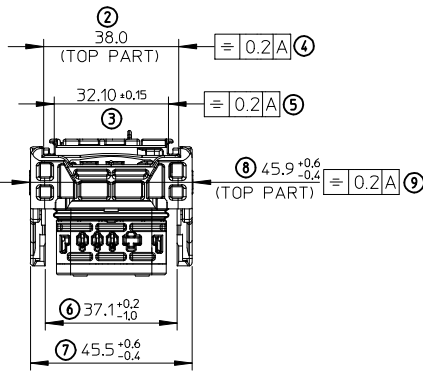
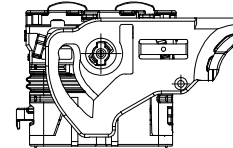
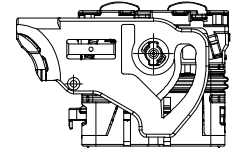

1:1

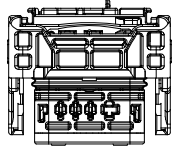

ISOMETRIC VIEWS

1:1

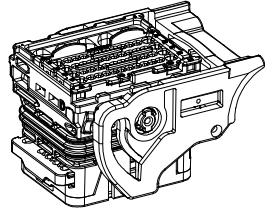
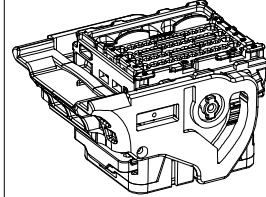

LEFT WIRE OUTPUT

RIGHT WIRE OUTPUT

POS.	QTY	DESCRIPTION	MATERIAL	COLOR
7	1	BACK SEAL "GROMMET"	Silicon	RED
8	1	REAR SEAL COVER	>PBT-GF20<	GREY
5	1	LOCKING LEVER R&L S4	>PBT-GF30<	BLACK
4	1	TPA	>PBT-GF20<	YELLOW
3	1	PERIMETER SEAL SIZE 4	Silicon	RED
2	1	HOUSING TOP PART	>PBT-GF20<	BROWN
1	1	HOUSING BOTTOM PART	>PBT-GF20<	BLACK
			BROWN	
			GREY	
			GREEN	

MARKINGS:

- 1 - Tracking N° for assembled connector. (Year & Day)
- 2 - Cavities Identification (N°).
- 3 - Lever sens indicator. Visible letter "D" = RIGHT WIRE OUTPUT. (Lever on the opposite side of the SL Key) Visible letter "G" = LEFT WIRE OUTPUT. (Lever on the side of the SL Key)
- 4 - Supplier logo.
- 5 - Molex Area.

NOTES:

- 1- The represented female connector is the "D" version (Way out on the Right), Black coding.
- 2- Application Spec.: AS-64318-002
- 3- Plugs & caps used:  
Cavities 0.6: plug: 0643251010  
Cavities 1.5: plug: 0643251023  
Cavities 2.8: cap: 0643251091
- 4- Weight: 50,8 g
- 5- The assembled female connector matches with the cover CMC 53W (P/N: 0643211011)

\*- Clamping areas on male connector.

MODIFY: COLOR PERIMETER SEAL EC NO: G2014-01Z7 DRAWN: J. JOUAS 2014/01/16 CHKD: CROUCHAN 2014/01/16 APPR: O.PLESSIS 2014/06/17	DESCRIPTION	GENERAL TOLERANCES (UNLESS SPECIFIED)		DIMENSION STYLE MM ONLY	SCALE 1:1	DESIGN UNITS METRIC	FIRST ANGLE PROJECTION
		4 PLACES ± --- ± --- 3 PLACES ± --- ± --- 2 PLACES ± 0.05 ± --- 1 PLACE ± 0.1 ± --- 0 PLACE ± 0.1 ± ---	m/m INCH	DRAWN BY DATE G. DESBRUERES 2007/09/05	TITLE CMC FEMALE MODULE 53W GENERIC SALES DRAWING		
		DRAFT WHERE APPLICABLE MUST REMAIN WITHIN DIMENSIONS		CHECKED BY DATE O.PLESSIS 2007/09/06	SHEET NO. 1 OF 2		
		ANGULAR ± 2 °		APPROVED BY DATE L. STICKEIR 2007/09/07			



SD-64321-001

**CODINGS**

**FEMALE HOUSING RIGHT WIRE OUTPUT**

**MODULE OVERALL DIMENSIONS:**

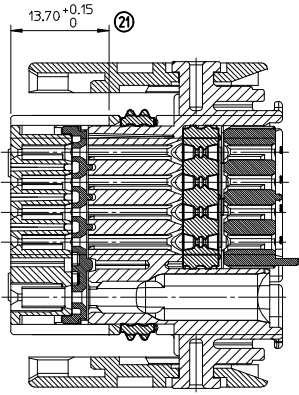

**B - B  
2:1**

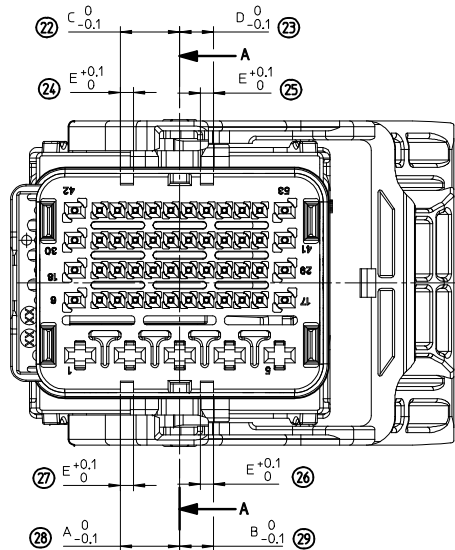

COLOR	CODING	A $\begin{smallmatrix} 0 \\ -0,1 \end{smallmatrix}$	B $\begin{smallmatrix} 0 \\ -0,1 \end{smallmatrix}$	C $\begin{smallmatrix} 0 \\ -0,1 \end{smallmatrix}$	D $\begin{smallmatrix} 0 \\ -0,1 \end{smallmatrix}$	E $\begin{smallmatrix} +0,1 \\ 0 \end{smallmatrix}$
BLACK	1	8,4	4,8	8,4	4,8	1,8
GREY	2	8,4	6,6	6,6	6,6	1,8
BROWN	3	8,4	8,4	4,8	10,2	1,8
GREEN	4	4,8	10,2	8,4	12,0	1,8

**TERMINALS' P/N(S)**

CAVITIES N°	FEMALE TERMINALS (Section mm2)	PLATING	MOLEX P/N	WIRE SEAL	min / MAX WIRE INSULATION DIAMETER		
7 to 16 19 to 28 31 to 40 43 to 52	CP 0.6 (0.35mm2)	Tin plated	0643221019		∅1.25 min. / ∅1.40 Max.		
		Gold plated	0643221229				
	CP 0.6 (0.5mm2)	Tin plated	0643221039				
		Gold plated	0643221239				
6, 17, 18 29, 30, 41 42, 53	CP 0.6 (0.75mm2)	Tin plated	0643221029		∅1.60 min. / ∅1.90 Max.		
		Gold plated	0643221219				
	CP 1.5 (0.5mm2 to 1mm2)	Tin plated	0643231029				
		Gold plated	0643231319				
1 to 5	CP 1.5 (>1mm2 to 2mm2)	Tin plated	0643231039		∅2.10 min. / ∅2.80 Max.		
		Gold plated	0643231219				
	CP 2.8 (>0.5mm2 to 1mm2)	Tin plated	0643241049			0643251332	∅1.40 min. / ∅2.15 Max.
		Gold plated	0643241149				
	CP 2.8 (>1mm2 to 2mm2)	Tin plated	0643241039	0643251345	∅2.10 min. / ∅2.80 Max.		
		Gold plated	0643241139				
	CP 2.8 (>2mm2 to 3mm2)	Tin plated	0643241029			0643251358	∅2.65 min. / ∅3.45 Max.
		Gold plated	0643241129				
	CP 2.8 (>3mm2 to 5mm2)	Tin plated	0643241019	0643251366	∅3.40 min. / ∅4.00 Max.		
		Gold plated	0643241119				

**TPA: UNLOCKED POSITION**

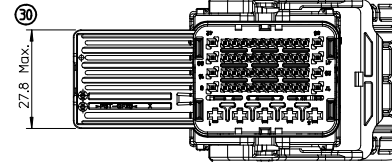

**TPA: DELIVERY POSITION**

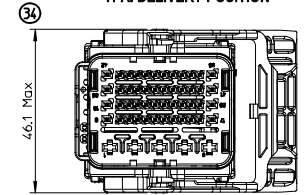

**RIGHT WIRE OUTPUT**

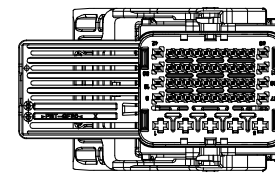
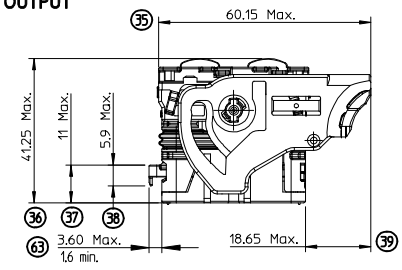
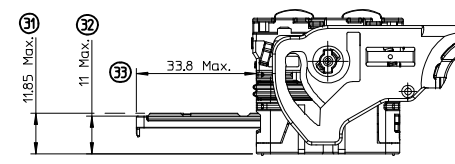

**LEFT WIRE OUTPUT**

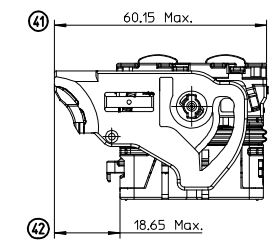
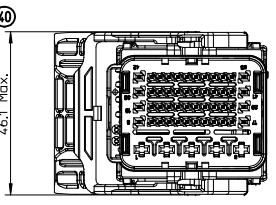
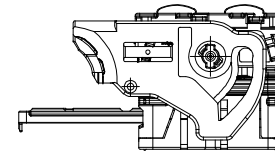

MODIFY COLOR PERMETER SEAL EC NO: G2014-0127 DRAWN: JOUAS 2014/01/16 CHKD: BROUHAN 2014/01/16 APPR: PLESSIS 2014/06/17	DESCRIPTION	GENERAL TOLERANCES (UNLESS SPECIFIED)		DIMENSION STYLE MM ONLY		SCALE 1.5:1	DESIGN UNITS METRIC	FIRST ANGLE PROJECTION		
		4 PLACES ± --- ± --- 3 PLACES ± --- ± --- 2 PLACES ± 0.05 ± --- 1 PLACE ± 0.1 ± --- 0 PLACE ± 0.1 ± ---	mm INCH ± --- ± --- ± --- ± --- ± --- ± --- ± --- ± ---	DRAWN BY G. DESBRUERES	DATE 2007/09/05	TITLE CMC FEMALE MODULE 53W GENERIC SALES DRAWING				
		ANGULAR ± 2 ° DRAFT WHERE APPLICABLE MUST REMAIN WITHIN DIMENSIONS		CHECKED BY O. PLESSIS	DATE 2007/09/06	APPROVED BY L. STICKEIR		DATE 2007/09/07	MATERIAL NO. SEE SHEET 1	
				DOCUMENT NO. SD-64321-001		SHEET NO. 2 OF 2				

THIS DRAWING CONTAINS INFORMATION THAT IS PROPRIETARY TO MOLEX INCORPORATED AND SHOULD NOT BE USED WITHOUT WRITTEN PERMISSION