



产品编号 : 643212019

系列号 : 64321

Product Category : Connector Housings

Product Description : .635mm, 1.50mm, 2.80mm, CMC Receptacle, 53 Circuits, Right Wire Output, Brown Coding, Mat Sealed

状态 : Active

文件和资源

图纸

图纸 643212019_sd.pdf

3D 模型和设计文件

3D模型 643212019_stp.zip

规格

应用规格 AS-64318-002-001.pdf

应用规格 AS-64318-002-CH-001.pdf

应用规格 AS-64318-002-SP-001.pdf

应用规格 AS-98420-001-001.pdf

应用规格 AS-98420-001-CH-001.pdf

应用规格 AS-98420-001-SP-001.pdf

应用规格 AS-64318-002-FR-001.pdf

应用规格 AS-98420-001-FR-001.pdf

包装规格 PK-98995-001-001.pdf

产品规格 PS-64321-001-001.pdf

产物环境合规

合规

| | |
|--------------------|---|
| GADSL/IMDS | Compliant |
| China RoHS |  |
| EU ELV | Compliant per 2000/53/EC |
| Low-Halogen Status | Low-Halogen per IEC 61249-2-21 |
| REACH SVHC | Not Contained per D(2023)8585-DC (23 Jan 2024) |
| EU RoHS | Compliant per EU 2015/863 |

多部分产品合规性声明

- Eu RoHS

- REACH SVHC

- Low-Halogen
- IPC 1752A Class C
- IPC 1752A Class D
- Molex Product Compliance Declaration
- IEC-62474
- chemSHERPA (xml)

欧盟 RoHS 合格证书

产品详情

常规

| | |
|----------|---|
| 状态 | 活动 |
| 类别 | Connector Housings |
| 系列 | 64321 |
| 说明 | .635mm, 1.50mm, 2.80mm, CMC Receptacle, 53 Circuits, Right Wire Output, Brown Coding, Mat Sealed |
| 应用 | Automotive, Power, Wire-to-Board |
| 评论 | Current tested on a fully loaded connector, current for temperature increase of 40° C; Current max = 21.0A for 2.80mm Terminal (5.00mm ² wire), 12.0A for 1.50mm Terminal (2.00mm ² wire), 2.5A for 0.635mm Terminal (0.75mm ² wire) |
| 更详细的技术信息 | Sealed, high-density, power, modular connecting system for Power Train and Body Electronics applications in cars, trucks, busses |
| 产品系列 | CMC and CMX Sealed, Hybrid, Modular Connectors |
| 产品名称 | CMC |
| UPC | 883906135324 |

物理

| | |
|----------|---|
| 电路详图 | 5x 2.8mm, 8 x 1.5mm, 40 x 0.635mm terminals |
| 电路数 (最多) | 53 |
| 颜色-树脂 | 棕色 |
| 性别 | Receptacle |

| | |
|-----------|------------------------|
| 符合灼热丝规范 | 否 |
| 插接极性 | 是 |
| 锁定插接部位 | 是 |
| 材料 - 树脂 | Polyester |
| 净重 | 50.860/g |
| 行数 | 5 |
| 包装形式 | Carton |
| 面板安装式 | 否 |
| 间距 - 插配接口 | 2.54mm, 3.50mm, 7.00mm |
| 有极性的插配件 | 是 |
| 可堆叠的 | 否 |
| 运行温度范围 | -40° to +125° C |

进程

| | |
|----|-----|
| 无铅 | 不适用 |
|----|-----|

可配插/可连接使用的产品

可配插部件

| 描述 | 产品编号 |
|--|------------------|
| CMC Header 154 Circuits, 3-Bay (Bay-X 48 Circuits; Bay-Y 53 Circuits; Bay-Z 53 Circuits) Compliant Pin, Press-fit Style | <u>347630001</u> |

可连接使用部件

| 描述 | 产品编号 |
|--|--|
| Wire Cap for CMC Mat Sealed Receptacle, 53 Circuits | <u>/content/molex/molex-dot-com/cn/zh/products/product-page.html/643211101.html</u> |
| CMC 0.635mm Blind Cavity Plug | <u>/content/molex/molex-dot-com/cn/zh/products/product-page.html/643251010.html</u> |
| CMC 1.50mm Blind Cavity Plug | <u>/content/molex/molex-dot-com/cn/zh/products/product-page.html/643251023.html</u> |
| CMC 2.80mm Blind Cavity Plug | <u>/content/molex/molex-dot-com/cn/zh/products/product-page.html/643251091.html</u> |

| | |
|---------------------------------|--------------|
| 0.635mm CMC CP Female Terminals | <u>64322</u> |
| 1.50mm CMC CP Female Terminals | <u>64323</u> |

施工工具

全局

| 描述 | 产品编号 |
|---|------------------|
| Continuity Test Pen Assembly | <u>638121100</u> |
| Unlocking Tool for CMC and CMX Receptacle Connector | <u>638241200</u> |

This document was generated on Jun 04, 2024

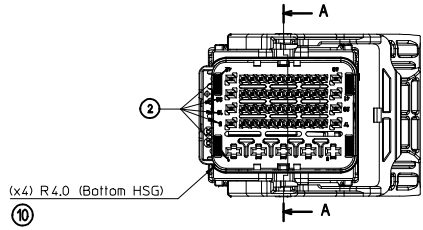
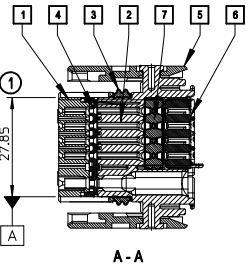

CMC 53W LEFT WIRE OUTPUT

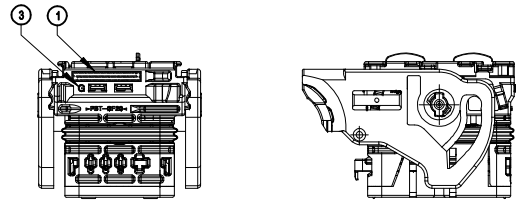

| LEFT WIRE OUTPUT (Position shown below) | |
|--|-------|
| MOLEX P/N | COLOR |
| 0643211011 | BLACK |
| 0643211018 | GREY |
| 0643211019 | BROWN |
| 0643211015 | GREEN |

| RIGHT WIRE OUTPUT (Position shown below) | |
|---|-------|
| MOLEX P/N | COLOR |
| 0643212011 | BLACK |
| 0643212018 | GREY |
| 0643212019 | BROWN |
| 0643212015 | GREEN |

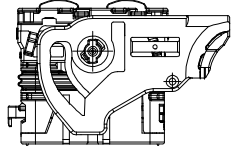
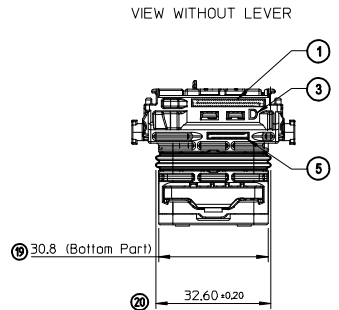
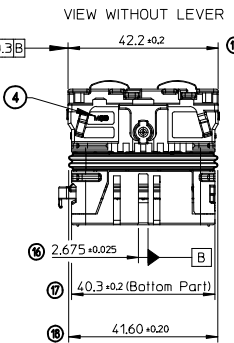
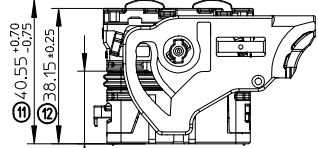
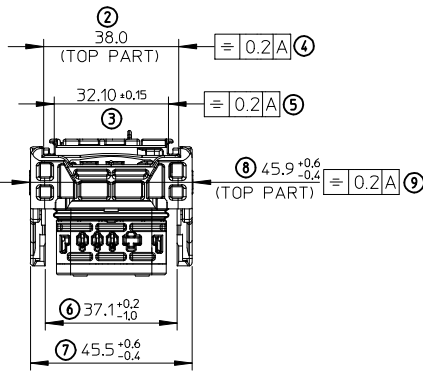
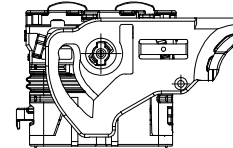
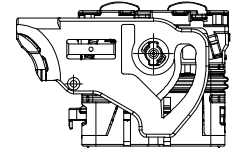

1:1

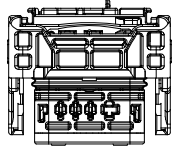

ISOMETRIC VIEWS

1:1

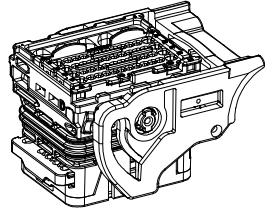
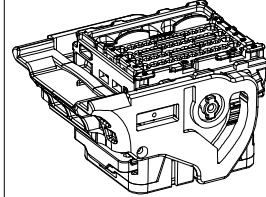

LEFT WIRE OUTPUT

RIGHT WIRE OUTPUT

| POS. | QTY | DESCRIPTION | MATERIAL | COLOR |
|------|-----|-----------------------|------------|--------|
| 7 | 1 | BACK SEAL "GROMMET" | Silicon | RED |
| 8 | 1 | REAR SEAL COVER | >PBT-GF20< | GREY |
| 5 | 1 | LOCKING LEVER R&L S4 | >PBT-GF30< | BLACK |
| 4 | 1 | TPA | >PBT-GF20< | YELLOW |
| 3 | 1 | PERIMETER SEAL SIZE 4 | Silicon | RED |
| 2 | 1 | HOUSING TOP PART | >PBT-GF20< | BROWN |
| 1 | 1 | HOUSING BOTTOM PART | >PBT-GF20< | BLACK |
| | | | BROWN | |
| | | | GREY | |
| | | | GREEN | |

MARKINGS:

- ① - Tracking N° for assembled connector. (Year & Day)
- ② - Cavities Identification (N°).
- ③ - Lever sens indicator. Visible letter "D" = RIGHT WIRE OUTPUT. (Lever on the opposite side of the SL Key)
- ④ - Visible letter "G" = LEFT WIRE OUTPUT. (Lever on the side of the SL Key)
- ⑤ - Supplier logo.
- ⑥ - Molex Area.

NOTES:

- 1- The represented female connector is the "D" version (Way out on the Right), Black coding.
- 2- Application Spec.: AS-64318-002
- 3- Plugs & caps used:
 Cavities 0.6: plug: 0643251010
 Cavities 1.5: plug: 0643251023
 Cavities 2.8: cap: 0643251091
- 4- Weight: 50,8 g
- 5- The assembled female connector matches with the cover CMC 53W (P/N: 0643211101)

*- Clamping areas on male connector.

| | | | | | | | |
|--|---|----------|--|---|------------------------------|--|--|
| MODIFY: COLOR PERIMETER SEAL EC NO: G2014-01Z7 DRAWN: J. JOUAS 2014/01/16 CHKD: CROUCHAN 2014/01/16 APPR: O.PLESSIS 2014/06/17 | GENERAL TOLERANCES (UNLESS SPECIFIED) | | DIMENSION STYLE MM ONLY | SCALE 1:1 | DESIGN UNITS METRIC | FIRST ANGLE PROJECTION | |
| | 4 PLACES ± --- ± --- 3 PLACES ± --- ± --- 2 PLACES ± 0.05 ± --- 1 PLACE ± 0.1 ± --- 0 PLACE ± 0.1 ± --- | m/m INCH | DRAWN BY DATE G. DESBRUERES 2007/09/05 | TITLE CMC FEMALE MODULE 53W GENERIC SALES DRAWING | SHEET NO. 1 OF 2 | | |
| | ANGULAR ± 2 ° | | CHECKED BY DATE O.PLESSIS 2007/09/06 | molex | | | |
| | DRAFT WHERE APPLICABLE MUST REMAIN WITHIN DIMENSIONS | | APPROVED BY DATE L. STICKEIR 2007/09/07 | MATERIAL NO. SEE CHARTS | DOCUMENT NO. SD-64321-001 | INCORPORATED AND SHOULD NOT BE USED WITHOUT WRITTEN PERMISSION | |

CODINGS

FEMALE HOUSING RIGHT WIRE OUTPUT

MODULE OVERALL DIMENSIONS:

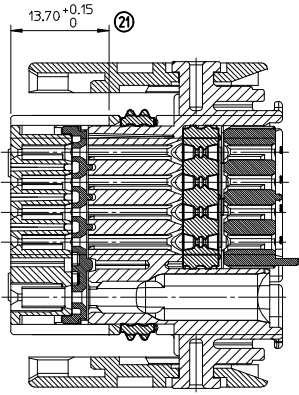

**B - B
2:1**

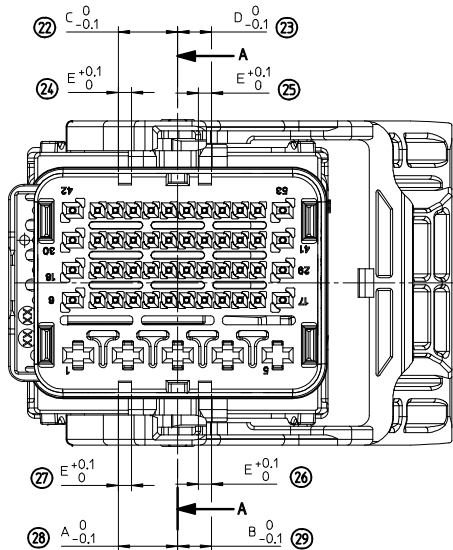

| COLOR | CODING | A $\begin{smallmatrix} 0 \\ -0,1 \end{smallmatrix}$ | B $\begin{smallmatrix} 0 \\ -0,1 \end{smallmatrix}$ | C $\begin{smallmatrix} 0 \\ -0,1 \end{smallmatrix}$ | D $\begin{smallmatrix} 0 \\ -0,1 \end{smallmatrix}$ | E $\begin{smallmatrix} +0,1 \\ 0 \end{smallmatrix}$ |
|-------|--------|---|---|---|---|---|
| BLACK | 1 | 8,4 | 4,8 | 8,4 | 4,8 | 1,8 |
| GREY | 2 | 8,4 | 6,6 | 6,6 | 6,6 | 1,8 |
| BROWN | 3 | 8,4 | 8,4 | 4,8 | 10,2 | 1,8 |
| GREEN | 4 | 4,8 | 10,2 | 8,4 | 12,0 | 1,8 |

TERMINALS' P/N(S)

| CAVITIES N° | FEMALE TERMINALS (Section mm2) | PLATING | MOLEX P/N | WIRE SEAL | min / MAX WIRE INSULATION DIAMETER | | |
|---|--------------------------------|-------------|------------|------------|------------------------------------|------------|-------------------------|
| 7 to 16 19 to 28 31 to 40 43 to 52 | CP 0.6 (0.35mm2) | Tin plated | 0643221019 | | ∅1.25 min. / ∅1.40 Max. | | |
| | | Gold plated | 0643221229 | | | | |
| | CP 0.6 (0.5mm2) | Tin plated | 0643221039 | | | | |
| | | Gold plated | 0643221239 | | | | |
| 6, 17, 18 29, 30, 41 42, 53 | CP 0.6 (0.75mm2) | Tin plated | 0643221029 | | ∅1.60 min. / ∅1.90 Max. | | |
| | | Gold plated | 0643221219 | | | | |
| | CP 1.5 (0.5mm2 to 1mm2) | Tin plated | 0643231029 | | | | |
| | | Gold plated | 0643231319 | | | | |
| 1 to 5 | CP 1.5 (>1mm2 to 2mm2) | Tin plated | 0643231039 | | ∅2.10 min. / ∅2.80 Max. | | |
| | | Gold plated | 0643231219 | | | | |
| | CP 2.8 (>0.5mm2 to 1mm2) | Tin plated | 0643241049 | | | 0643251332 | ∅1,40 min. / ∅2,15 Max. |
| | | Gold plated | 0643241149 | | | | |
| 1 to 5 | CP 2.8 (>1mm2 to 2mm2) | Tin plated | 0643241039 | 0643251345 | ∅2,10 min. / ∅2,80 Max. | | |
| | | Gold plated | 0643241139 | | | | |
| | CP 2.8 (>2mm2 to 3mm2) | Tin plated | 0643241029 | | | 0643251358 | ∅2,65 min. / ∅3,45 Max. |
| | | Gold plated | 0643241129 | | | | |
| 1 to 5 | CP 2.8 (>3mm2 to 5mm2) | Tin plated | 0643241019 | 0643251366 | ∅3,40 min. / ∅4,00 Max. | | |
| | | Gold plated | 0643241119 | | | | |

TPA: UNLOCKED POSITION

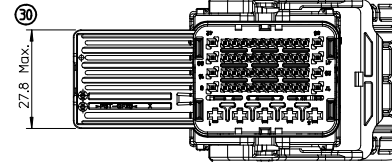

TPA: DELIVERY POSITION

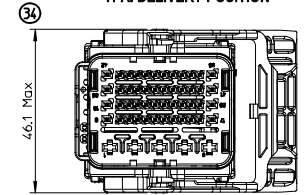

RIGHT WIRE OUTPUT

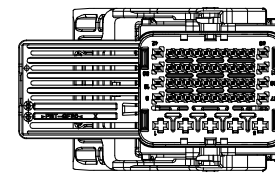
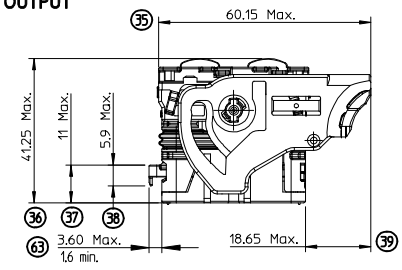
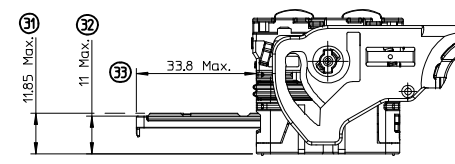

LEFT WIRE OUTPUT

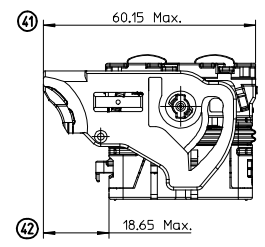
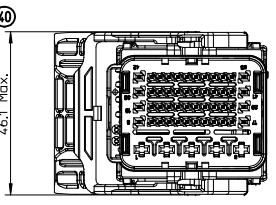
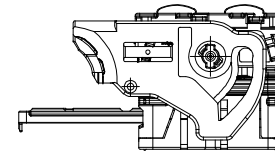

| | | | | | | | | | |
|--|-------------|---|---------|------------------------------|--------------------|--|----------------------------|------------------------|--------------------|
| MODIFY COLOR PERMETER SEAL EC NO: G2014-0127 DRAWN: JOUAS 2014/01/16 CHKD: BROUHAN 2014/01/16 APPR: PLESSIS 2014/06/17 | DESCRIPTION | GENERAL TOLERANCES (UNLESS SPECIFIED) | | DIMENSION STYLE MM ONLY | | SCALE 1.5:1 | DESIGN UNITS METRIC | FIRST ANGLE PROJECTION | |
| | | 4 PLACES ± --- ± --- 3 PLACES ± --- ± --- 2 PLACES ± 0.05 ± --- 1 PLACE ± 0.1 ± --- 0 PLACE ± 0.1 ± --- | mm INCH | DRAWN BY G. DESBRUERES | DATE 2007/09/05 | TITLE CMC FEMALE MODULE 53W GENERIC SALES DRAWING | | SHEET NO. 2 OF 2 | |
| REV | | ANGULAR ± 2 ° DRAFT WHERE APPLICABLE MUST REMAIN WITHIN DIMENSIONS | | CHECKED BY O. PLESSIS | | DATE 2007/09/06 | APPROVED BY L. STICKEIR | | DATE 2007/09/07 |
| MATERIAL NO. | | SEE SHEET 1 | | DOCUMENT NO. SD-64321-001 | | THIS DRAWING CONTAINS INFORMATION THAT IS PROPRIETARY TO MOLEX INCORPORATED AND SHOULD NOT BE USED WITHOUT WRITTEN PERMISSION | | | |