

NOTES

- 1 - GENERAL TOLERANCE ACC. DIN 16901 GROUP 130
- 2 - SEALING AREA (NO BURR, SCRATCHES, CONTAMINATION, SHRINK DEPENDENT WARPAGE AND TOOL SPLITTING LINES ALLOWED)
- 3 - MATERIAL MARKING
ADDITIONAL MARKING POSSIBLE
e.g.: - CAVITY NO.
- MATERIAL NO.
- VERSION NO.
- TRACEABILITY MARKING (INK-JET OR LASERMARKING (SPECIAL PLASTIC MATERIAL NEEDED))
- etc.
- 4 - TOOLING SPLITTING LINES FOR AIR VENT (2x)
- 5 - COLOUR CODING ON INTERFACE (BROWN AND BLUE)
- 6 - MARKING FOR HARNESS DIRECTION: APPLY THERMAL RIBBON
- 7 - MATES WITH CMC CONNECTOR 32CKT
MATERIAL NO's:
RIGHT WIRE OUTPUT BROWN CODING 643193219
RIGHT WIRE OUTPUT BLACK CODING 643193211
RIGHT WIRE OUTPUT BLUE CODING 643193216
LEFT WIRE OUTPUT BROWN CODING 643191219
LEFT WIRE OUTPUT BLACK CODING 643191211
LEFT WIRE OUTPUT BLUE CODING 643191216
- 8 - THE PRODUCT INTERFACE INFORMATION SEE SD-98644-006

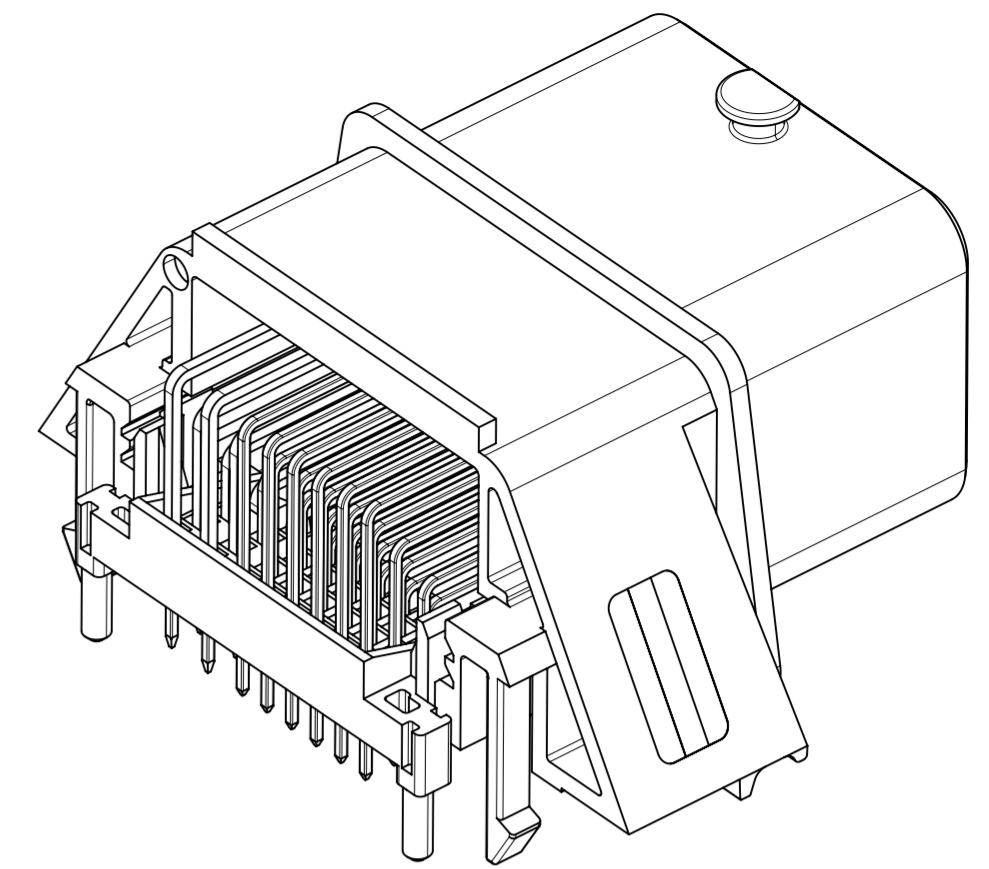

3D-VIEW

TECHNICAL PERFORMANCE CHARACTERISTICS

LOCKING FEATURES RETENTION FORCE AVERAGE: >260N
THE LOWEST RETENTION FORCE VALUE >240N

PIN RETENTION AND TRACTION FORCES:

PIN	SIZE [mm]	RETENTION FORCES
PIN 0.635	0.635 x 0.635	≥ 30N
PIN 1.5	1.5 x 0.8	≥ 60N

SOLDERABILITY:
TESTING ACC. DIN IEC 60068-2-20 WITHOUT PRE-AGING

ALL FURTHER TECHNICAL PERFORMANCE CHARACTERISTICS
ARE SHOWN IN PRODUCTS AND TEST SPECIFICATION OF THE
RELEVANT FEMALE CONNECTORS: PS-64319-001

勝特力電材超市-龍山店 886-3-5773766
勝特力電材超市-光復店 886-3-5729570
勝特力电子(上海) 86-21-34970699
勝特力电子(深圳) 86-755-83298787
<http://www.100y.com.tw>

BILL OF MATERIAL

ITEM	DESCRIPTION	RAW MATERIAL	BARRIER (OVERALL)	FINISH (OVERALL)	UNIT	AMOUNT			
10	Pin 1.5 Row 4	CuZn30	Ni 1.3-3.8µm	Sn 2-4µm	PIECE	2			
9	Pin 1.5 Row 3				PIECE	2			
8	Pin 1.5 Row 2				PIECE	2			
7	Pin 1.5 Row 1				PIECE	2			
6	Pin 0.64 Row 4				PIECE	6			
5	Pin 0.64 Row 3				PIECE	6			
4	Pin 0.64 Row 2				PIECE	6			
3	Pin 0.64 Row 1				PIECE	6			
2	GUIDE PLATE				PBT GF30-V0 BLK	---	---	PIECE	1
1	HOUSING				PBT GF30-V0 BLK	---	---	PIECE	1

TOOLED PART LIST

DESCRIPTION	MOLEX PART NUMBER	CODING COLOR	WEIGHT MEASURED
CMC HDR ASSY 32CKT	0643340100	BLACK	28.3g
	0643340300	BROWN	
	0643340500	BLUE	

INSPECTION BALLOON NUMBER LOG
PER DRAWING REVISION: C
LAST BALLOON NUMBER USED: 26
ADDED BALLOON NUMBER USED:
REMOVED BALLOON NUMBER: 4, 5, 10

THIS DRAWING CONTAINS INFORMATION THAT IS PROPRIETARY TO MOLEX ELECTRONIC TECHNOLOGIES, LLC AND SHOULD NOT BE USED WITHOUT WRITTEN PERMISSION

DIMENSION UNITS	SCALE	CURRENT REV DESC: REFER TO REVISION CHANGE LOG FOR DETAILS IN G-2 OF SHEET 1	molex
mm	2:1	1	
		EC NO: 629431 DRWN: HKANG03 2019/12/02 CHK'D: HWBAI 2020/02/12 APPR: SLAFAURE 2020/02/18	CMC HEADER 32CKT ASSEMBLED SOLDER VERSION
		INITIAL REVISION: DRWN: TLUO 2009/04/15 APPR: GGLEE 2009/05/11	PRODUCT CUSTOMER DRAWING
		DRAFT WHERE APPLICABLE MUST REMAIN WITHIN DIMENSIONS	DOCUMENT NUMBER: SD-64334-100 DOC TYPE: PSD DOC PART: 005 REVISION: D
		THIRD ANGLE PROJECTION	MATERIAL NUMBER: SEE TABLE CUSTOMER: GENERAL MARKET SHEET NUMBER: 1 OF 2
		DRAWING: A2-SIZE	SERIES: 64334

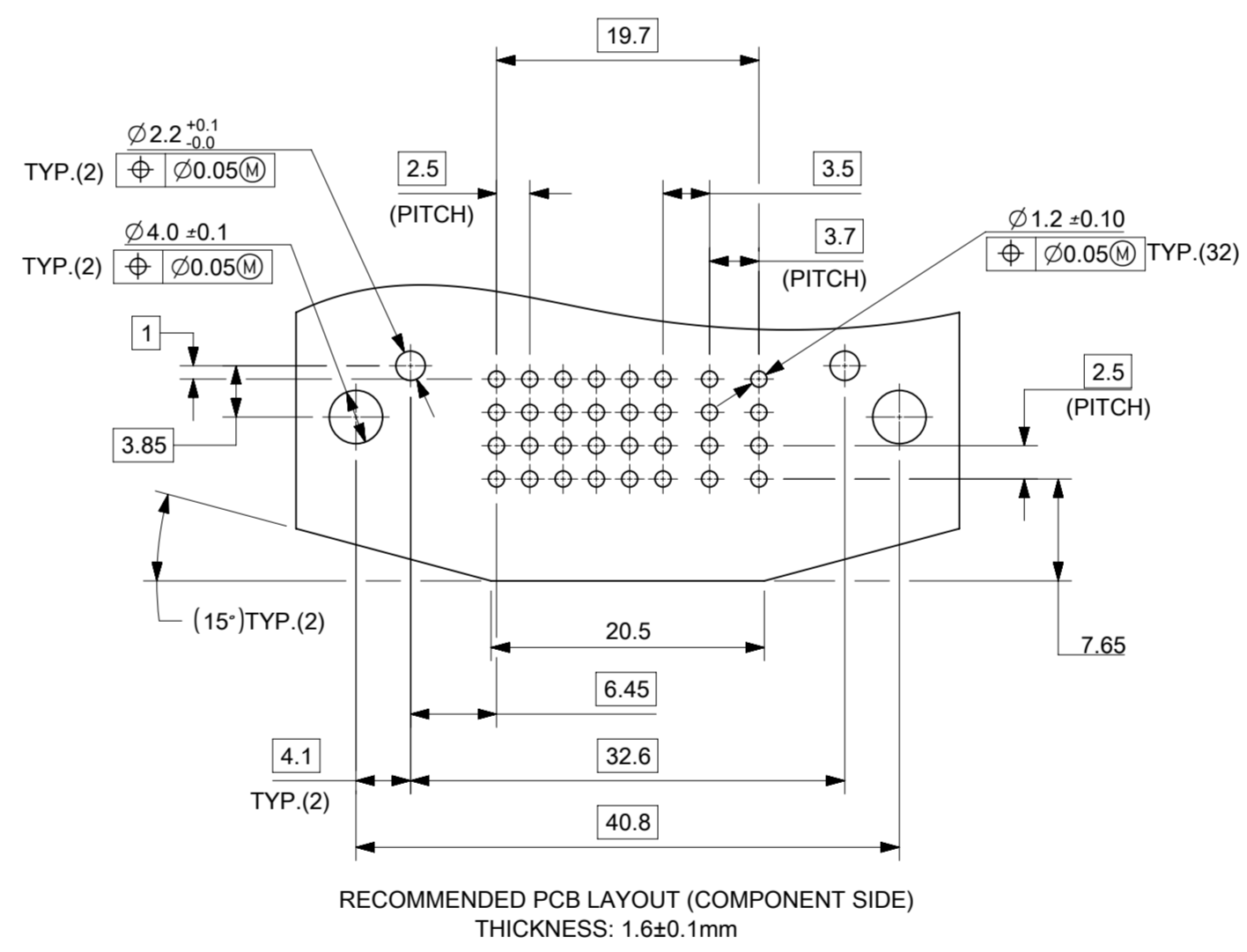
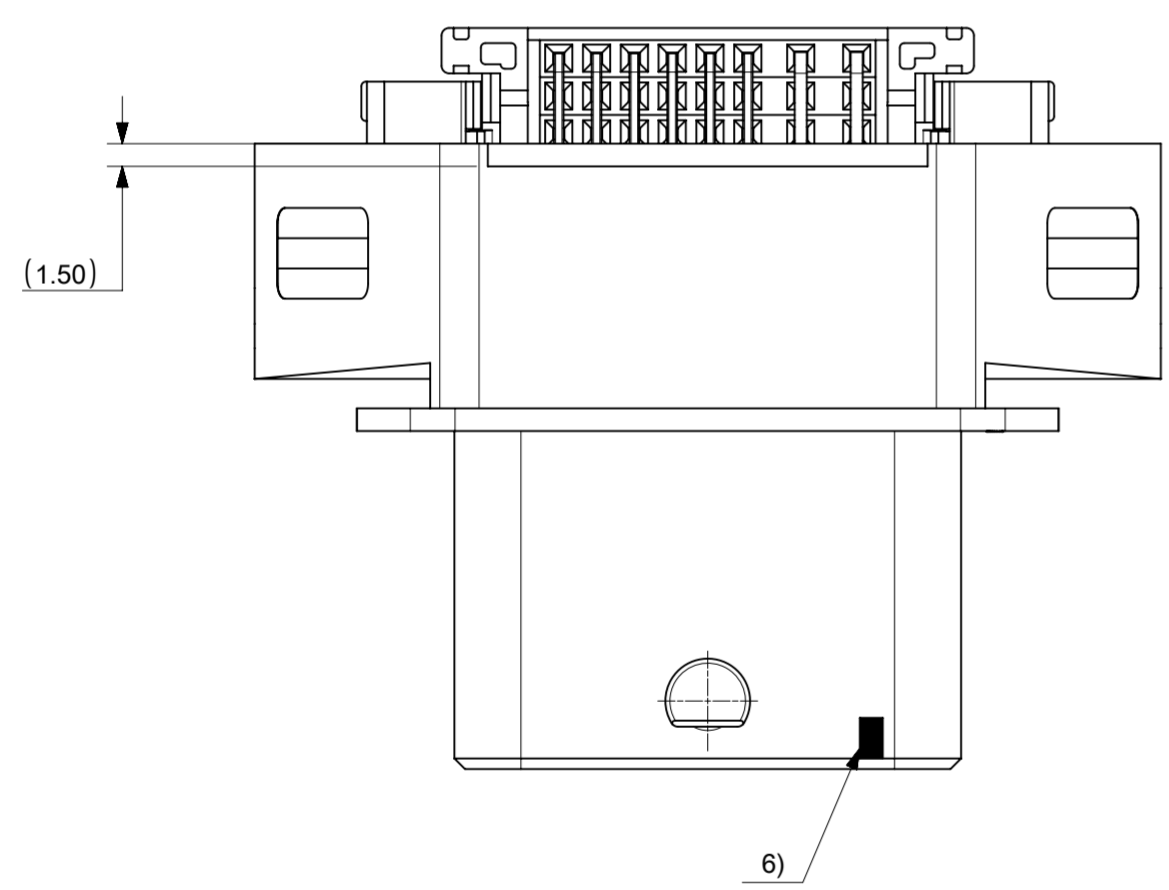
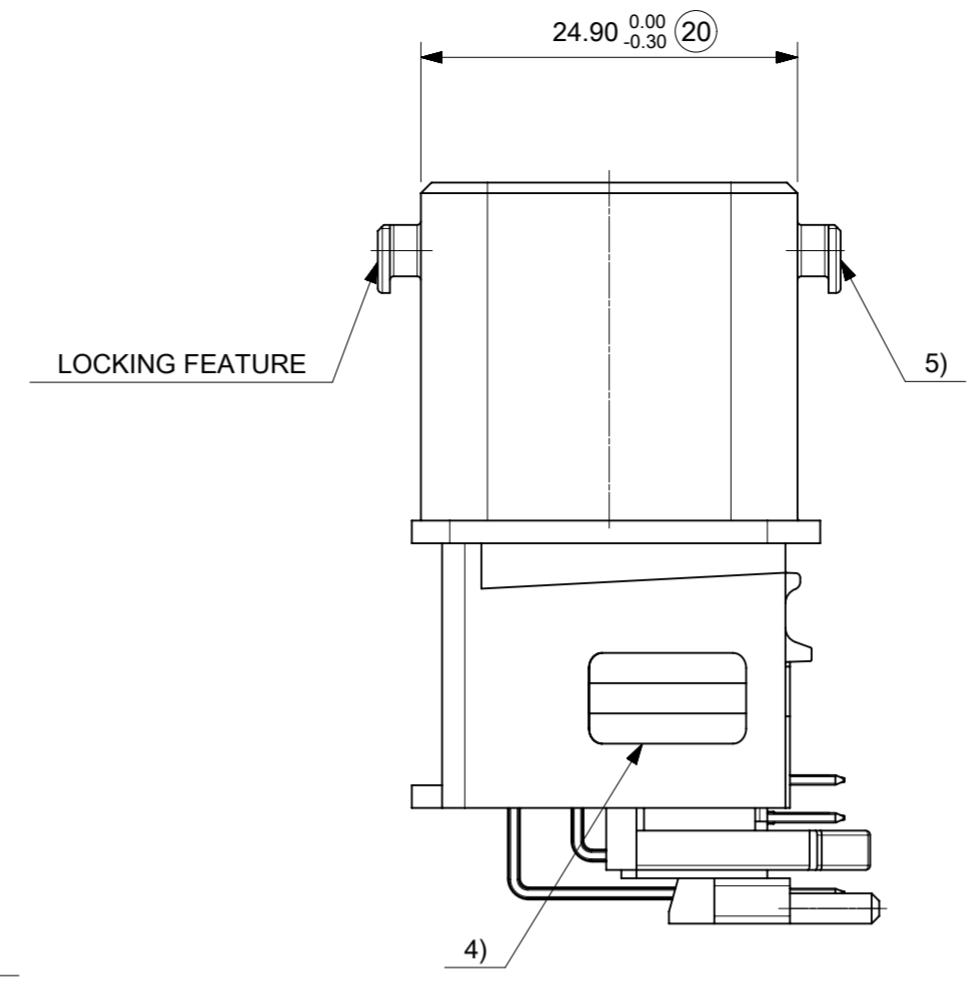
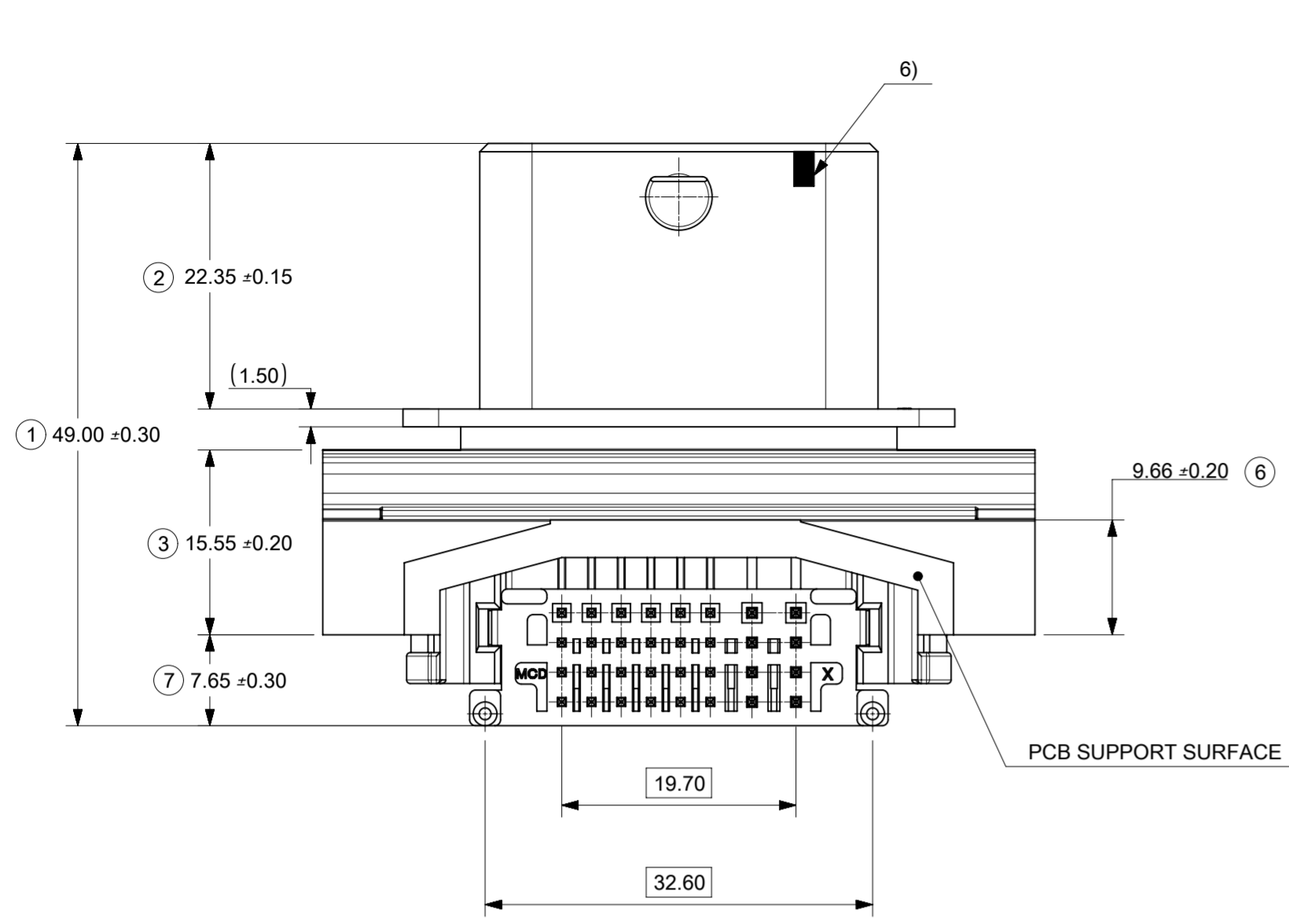

RECOMMENDED PCB LAYOUT (COMPONENT SIDE)
THICKNESS: 1.6±0.1mm

NOTES:

1. THE VIEW "RECOMMENDED PCB LAYOUT" SHOWS THE SECTION OF THE HOLE POSITION CONCERNING THE HEADER-PIN, GUIDING AND LOCKING LAYOUT.
2. THIS VIEW OF THE HOLE PATTERN DOESN'T POINT TO THE ABSOLUTE POSITION ON THE PCB.
3. THE HOLE PATTERN IS COPY OF THE HEADER LAYOUT.
4. PLEASE COMBINE THE TWO ELEMENTS (HEADER AND VIEW OF THE HOLE PATTERN) TO CREATE PCB LAYOUT.

D	629431	1. UPDATED VIEWS FROM PAP PRE-LOCK TO FINAL-LOCK 2. UPDATED DIM 12 FROM 4.65 TO 6.80 DUE TO GUIDE PLATE RELOCATION 3. CHANGED LETTERS FROM LOWER CASE TO CAPITAL 4. REMOVED BALLOON NUMBER FOR BASIC DIMENSIONS 5. ADDED INSPECTION BALLOON NUMBER LOG 6. UPDATED NOTES 6 FROM WHITE INK TO THERMAL RIBBON
C	619506	1) REMOVE PAGES OF INTERFACE DRAWING SD-98644-006 2) REMOVE QA COUNT FROM TITLE BLOCK 3) REMOVE GERMAN TEXT ON PAGES SHEET 1 4) UPDATE "NOTES" SEE REVISION SYMBOL C FOR DETAIL 5) ADD BLUE CODING "TOOLED PART LIST" TABLE SHEET 2 6) ADD REVISION LOG
B1	GCA2011-0026	UPDATE TEST SPEC OF SOLDERABILITY
B	GCA2011-0001	UPDATE NEW REVISION INTERFACE DRAWING
A1	GCA2009-0059	1) ADD DIM 6, 7, 8 2) CORRECT HEADER WEIGHT 3) ADD PCB LAYOUT AND NOTES
A	610245	VOIDED BY ECTR MIGRATION TEAM DUE TO SHEET NUMBER CHANGED
4	GCA2009-0033	ADD NOTES 7: MATES WITH CMC CONNECTOR 32CKT
3	G2009-0257	1) CHANGE WRITTEN FAILURE OF PS: OLD: PS-64319-002 NEW: PS-64319-001 2) ADD AND ADDITIONA PAGE CHANGE FRAME SIZE OF PAGE 1, 2, 3, 4 AND 5 FROM DIN A1 INTO DIN A2 3) CHANGE TITLE: OLD: CMC HEADER ASSY 32CKT./HARNESS DIRECTION RIGHT NEW: CMC HEADER 32CKT./ASSEMBLED/ SOLDER VERSION
2	G2009-0220	CHANGE MATERIAL DESCRIPTION ON PART
1	G2009-0081	INITIAL RELEASE
REVISION	EC#	DESCRIPTIONS

MODIFICATION LOG

THIS DRAWING CONTAINS INFORMATION THAT IS PROPRIETARY TO MOLEX ELECTRONIC TECHNOLOGIES, LLC AND SHOULD NOT BE USED WITHOUT WRITTEN PERMISSION

DIMENSION UNITS	SCALE	CURRENT REV DESC: REFER TO REVISION CHANGE LOG FOR DETAILS IN G-2 OF SHEET 1
mm	2:1	
		EC NO: 629431
		DRWN: HKANG03 2019/12/02
		CHK'D: HWBAI 2020/02/12
		APPR: SLAFAURE 2020/02/18
		INITIAL REVISION:
		DRWN: TLUO 2009/04/15
		APPR: GGLEE 2009/05/11
DRAFT WHERE APPLICABLE MUST REMAIN WITHIN DIMENSIONS	THIRD ANGLE PROJECTION	DRAWING
		A2-SIZE
		SERIES
		64334
		MATERIAL NUMBER
		SEE TABLE
		CUSTOMER
		GENERAL MARKET
		SHEET NUMBER
		2 OF 2



CMC HEADER 32CKT
ASSEMBLED SOLDER VERSION

PRODUCT CUSTOMER DRAWING

DOCUMENT NUMBER	DOC TYPE	DOC PART	REVISION
SD-64334-100	PSD	005	D



产品编号 : [643340100](#)

Product Description : 2.50mm, 3.70mm CMC Header, Right-Angle, 32 Circuits, 1 Port, Black

系列号 : 64334

状态 : Active

Product Category : PCB Headers and Receptacles

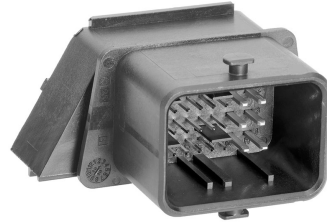

文件和资源

图纸

[图纸 643340100_sd.pdf](#)

3D 模型和设计文件

[3D模型 643340100_stp.zip](#)

规格

[应用规格 AS-64334-001-001.pdf](#)

产物环境合规

合规

GADSL/IMDS	Compliant with Exemption 44; 33
China RoHS	
EU ELV	Compliant per 2000/53/EC
Low-Halogen Status	Not Low-Halogen per IEC 61249-2-21
REACH SVHC	Not Contained per D(2023)3788-DC (14 Jun 2023)
EU RoHS	Compliant per EU 2015/863

多部分产品合规性声明

- Eu RoHS
- REACH SVHC
- Low-Halogen

多部分行业合规性文件

- IPC 1752A Class C
- IPC 1752A Class D

- Molex Product Compliance Declaration

- IEC-62474

- chemSHERPA (xml)

欧盟 RoHS 合格证书

产品详情

常规

状态	活动
类别	PCB Headers and Receptacles
系列	64334
说明	2.50mm, 3.70mm CMC Header, Right-Angle, 32 Circuits, 1 Port, Black
应用	Automotive, Board-to-Board, Wire-to-Board
个评论	Coding: Black
元件类型	PCB Header
产品系列	CMC and CMX Sealed, Hybrid, Modular Connectors
产品名称	CMC
UPC	883906844431

电气

每触点最大电流	12.0A, 2.5A
电压 - 最大	14V DC

物理

断开	否
电路详图	8 x 1.5mm & 24 x 0.635mm terminals
回路数 (已载入)	32
电路数 (最多)	32
颜色-树脂	黑色
耐用性(插拔次数) - 最多次数	20
先接后断	否
符合灼热丝规范	否
可配插产品指南	是

插接极性	是
锁定插接部位	是
材料 - 接合部位电镀	Tin
材料 - 树脂	Nylon Alloy
净重	29.700/g
行数	4
方向	Right Angle
包装形式	Tray
间距 - 插配接口	2.50mm, 3.70mm
有极性的插配件	是
PCB 极性	是
运行温度范围	-40° to +105° C
终端界面类型	Solder or Weld

进程

最长持续时间	25
无铅	WAVE
最大周期	1
最高温度	260

可配插/可连接使用的产品

可配插部件

描述	产品编号
.635mm, 1.50mm, CMC Receptacle, 32 Circuits, Right Wire Output, Black Coding, Mat Sealed	<u>0643193211</u>