



产品编号 : 788641001

系列号 : 78864

Product Category : PCB Headers and Receptacles

Product Description : 1.60mm Pitch Compression Connector, 1.20mm Working Height, Dual Row, 6 Circuits

状态 : Active

---

## 文件和资源

### 图纸

图纸 788641001\_sd.pdf

包装设计图 PK-78864-001-001.pdf

### 3D 模型和设计文件

3D模型 788641001\_stp.zip

### 规格

产品规格 PS-78864-001-001.pdf

---

## 产物环境合规

### 合规

GADSL/IMDS	Not Relevant
China RoHS	
EU ELV	Not Relevant
Low-Halogen Status	Low-Halogen per IEC 61249-2-21
REACH SVHC	Not Contained per D(2023)8585-DC (23 Jan 2024)
EU RoHS	Compliant per EU 2015/863

### 多部分产品合规性声明

- Eu RoHS
- REACH SVHC
- Low-Halogen
  
- IPC 1752A Class C
- IPC 1752A Class D
- Molex Product Compliance Declaration
- IEC-62474
- chemSHERPA (xml)

## 产品详情

### 常规

状态	活动
类别	PCB Headers and Receptacles
系列	78864
说明	1.60mm Pitch Compression Connector, 1.20mm Working Height, Dual Row, 6 Circuits
应用	Board-to-Board, Signal
元件类型	PCB Header
产品系列	Compression Connectors
产品名称	Battery Connector, Compression Connector
UPC	887191496115

### 电气

每触点最大电流	1.0A
电压 - 最大	10V

### 物理

断开	否
回路数 (已载入)	6
电路数 (最多)	6
颜色-树脂	黑色
耐用性(插拔次数) - 最多次数	30
符合灼热丝规范	否
锁定插接部位	无
材料 - 金属	Copper Alloy
材料 - 接合部位电镀	金牌
材料 - 终端电镀	Matte Tin
材料 - 树脂	Liquid Crystal Polymer
净重	0.038/g
行数	2
方向	垂直

包装形式	Embossed Tape on Reel
间距 - 插配接口	1.60mm
最薄镀层 - 接合部位	0.102 $\mu$ m
运行温度范围	-40° to +85° C
终端界面类型	Surface Mount

## 进程

最长持续时间	10
无铅	REFLOW
最大周期	2
最高温度	245

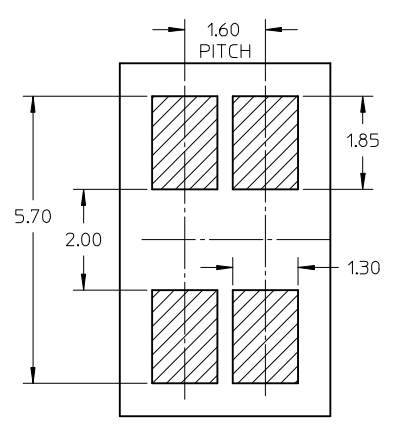
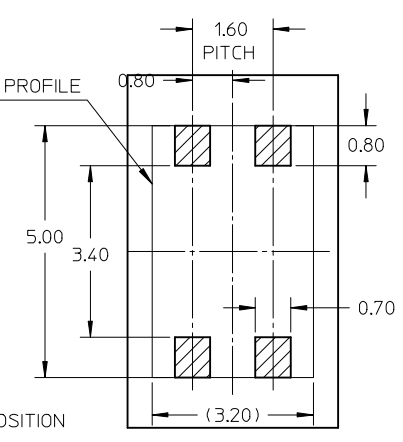
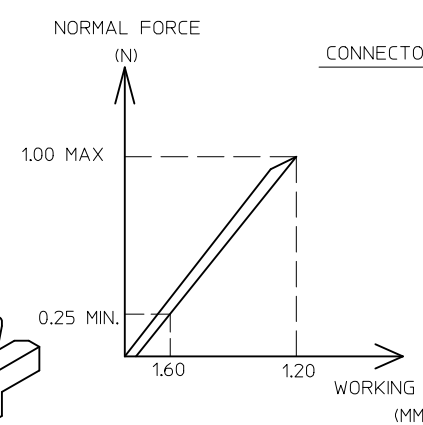
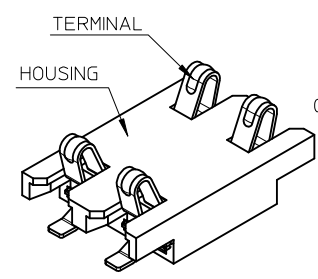
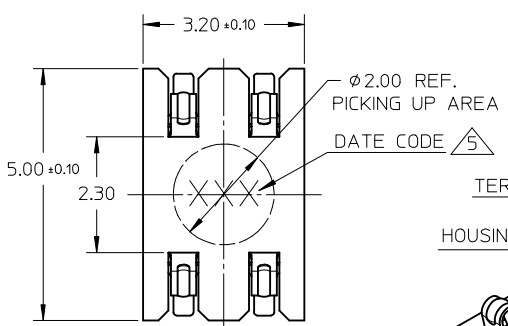

RECOMMENDED PCB LAYOUT  
RECOMMENDED TOLERANCE: ±0.02MM

RECOMMENDED MATING PAD LAYOUT  
RECOMMENDED TOLERANCE: ±0.02MM

- NOTES:
- MATERIALS:  
HOUSING: LIQUID CRYSTAL POLYMER, GLASS FILLED, COLOUR: BLACK;  
TERMINAL: COPPER ALLOY;
  - FINISH:  
1.27 MICROMETER MIN. NICKEL UNDERPLATING OVERALL,  
0.10 MICROMETER MIN. GOLD PLATING ON CONTACT AREA,  
1.27 MICROMETER MIN. MATTE TIN PLATING ON SOLDERING AREA;
  - RECOMMENDED MATING PAD FINISH:  
1.27 MICROMETER MIN. NICKEL UNDERPLATING AND 0.38 MICROMETER MIN. GOLD PLATING OVERALL;
  - PRODUCT SPECIFICATION: PLEASE REFER TO PS-78864-001;
  - DATE CODE PRINTED: XXX .  
DAY OF THE YEAR

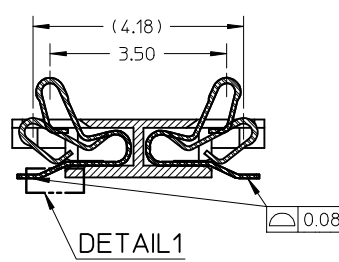
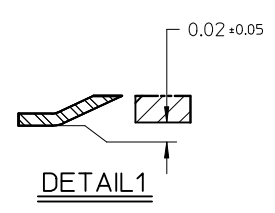
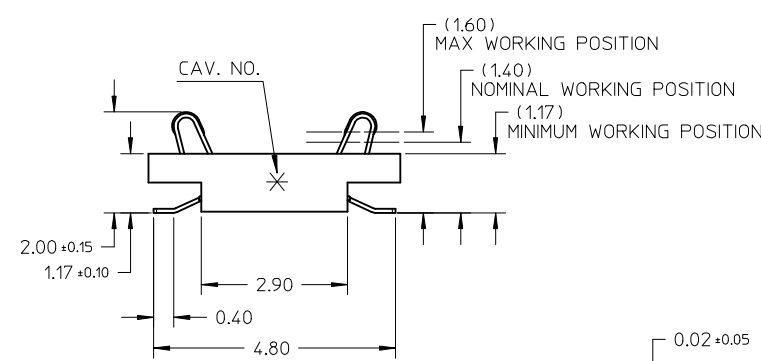
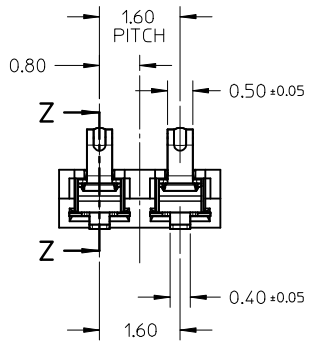

SECTION Z-Z

THIS DESIGN IS BASED ON DESIGN OBJECTIVES AND IS STRICTLY TENTATIVE. IT MAY CHANGE BASED ON RESULTS OF ADDITIONAL DESIGN REVIEWS & VERIFICATIONS.

PART NUMBER	POS. NO.
788640001	4

DRAWING RELEASE EC NO: S2015-1399 DRW:HTGU002 CHKD:JZENG APPR:KHLIM	QUALITY SYMBOLS FA=0 FC=0 FP=0	GENERAL TOLERANCES (UNLESS SPECIFIED)		DIMENSION STYLE MM ONLY		SCALE NTS	DESIGN UNITS METRIC	THIRD ANGLE PROJECTION			
		mm	INCH	DRAWN BY HLWANG06	DATE 2013/07/13	TITLE SALES DRAWING FOR BATTERY 1.2H 1.6MM PITCH DOUBLE ROW CONNECTOR					
		4 PLACES	± ---	± ---	CHECKED BY JTAN02	DATE 2013/08/26					
		3 PLACES	± ---	± ---	APPROVED BY KHLIM	DATE 2013/08/28					
ANGULAR ± 3 °		DRAFT WHERE APPLICABLE MUST REMAIN WITHIN DIMENSIONS		MATERIAL NO. SEE TABLE		DOCUMENT NO. SD-78864-001		SHEET NO. 1 OF 2			
THIS DRAWING CONTAINS INFORMATION THAT IS PROPRIETARY TO MOLEX INCORPORATED AND SHOULD NOT BE USED WITHOUT WRITTEN PERMISSION											

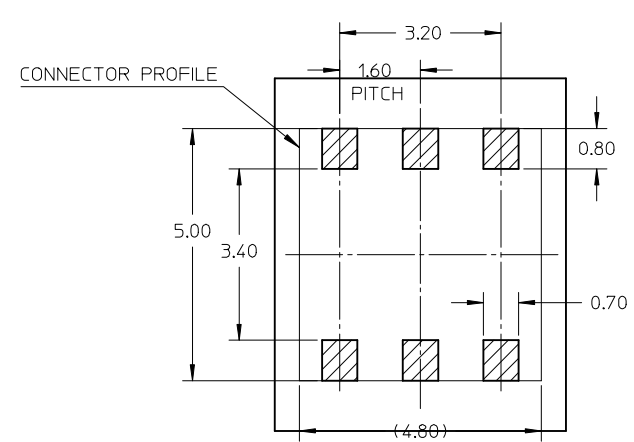
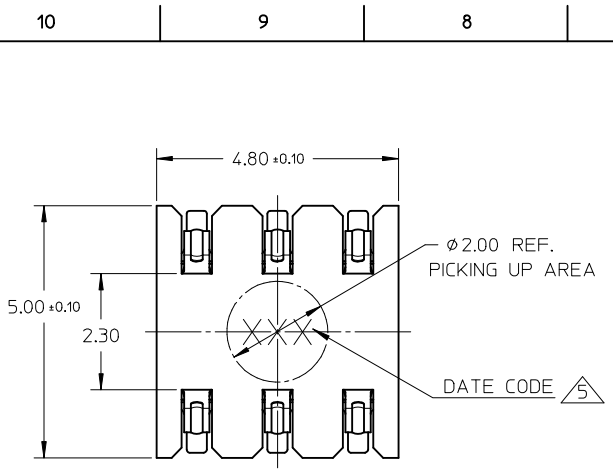

RECOMMENDED PCB LAYOUT  
RECOMMENDED TOLERANCE: ±0.02MM

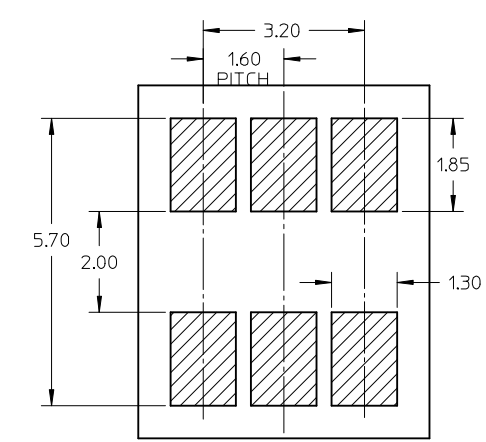

RECOMMENDED MATING PAD LAYOUT  
RECOMMENDED TOLERANCE: ±0.02MM

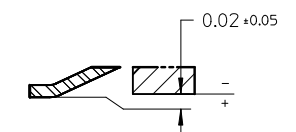
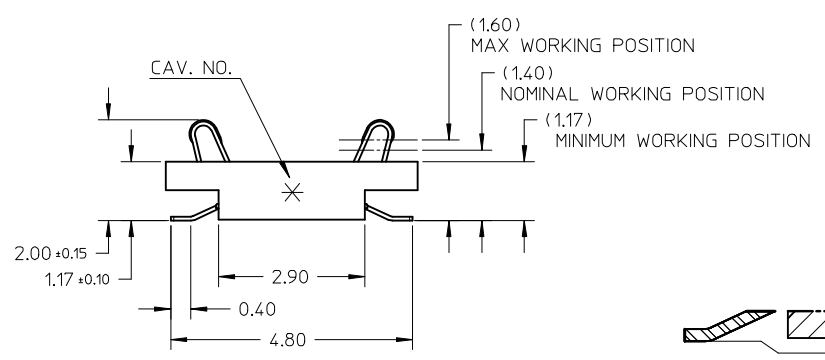
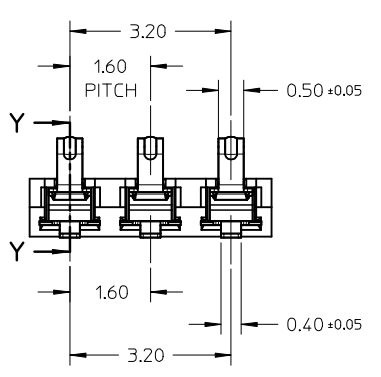

DETAIL3

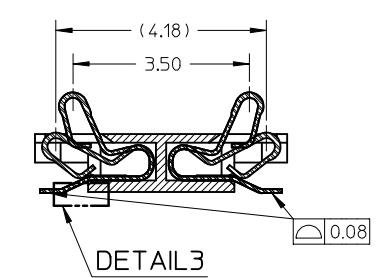

SECTION Y-Y

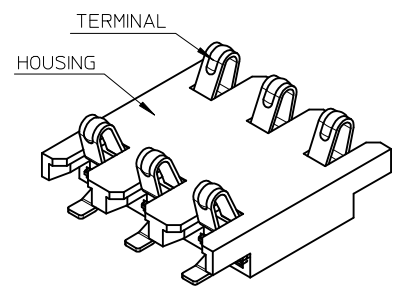

DRAWING RELEASE  
EC NO: S2015-1399  
DRW:HTGU002  
CHKD:JZENG  
APPR:KHLIM

REV	DESCRIPTION
1	2015/05/29
2	2015/06/17
3	2015/06/18

QUALITY SYMBOLS	GENERAL TOLERANCES (UNLESS SPECIFIED)	
	mm	INCH
$F_A=0$	4 PLACES ± ---	± ---
$F_C=0$	3 PLACES ± ---	± ---
$F_D=0$	2 PLACES ± 0.20	± ---
$F_E=0$	1 PLACE ± ---	± ---
$F_F=0$	0 PLACE ± ---	± ---

ANGULAR ± 3 °  
DRAFT WHERE APPLICABLE  
MUST REMAIN WITHIN DIMENSIONS

DIMENSION STYLE		SCALE	DESIGN UNITS	THIRD ANGLE PROJECTION
MM ONLY		NTS	METRIC	
DRAWN BY	DATE	TITLE		
HLWANG06	2013/07/13	SALES DRAWING FOR BATTERY 1.2H 1.6MM PITCH DOUBLE ROW CONNECTOR		
CHECKED BY	DATE	<b>molex</b>		
JTAN02	2013/08/26			
APPROVED BY	DATE	DOCUMENT NO.	SHEET NO.	
KHLIM	2013/08/28	SD-78864-001	2 OF 2	
MATERIAL NO.	SEE TABLE			

THIS DRAWING CONTAINS INFORMATION THAT IS PROPRIETARY TO MOLEX INCORPORATED AND SHOULD NOT BE USED WITHOUT WRITTEN PERMISSION

PART NUMBER	POS. NO.
788641001	6