

勝特力電材超市-龍山店 886-3-5773766  
 勝特力電材超市-光復店 886-3-5729570  
 勝特力电子(上海) 86-21-34970699  
 勝特力电子(深圳) 86-755-83298787  
<http://www.100y.com.tw>

| REVISIONS |        |                            |           |        |       |
|-----------|--------|----------------------------|-----------|--------|-------|
| REV       | ECO    | DESCRIPTION                | DATE      | BY     | APPR  |
| A3        | -      | RELEASE NEW DWG FORMAT     | 30/JUL/13 | DRP    | -     |
| A4        | -      | CONTACT INFORMATION UPDATE | 16/JAN/14 | DRP    | -     |
| A5        | C1070S | UPDATE DRAWING             | 02/JUL/19 | JOE    | TOMMY |
| B1        | C1298S | UPDATE PLATING             | 14/SEP/20 | SULLEN | TOMMY |

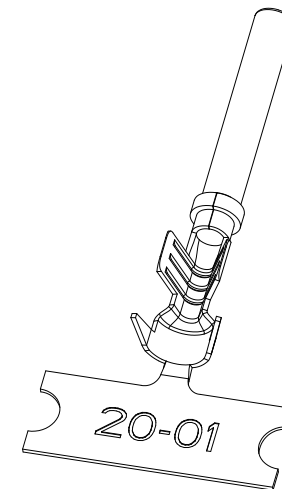
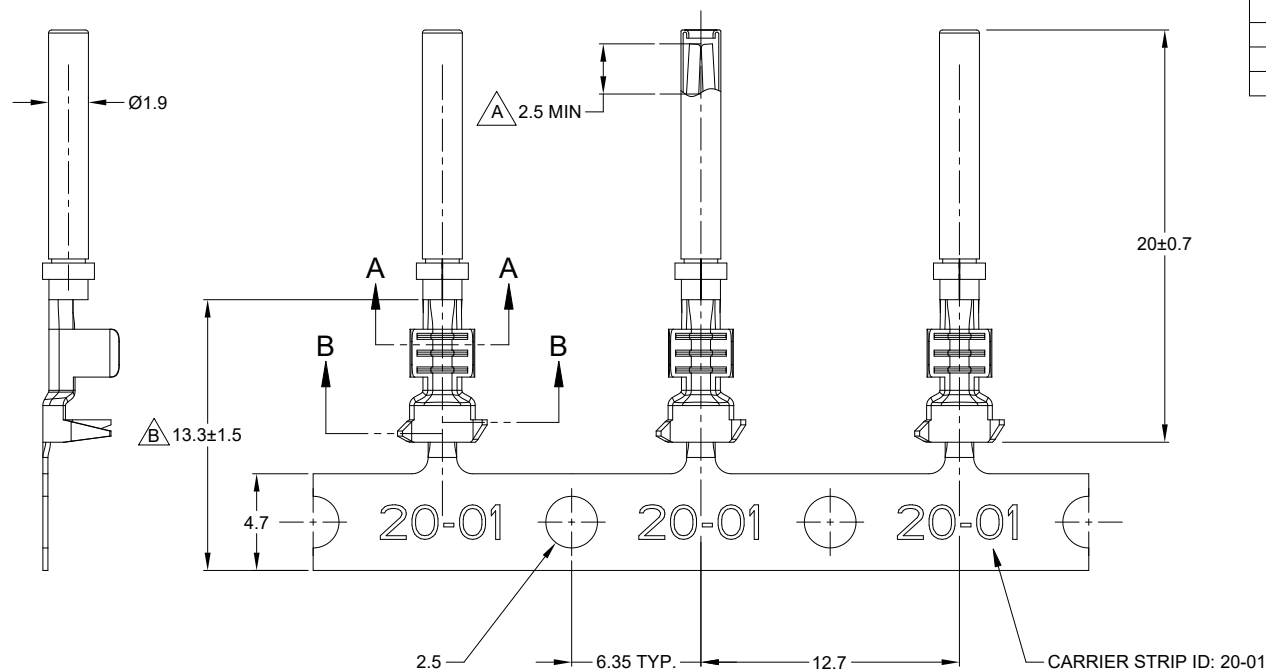

NOTES: UNLESS OTHERWISE SPECIFIED

- MATERIAL: COPPER ALLOY
- PLATING: SEE PART NUMBER CHART
- CONTACT SIZE: 20
- SPECIFICATIONS:
  - CURRENT RATING: 7.5 AMPS
  - CONTACT MILLIVOLT DROP: 100 MILLIVOLT DROP @ 7.5 AMP TEST CURRENT.
  - RoHS COMPLIANT
- RECOMMENDED WIRE RANGE: 16 - 22 AWG (1.5 - 0.35MM<sup>2</sup>)  
 RECOMMENDED INSUL O.D: 1.91 - 3.15MM (0.075 - 0.125INCH)
- PACKAGE: 4000 PCS/REEL
- AVAILABLE APPLICATORS: MFX-3974-K OR MFX-3974-G
- ALL DIMENSIONS ARE FOR REFERENCE USE ONLY

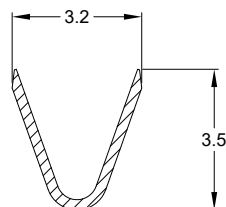

SECTION A-A

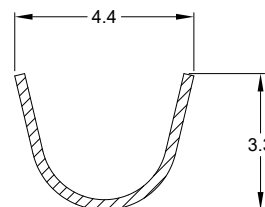

SECTION B-B

| PART NUMBER CHART |              |                                                                             |
|-------------------|--------------|-----------------------------------------------------------------------------|
| PLATING           | PART NUMBER  | PLATING DESCRIPTION                                                         |
| NICKEL            | AT62-20-0122 | SELECTIVE TIN OVER NICKEL OVERALL IN $\Delta$ ZONE                          |
| GOLD              | AT62-20-0144 | SELECTIVE GOLD FLASH OVER NICKEL OVERALL IN $\Delta$ ZONE OR ENTIRE CONTACT |
| TIN               | AT62-20-0177 | TIN OVER NICKEL OVERALL                                                     |

| SEE PART NUMBER CHART                                                                                                                                                                                                      |             | REF: 1062-20-0122, 1062-20-0144, 1062-20-0177                                                                                                                                                                                                                        |  | ITEM         |
|----------------------------------------------------------------------------------------------------------------------------------------------------------------------------------------------------------------------------|-------------|----------------------------------------------------------------------------------------------------------------------------------------------------------------------------------------------------------------------------------------------------------------------|--|--------------|
| QUANTITY                                                                                                                                                                                                                   | PART NUMBER | DESCRIPTION                                                                                                                                                                                                                                                          |  |              |
| <b>MATERIALS LIST</b>                                                                                                                                                                                                      |             |                                                                                                                                                                                                                                                                      |  |              |
| UNLESS OTHERWISE SPECIFIED<br>1) All dimensions are in metric(mm).<br>2) Tolerances are as follows:<br>1 PL DEC ±0.30<br>2 PL DEC ±0.15<br>3 PL DEC ±0.08<br>Fractions ±1/64<br>Angles ±1°<br>3) Note reference = $\Delta$ |             | SIGNATURES                                                                                                                                                                                                                                                           |  | DATE         |
| DRAWN: SULENZHANG                                                                                                                                                                                                          |             | 14/SEP/20                                                                                                                                                                                                                                                            |  |              |
| CHECKED: ORONLI                                                                                                                                                                                                            |             | 15/SEP/20                                                                                                                                                                                                                                                            |  |              |
| ENGINEER:                                                                                                                                                                                                                  |             |                                                                                                                                                                                                                                                                      |  |              |
| APPROVAL: TOMMY.XIE                                                                                                                                                                                                        |             | 18/SEP/20                                                                                                                                                                                                                                                            |  |              |
| MATERIAL SPECIFICATIONS:                                                                                                                                                                                                   |             | CUSTOMER:                                                                                                                                                                                                                                                            |  |              |
| PROCESS SPECIFICATIONS:                                                                                                                                                                                                    |             | THIS DRAWING IS SUPPLIED FOR INFORMATION ONLY. DESIGN FEATURES, SPECIFICATIONS AND PERFORMANCE DATA SHOWN HEREON ARE THE PROPERTY OF THE AMPHENOL CORPORATION. NO RIGHTS OF REPRODUCTION ARE IMPLIED. ALL DIMENSIONS ARE SUBJECT TO NORMAL MANUFACTURING VARIATIONS. |  |              |
| NEXT ASSY:                                                                                                                                                                                                                 |             | SCALE: NONE                                                                                                                                                                                                                                                          |  |              |
|                                                                                                                                                                                                                            |             | SIZE: B C-                                                                                                                                                                                                                                                           |  | REVISION: B1 |
|                                                                                                                                                                                                                            |             | DWG NO: AT62-20-01XX                                                                                                                                                                                                                                                 |  | SHEET 1 OF 1 |

TITLE: SOCKET, STAMPED, SIZE 20, 16-22 AWG, A SERIES  
 DWG NO: AT62-20-01XX  
 REV: B1  
 SH: 1  
 OF: 1