

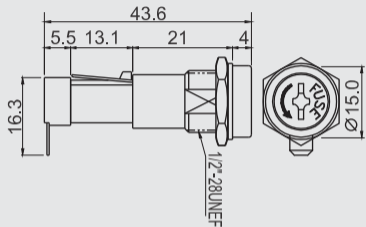

R3-9

 (4.8mm)0.187"
Quick connect

 0.5~4.5mm MAX

FEATURES:

- Material:
Frame and cap: PBT(UL flame: 94V-0).
Terminal: tin plated brass.
- Mounted by nut.
- Metal or plastic nut is optional.

A

B

C

C O

CAP

Bayonet type
(tool release)



Bayonet type
(tool release)



Screw type
(tool release)



Screw type
(tool release)



FUSE 

∅ 6.35*30mm

∅ 6.35*31.8mm

∅ 5.0*20mm

∅ 6.35*30mm

∅ 6.35*31.8mm

∅ 6.35*30mm

∅ 6.35*31.8mm

RATING

15A 250V
AC

10A 250V
AC

15A 250V
AC

15A 250V
AC



CUT-OUT

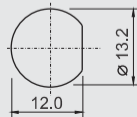

勝特力材料 886-3-5773766
勝特力电子(上海) 86-21-34970699
勝特力电子(深圳) 86-755-83298787
[Http://www.100y.com.tw](http://www.100y.com.tw)