



MSR Gold™ SA/DE

勝特力材料 886-3-5753170  
 勝特力电子(上海) 86-21-54151736  
 勝特力电子(深圳) 86-755-83298787  
[Http://www.100y.com.tw](http://www.100y.com.tw)

**Features**

1. Philips Pinch Protection.
2. MSR filling.
3. Gold plated lamp caps.

**Benefits**

1. Enables use at higher temperatures in any burning position. Longer lifetime, fewer early failures, consistent performance over time.
2. Pure, white light; color point close to black body line. Consistent color impression over MSR Range.
3. Reduces early lamp or lamp holder failures.

**Application**

- Entertainment, TV/Studio

Type	Lamp wattage	Cap/ base	Arc size mm	Minimum ignition supply voltage	Lumen output	Efficacy source lm/W	Colour temp.
MSR Gold 1200 SA/DE	1200W	SFC 10-4	7	207V	110000 lm	90	6000 K
MSR Gold 1200 SA/2 DE	1200W	SFC 10-4	7	207V	103000 lm	86	7500 K
MSR Gold 700 SA/2 DE	700W	SFC 10-4	4	207V	56000 lm	80	7500 K
MSR Gold 575 SA/2 DE	575W	SFC 11	5	207V	42000 lm	75	7500 K
MSR Gold 400 SA/2 DE	400W	SFC 10-4	3	207V	27000 lm	70	7500 K

Type	Max. perm. pinch temp °C	CRI	Average life h	Replacement before hrs	Burning position	Lamp current A	Ordering number
MSR 1200 SA/DE	500	85	750	1000	any	13,6	9280 996 05100
MSR 1200 SA/2 DE	500	80	750	1000	any	13,6	9281 753 05100
MSR 700 SA/2 DE	500	75	750	1000	any	10,2	9281 747 05100
MSR 575 SA/2 DE	450	75	500	600	any	7,1	9281 751 05100
MSR 400 SA/2 DE	500	70	750	1000	any	8,4	9281 736 05100

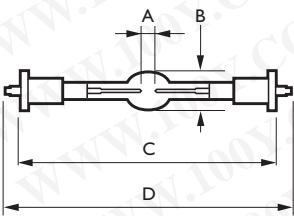

Type	A max	B max	C max	D max
MSR 1200 SA/DE	7.0	21	115	135
MSR 1200 SA/2 DE	7.0	21	115	135
MSR 700 SA/DE	4.0	18	115	135
MSR 575 SA/DE	5.0	18	70	92
MSR 400 SA/DE	3.0	18	115	135

Dimensions in mm



**Philips pinch protection technology**

- **Reliability**, through longer lifetime and fewer early failures.
- **Quality**, through excellent storage characteristics and consistent performance over time.
- **Compactness**, allowing more compact design of fixtures and burning positions.
- **Philips P3 technology**, Max 500° C pinch temperature
- **No pinch protection**, Max 350° C pinch temperature

**Dealer stamp**