



4 ~ 6W AC-DC Single Output Wall-mounted type

GS06E series



Features :

- Universal AC input / Full range
- No load power consumption <0.5W
- Meet energy star level IV(CEC) for 5 ~ 48V
- Meet EISA 2007 (Energy Independence and Security Act) for 5 ~ 48V
- 2 pole EURO plug
- Class II power (without earth pin)
- Full output 3~48V safety approval
- Protections: Short circuit / Overload / Over voltage
- Pass LPS
- Fully enclosed plastic case
- Approvals: TUV / CB / FCC / CE
- 2 years warranty



SPECIFICATION

| ORDER NO. | | GS06E-0P1J | GS06E-1P1J | GS06E-11P1J | GS06E-2P1J | GS06E-3P1J | GS06E-4P1J | GS06E-5P1J | GS06E-6P1J | GS06E-8P1J | |
|-------------------------------------|---|--|------------|--------------|------------|------------|------------|------------|------------|------------|--|
| OUTPUT | SAFETY MODEL NO. | GPSU06-0-E | GPSU06-1-E | GPSU06-1-1-E | GPSU06-2-E | GPSU06-3-E | GPSU06-4-E | GPSU06-5-E | GPSU06-6-E | GPSU06-8-E | |
| | DC VOLTAGE Note.2 | 3.3V | 5V | 7.5V | 9V | 12V | 15V | 18V | 24V | 48V | |
| | RATED CURRENT | 1.21A | 1.00A | 0.8A | 0.66A | 0.5A | 0.4A | 0.33A | 0.25A | 0.125A | |
| | CURRENT RANGE | 0 ~ 1.21A | 0 ~ 1.00A | 0 ~ 0.8A | 0 ~ 0.66A | 0 ~ 0.5A | 0 ~ 0.4A | 0 ~ 0.33A | 0 ~ 0.25A | 0 ~ 0.125A | |
| | RATED POWER | 4W | 5W | 6W | 6W | 6W | 6W | 6W | 6W | 6W | |
| | RIPPLE & NOISE (max.) Note.3 | 50mVp-p | 50mVp-p | 80mVp-p | 80mVp-p | 100mVp-p | 120mVp-p | 150mVp-p | 180mVp-p | 200mVp-p | |
| | VOLTAGE ADJ. RANGE | 3 ~ 5V | 5 ~ 6V | 6 ~ 8V | 8 ~ 11V | 11 ~ 13V | 13 ~ 16V | 16 ~ 21V | 21 ~ 27V | 33 ~ 48V | |
| | | Fixed | | | | | | | | | |
| | VOLTAGE TOLERANCE Note.4 | ±5.0% | ±5.0% | ±5.0% | ±5.0% | ±3.0% | ±3.0% | ±3.0% | ±2.0% | ±2.0% | |
| | LINE REGULATION Note.5 | ±1.0% | ±0.5% | ±0.5% | ±0.5% | ±0.5% | ±0.5% | ±0.5% | ±0.5% | ±0.5% | |
| LOAD REGULATION Note.6 | ±5.0% | ±5.0% | ±5.0% | ±5.0% | ±3.0% | ±3.0% | ±3.0% | ±2.0% | ±2.0% | | |
| SETUP, RISE, HOLD UP TIME | 1000ms, 50ms, 12ms at full load | | | | | | | | | | |
| INPUT | VOLTAGE RANGE | 90 ~ 264VAC 135 ~ 370VDC | | | | | | | | | |
| | FREQUENCY RANGE | 47 ~ 63Hz | | | | | | | | | |
| | EFFICIENCY (Typ.) Note.7 | 55% | 67% | 72% | 74% | 76% | 77% | 78% | 80% | 82% | |
| | AC CURRENT | 0.2A / 100VAC | | | | | | | | | |
| | INRUSH CURRENT (max.) | 50A / 230VAC | | | | | | | | | |
| | LEAKAGE CURRENT(max.) | 0.25mA / 240VAC | | | | | | | | | |
| PROTECTION | OVERLOAD | >105% rated output voltage power for 3.3 ~ 5V ; >110% rated output power for 7.5 ~ 48V Protection type : Hiccup mode, recovers automatically after fault condition is removed | | | | | | | | | |
| | OVER VOLTAGE | >120% rated output power Protection type : Clamp by zener diode | | | | | | | | | |
| ENVIRONMENT | WORKING TEMP. | 0 ~ +40℃ (Refer to output load derating curve) | | | | | | | | | |
| | WORKING HUMIDITY | 20% ~ 90% RH non-condensing | | | | | | | | | |
| | STORAGE TEMP., HUMIDITY | -20 ~ +85℃, 10 ~ 95% RH | | | | | | | | | |
| | TEMP. COEFFICIENT | ±0.03% / °C (0 ~ 50℃) | | | | | | | | | |
| VIBRATION | 10 ~ 500Hz, 2G 10min./1cycle, period for 60min. each along X, Y, Z axes | | | | | | | | | | |
| SAFETY & EMC (Note. 8) | SAFETY STANDARDS | EN60950-1 approved | | | | | | | | | |
| | WITHSTAND VOLTAGE | I/P-O/P:4242VDC | | | | | | | | | |
| | ISOLATION RESISTANCE | I/P-O/P:100M Ohms / 500VDC / 25℃ / 70% RH | | | | | | | | | |
| | EMI CONDUCTION & RADIATION | Compliance to EN55022 class B, FCC Part15 class B | | | | | | | | | |
| | HARMONIC CURRENT | Compliance to EN61000-3-2,3 | | | | | | | | | |
| | EMS IMMUNITY | Compliance to EN61000-4-2,3,4,5,6,11, light industry level, criteria A | | | | | | | | | |
| OTHERS | MTBF | 500Khrs min. MIL-HDBK-217F(25℃) | | | | | | | | | |
| | DIMENSION | 32*66*42.5mm (L*W*H) | | | | | | | | | |
| | PACKING | 100g ; 90pcs / 10Kg / CARTON | | | | | | | | | |
| CONNECTOR | PLUG | Standard type P1J: 2.1φ * 5.5φ * 11mm, turning fork type center positive for stock ; Other type available by customer requested | | | | | | | | | |
| | CABLE | Standard type 20Awg UL1185 6ft for stock ; Other type available by customer requested | | | | | | | | | |
| NOTE | 1.All parameters are specified at 230VAC input, rated load, 25℃ 70% RH ambient. 2.DC voltage: The output voltage set at point measure by plug terminal & 50% load. 3.Ripple & noise are measured at 20MHz by using a 12" twisted pair terminated with a 0.1uf & 47uf capacitor. 4.Tolerance: includes set up tolerance, line regulation, load regulation. 5.Line regulation is measured from low line to high line at rated load. 6.Load regulation is measured from 0% to 100% rated load 7.Efficiency is measured at 230VAC. 8.The power supply is considered a component which will be installed into a final equipment. The final equipment must be re-confirmed that it still meets EMC directives. | | | | | | | | | | |

勝特力材料 886-3-5753170
勝特力电子(上海) 86-21-3497069
勝特力电子(深圳) 86-755-832987
[Http://www.100y.com.tw](http://www.100y.com.tw)

勝特力材料 886-3-5753170
勝特力电子(上海) 86-21-34970699
勝特力电子(深圳) 86-755-83298787
[Http://www.100y.com.tw](http://www.100y.com.tw)

Mechanical Specification

Unit:mm

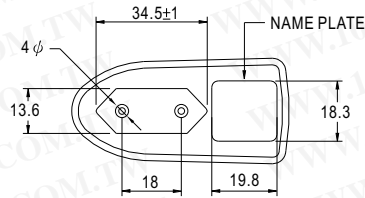

Plug Assignment

Standard plug: P1J (option)

| P1J | |
|--------|--------|
| P/N | OUTPUT |
| CENTER | + |

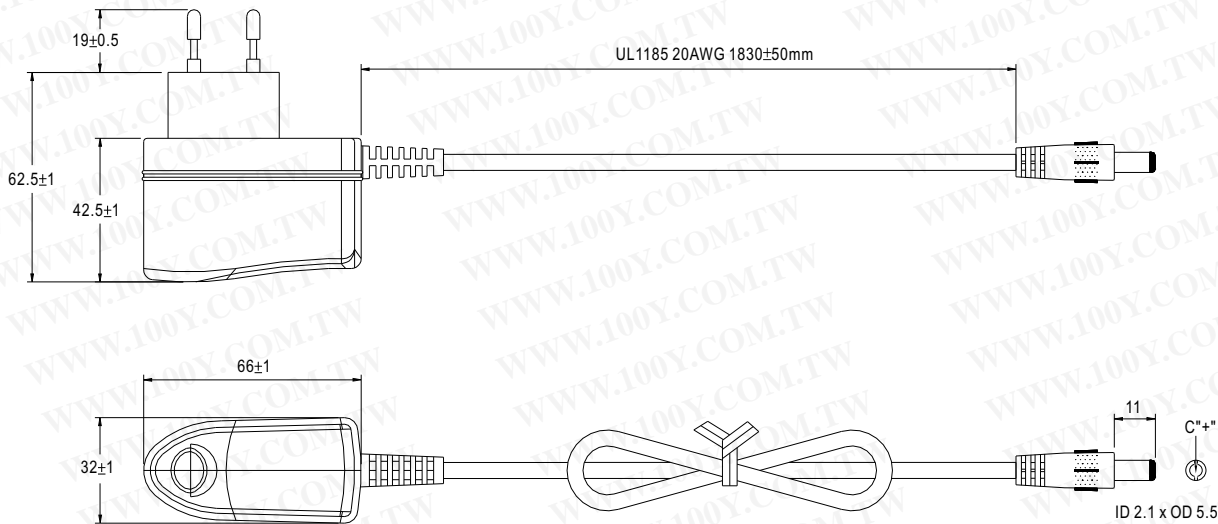

Derating Curve

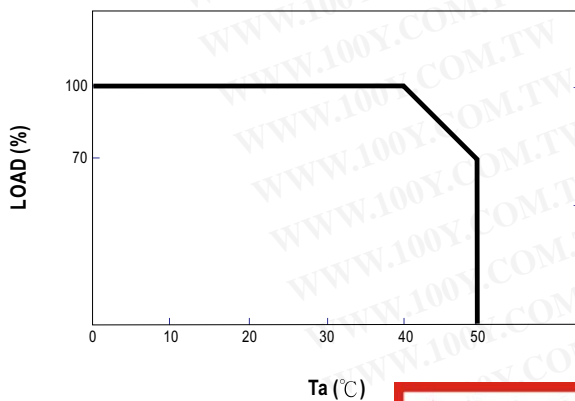

Static Characteristics

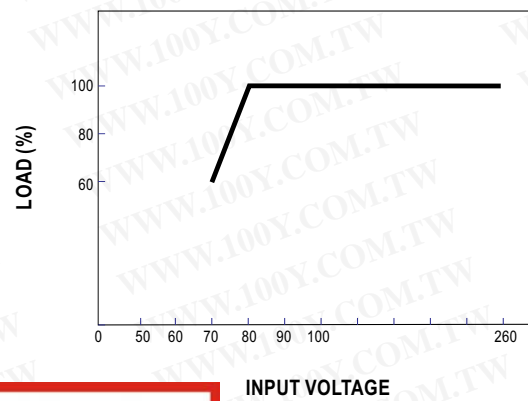

勝特力材料 886-3-5753170
 勝特力电子(上海) 86-21-34970699
 勝特力电子(深圳) 86-755-83298787
[Http://www.100y.com.tw](http://www.100y.com.tw)