

High Insulation Axial-Lead Type 高絕緣兩端引線類型

OKITA

1~4a · Mercury Relay 1~4a · 水銀繼電器

勝特力材料 886-3-5753170
 勝特力电子(上海) 86-21-54151736
 勝特力电子(深圳) 86-755-83298787
[Http://www.100y.com.tw](http://www.100y.com.tw)

Part Number / Feature 品名 / 特長

● MRR - * 00 S - * *

- Insulation resistance power specification 絕緣阻抗係數
 - 11: Insulation resistance > 10¹¹ Ω (-11: 絕緣阻抗 > 10¹¹ Ω)
 - 12: Insulation resistance > 10¹² Ω (-12: 絕緣阻抗 > 10¹² Ω)
 - 13: Insulation resistance > 10¹³ Ω (-13: 絕緣阻抗 > 10¹³ Ω)
- However, it removes between coil to shield. 線圈-- 接地除外
- Coax-shield 靜電遮蔽接地
- Coil Voltage 線圈電壓
- Contact Form 接點型式

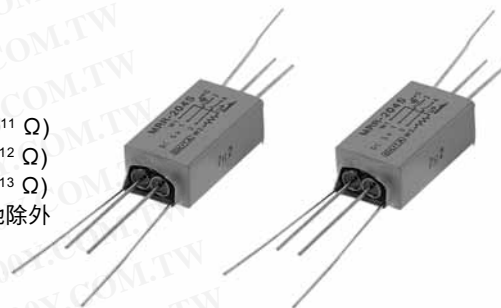

- Since it is a high insulation type mercury relay, it is the most suitable for a low level current circuit where leakage current becomes problem. Because of axial-lead (tubular) type, you can freely choose the method and size of mounting. There are four variations from 1 to 4 make contacts in this series. Since magnetic shield is provide, adjacent mounting is possible. The electrostatic shield-less type is prepared separately.
- 此為高絕緣的水銀繼電器，適用於有洩漏電流問題或用於微小電流電路。因為外觀為兩端出線類型，印刷電路板、空中線路等，其安裝方法及安裝尺寸皆能自由選擇。體積小，1-4a 接點皆有，除此添加磁氣屏蔽，能緊密組裝。另備有無靜電接地機種。

Performance 性能

Specifications 規格	Item 項目	Standard 規格
Contact Specifications 接點規格	Contact Form 接點型式	1a, 2a, 3a, 4a (make mercury)
	Contact Rating 接點額定	50 W
	Max. Switching Voltage 最大切換電壓	DC.500V
	Max. Switching Current 最大切換電流	2 A
	Max. Carry Current 最大通電電流	2 A
	Contact Resistance 接點接觸阻抗	100m Ω MAX.
Electrical Specifications 電氣規格	Breakdown Voltage 耐電壓	Between contacts DC.1000V Contacts to Coil DC.1000V Contacts to shield DC.1000V Coil to shield DC.1000V
	Insulation Resistance 絕緣阻抗	Between all isolated pins 1X10 ¹⁰ Ω MIN. (DC.100V)
	Capacitance 靜電容量	Across Open contacts 0.1pF MAX.(Shield guarding)
	Thermal Electromotive Force 熱起電力	60μV Typ.
	Operate Time 動作時間	(1 Pulse) 3.0mS MAX. (at Nominal Voltage)
	Release Time 釋放時間	(1 Pulse) 2.5mS MAX. (at Nominal Voltage)
Mechanical Specifications 機械規格	Vibration 耐振動	20G (0~55Hz, 1.5mm)
	Shock 耐衝擊	30G (11mS, 1/2 Sin Wave)
Environmental 環境	Operating Temperature 使用周圍溫度	-10°C ~ +60°C
Life Expectancy 壽命	Mechanical 機械的	1X10 ⁹ MIN. Operations
	Electrical 電氣的	DC.10mV-10mA 1X10 ⁹ MIN. Operations (R.L.) Refer 14 page (IV) for Life data

Coil Specifications 線圈規格

Contact Form 接點型式	Part Number 品名	Nominal Voltage DC ± 10%[V] 額定電壓	Coil Resistance ± 10%[Ω] at 20°C 線圈阻抗	Nominal Current [mA] 額定電流	Must-Operate Voltage MAX.[V] at 20°C 啟動電壓
1a	MRR-101S	24	1600	15.0	16.8
	MRR-102S	12	400	30.0	8.4
	MRR-104S	5	100	50.0	3.8
2a	MRR-201S	24	1600	15.0	16.8
	MRR-202S	12	400	30.0	8.4
	MRR-204S	5	100	50.0	3.8
3a	MRR-301S	24	800	30.0	16.8
	MRR-302S	12	200	60.0	8.4
	MRR-304S	5	50	100.0	3.8
4a	MRR-401S	24	800	30.0	16.8
	MRR-402S	12	500	60.0	8.4
	MRR-404S	5	50	100.0	3.8

Dimensions · Terminal Identification (Unit:mm)外型尺寸圖 · 結線圖 (單位:毫米)

MRR-100S (1a)

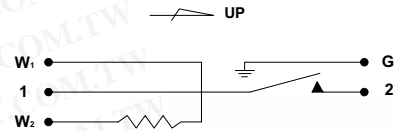
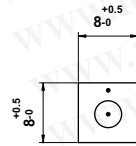
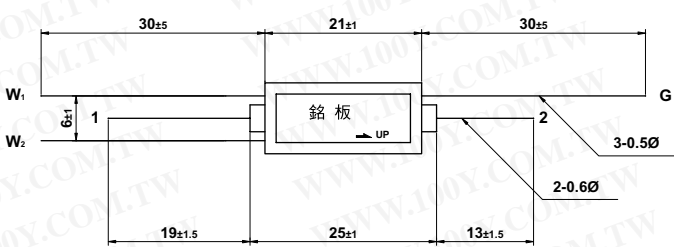

Weight: about 4.1gr

備註：安裝時，UP 表示方向，
並請於垂直 $\square 30$ 範圍內裝置。

MRR-200S (2a)

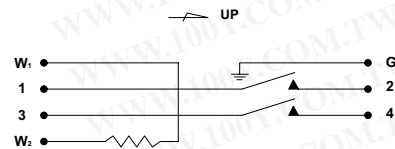
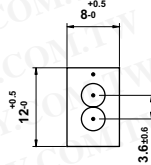
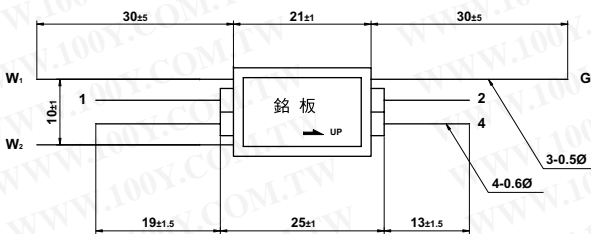

Weight: about 5.6gr

備註：安裝時，UP 表示方向，
並請於垂直 $\square 30$ 範圍內裝置。

MRR-300S (3a)

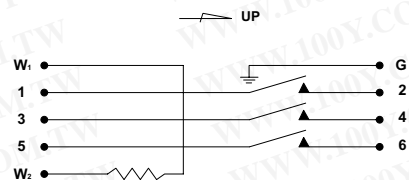
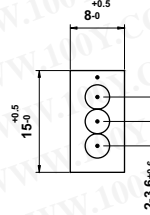
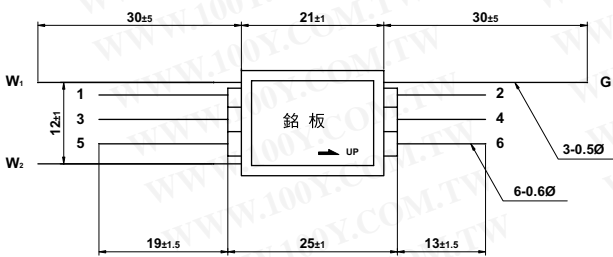

Weight: about 7.3gr

備註：安裝時，UP 表示方向，
並請於垂直 $\square 30$ 範圍內裝置。

MRR-400S (4a)

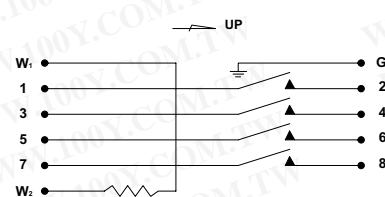
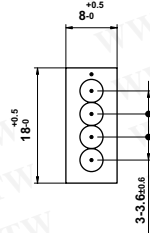
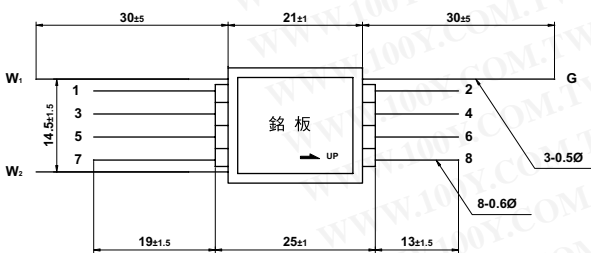

Weight: about 9.7gr

備註：安裝時，UP 表示方向，
並請於垂直 $\square 30$ 範圍內裝置。