

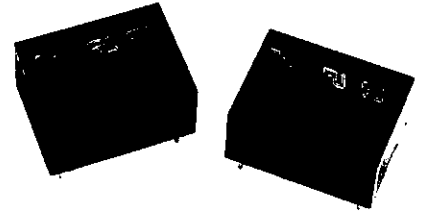

TRV

MAIN FEATURES

- High capacity type (16A) available.
- High sensitivity 0.2W (1 Form A).
- Flat type : LxWxH=16.6mmMax.x22.3mmMax.x11mmMax.
- UL、cUL and TUV recognized.



APPLICATIONS

- Home appliances : Air conditioner, heater, etc.
- Automotive : Power supply for car stereo and air conditioner.

ORDERING INFORMATION

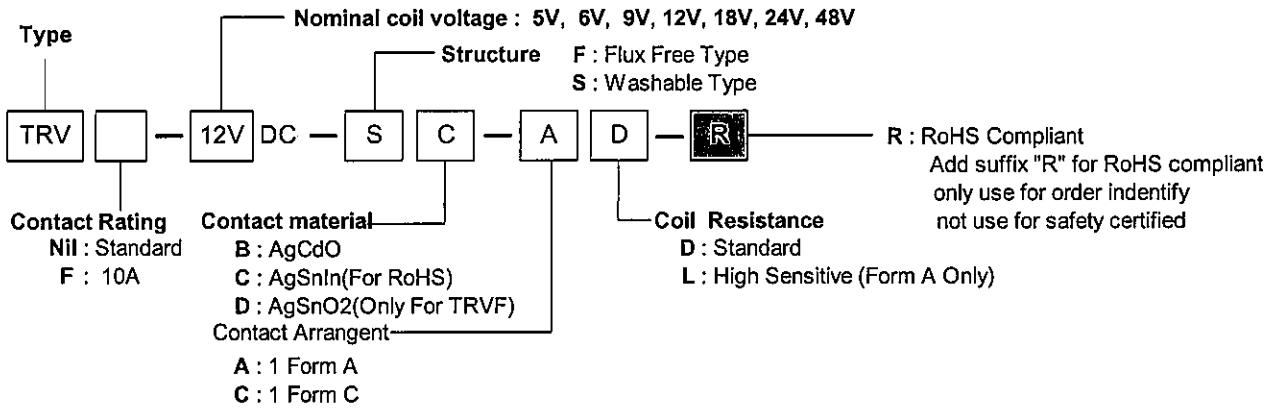

DIMENSION (unit:mm) DRILLING (unit:mm) WIRING DIAGRAM

1 Form A

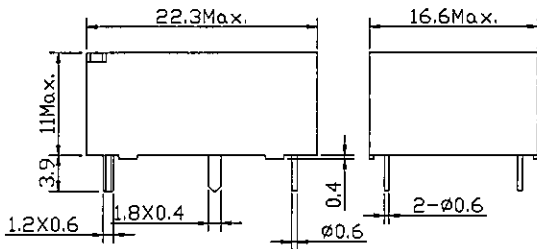

(Bottom View)

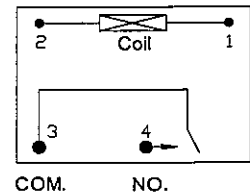
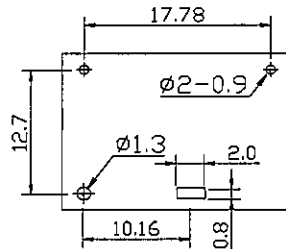

1 Form C

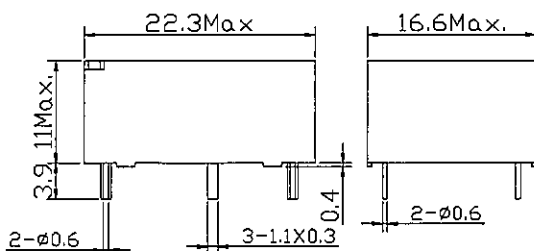

(Bottom View)

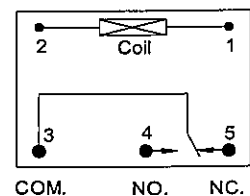
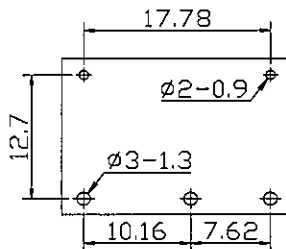

Remark: 1. In case of no tolerance shown in dimension: ±0.5mm.
2. The tolerance without indicating for DRILLING is always ±0.1mm.

➤ COIL DATA CHART (at 20 °C)

TRV TYPE

Coil Sensitivity	Nominal Coil Voltage (VDC)	Coil Resistance ±10%(Ω)	Pull-In Voltage (VDC)	Drop-Out Voltage (VDC)	Allowable Voltage (max)
High Sensitivity Type (Form A only) (0.2W)	5	125	80% Max.	5% Min.	130%
	6	180			
	9	405			
	12	720			
	18	1620			
	24	2880			
	48	9200 *			
Standard Type (0.45W)	5	55.5	80% Max.	5% Min.	130%
	6	80			
	9	180			
	12	320			
	18	720			
	24	1280			
	48	5120			
100	16600 *				

TRVF TYPE

Coil Sensitivity	Nominal Coil Voltage (VDC)	Coil Resistance ±10%(Ω)	Pull-In Voltage (VDC)	Drop-Out Voltage (VDC)	Allowable Voltage (max)
High Sensitivity Type (Form A only) (0.2W)	5	125	80% Max.	5% Min.	130%
	6	180			
	9	405			
	12	720			
	18	1620			
	24	2880			
	48	11520			
Standard Type (0.4W)	5	62.5	80% Max.	80% Max.	130%
	6	90			
	9	202.5			
	12	360			
	18	810			
	24	1440			
	48	5670			

➤ CONTACT RATING

Item	Type	TRV			TRVF		
	FORM A	FORM C		FORM A	FORM C		
		N/O	N/C		N/O	N/C	
Contact Capacity	16A 125VAC	16A 125VAC	15A 125VAC	TV-5 125VAC	10A 250VAC	6A 250VAC	
Resistive Load	16A 250VAC	16A 250VAC	15A 250VAC	16A 125VAC			
cosφ=1	16A 30VDC	16A 30VDC	12A 30VDC	10A 250VAC/125VAC			
				10A 30VDC			
Rated Carrying Current	16A	16A	12A	16A	10A	6A	
Max. Allowable Voltage	250VAC, 30VDC			250VAC, 30VDC	250VAC		
Max. Allowable Current	16A	16A	12A	16	10A	6A	
Max. Allowable Power Force	2000VA 480W	2000VA 480W	1875VA 360W	2500VA 300W	2500VA	1500VA	
Referenced Min. Applicable Load	5VDC, 100mA			5VDC, 100mA			
Contact Material	Ag Alloy			Ag Alloy			

➤ PERFORMANCE (at initial value)

Item	Type	TRV / TRVF
Contact Resistance		100mΩ Max. (6VDC / 1A)
Operation Time		10msec Max.
Release Time		5msec Max.
Dielectric Strength		
Between coil & contact		1500VAC 50/60Hz (1 minute)
Between contacts		750VAC
Insulation Resistance		100 MΩ Min. (AT 500VDC)
Max. ON/OFF Switching		
Mechanically		300 operation/min
Electrically		30 operation/min
Operating Ambient Temperature		-40°C to +70°C (No condensation)
Operating Humidity		45 to 80% RH
Coil Temperature Rise		30deg. Max. (at rated coil voltage)
Vibration		
Endurance		10 to 55Hz Double Amplitude 1.6mm
Error Operation		10 to 55Hz Double Amplitude 1.6mm
Shock		
Endurance		100G Min.
Error Operation		10G Min.
Life Expectancy		
Mechanically		5 × 10 ⁶
Electrically		1 × 10 ⁵
Weight		abt. 10grs.
UL & cUL		E156521
TUV		R50050856