**SPECIFICATIONS:**

**CONTACT RATING:** Refer to "Contact Material Options" for more info.

**ELECTRICAL LIFE:** 30,000 make-and-break cycles at full load.

**CONTACT RESISTANCE:** 20mΩ max typ. initial @ 2-4 VDC  
100mA for both silver and gold contacts.

**INSULATION RESISTANCE:** 1,000MΩ min.

**DIELECTRIC STRENGTH:** 1,500 V RMS @ sea level.

**OPERATING TEMPERATURE:** -30°C to 85°C.

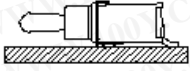
**MATERIALS:**

**CASE & BUSHING:** Glass filled nylon 4/6, flame retardant, heat stabilized (UL 94V-0).

**ACTUATOR:** Brass, chrome plated, internal o-ring sealed (std).

**SWITCH SUPPORT:** Brass, tin plated.

**TERMINAL SEAL:** Epoxy.

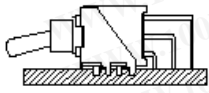

If your preferred product configuration is not shown, please contact our sales representative for custom design.

**HOW TO ORDER SYSTEM**

200B      E

**Switch Function**

**WMSP-1** On-None-On  
**WMSP-2** On-None-(On)  
**WMSP-3** On-Off-On  
**WMSP-4** (On)-Off-(On)  
**WMSP-5** On-Off-(On)

**Actuator**

**T1** 10.80 (.425") high  
**T2** 6.10 (.240") high  
**P1** Plastic, anti-static 10.80 (.425") high  
**P2** Plastic, anti-static 6.70 (.264") high  
**P3** Plastic, anti-static 6.20 (.244") high  
**P4** Plastic, anti-static 7.40 (.291") high

**Bushing**

**B4** 4.50 (.177") high, unthreaded

**Termination**

**M6** Right angle, surface mount  
**S6** Surface mount  
**L6** Right angle, surface mount  
**M7** Vertical, right angle, surface mount

**Contact Material**

**Q** Silver  
**P** Silver (tin plated term.)  
**R** Gold  
**K** Gold (tin plated term.)  
**G** Silver (gold over silver term.)

勝特力材料 886-3-5753170  
勝特力电子(上海) 86-21-54151736  
勝特力电子(深圳) 86-755-83298787  
[Http://www.100y.com.tw](http://www.100y.com.tw)

# Series 200B

# Sealed Surface Mount Toggle Switches

M6

Model No.	Switching Position		
WMSP-1	ON	NONE	ON
WMSP-2	ON	NONE	(ON)
WMSP-3	ON	OFF	ON
WMSP-4	(ON)	OFF	(ON)
WMSP-5	ON	OFF	(ON)
Term. Comm.	2-3	OPEN	2-1

Schematic

Q2Comm.

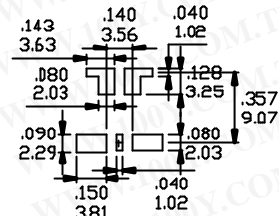
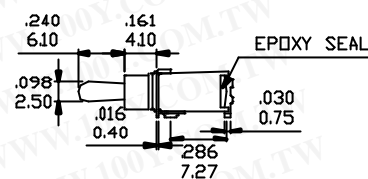
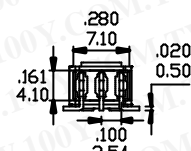
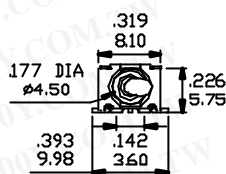

SPDT

勝特力材料 886-3-5753170  
 勝特力电子(上海) 86-21-54151736  
 勝特力电子(深圳) 86-755-83298787  
[Http://www.100y.com.tw](http://www.100y.com.tw)

S6

Model No.	Switching Position		
WMSP-1	ON	NONE	ON
WMSP-2	ON	NONE	(ON)
WMSP-3	ON	OFF	ON
WMSP-4	(ON)	OFF	(ON)
WMSP-5	ON	OFF	(ON)
Term. Comm.	2-3	OPEN	2-1

Schematic

Q2Comm.

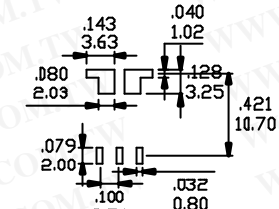
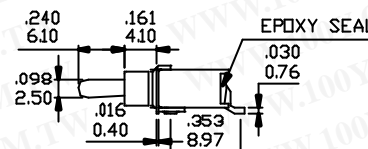
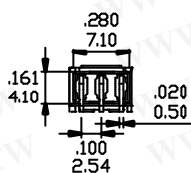
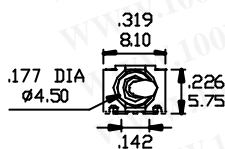

SPDT

L6

Model No.	Switching Position		
WMSP-1	ON	NONE	ON
WMSP-2	ON	NONE	(ON)
WMSP-3	ON	OFF	ON
WMSP-4	(ON)	OFF	(ON)
WMSP-5	ON	OFF	(ON)
Term. Comm.	2-3	OPEN	2-1

Schematic

Q2Comm.

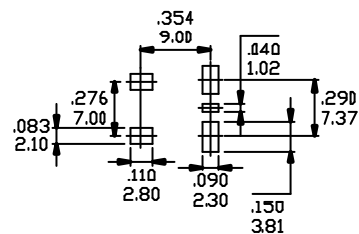
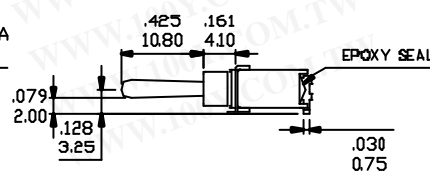
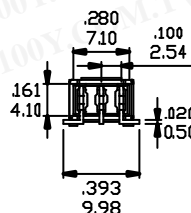
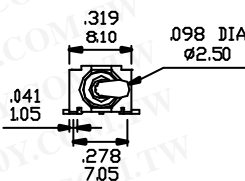

SPDT

# Series 200B

# Sealed Surface Mount Toggle Switches

M7

Model No.	Switching Position		
WMSP-1	ON	NONE	ON
WMSP-2	ON	NONE	(ON)
WMSP-3	ON	OFF	ON
WMSP-4	(ON)	OFF	(ON)
WMSP-5	ON	OFF	(ON)
Term. Comm.	2-3	OPEN	2-1

Schematic

Q2Comm.



SPDT

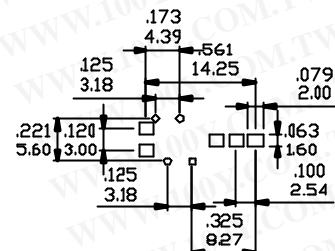
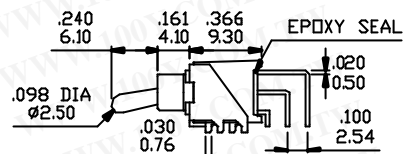
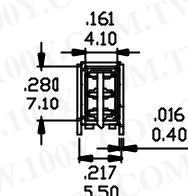
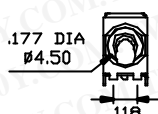

## ACTUATOR OPTIONS

T1

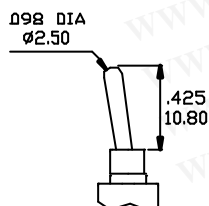

\* Available with L6, S6, M7 terminals only.

T2

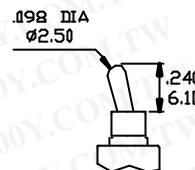

勝特力材料 886-3-5753170  
 勝特力电子(上海) 86-21-54151736  
 勝特力电子(深圳) 86-755-83298787  
[Http://www.100y.com.tw](http://www.100y.com.tw)

P1 PLASTIC TOGGLE

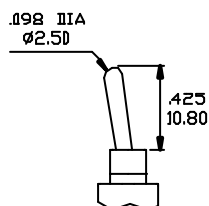

P2 PLASTIC TOGGLE

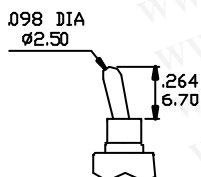

P3 PLASTIC TOGGLE

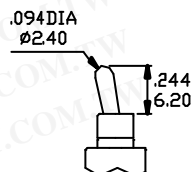

P4 PLASTIC TOGGLE

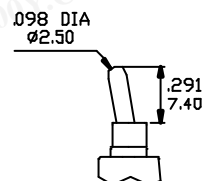

\* Actuator length shown above is with B4 bushing.  
 \* Please consult us for detailed spec on specific item.

\* PLASTIC TOGGLE is capable of withstanding ESD resistance 9000VDC.

# Series 200B

# Sealed Surface Mount Toggle Switches

## REEL TAPING

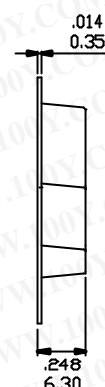
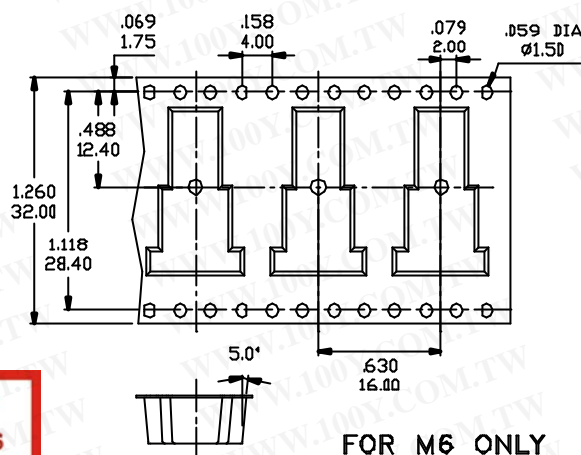
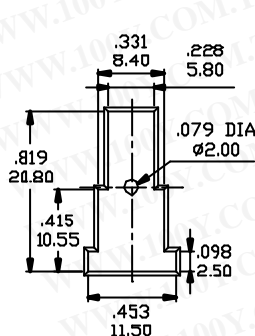

FOR M6 ONLY

勝特力材料 886-3-5753170  
勝特力电子(上海) 86-21-54151736  
勝特力电子(深圳) 86-755-83298787  
[Http://www.100y.com.tw](http://www.100y.com.tw)

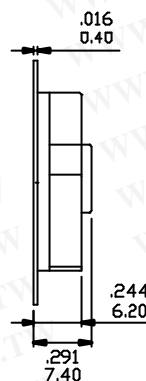
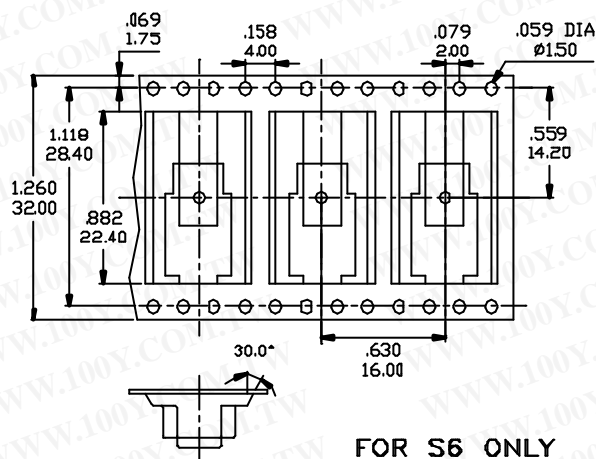
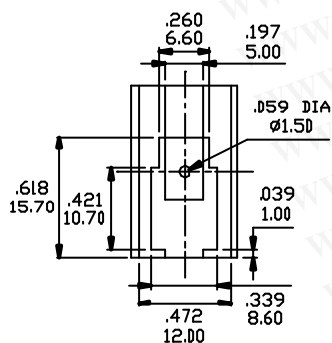

FOR S6 ONLY

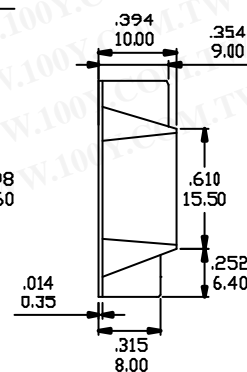
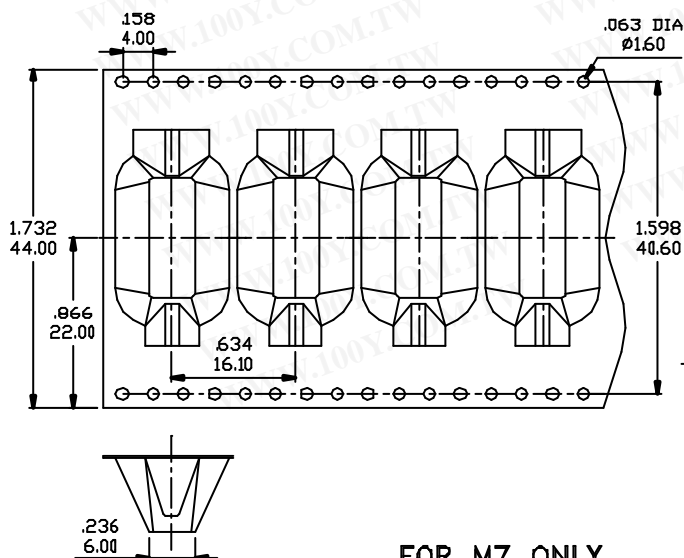
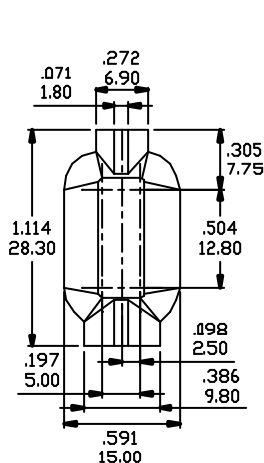

FOR M7 ONLY



# Series 200B

# Sealed Surface Mount Toggle Switches

## REEL TAPING

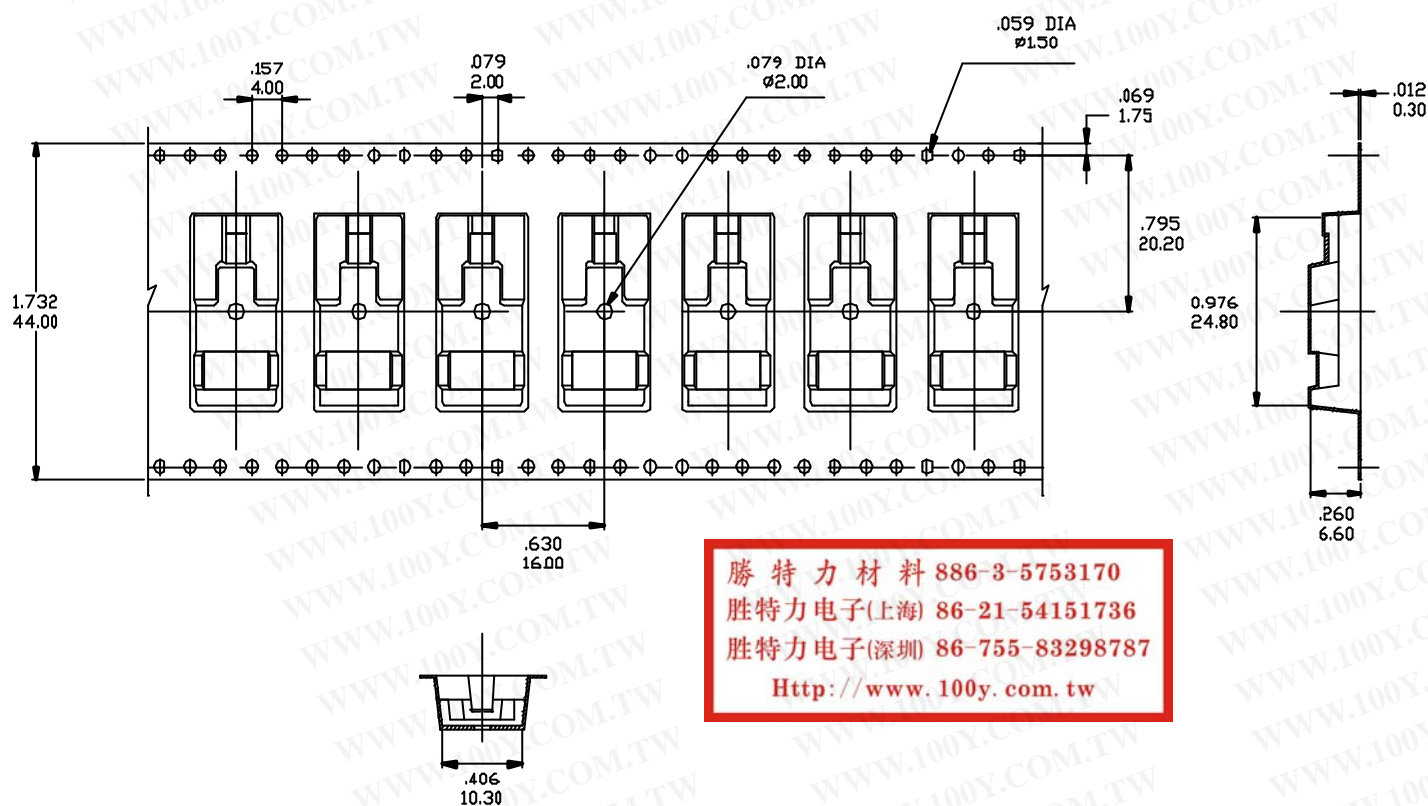

FOR L6 ONLY

## REEL TAPING

REEL INFORMATION	
OUTSIDE DIAMETER	330mm(12.99")
PILOT HOLE	13mm(.502")
QUANTITY PER REEL	500

## CONTACT MATERIAL OPTIONS

Coding	Contact Material	Terminal Plating	Rating	Agency Approvals
Q	Silver <sup>1</sup>	Silver plated <sup>1</sup>	3Amps @ 125VAC or 28VDC 1.5Amps @ 250VAC	IP67
P		Tin plated <sup>5</sup>		
R	Gold <sup>2</sup>	Gold plated <sup>4</sup>	0.4VA max @ 20V max (AC or DC)	IP67
K		Tin plated <sup>5</sup>		
G	Silver <sup>1</sup>	Gold over <sup>3</sup> silver	3Amps @ 125VAC or 28VDC 1.5Amps @ 250VAC	IP67

1. Movable Contact / Terminals: Copper alloy, silver plated.
2. Movable Contact: Copper alloy with gold plated over nickel plated.
3. Terminals: Silver plated with outer layer in gold plating.
4. Terminals: Copper alloy, with gold plated over nickel plated.
5. Outer Terminals: Copper alloy with tin over nickel plated.
6. Terminal Contact: Gold plated over nickel plated.
7. Terminal Contact: Palladium nickel alloy plated.

勝特力材料 886-3-5753170  
 勝特力电子(上海) 86-21-54151736  
 勝特力电子(深圳) 86-755-83298787  
[Http://www.100y.com.tw](http://www.100y.com.tw)