

FS20KM-6 PCB 24  
 MITSUBISHI Nch POWER MOSFET  
**FS20KM-6**  
 HIGH-SPEED SWITCHING USE

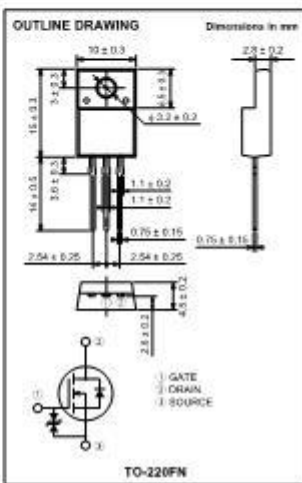
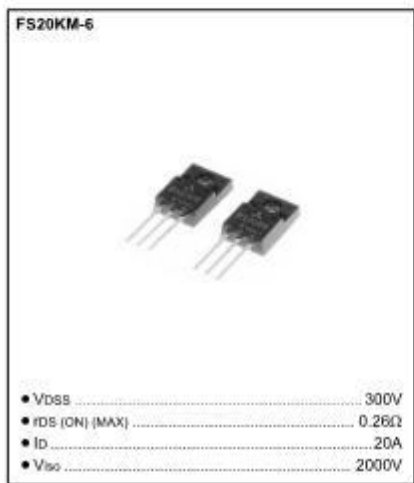

**APPLICATION**  
 SMPS, DC-DC Converter, battery charger, power supply of printer, copier, HDD, FDD, TV, VCR, personal computer etc.

**MAXIMUM RATINGS** (T<sub>c</sub> = 25 °C)

Symbol	Parameter	Conditions	Rating	Unit
V <sub>DSS</sub>	Drain-source voltage	V <sub>GS</sub> = 0V	300	V
V <sub>GSM</sub>	Gate-source voltage	V <sub>DS</sub> = 0V	±30	V
I <sub>D</sub>	Drain current		20	A
I <sub>SM</sub>	Drain current (Pulsed)		40	A
P <sub>D</sub>	Maximum power dissipation		40	W
T <sub>ch</sub>	Channel temperature		-55 ~ +150	°C
T <sub>stg</sub>	Storage temperature		-55 ~ +150	°C
V <sub>iso</sub>	Isolation voltage	AC for 1 minute, Terminal to case	2000	Vrms
—	Weight	Typical value	2.0	g

Pub.1000

