



PRODUCT IDENTIFICATION

JTP - 0301- 1R0 K

|
|
|
|

Type Size Inductance Tolerance

FEATURES

- High saturation for surface mount
- High current rating for high current circuits
- Special lead wire design to prevent open circuit failure
- Excellent terminal strength construction

APPLICATIONS

- OA equipments
- PC and notebook
- LCD TV set
- Power supply

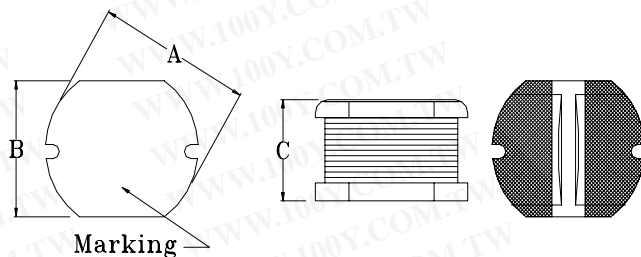

DIMENSIONS (mm)

No.	Part No.	Size (mm)		
		A	B	C
1	JTP 0301	3.5 ± 0.3	3.0 ± 0.3	1.0 ± 0.30
2	JTP 0315	3.5 ± 0.3	3.0 ± 0.3	1.6 ± 0.30
3	JTP 0302	3.5 ± 0.3	3.0 ± 0.3	2.3 ± 0.30
4	JTP 0403	4.5 ± 0.3	4.0 ± 0.3	3.2 ± 0.30
5	JTP 0504	5.8 ± 0.3	5.2 ± 0.3	4.5 ± 0.35
6	JTP 0703	7.8 ± 0.3	7.0 ± 0.3	3.5 ± 0.50
7	JTP 0705	7.8 ± 0.3	7.0 ± 0.3	5.0 ± 0.50
8	JTP 1004	10 ± 0.3	9.0 ± 0.3	4.0 ± 0.50
9	JTP 1005	10 ± 0.4	9.0 ± 0.4	5.4 ± 0.40

RECOMMENDED PATTERN (mm)

Part	A	B	C
JTP 0301	1.40	0.80	3.00
JTP 0315	1.40	0.80	3.00
JTP 0302	1.40	0.80	3.00
JTP 0403	1.80	1.50	4.50
JTP 0504	1.80	1.90	5.00
JTP 0703	3.00	2.00	7.50
JTP 0705	3.00	2.00	7.50
JTP 1004	3.75	2.50	9.50
JTP 1005	3.75	2.50	9.50

勝特力材料 886-3-5753170
 勝特力电子(上海) 86-21-34970699
 勝特力电子(深圳) 86-755-83298787
[Http://www.100y.com.tw](http://www.100y.com.tw)

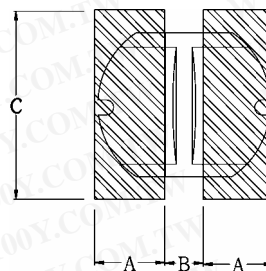

PACKAGE

Type	JTP 0301	JTP 0315/0302	JTP 0403	JTP 0504	JTP 0703	JTP 0705	JTP 1004	JTP 1005
Q'TY/Reel	3,000	3,000	1,500	1,500	1,000	1,000	500	500

Part Code	L (μ H)	JTP 0301		JTP 0315		JTP 0302		JTP 0403		JTP 0504	
		RDC(Ω)	IDC(A)	RDC(Ω)	IDC(A)	RDC(Ω)	IDC(A)	RDC(Ω)	IDC(A)	RDC(Ω)	IDC(A)
1R0	1.0	0.09	1.70					0.05	2.56		
1R4	1.4							0.06	2.52		
1R8	1.8							0.06	1.95		
2R2	2.2	0.12	1.30	0.13	0.79			0.07	1.75		
2R7	2.7							0.08	1.58		
3R3	3.3	0.16	1.30					0.09	1.44		
3R9	3.9							0.09	1.33		
4R7	4.7	0.23	1.00	0.20	0.65			0.11	1.15		
5R6	5.6							0.13	0.99		
6R8	6.8	0.32	0.90					0.13	0.95		
8R2	8.2							0.15	0.84		
100	10	0.47	0.75	0.39	0.45	0.23	0.76	0.18	1.04	0.10	1.44
120	12					0.27	0.69	0.210	0.97	0.12	1.40
150	15	0.77	0.65	0.75	0.30	0.31	0.64	0.24	0.85	0.14	1.30
180	18					0.41	0.53	0.34	0.74	0.15	1.23
220	22	0.95	0.50	0.92	0.25	0.47	0.50	0.38	0.68	0.18	1.11
270	27					0.66	0.41	0.52	0.62	0.20	0.97
330	33	1.95	0.30	1.43	0.20	0.76	0.38	0.540	0.56	0.23	0.88
390	39					0.85	0.36	0.59	0.52	0.32	0.80
470	47	2.65	0.25	1.69	0.17	0.97	0.33	0.84	0.44	0.37	0.72
560	56					1.25	0.29	0.94	0.42	0.42	0.68
680	68	3.13	0.20	2.86	0.13	1.45	0.28	1.12	0.37	0.46	0.61
820	82					1.85	0.24			0.60	0.58
101	100	4.13	0.18	4.55	0.10	2.20	0.22			0.70	0.52
121	120					2.90	0.19			0.93	0.48
151	150					3.40	0.17			1.10	0.40
181	180					3.90	0.17			1.38	0.38
221	220					4.50	0.16			1.57	0.35
271	270					6.00	0.14				
331	330					7.00	0.13				
391	390					7.80	0.12				
471	470										
561	560										
681	680										
821	820										
102	1000										
122	1200			49.40	0.05						
152	1500			71.50	0.03						

DCR & IDC are listed all Max. value.

Tolerance : M=± 20%,K ± 10%

M and K tolerance are standard for JTP 0301. K tolerance is standard for the others.

****Customization is available. Please contact with Sales Dept. for more detail.****

Part Code	L (μ H)	JTP 0703		JTP 0705		JTP 1004		JTP 1005	
		RDC(Ω)	IDC(A)	RDC(Ω)	IDC(A)	RDC(Ω)	IDC(A)	RDC(Ω)	IDC(A)
1R0	1.0								
1R2	1.2								
1R4	1.4								
1R5	1.5								
1R8	1.8								
2R2	2.2								
2R7	2.7								
3R3	3.3								
3R9	3.9								
4R7	4.7								
5R6	5.6								
6R8	6.8								
8R2	8.2								
100	10	0.08	1.44	0.07	2.30	0.05	2.38	0.06	2.60
120	12	0.09	1.39	0.08	2.00	0.06	2.13	0.07	2.45
150	15	0.10	1.24	0.09	1.80	0.07	1.87	0.08	2.27
180	18	0.11	1.12	0.10	1.60	0.08	1.73	0.09	2.15
220	22	0.13	1.07	0.11	1.50	0.09	1.60	0.10	1.95
270	27	0.15	0.94	0.12	1.30	0.10	1.44	0.11	1.76
330	33	0.17	0.85	0.13	1.20	0.12	1.26	0.12	1.50
390	39	0.22	0.74	0.16	1.10	0.15	1.20	0.14	1.37
470	47	0.25	0.68	0.18	1.10	0.17	1.10	0.17	1.28
560	56	0.28	0.64	0.24	0.94	0.20	1.01	0.19	1.17
680	68	0.33	0.59	0.28	0.85	0.22	0.91	0.22	1.11
820	82	0.41	0.54	0.37	0.78	0.25	0.85	0.25	1.00
101	100	0.48	0.51	0.43	0.72	0.34	0.74	0.35	0.97
121	120	0.54	0.49	0.47	0.66	0.40	0.69	0.40	0.89
151	150	0.76	0.40	0.64	0.58	0.54	0.61	0.47	0.78
181	180	1.02	0.36	0.71	0.51	0.62	0.56	0.63	0.72
221	220	1.20	0.31	0.96	0.49	0.72	0.53	0.73	0.66
271	270	1.31	0.29	1.11	0.42	0.95	0.45	0.97	0.57
331	330	1.50	0.28	1.26	0.40	1.10	0.42	1.15	0.52
391	390			1.77	0.36	1.25	0.38	1.30	0.48
471	470			1.96	0.34	1.53	0.35	1.48	0.42
561	560					1.90	0.32	1.90	0.33
681	680							2.25	0.28
821	820							2.55	0.24
102	1000							2.75	0.22

DCR & IDC are listed all Max. value.

Tolerance : $K \pm 10\%$, K tolerance is standard.

****Customization is available. Please contact with Sales Dept. for more detail.****

勝特力材料 886-3-5753170
 勝特力电子(上海) 86-21-34970699
 勝特力电子(深圳) 86-755-83298787
[Http://www.100y.com.tw](http://www.100y.com.tw)