

# G5T16-E1Z200

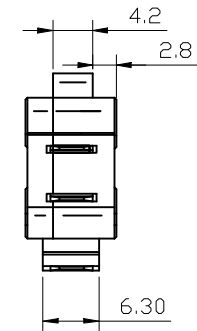
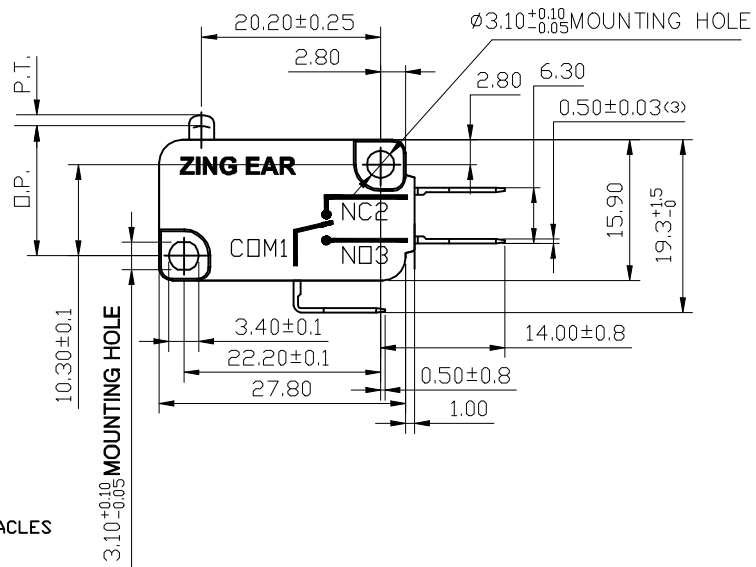
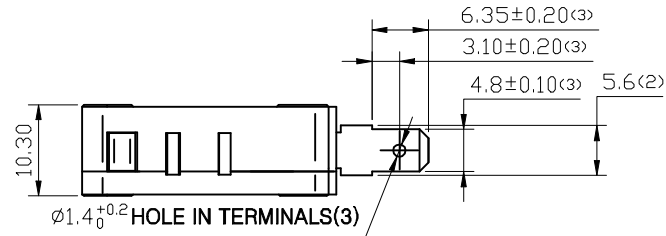

**NOTES:**

1. MOUNTING HOLES WILL ACCEPT  $\phi 3$  MAX PINS OR SCREWS.
2. TERMINALS WILL ACCEPT 4.80mm WIDE QUICK CONNECT RECEPTACLES AND COMPLY WITH EN61058-1 REQUIREMENTS.

**CHARACTERISTICS**

<b>OPERATING FORCE:</b>	<b>200gf Max.</b>
<b>RELEASE FORCE:</b>	<b>50gf Min.</b>
<b>OPERATING POSITION:</b>	<b>14.7±0.5mm.</b>
<b>PRE-TRAVEL:</b>	<b>1.6mm Max.</b>
<b>DIFFERENTIAL TRAVEL:</b>	<b>0.4mm Max.</b>
<b>OVER-TRAVEL:</b>	<b>0.8mm Min.</b>

**ELECTRICAL DATA**  
CONTACT ARRANGEMENT

**S.P.D.T**



**16(4)A 250V~**  
**25T125  $\mu$  5E4**



**16A 1/2HP 125/250VAC**

REV	REF	DESCRIPTION	DWN.BY	DATE
TITLE	G5 SERIES OUTLINE DRAWING	UNIT mm	Rev A	
MODEL	G5T16-E1Z200	FINISH SHI JUN	CHK.BY PAN JIAQUAN	APP.BY LUKE LU

勝特力電材超市-龍山店 886-3-5773766  
 勝特力電材超市-光復店 886-3-5729570  
 勝特力电子(上海) 86-21-34970699  
 勝特力电子(深圳) 86-755-83298787  
<http://www.100y.com.tw>