



CIRCUIT-BREAKER SIZE S0,  
FOR MOTOR PROTECTION, CLASS 10,  
A-REL. 7...10A, N-REL. 130A,  
SCREW TERMINAL,  
STANDARD SWITCHING CAPACITY

勝特力材料 886-3-5753170  
 勝特力电子(上海) 86-21-34970699  
 勝特力电子(深圳) 86-755-83298787  
[Http://www.100y.com.tw](http://www.100y.com.tw)

**General technical data:**

<b>product brand name</b>	SIRIUS	
<b>product designation</b>	circuit breaker	
<b>Size of the circuit-breaker</b>	S0	
<b>Number of poles / for main current circuit</b>	3	
<b>Product function</b>	<ul style="list-style-type: none"> <li>• removable terminal for auxiliary and control circuit No</li> <li>• overload protection Yes</li> <li>• phase disturbance recognition Yes</li> <li>• short-circuit to earth recognition No</li> </ul>	
<b>Product component</b>	<ul style="list-style-type: none"> <li>• auxiliary switch No</li> <li>• undervoltage release mechanism No</li> <li>• trip indicator No</li> </ul>	
<b>Product extension</b>	<ul style="list-style-type: none"> <li>• auxiliary switch Yes</li> <li>• optional / motor drive No</li> </ul>	
<b>Impulse voltage resistance / rated value</b>	V	6,000
<b>Protection class IP / on the front</b>	IP20	
<b>Protection against electrical shock</b>	finger-safe	

<b>Installation altitude / at a height over sea level / maximum</b>	m	2,000
<b>Resistance against shock</b>		25g / 11 ms
<b>Ambient temperature</b>		
• during transport	°C	-50 ... +80
• during storage	°C	-50 ... +80
• during operating	°C	-20 ... +70
<b>Active power loss / total / typical</b>	W	7

#### Main circuit:

<b>Operating voltage / rated value</b>	V	690
<b>type of voltage</b>		AC/DC
<b>Service power / at AC-3 / at 400 V / rated value</b>	kW	4
<b>Operating current / at AC-3 / at 400 V / rated value</b>	A	10
<b>Mechanical operating cycles as operating time / of the main contacts / typical</b>		100,000
<b>Frequency of operation / at AC-3 / according to IEC 60947-6-2</b>	1/h	15

#### Auxiliary circuit:

<b>Number of changeover contacts / for auxiliary contacts</b>		0
---	--	---

#### Protection function:

<b>Trip class</b>		CLASS 10
<b>Adjustable response current / of the current-dependent overload release</b>	A	7 ... 10
<b>Breaking capacity limit short-circuit current (I<sub>cu</sub>)</b>		
• at 400 V / rated value	kA	100
• at 500 V / rated value	kA	42
• at 690 V / rated value	kA	6

#### Installation/mounting/dimensions:

<b>Type of mounting</b>		screw and snap-on mounting onto 35 mm standard mounting rail according to DIN EN 50022
<b>mounting position</b>		any
<b>Depth</b>	mm	96
<b>Height</b>	mm	97
<b>Width</b>	mm	45

#### Connections:

<b>Arrangement of electrical connectors / for main current circuit</b>		front side
<b>Design of the electrical connection</b>		
• for main current circuit		screw-type terminals
• for auxiliary and control current circuit		screw-type terminals
<b>Type of the connectable conductor cross-section</b>		

- for main contacts
  - solid
  - finely stranded
    - with conductor end processing
  - stranded
- for AWG conductors / for main contacts

2x (1 ... 2.5 mm<sup>2</sup>), 2x (2.5 ... 6 mm<sup>2</sup>)

2x (1 ... 2.5 mm<sup>2</sup>), 2x (2.5 ... 6 mm<sup>2</sup>)

2x (1 ... 2.5 mm<sup>2</sup>), 2x (2.5 ... 6 mm<sup>2</sup>)

2x (14 ... 10)

### Certificates/approvals:

#### General Product Approval



#### Test Certificates

[Special Test Certificate](#)

#### Shipping Approval



#### other

[Confirmation](#)

[Declaration of Conformity](#)

[other](#)

[Environmental Confirmations](#)

### Further information:

#### Information- and Downloadcenter (Catalogs, Brochures,...)

<http://www.siemens.com/industrial-controls/catalogs>

#### Industry Mall (Online ordering system)

<http://www.siemens.com/industrial-controls/mall>

#### Cax online generator:

<http://www.siemens.com/cax>

#### Service&Support (Manuals, Certificates, Characteristics, FAQs,...)

<http://support.automation.siemens.com/WW/view/en/3RV1021-1JA10/all>

#### Image database (product images, 2D dimension drawings, 3D models, device circuit diagrams, ...)

[http://www.automation.siemens.com/bilddb/cax\\_en.aspx?mlfb=3RV1021-1JA10](http://www.automation.siemens.com/bilddb/cax_en.aspx?mlfb=3RV1021-1JA10)

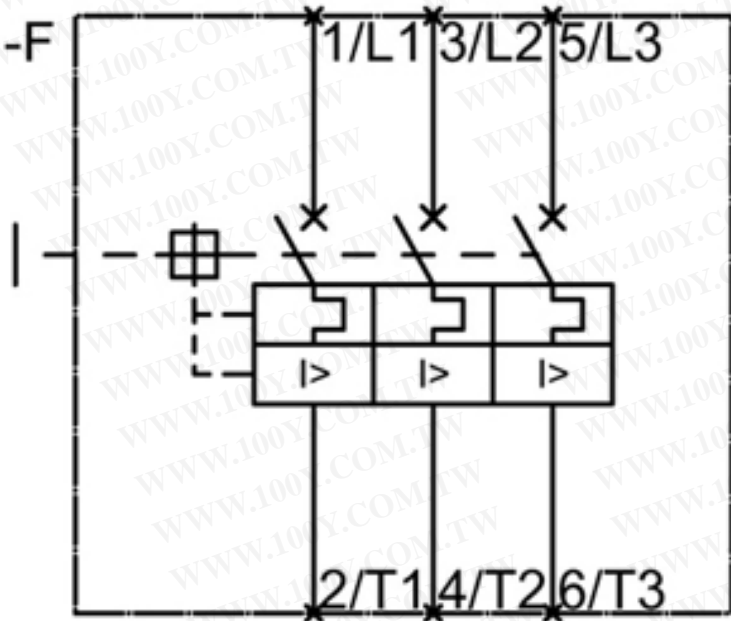
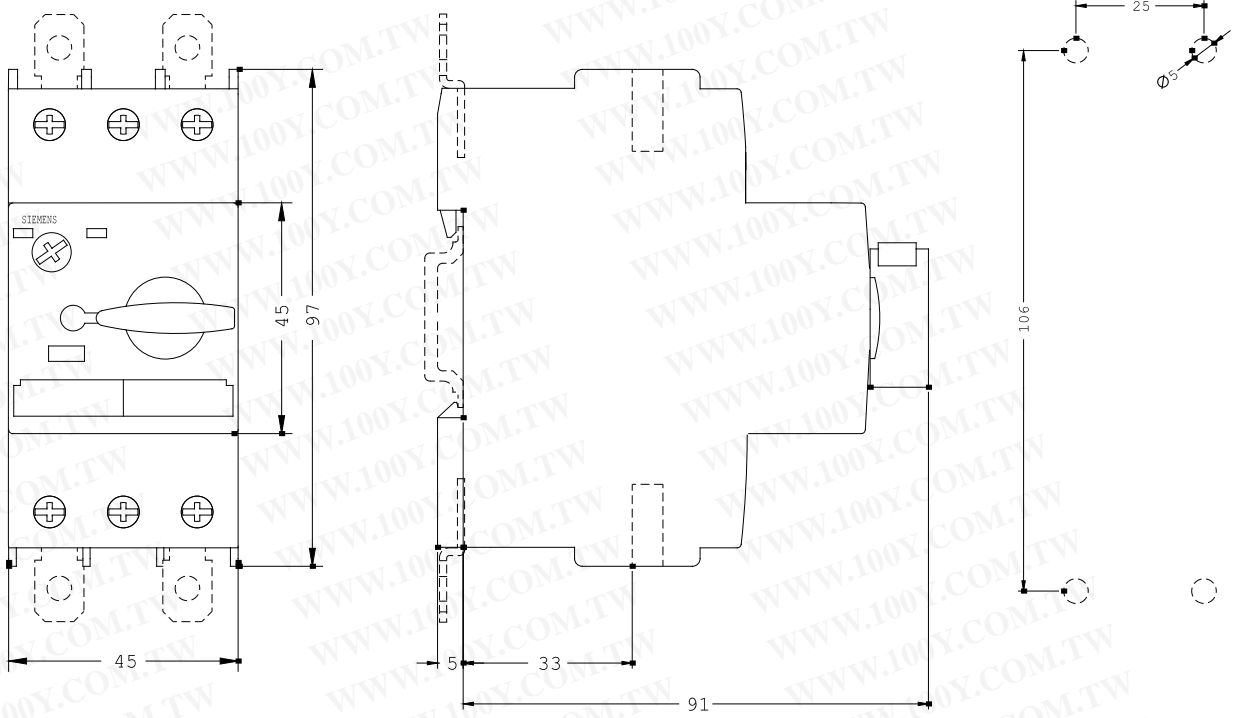

勝特力材料 886-3-5753170  
 勝特力电子(上海) 86-21-34970699  
 勝特力电子(深圳) 86-755-83298787  
[Http://www.100y.com.tw](http://www.100y.com.tw)

last change:

Oct 28, 2013