

DILA-22, DILA22, DILA 22

Industrial Control Relay



The DILA-22 contactor relay can not be combined with the 4-pole auxiliary contact module.

Normally Open (Make)	Normally Closed (Break)
2	2

勝特力材料 886-3-5753170
 勝特力电子(上海) 86-21-34970699
 勝特力电子(深圳) 86-755-83298787
[Http://www.100y.com.tw](http://www.100y.com.tw)

AC-15
 380 V
 400 V
 415 V

I_c
 A

I_c
 A

Can be combined
 with auxiliary
 contact

Note:

4

10

DILA-XHI(V)

Interlocked opposing
 contacts

Available voltages include: 230 V 50 Hz, 240 V 60 Hz, 24 V 50/60 Hz, 110 V 50 Hz, 120 V 60 Hz and 24 V DC

Other DILA Product Lines include:

DILA-22 Contact Sequence

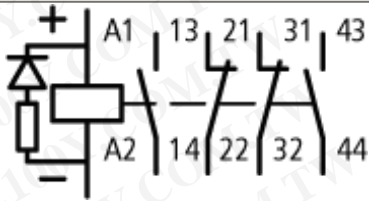

DC Coil

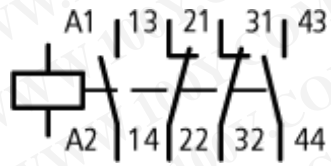

AC Coil

DILA-22 Dimensions

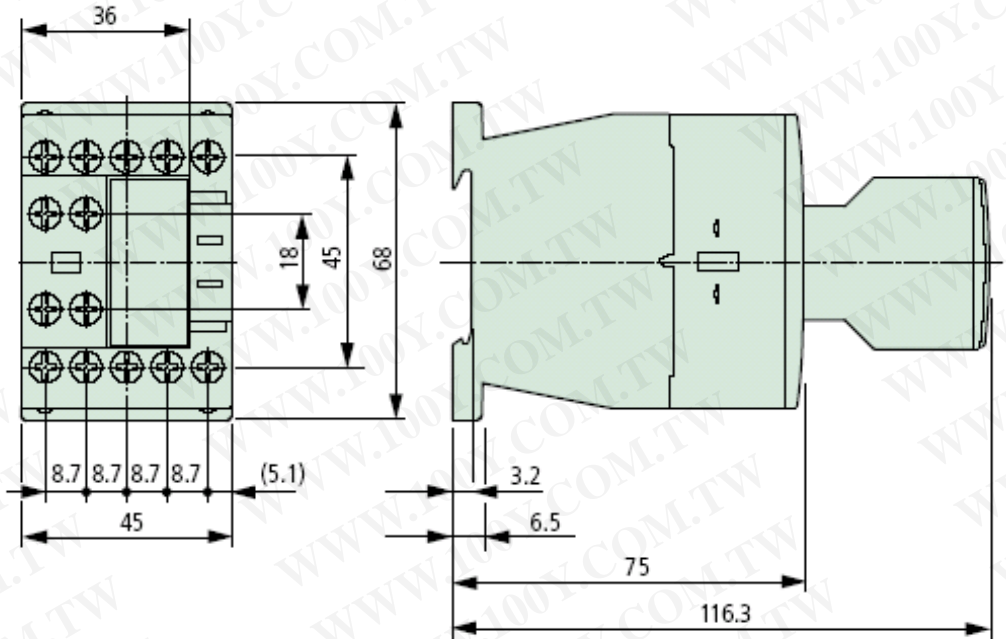

Shown with two pole top mounted auxiliary contact, four pole top mounted auxiliary contact will be slightly wider.

Inches Millimeters

=

DILA-22 Ordering Information

勝特力材料 886-3-5753170
 勝特力电子(上海) 86-21-34970699
 勝特力电子(深圳) 86-755-83298787
[Http://www.100y.com.tw](http://www.100y.com.tw)

	Article Number	Actuating Voltage	Type of Current	Rated Operational Current		Auxiliary Contact Module
				220 V 230 V 240 V I_e A	380 V 400 V 415 V I_e A	
DILA-22 (*VDC)	276419	...V DC	DC operation	6	4	16DILA-XHI (V)...
DILA-22 (110VDC)	276417	110V DC	DC operation	6	4	16DILA-XHI (V)...
DILA-22 (220VDC)	276418	220V DC	DC operation	6	4	16DILA-XHI (V)...
DILA-22 (48VDC)	276415	48V DC	DC operation	6	4	16DILA-XHI (V)...
DILA-22 (230V50HZ.240V60HZ)	276399	230V 50Hz. 240V 60Hz	AC operation	6	4	DILA-XHI (V)...
DILA-22 (24V50HZ)	276386	24V 50 Hz	AC operation	6	4	16DILA-XHI (V)...
DILA-22 (110V50/60HZ)	276405	110 V 50/60 Hz	AC operation	6	4	16DILA-XHI (V)...
DILA-22 (*V60HZ)	276412	... V 60 Hz	AC operation	6	4	16DILA-XHI (V)...
DILA-22 (*V50HZ)	276411	... V 50 Hz	AC operation	6	4	16DILA-XHI (V)...
DILA-22 (110V50HZ.120V60HZ)	276396	110V 50 Hz. 120V 60 Hz	AC operation	6	4	16DILA-XHI (V)...
DILA-22 (220V50HZ.240V60HZ)	276398	220V 50 Hz. 240V 60 Hz	AC operation	6	4	16DILA-XHI (V)...
DILA-22 (190V50HZ.220V60HZ)	276397	190V 50 Hz. 220V 60 Hz	AC operation	6	4	16DILA-XHI (V)...
DILA-22 (220V50/60HZ)	276406	220V 50/60Hz	AC operation	6	4	16DILA-XHI (V)...
DILA-22 (230V50/60HZ)	276407	230 V 50/60 Hz	AC operation	6	4	16DILA-XHI (V)...
DILA-22 (240V50HZ)	276388	240V 50Hz	AC operation	6	4	16DILA-XHI (V)...
DILA-22 (24V50/60HZ)	276403	24V 50/60Hz	AC operation	6	4	16DILA-XHI (V)...
DILA-22 (380V50HZ.440V60HZ)	276400	380V 50 Hz. 440V 60 Hz	AC operation	6	4	16DILA-XHI (V)...
DILA-22 (400V50HZ.440V60HZ)	276401	400V 50 Hz. 440V 60 Hz	AC operation	6	4	16DILA-XHI (V)...
DILA-22 (42V50/60HZ)	276404	42V 50/60Hz	AC operation	6	4	16DILA-XHI (V)...
DILA-22 (TVC100)	276409	TVC100	AC operation	6	4	16DILA-XHI (V)...
DILA-22 (TVC200)	276410	TVC200	AC operation	6	4	16DILA-XHI (V)...
DILA-22 (24VDC)	276414	24 V DC	DC operation	6	4	DILA-XHI (V)...