

十字盤頭塑膠螺絲是屬於塑膠螺絲的公制塑膠螺絲系列，它的別稱又可分為：十字圓柱頭塑膠螺絲，十字圓柱頭尼龍螺絲。

十字盤頭塑膠螺絲是屬於塑膠螺絲系列，主要應用在電子、電腦 PC 板上，代替緊固件螺絲用。

材質：UL 合格之 NYLON66/PC 料（本色/黑色），防火等級 94V-2；

用途：PC 板、機板及其他器具固定用；

特點：絕緣性良好，不生銹、不腐蝕，重量輕；

其他要點：符合 ROHS，常備庫存，系列尺寸。

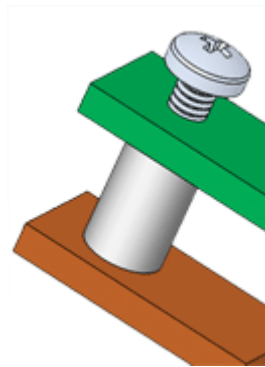

十字圓柱頭塑料螺絲安裝效果圖

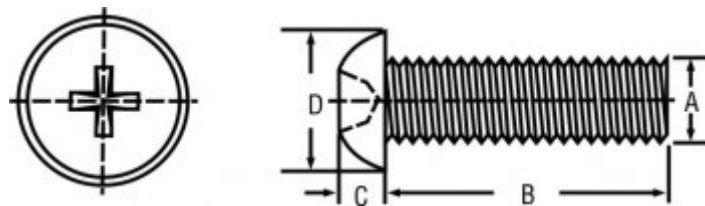

十字圓柱頭塑料螺絲緊固件工程圖

單位: mm

| 型號        |             | Item No. |           | A   | B  | C    | D    | 螺距<br>Pitch | 包裝<br>Packing       |
|-----------|-------------|----------|-----------|-----|----|------|------|-------------|---------------------|
| 尼龍NYLON   |             | PC       |           |     |    |      |      |             |                     |
| 本色        | 黑色          | 本色       | 黑色        |     |    |      |      |             |                     |
| PF2-6N    | PF2-6N B    | PF2-6    | PF2-6B    | 2.0 | 6  | 1.35 | 3.5  | 0.4         | 1000PCS<br>(100PCS) |
| PF2-8N    | PF2-8N B    | PF2-8    | PF2-8B    |     | 8  |      |      |             |                     |
| PF2-10N   | PF2-10N B   | PF2-10   | PF2-10B   |     | 10 |      |      |             |                     |
| PF2.5-6N  | PF2.5-6N B  | PF2.5-6  | PF2.5-6B  | 2.5 | 6  | 2.0  | 4.3  | 0.45        |                     |
| PF2.5-8N  | PF2.5-8N B  | PF2.5-8  | PF2.5-8B  |     | 8  |      |      |             |                     |
| PF2.5-10N | PF2.5-10N B | PF2.5-10 | PF2.5-10B |     | 10 |      |      |             |                     |
| PF3-6N    | PF3-6N B    | PF3-6    | PF3-6B    | 3.0 | 6  | 2.5  | 6.0  | 0.5         |                     |
| PF3-8N    | PF3-8N B    | PF3-8    | PF3-8B    |     | 8  |      |      |             |                     |
| PF3-10N   | PF3-10N B   | PF3-10   | PF3-10B   |     | 10 |      |      |             |                     |
| PF3-12N   | PF3-12N B   | PF3-12   | PF3-12B   |     | 12 |      |      |             |                     |
| PF3-15N   | PF3-15N B   | PF3-15   | PF3-15B   |     | 15 |      |      |             |                     |
| PF3-20N   | PF3-20N B   | PF3-20   | PF3-20B   |     | 20 |      |      |             |                     |
| PF3-22N   | PF3-22N B   | PF3-22   | PF3-22B   |     | 22 |      |      |             |                     |
| PF3-25N   | PF3-25N B   | PF3-25   | PF3-25B   | 25  |    |      |      |             |                     |
| PF4-6N    | PF4-6N B    | PF4-6    | PF4-6B    | 4.0 | 6  | 2.6  | 7.5  | 0.7         |                     |
| PF4-8N    | PF4-8N B    | PF4-8    | PF4-8B    |     | 8  |      |      |             |                     |
| PF4-10N   | PF4-10N B   | PF4-10   | PF4-10B   |     | 10 |      |      |             |                     |
| PF4-12N   | PF4-12N B   | PF4-12   | PF4-12B   |     | 12 |      |      |             |                     |
| PF4-15N   | PF4-15N B   | PF4-15   | PF4-15B   |     | 15 |      |      |             |                     |
| PF4-20N   | PF4-20N B   | PF4-20   | PF4-20B   |     | 20 |      |      |             |                     |
| PF4-25N   | PF4-25N B   | PF4-25   | PF4-25B   |     | 25 |      |      |             |                     |
| PF4-30N   | PF4-30N B   | PF4-30   | PF4-30B   |     | 30 |      |      |             |                     |
| PF5-8N    | PF5-8N B    | PF5-8    | PF5-8B    | 5.0 | 8  | 3.5  | 9.0  | 0.8         |                     |
| PF5-10N   | PF5-10N B   | PF5-10   | PF5-10B   |     | 10 |      |      |             |                     |
| PF5-12N   | PF5-12N B   | PF5-12   | PF5-12B   |     | 12 |      |      |             |                     |
| PF5-15N   | PF5-15N B   | PF5-15   | PF5-15B   |     | 15 |      |      |             |                     |
| PF5-20N   | PF5-20N B   | PF5-20   | PF5-20B   |     | 20 |      |      |             |                     |
| PF5-25N   | PF5-25N B   | PF5-25   | PF5-25B   |     | 25 |      |      |             |                     |
| PF5-30N   | PF5-30N B   | PF5-30   | PF5-30B   |     | 30 |      |      |             |                     |
| PF5-35N   | PF5-35N B   | PF5-35   | PF5-35B   |     | 35 |      |      |             |                     |
| PF5-40N   | PF5-40N B   | PF5-40   | PF5-40B   | 40  |    |      |      |             |                     |
| PF6-10N   | PF6-10N B   | PF6-10   | PF6-10B   | 6.0 | 10 | 4.0  | 10.0 | 1.0         |                     |
| PF6-12N   | PF6-12N B   | PF6-12   | PF6-12B   |     | 12 |      |      |             |                     |
| PF6-14N   | PF6-14N B   | PF6-14   | PF6-14B   |     | 14 |      |      |             |                     |
| PF6-16N   | PF6-16N B   | PF6-16   | PF6-16B   |     | 16 |      |      |             |                     |
| PF6-20N   | PF6-20N B   | PF6-20   | PF6-20B   |     | 20 |      |      |             |                     |
| PF6-25N   | PF6-25N B   | PF6-25   | PF6-25B   |     | 25 |      |      |             |                     |
| PF6-30N   | PF6-30N B   | PF6-30   | PF6-30B   |     | 30 |      |      |             |                     |
| PF6-35N   | PF6-35N B   | PF6-35   | PF6-35B   |     | 35 |      |      |             |                     |
| PF6-40N   | PF6-40N B   | PF6-40   | PF6-40B   | 40  |    |      |      |             |                     |
| PF8-12N   | PF8-12N B   |          |           | 8.0 | 12 | 5.4  | 14.0 | 1.25        |                     |
| PF8-14N   | PF8-14N B   |          |           |     | 14 |      |      |             |                     |
| PF8-16N   | PF8-16N B   |          |           |     | 16 |      |      |             |                     |
| PF8-20N   | PF8-20N B   |          |           |     | 20 |      |      |             |                     |
| PF8-25N   | PF8-25N B   |          |           |     | 25 |      |      |             |                     |
| PF8-30N   | PF8-30N B   |          |           |     | 30 |      |      |             |                     |
| PF8-35N   | PF8-35N B   |          |           |     | 35 |      |      |             |                     |
| PF8-40N   | PF8-40N B   |          |           | 40  |    |      |      |             |                     |