

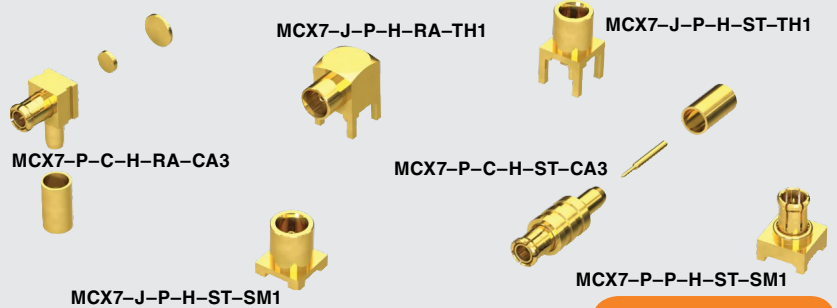

勝特力材料 886-3-5753170  
 勝特力电子(上海) 86-21-34970699  
 勝特力电子(深圳) 86-755-83298787  
 Http://www.100y.com.tw



**MCX7 SERIES**

# 75 Ω OPTIMIZED MCX JACKS & PLUGS

**SPECIFICATIONS**

For complete specifications and recommended PCB layouts see [www.samtec.com?MCX7-SM](http://www.samtec.com?MCX7-SM) or [www.samtec.com?MCX7-TH](http://www.samtec.com?MCX7-TH)

- Shell Material:** Brass
- Contact Material:** BeCu
- Insulator Material:** PTFE
- Impedance:** ST = 75 Ω ±3 Ω, RA = 75 Ω ±4 Ω
- Frequency Range:** 0-6 GHz
- Working Voltage:** 170 Vrms max
- Dielectric Withstanding:** 500 Vrms min
- Engagement Force:** 4.5 lbs max (-ST only)
- Disengagement Force:** 2.3 lbs max (-ST only)
- Operating Temperature:** -65 °C to +125 °C
- RoHS Compliant:** Yes

**PROCESSING**

**Lead-Free Solderable:** Yes

**MCX7**

**GENDER**

**TYPE**

**PLATING**

**ORIENTATION**

**TERMINATION**

Mates with:  
 RF179,  
 GRF7H-C

- P = Plug
- J = Jack

- P = PCB Mount

- H = 30 μ" (0.76 μm) Gold center contact, 3 μ" (0.08 μm) Gold outer contact

- ST = Straight
- RA = Right-angle (-J-TH1 only)

- SM1 = Surface Mount (-ST only)
- TH1 = Through-hole (-J only)

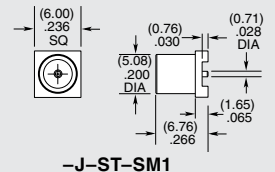

-J-ST-SM1

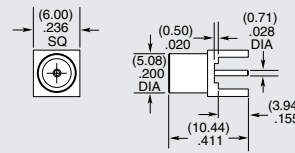

-J-ST-TH1

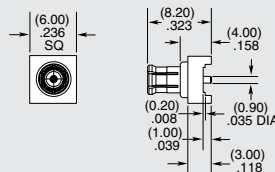

-P-ST-SM1

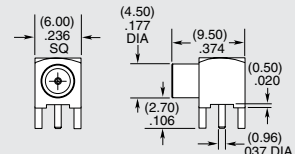

-J-RA-TH1

**SPECIFICATIONS**

For complete specifications and assembly instructions see [www.samtec.com?MCX7-CA](http://www.samtec.com?MCX7-CA)

- Contact Material:** Brass
- Finger Shell Material:** BeCu
- Body Material:** Brass
- Insulator Material:** PTFE
- Center Contact:** Soldered
- Outer Ferrule:** Crimped
- Impedance:** 75 Ω
- Frequency Range:** 0-6 GHz (-ST), 0-4.5 GHz (-RA)
- Working Voltage:** 170 Vrms max
- Dielectric Withstanding:** 500 Vrms min
- Operating Temperature:** -65 °C to +125 °C

**MCX7**

**GENDER**

**TYPE**

**PLATING**

**ORIENTATION**

**TERMINATION**

- P = Plug

- C = Cable

- H = 30 μ" (0.76 μm) Gold center contact, 3 μ" (0.08 μm) Gold outer contact

- ST = Straight
- RA = Right-angle

- CA3 = RG 179 Cable

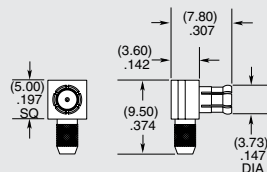

-P-RA

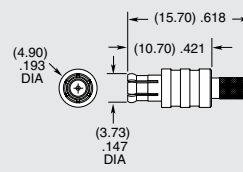

-P-ST

Supplied with pins and ferrules. See website for dimensions.