

THIS DRAWING IS UNPUBLISHED. RELEASED FOR PUBLICATION  
 © COPYRIGHT - By - ALL RIGHTS RESERVED.

LOC	DIST	REVISIONS			
P	LTR	DESCRIPTION	DATE	DWN	APVD
AJ	17	A	ECR-12-005726	27MAR12	RK MY

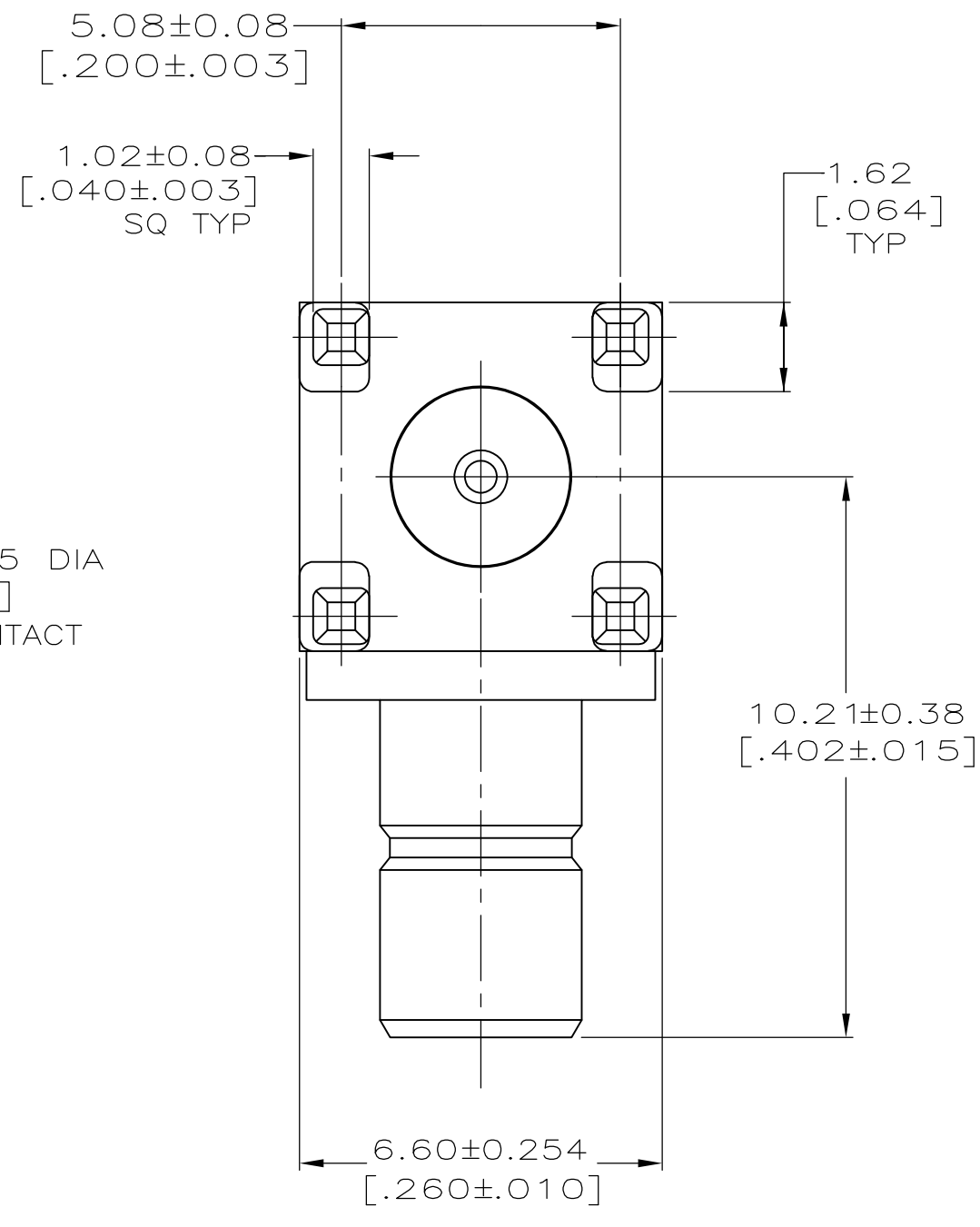

- 1 MATERIALS:  
 BODY(LEG): ZINC ALLOY (ZAMAK 3).  
 BODY(FRONT): BRASS PER QQ-B-262.  
 CENTER CONTACT: BRASS PER QQ-B-626.  
 INSULATORS: PTFE PER ASTM-D-1710.  
 END CAP: BRASS PER QQ-B-626.
- 2 FINISH  
 CENTER CONTACT: GOLD PLATE PER MIL-G-45204.  
 BODY(LEG): TIN PLATE PER ASTM-B-545.  
 BODY(FRONT): ELECTROLESS NICKEL PER MIL-C-26074.  
 END CAP: NICKEL PLATE PER QQ-N-290.
- 3. INTERFACE PER MIL-C-39012.

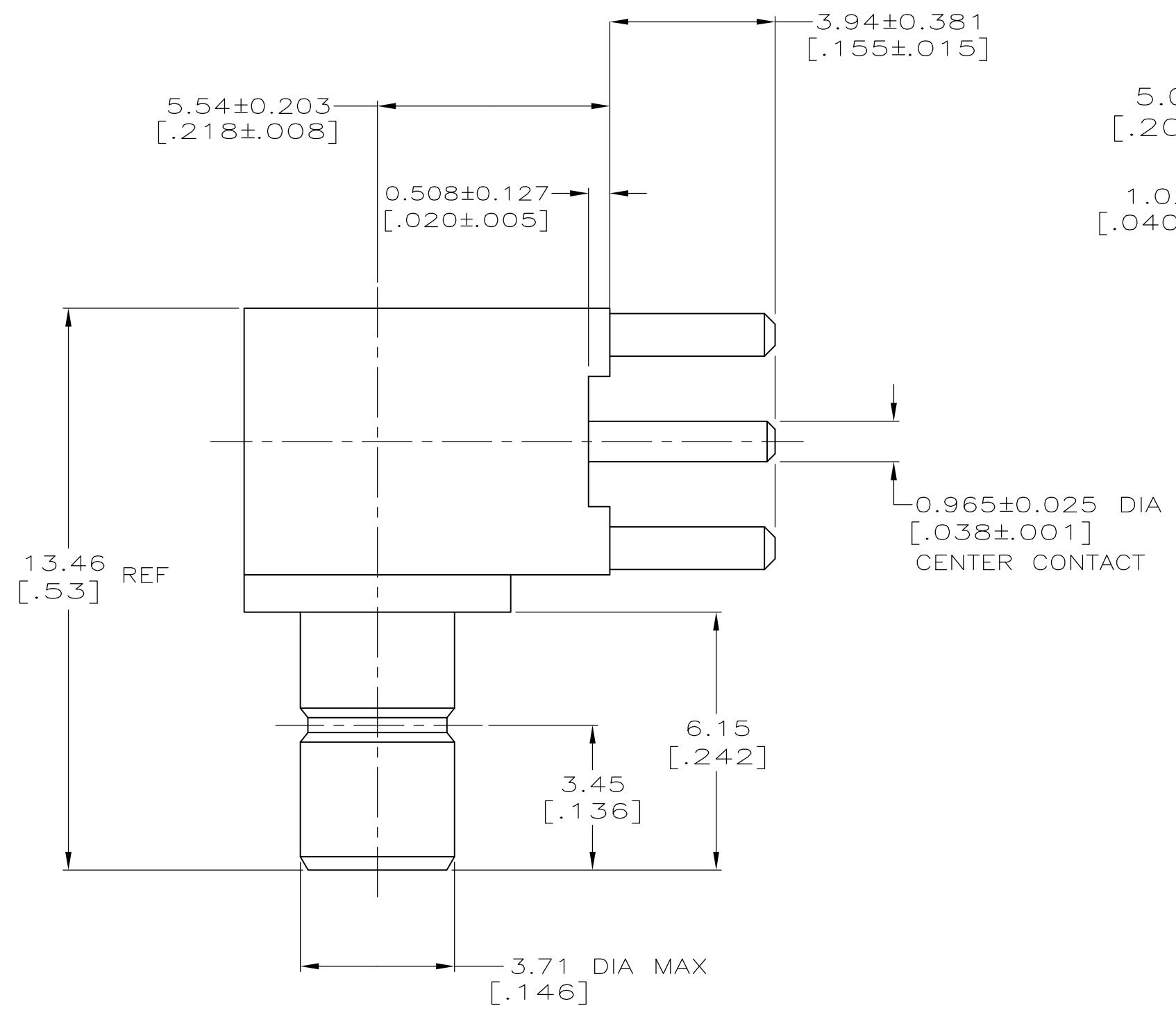
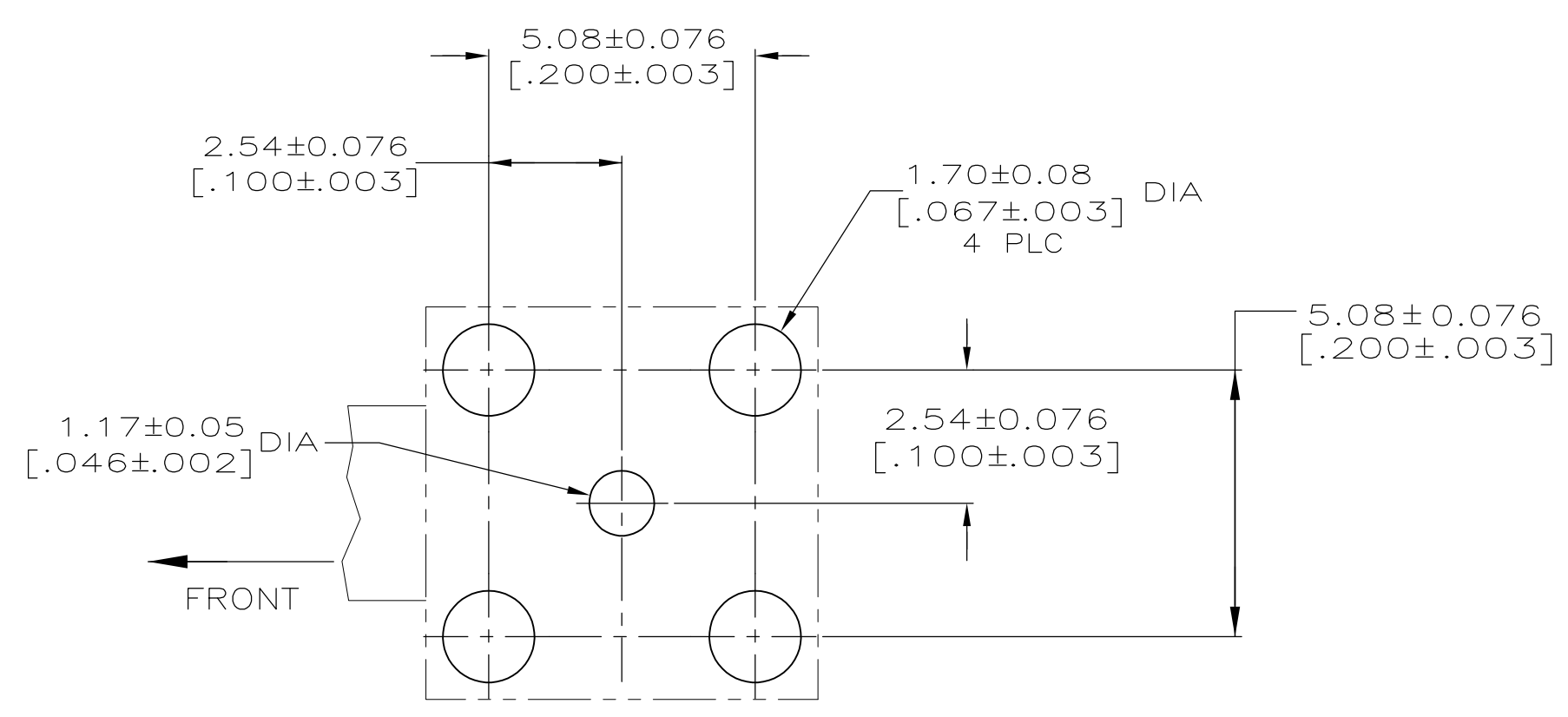

RECOMMENDED PCB CONFIGURATION

**勝特力材料 886-3-5753170**  
**勝特力电子(上海) 86-21-34970699**  
**勝特力电子(深圳) 86-755-83298787**  
[Http://www.100y.com.tw](http://www.100y.com.tw)

5414337-1  
 PART NUMBER

THIS DRAWING IS A CONTROLLED DOCUMENT.		DWN G. ATTADIA - 01FEB2005	TE Connectivity	
DIMENSIONS: INCHES		CHK J. HAVENER - 01FEB2005	NAME JACK,RTANG,SMB/PCB	
TOLERANCES UNLESS OTHERWISE SPECIFIED:		APVD J. HAVENER - 01FEB2005	PRODUCT SPEC	
0 PLC ± -		APPLICATION SPEC		
1 PLC ± -		WEIGHT		
2 PLC ± .25 [.010]		SIZE A2		
3 PLC ± .13 [.005]		CAGE CODE 00779		
4 PLC ± -		DRAWING NO 5414337		
ANGLES ± -		RESTRICTED TO		
FINISH		SCALE 8:1		
1		SHEET 1 of 1		
2		REV A		
CUSTOMER DRAWING				

5414337