

SPECIFICATIONS

MATERIAL

Sleeve: Brass Gold or Tin over Nickel plated
 Clip: Beryllium Copper Gold over Nickel plated

ELECTRICAL

Contact Rating: 1-ADC Max.
 Contact Resistance: 10 m Max.
 Insulation Resistance: 106 M Min. at 100 VDC
 Dielectric Strength: 1000 VAC Min. for 1 minute
 Capacitance between adjacent pin: 0.9 pF Max.

MECHANICAL AND ENVIRONMENTAL

Temperature Rating: Operating -55 to +125
 Life cycle with insertion and withdrawal: 100 operating cycles Min.
 Humidity: 90-95%RH, 40 for 96 Hrs.
 Vibration: per MIL-STD-202F METHOD 204D
 Solderability: per MIL-STD-202F METHOD 208D
 Soldering Heat: 260±5 for 5±1 seconds

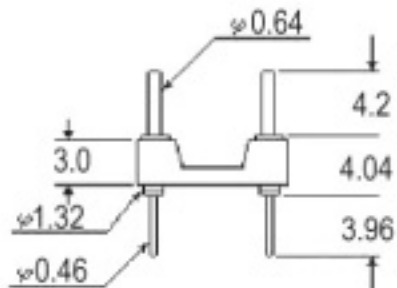

PIN NO.	A	B	C	PIN NO.	A	B	C
6	10.10	7.62	7.60	22	12.70	10.16	27.90
8	10.10	7.62	10.10	24	17.70	15.24	30.40
10	10.10	7.62	12.70	28	17.70	15.24	35.50
14	10.10	7.62	17.70	32	17.70	15.24	40.60
16	10.10	7.62	20.30	36	17.70	15.24	45.70
18	10.10	7.62	22.80	40	17.70	15.24	50.80
20	10.10	7.62	25.40	48	17.70	15.24	60.90
24	10.10	7.62	30.40				

ORDER INFORMATION

勝特力材料 886-3-5753170
 勝特力电子(上海) 86-21-54151736
 勝特力电子(深圳) 86-755-83298787
[Http://www.100y.com.tw](http://www.100y.com.tw)

06,08,10,14,16 S: 0.3*(7.62mm)
 18,20,22,24,28 H: 0.4*(10.16mm)
 32,36,40,48 L: 0.6*(15.24mm)

N: No Clip

T: Tin
 G: Gold Flash

B: Block

Fill It With "0"

Fill It With "0"

UNIT

SCALE

PART NAME

MM

2:1

I.C. SOCKET MACHINED PIN
 -STRAIGHT

APPD.

CKD.

TOLERANCE

PART NO.

REV.

制表日: 2003/08/26

DRAWING.

APPROVED

± 0.3

A

1 2 3 4 5 6 7 8