



勝特力材料 886-3-5753170  
 勝特力电子(上海) 86-21-54151736  
 勝特力电子(深圳) 86-755-83298787  
[Http://www.100y.com.tw](http://www.100y.com.tw)

### PE12V4.5

### Rechargeable Sealed Lead Acid Battery

#### Specifications



#### Dimensions

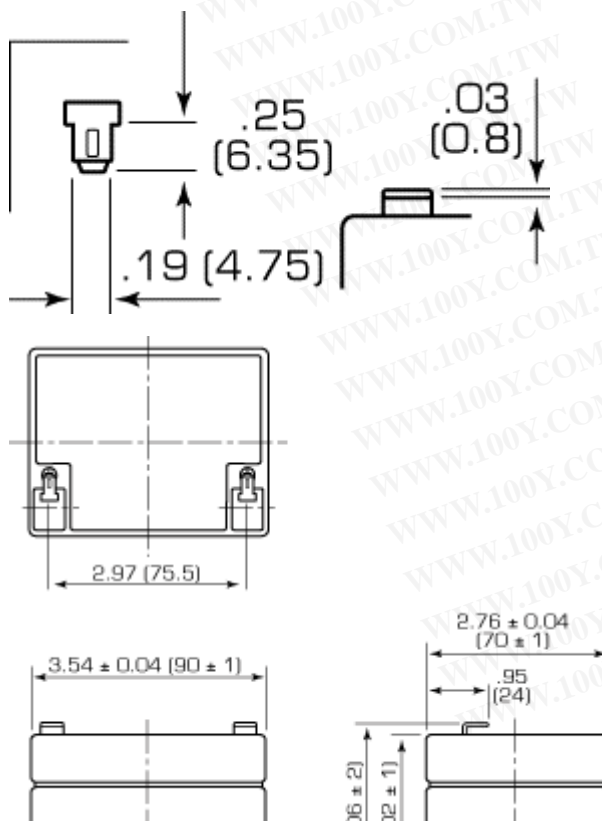

1	Nominal Voltage	12V
2	Nominal Capacity	0.05C (0.225A to 10.50V) 4.5 Ahr 0.1C (0.45A to 10.50V) 4.05 Ahr 0.2C (0.90A to 10.20V) 3.51 Ahr 1C (4.50A to 9.00V) 2.34 Ahr
3	Weight (Approx.)	3.86 lbs. (1.75 kg)
4	Internal Resistance of fully charged battery	40 milliohms
5	Energy Density (0.05C)	1.37 Watt-hours/cubic inch (84.0 Watt-hours/ℓ)
6	Specific Energy (0.05C)	14.0 Watt-hours/pound (30.9 Watt-hours/ℓ)
7	Maximum Discharge Current with standard terminals	27 amperes
8	Maximum Short Duration Discharge Current (less than 5 sec.)	67.5 amperes
9	Vibration Test	(2000 cycles/minute, 0.10 inch excursion, 2 hours) No loss in capacity or performance

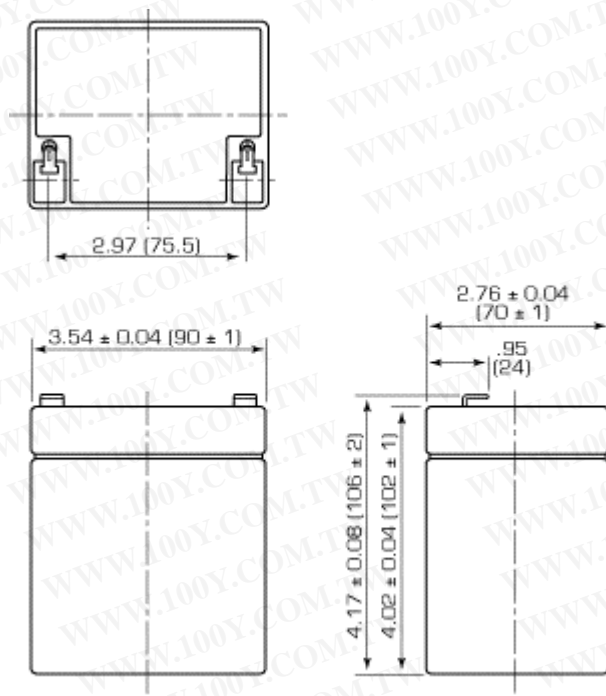

勝特力材料 886-3-5753170  
 勝特力电子(上海) 86-21-54151736  
 勝特力电子(深圳) 86-755-83298787  
[Http://www.100y.com.tw](http://www.100y.com.tw)

10	Charge Retention (shelf life)	% of nominal capacity at 77°F (25°C)  1 month 97% 3 months 91% 6 months 85%
11	Operating Temperature Range	Charge 32°F (0°C) to 104°F (40°C) Discharge -4°F (-20°C) to 122°F (50°C) Storage -4°F (-20°C) to 104°F (40°C)
12	Case Material	Synthetic resin (ABS)
13	Standard Terminal	F1

**CHARGING METHODS**

**CYCLIC USE:**

Maximum Initial Charge Current: 1.125A  
 Charging Voltage: 14.4V-14.7V  
 Charge should be switched to float mode or disconnected when current drops to 45mA.

**STANDBY USE:**

Maximum Initial Charge Current: 1.125A  
 Charge Voltage: 13.5V-13.8V

**Discharge Time vs. Terminal Voltage**

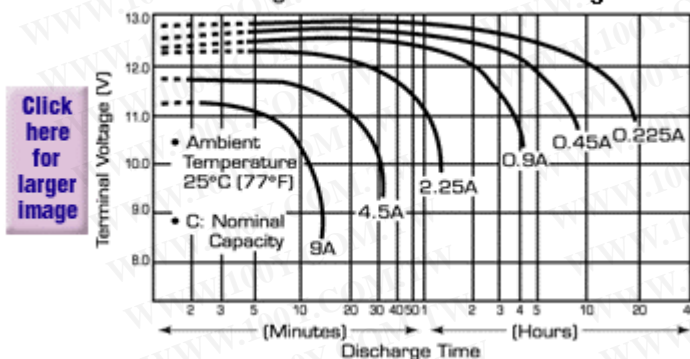

勝特力材料 886-3-5753170  
 勝特力电子(上海) 86-21-54151736  
 勝特力电子(深圳) 86-755-83298787  
[Http://www.100y.com.tw](http://www.100y.com.tw)

Life Characteristics of Cyclic Use

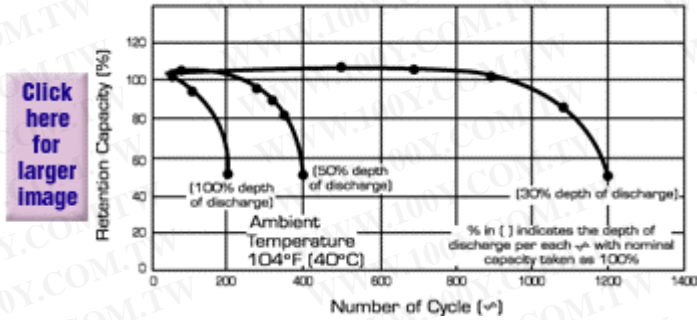

Shelf Life Characteristics

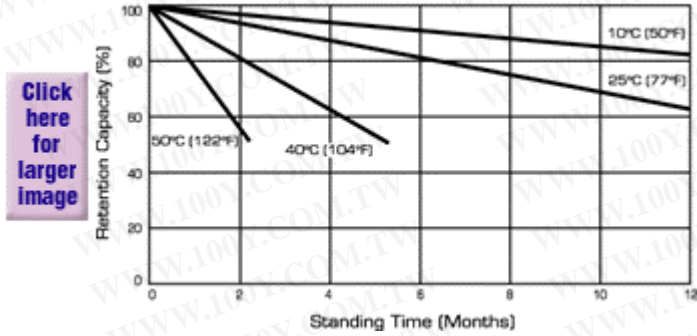

Effect of Temperature on Self-Discharge Rate

Click here for larger image

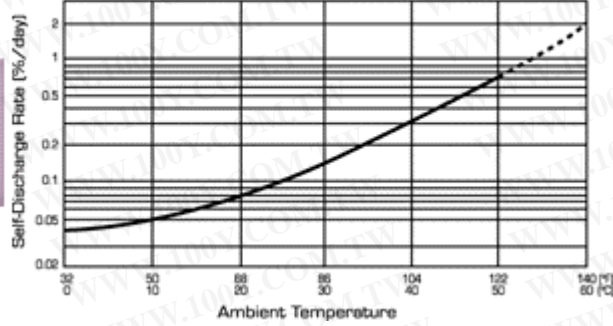

Effect on Temperature on Capacity

Click here for larger image

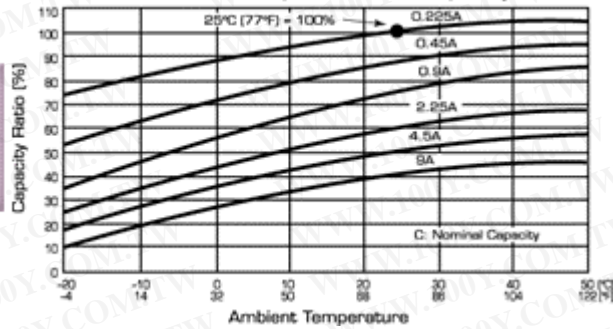

Life Characteristics of Standby Use

Click here for larger image

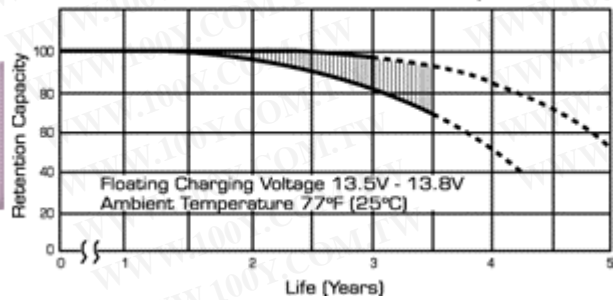

勝特力材料 886-3-5753170  
 勝特力电子(上海) 86-21-54151736  
 勝特力电子(深圳) 86-755-83298787  
[Http://www.100y.com.tw](http://www.100y.com.tw)

Click  
here  
for  
larger  
image

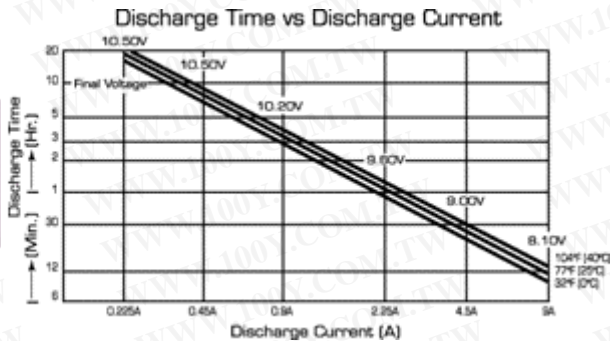

勝特力材料 886-3-5753170  
勝特力电子(上海) 86-21-54151736  
勝特力电子(深圳) 86-755-83298787  
[Http://www.100y.com.tw](http://www.100y.com.tw)