

型號說明

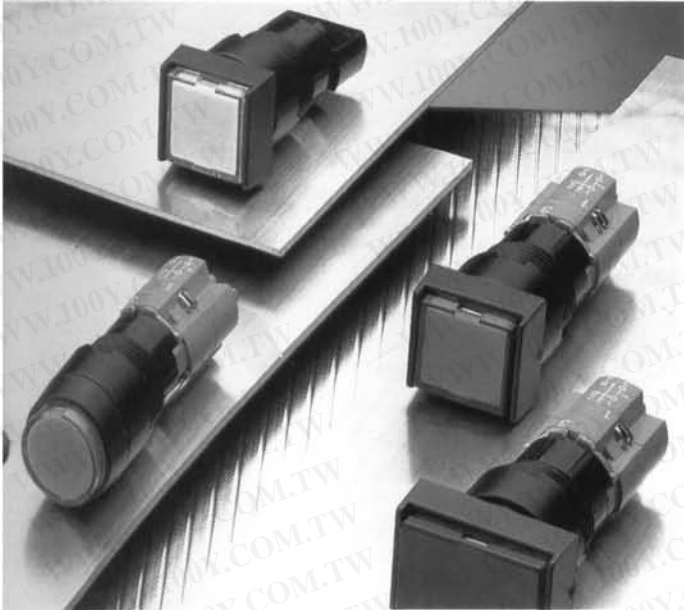
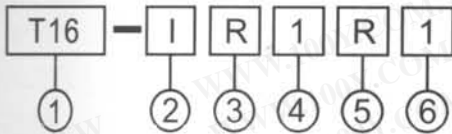

性能

接觸抵抗	15mΩ max.
絕緣抵抗	100MΩ min. (at500VDC)
耐電壓	1500VAC, 50/60Hz for 1minute
使用周圍溫度	operating: -20°C ~80°C
使用周圍濕度	95% RH max.
動作力量	150 g
壽命	機械壽命: 1,000,000 operations min. 電氣壽命: 100,000 operations min.
重量	10 gr(1a1b)
	15 gr(4a4b)

固定孔中心距離

- (圓形、方形)指示燈、照光式按鈕開關

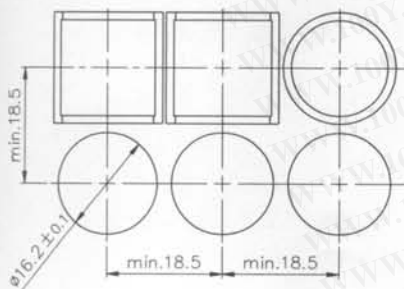

接點規格

額定絕緣電壓		250VAC	125VAC	接點	長度
額定接觸電流(A)		3A	5A		
額定使用電流(A)				2a2b	49.5mm
AC		DC		3a3b	57.5mm
電壓	AC13 AC12	電壓	DC13 DC12	4a4b	65.5mm
110V	0.7A 1A	12V	0.7A 1A		
220V	0.5A 0.5A	24V	0.7A 1A		

AC13/DC13:電感性負載; AC12/DC12:電阻性負載

- (長方形)指示燈、照光式按鈕開關

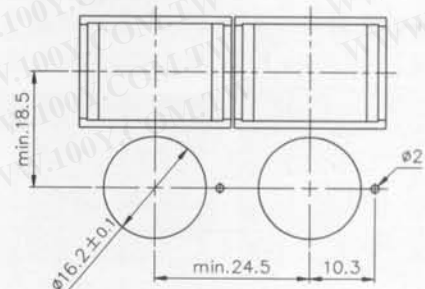

T16-IR(交替式)
T16-BR(復歸式)

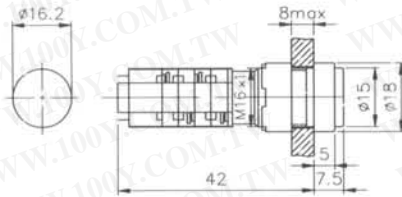

T16-PR圓型指示燈

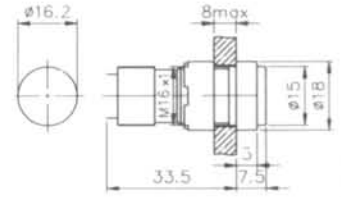

T16-IS(交替式)
T16-BS(復歸式)

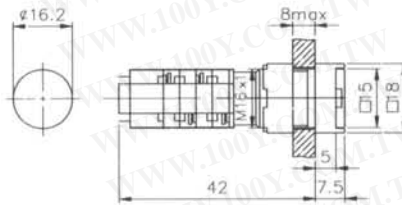

T16-PS方型指示燈

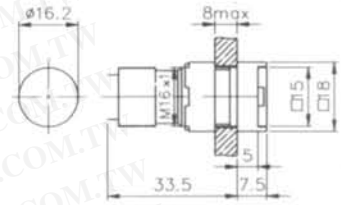

T16-IL(交替式)
T16-BL(復歸式)

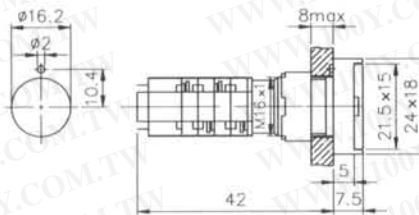

T16-PL長方型指示燈

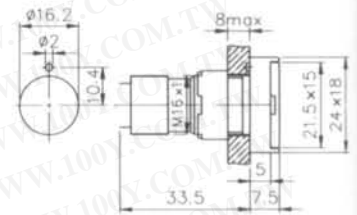

T16-WL防水套

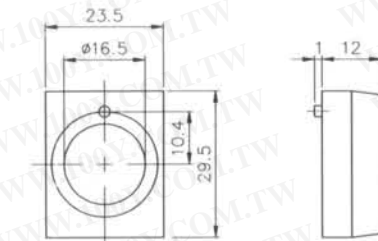
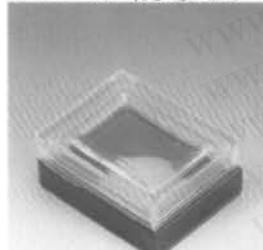

T16-GL護蓋

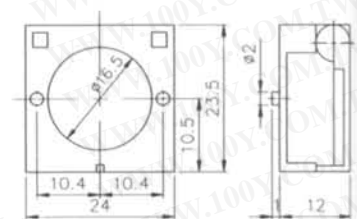

● Ø16m/m專用燈泡
T-4.5



電壓	瓦特數	直徑	長度
V	W	mm	mm
6	0.3	4.2±0.2	16.5 ^{+0.5} ₋₁
12	0.5		
18	0.5		
24	0.5		
28	0.7		
110V	0.3		
220V	0.3		

● 固定圈鎖緊與燈泡裝卸器
T16-A

