



# TRL

勝特力材料 886-3-5753170  
 勝特力电子(上海) 86-21-34970699  
 勝特力电子(深圳) 86-755-83298787  
[Http://www.100y.com.tw](http://www.100y.com.tw)

## MAIN FEATURES

- Long life and high reliability
- Strong construction for vibration and shock
- Approximately thousands for kinds are available depending on the combination of terminals, covers, contact ratings, coil etc.
- Plastic-sealed type is available
- Molded material : All UL 94V-0
- UL & cUL recognized

## APPLICATIONS

- Coil operated machines
- Vending machines
- Refrigerators
- Transportations
- Power station control equipment
- Office machines
- Building control equipment
- Medical equipment
- Amusement devices, etc.

## ORDERING INFORMATION

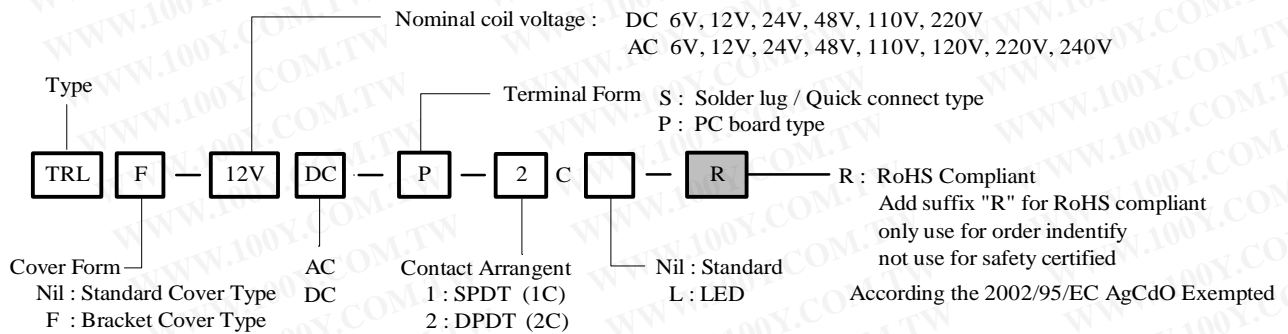

### Option Socket :

Please refer appendix P101 - P102



- OD07-0001A (PT-08-0)
- OD07-0002A (PTF-08A)
- OD07-0003A (PTF-08AE)

## DIMENSION(unit:mm)

## DRILLING(unit:mm)

## WIRING DIAGRAM

Standard Cover Type

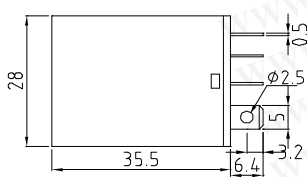

P.C.B Terminal Type

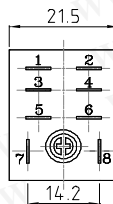
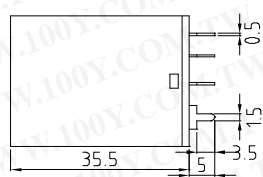

Bracketed Cover Type

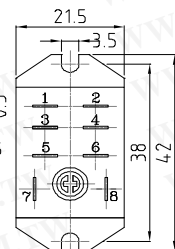
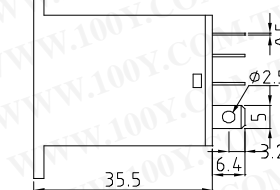

PC BOARD PATTEN (Bottom View)

SPDT (1C)

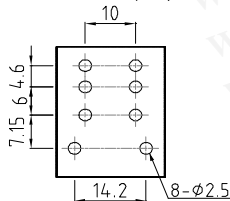

DPDT (2C)

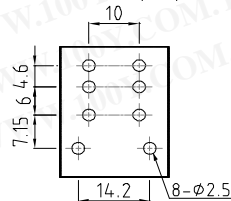

SCHEMATIC (Bottom View)

SPDT (1C)

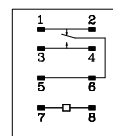

DPDT (2C)

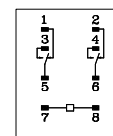

➤ **COIL DATA CHART(at 20°C)**

Nominal voltage	Pick-Up voltage	Drop-out voltage	Nominal current	Coil resistance	Power consumption	Max. allowable voltage
<b>AC Type</b>						
VAC	VAC(Max.)	VAC(Min.)	mA(+15%,-20%)	Ω (±10%)	P(VA)	(VAC)
6	4.8	1.8	183.0	11.5	Approx. 1.2VA	110% of nominal voltage
12	9.6	3.6	91.0	46		
24	19.2	7.2	46.0	184		
48	38.4	14.4	24	735		
110	88.0	33.0	11	3900		
120	96.0	36.0	9.8	4550± 15%		
220	176	66	4.2	14400± 15%		
240	192	72	5.5	15210± 15%		
<b>DC Type</b>						
VDC	VDC(Max.)	VDC(Min.)	mA(10%)	Ω (±10%)	P(W)	(VDC)
6	4.8	0.6	150	40	Approx. 0.9W	110% of nominal voltage
12	9.6	1.2	75	160		
24	19.2	2.4	37.2	650		
48	38.4	4.8	18.8	2560± 15%		
110	88	11.0	8.2	13444± 15%		
220	176	22.0	4.1	53778± 15%		

➤ **CONTACT RATING**

Item	Arrangement	TRL -1C (SPDT)	TRL -2C(DPDT)
Rated load		15A 277VAC 15A 28VDC	10A 277VAC 10A 28VDC
Carrying current		15A	10A
Max. switching voltage		300VAC, 30VDC	
Max. switching current		15A	10A
Max. switching power		4155VA, 420W	2770VA, 280W
Min. permissible load		5VDC 100mA	
Contact material		AgCdO	

➤ **PERFORMANCE (at initial value)**

Item	Arrangement	TRL
Contact Resistance		Max. 100mΩ
Operation time (at nominal voltage)		Max. 25msec
Release time (at nominal voltage)		Max. 25msec
Operating frequency		20 ops/minute
Insulation resistance		Min. 100MΩ (at 500VDC)
Vibration resistance		Functional : 6G 10 to 55 Hz, at double amplitude of 1mm Destructive : 12G 10 to 55 Hz, at double amplitude of 2mm
Shock resistance		Functional : Min, 20G Destructive : Min, 100G
Dielectric strength		1500VAC. for 1minute between coil and contact. 750VAC. for 1minute between contact sets. 750VAC. for 1minute between open contacts.
Ambient temperature		-40°C to +70°C
Humidity		40% to 85% RH
Life expectancy		Mechanical : 1 x 10 <sup>7</sup> operations Electrical : 2 x 10 <sup>5</sup> operations (at rated load)
Weight		abt 37grs.
UL & cUL		E156521